

INSTALLATION INSTRUCTIONS

SSB-166, SSM-166, SLB-166 and SLM-166 Interface Brackets

SSB-166, SSM-166, SLB-166 and SLM-166 Interface Brackets are designed for use with Chief® Series Projector Mounts. See the specific installation instructions provided with the mount for additional installation information.

Unpack carton and verify kit contents. If any listed parts are missing, immediately contact a Chief Customer Service representative.



WARNING: IMPROPER INSTALLATION CAN LEAD TO EQUIPMENT FALLING CAUSING SERIOUS PERSONAL INJURY AND DAMAGE TO EQUIPMENT! DO NOT substitute hardware. Use only hardware supplied by manufacturer!

- | | |
|----------------------------|--------------------------------|
| (1) Interface Bracket | (3) Screw, Pan Head, M4 x 10mm |
| (4) 10-24 Thumb Nuts ** | (1) Screw, Pan Head, M4 x 20mm |
| (1) All-PointsSecurity Kit | (4) Washer, Flat, M4 |
| (1) Wrench, Hex, 5/32" | (1) Spacer, Nylon, 1/2" x 1/2" |

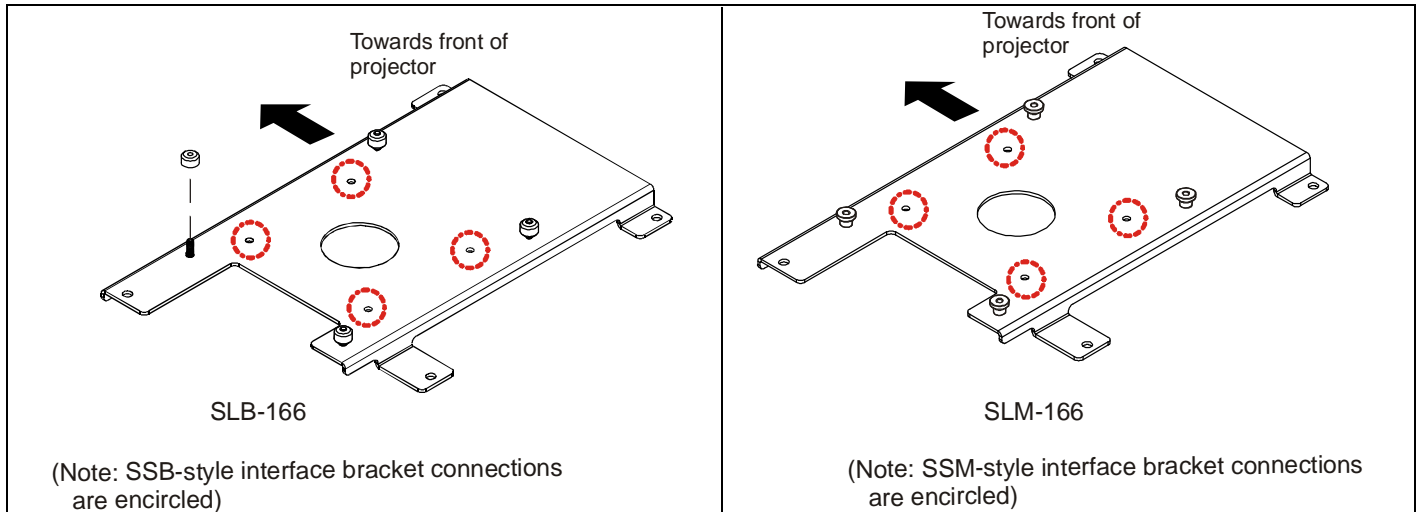

**Only used when installing SLB/SSB interface brackets.

NOTE: Specific to SSB-style and SSM-style interface bracket installation, all appropriate screws come pre-installed as reflected in the encircled locations above. DO NOT attempt to substitute and USE ONLY this pre-installed hardware for SSB-style and SSM-style interface bracket installation.

Installation Instructions



WARNING: OVER TIGHTENING OF SCREWS CAN DAMAGE PARTS AND CAN LEAD TO SERIOUS PERSONAL INJURY AND DAMAGE TO EQUIPMENT! DO NOT over tighten screws when installing interface bracket.

NOTE: Step 1 is only required when installing an SLB/SSB interface bracket. If an SLM/SSM bracket is being installed, proceed to step 2.

1. Screw thumb screws onto the 10-24 x 5/8" Phillips pan head screws. DO NOT fully tighten thumb screws at this time.
2. Turn projector upside down.
3. Place the interface bracket onto the bottom of the projector and align the threaded inserts in the bottom of the projector with the holes in the interface bracket.
4. Slide the 1/2" nylon spacer between the interface bracket and the projector.
5. Install the M4 x 10mm mounting screws and washers through interface bracket and into the mounting holes in projector.
6. Install the M4 x 20mm screw through the interface bracket, 1/2" spacer and mounting hole in projector. Tighten all fasteners at this time, securing the bracket to the projector.

NOTE: Security screws can be substituted when mounting interface bracket to projector by using the parts and installation instructions in the All-Points Security Kit.

Chief® is a registered trademark of Milestone AV Technologies. All rights reserved.

Touchboards
205 Westwood Ave, Long Branch, NJ 07740
Phone: 866-94 TOUCHBOARDS (26273) | (732) 222-1511
Fax: (732) 222-7088 | E-mail: sales@touchboards.com



Milestone AV Technologies, and its affiliated corporations and subsidiaries (collectively, "Milestone"), intend to make this manual accurate and complete. However, Milestone makes no claim that the information contained herein covers all details, conditions or variations, nor does it provide for every possible contingency in connection with the installation or use of this product. The information contained in this document is subject to change without notice or obligation of any kind. Milestone makes no representation of warranty, expressed or implied, regarding the information contained herein. Milestone assumes no responsibility for accuracy, completeness or sufficiency of the information contained in this document.

CHIEF
Our Mounts. Your Vision.

Chief Manufacturing, a products division of Milestone AV Technologies
8401 Eagle Creek Parkway, Savage, MN 55378
• P: 800.582.6480 / 952.894.6280 • F: 877.894.6918 / 952.894.6918

8802-000234 RevC
©2009 Milestone AV Technologies,
a Duchossois Group Company

05/09