

# SMART electric height-adjustable wall stand

## USER GUIDE

WSE-410 (S410-2)

Was this document helpful?  
[smarttech.com/docfeedback/171627](https://smarttech.com/docfeedback/171627)

**SMART**<sup>®</sup>



## Learn more

This guide and other resources for your SMART electric height-adjustable wall stand are available in the Support section of the SMART website ([smarttech.com/support](https://smarttech.com/support)). Scan this QR code to view these resources on your mobile device.

### **Trademark notice**

SMART Board, smarttech, the SMART logo and all SMART taglines are trademarks or registered trademarks of SMART Technologies ULC in the U.S. and/or other countries. All third-party product and company names may be trademarks of their respective owners.

### **Copyright notice**

© 2020 SMART Technologies ULC. All rights reserved. No part of this publication may be reproduced, transmitted, transcribed, stored in a retrieval system or translated into any language in any form by any means without the prior written consent of SMART Technologies ULC. Information in this manual is subject to change without notice and does not represent a commitment on the part of SMART.

This product and/or use thereof is covered by one or more of the following U.S. patents:

[www.smarttech.com/patents](https://www.smarttech.com/patents)

July 31, 2020

# Important information

## IMPORTANT SAFETY INSTRUCTIONS: SAVE THESE INSTRUCTIONS

### NOTE

Refer to the [illustrated installation instructions](#) for important information about installing and setting up the stand.

### WARNING

- Read the following warnings carefully. Failure to read the warnings below or to follow the installation instructions included with the stand could result in personal injury or product damage.
- DANGER: to reduce the risk of shock, always unplug the stand from the electrical outlet before cleaning or servicing the stand.
- Closely supervise the operation of the stand when it's used near children or people with disabilities.
- Use the stand only for its intended use as described in these instructions. Do not use attachments not recommended by SMART Technologies.
- Do not operate the stand if it has a damaged cord or plug, if it is not working properly, if it has been dropped or damaged, or if it has been dropped into water. Return the stand to a service center for examination and repair.
- Keep the power cord away from heated surfaces.
- Do not drop or insert any object into any opening.
- Do not use outdoors.
- Connect the stand only to a properly grounded outlet.
- Only use the stand with a nominal 120-volt circuit that has a grounding plug that looks like the plug in the illustration below.

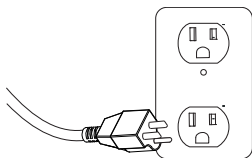

- Only connect the stand to an outlet that has the same configuration as the plug.

- Do not defeat the safety purpose of the grounding-type plug. A grounding plug has two blades or pins and a third grounding prong. The third prong is provided for your safety. If the provided plug does not fit into the outlet, consult an electrician for replacement of the obsolete outlet.
- Do not alter or remove the grounding prong from the power cord.
- Improper use of the grounding plug can result in electric shock.
- Do not use a mains power adapter plug.
- The stand must be grounded to reduce the risk of electric shock in the event of an electrical short circuit.
- To prevent injury, the stand must be securely attached to the wall in accordance with the installation instructions.
- The assembly and installation of the stand is intended for a trained professional.
- The installer must follow the installation instructions. Not doing so can result in injury or damage to equipment.
- Use only SMART-supplied mounting hardware or hardware that is designed to properly support the weight of the stand and mounted display and accessories.
- Use the stand only for lifting a display that meets the size and weight limitations indicated in the product specifications. Do not use the stand to lift people or objects.
- Do not overload the stand with too much weight, as this can cause injury or damage to the stand.
- Operating the stand can create a hand-crushing or hand-pinching hazard. To prevent injury, keep hands and people away from crush and pinch locations on the stand.
- Allow adequate clearance above and below the stand to ensure safe raising and lowering.
- Do not operate the stand if it is damaged.
- Do not use the stand near water.
- Allow only adults who are trained and able to use the stand safely to operate it.
- Do not allow children or people who are not able to safely operate the stand to use it.
- Do not allow children to operate or play with the stand.
- Do not climb (or allow children to climb) on a wall- or stand-supported display. Climbing on the display could result in injury or product damage.

## Important information

- Do not stand (or allow children to stand) on a chair to touch the surface of the display. Rather, adjust the stand so the display is at the proper height.
- Ensure that any cables extending across the floor to the stand are properly bundled and marked to avoid a trip hazard.
- Unplug the power cord before cleaning the stand. Use only a dry or slightly dampened cloth to clean the stand.
- Do not allow children to clean or maintain the stand without supervision.
- Only use attachments/accessories specified by the manufacturer.
- Unplug the power cord before connecting and disconnecting the control panel.
- Unplug the power cord if the stand malfunctions.
- To reduce the risk of fire or electric shock, do not expose the stand to rain or moisture.
- Do not use the stand if the power cord is damaged. Replace a damaged power cord only with a new cord and power bar provided by SMART Technologies or a qualified service technician.
- Do not modify or make changes to the control unit or hand switches.
- Do not open the control box. There is danger of electric shock.
- Allow only qualified service technicians to service the stand. Allowing anyone else to service the stand will void the warranty/guarantee.
- Refer all servicing to qualified service personnel. Servicing is required when the stand has been damaged in any way, such as power-supply cord or plug is damaged, liquid has been spilled or objects have fallen into the stand, the stand has been exposed to rain or moisture, does not operate normally, or has been dropped.
- Use only original accessories and replacement parts. Using other accessories or parts will void the warranty/guarantee.
- Make sure the stand's power cord is easily accessible at all times.

## CAUTION

- Operate the stand only indoors.
- Protect the power cord from being walked on or pinched, particularly at plugs, convenience receptacles, and the point where they exit from the stand.
- Use only a power extension cord that is rated for the stand's electrical load.
- Do not exceed the duty cycle written on the product label.

## IMPORTANT

- Keep these instructions.
- Make sure an electrical socket is near the stand and remains easily accessible during use.
- Plug the stand into its own electrical outlet for best operation.
- The stand is intended to be used by a trained operator in a commercial setting. It is not intended to be used in an area where children or people with disabilities are not supervised.
- When operating the stand, you must be familiar with the entrapment hazard of the stand, the mounted display, and of mounted accessories. In some cases, there can be less than 12" (30.5 cm) of clearance between the bottom of the display and the stand's base. This can cause a person to be pinned and injured. Installed accessories, such as the laptop shelf, can also cause people to be pinned between the stand and fixed objects or furniture. Those who operate the stand must ensure that they and others stay clear of entrapment locations when raising and lowering the stand.

## Product labels

<b>WSE-410</b>		
<b>SMART Wall Stand Electric</b>		
Part Number: 1034166		
Revision: XX	Date of Manufacture: YYYYWW	
Serial Number: VVVQYDDDPxxxx		
120V, 60Hz, 450W Operation of Lift: 2 minutes on / 18 minutes off Fonctionnement de l'ascenseur: 2 minutes marche / 18 minutes arrêt		
CAN ICES-3 (A) / NMB-3 (A) This device complies with Part 15 of the FCC Rules. Operation is subject to the following two conditions: (1) This device may not cause harmful interference. (2) This device must accept any interference received, including interference that may cause undesired operation		
Assembly instructions can be viewed, downloaded, and printed at Les instructions de montage peuvent être consultées, téléchargées et imprimées sur <a href="http://www.smarttech.com/kb/171619">www.smarttech.com/kb/171619</a>		 Commercial Product Usage AREA II E511662 Motorized Stand
User guide can be viewed, downloaded, and printed at Le guide de l'utilisateur peut être consulté, téléchargé et imprimé sur <a href="http://www.smarttech.com/kb/171627">www.smarttech.com/kb/171627</a>		
		
SMART Technologies ULC • 3636 Research Road NW • Calgary, AB T2L 1Y1 Canada <a href="http://smarttech.com/support">smarttech.com/support</a> • <a href="http://smarttech.com/compliance">smarttech.com/compliance</a> • <a href="http://smarttech.com/patents">smarttech.com/patents</a> Made in Netherlands 1034229-01		

**Important information**

**WARNING - Risk of Tip Over**  
 For use with displays weighing 200 lb (91 kg) or less. Use with heavier displays may result in instability causing tip over resulting in death or serious injury.



**WARNING - Risk of Injury**  
 Not to be operated in locations where children or people with cognitive disabilities are anticipated to be present and not supervised. Maximum load 227 lb (103 kg). The use of accessories may reduce the max display weight (227 lb - accessories = Max display weight).

**WARNING - Risk of Electric Shock, Fire and/or Injury**  
 Review the assembly instructions to ensure that only the SMART supplied critical components are being installed in the assembly of this stand.

**IMPORTANT** - This stand has optional mounting accessories for laptops and speakers. See Specification Sheets for a list of qualified mounting accessories. Use of other mounting accessories may result in instability leading to possible injury. For commercial use only.

1034226-01

**AVERTISSEMENT - Risque de basculement**  
 Pour une utilisation avec des écrans pesant 200 lb (91 kg) ou moins. Une utilisation avec des écrans plus lourds peut entraîner une instabilité pouvant causer un basculement qui peut entraîner la mort ou des blessures graves.



**AVERTISSEMENT - Risque de blessure**  
 Ne pas utiliser dans des endroits où des enfants ou des personnes ayant des déficiences cognitives devraient être présents et non surveillés. Charge maximale 227 lb (103 kg). L'utilisation d'accessoires peut réduire le poids maximum de l'écran (227 lb - accessoires = poids maximum du panneau).

**AVERTISSEMENT - Risque de choc électrique, d'incendie et / ou de blessure** - Consultez les instructions d'assemblage pour vous assurer que seuls les composants critiques fournis par SMART sont installés dans l'assemblage de ce support.

**IMPORTANT** - Ce support a des accessoires de montage en option pour les ordinateurs portables et les haut-parleurs. Voir les fiches techniques pour une liste des accessoires de montage qualifiés. L'utilisation d'autres accessoires de montage peut entraîner une instabilité pouvant entraîner des blessures. Pour usage commercial uniquement.

1034226-01

**WARNING**  
**RISK OF FIRE AND SHOCK**  
 Use only SJ or SJT or equivalent Type 18 AWG cord.

**AVERTISSEMENT - RISQUE D'INCENDIE ET D'ÉLECTROCUTION**  
 Utilisez uniquement un cordon SJ ou SJT ou équivalent de type 18 AWG.

1032759-02

**WARNING**  
 Risk of injury. Do not operate this equipment unless properly trained.

**AVERTISSEMENT**  
 Risque de blessure, ne pas utiliser à moins d'être correctement formé.

1034319-01

**Subassemblies**

Laptop shelf  
 FSE-400-LS

**WARNING - Risk of tip over**  
 Maximum load: 13.2 lbs (6 kg)



**AVERTISSEMENT**  
 Risque de basculement. Charge maximale: 13,2 lbs (6 kg)

1032741-03

6 outlet power bar  
 Model TPL615B

**CAUTION: TO REDUCE THE RISK OF THE ELECTRIC SHOCK USE ONLY IN DRY LOCATIONS INDOORS**  
**ATTENTION: POUR RÉDUIRE LE RISQUE DE CHOC ÉLECTRIQUE UTILISER UNIQUEMENT DANS DES ENDROITS SECS À L'INTÉRIEUR**

**CAUTION: DO NOT CONNECT TO ANOTHER RELOCABLE POWER TAP**  
**ATTENTION: NE PAS BRANCHER DANS UNE AUTRE PRISE DE TENSION RELOCALISABLE**

Wall mount bracket  
 WM-SBID-200 (Model W200-1)

**US LISTED**  
 AV Wall Mount  
 E506955

**Display**  
 86 inch (218 mm) maximum diagonal screen, weighing up to 220 lb. (100 kg)

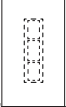

**Écran**  
 Écran de diagonale maximale de 86 pouces (218 cm), pesant jusqu'à 220 lb (100 kg)

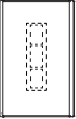

**CAUTION:** This wall mount is intended for displays no larger or heavier than the limits indicated. Use with products beyond these limits may result in collapse of the mount leading to possible injury.

**ATTENTION:** Ce support mural est conçu pour des écrans pas plus grands ni plus lourds que les limites indiquées. L'utilisation avec des produits au-delà de ces limites peut entraîner l'effondrement du support, et éventuellement provoquer des blessures.

**SMART**  
 SMART Technologies LLC  
 3535 Research Road NW  
 Calgary, AB T2L 1Y1 Canada  
 1032807-01

WM-SBID-200 SMART Wall Mount  
 Model W200-1  
 smarttech.com/support  
 smarttech.com/compliance  
 smarttech.com/patents

Made in China

Date of Manufacture: 201851



1032808-01

# Contents

- Important information ..... 3**
- Chapter 1: About the stand ..... 7**
  - Features ..... 7
  - Components ..... 8
  - Accessories ..... 9
  - More information ..... 9
- Chapter 2: Assembling the stand ..... 10**
  - Environmental requirements ..... 10
  - Considerations when assembling the stand ..... 11
- Chapter 3: Using the stand ..... 13**
  - Raising and lowering the stand ..... 13
- Chapter 4: Troubleshooting the stand ..... 18**
  - Resolving general issues ..... 18
  - Using the status light ..... 19
  - Factory resetting the stand ..... 19

## Chapter 1

# About the stand

Features .....	7
Components .....	8
Control switch .....	8
Accessories .....	9
More information .....	9

---

## Features

Your SMART electric height-adjustable wall stand has the following features:

Feature	Description
Powered height adjustment	With its 39 3/8" (99 cm) of electric-powered height adjustment, you can easily adjust the height of a mounted display with the press of a button.
Automatic height-adjustment safety lock	The stand's height-adjustment mechanism locks automatically after 20 seconds of inactivity.
Height-adjustment limits	The stand features height-adjustment limits to prevent the stand from hitting objects that are in the height-adjustment path.
Safety bounce-back mechanism	The stand features a safety mechanism to prevent injury and damage when raising and lowering a display. If an obstruction is encountered while the stand is being raised or lowered, the stand will stop and reverse direction briefly.
Power bar	The power bar, mounted on the side of the stand, has surge protection and can be used for connecting a display and accessories to power.
Sturdy steel frame	The sturdy steel frame allows the stand to support displays up to 86" (218 cm) diagonal and 80" (203 cm) wide and that weigh 200 lb. (91 kg). It supports a maximum weight of 227 lb. (103 kg) with a display and accessories.
Americans with Disabilities Act (ADA) compliance	The stand's design meets Americans with Disabilities Act (ADA) accessibility standards.

## Components

The stand consists of the following components:

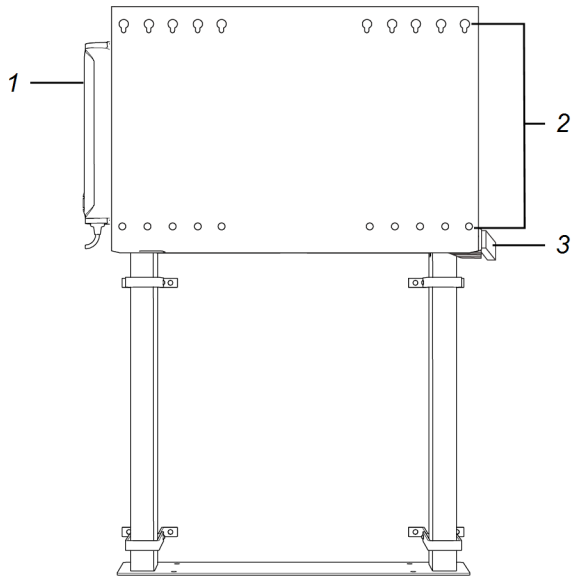

No.	Description
1	Power bar
2	Mounting holes
3	Control switch

### Control switch

You can raise and lower the stand with the control switch located on the right side of the stand. The control switch has three buttons and an indicator light.





Button	Description
	Unlocks the height adjustment lock.
	Sets the upper and lower limits.
	Unlocks the height adjustment lock.



## Accessories

The following accessories are available for your wall stand:

Accessory	Description
Laptop shelf	<p>The laptop shelf is a convenient place to place your laptop or keyboard when you're using a stand-mounted display.</p> <hr/> <p> <b>CAUTION</b></p> <p>The maximum allowable load is 13 lb. 3 oz. (6 kg).</p> <hr/>
Power bar	<p>The power bar, mounted on the side of the stand, has surge protection and can be used for connecting a display and accessories to power.</p> <hr/> <p> <b>CAUTION</b></p> <p>Use only the included six outlet power bar (model TPL615B) with the stand.</p> <hr/>

## More information

See the following resources for more information:

- WSE-410 specifications: [smarttech.com/kb/171628](https://smarttech.com/kb/171628)
- WSE-410 illustrated installation instructions: [smarttech.com/kb/171619](https://smarttech.com/kb/171619)

These documents are available in the Support section of the SMART website: [smarttech.com/support](https://smarttech.com/support).

## Chapter 2

# Assembling the stand

Environmental requirements .....	10
Considerations when assembling the stand .....	11

---

The stand requires assembly. Consult the *SMART electric height-adjustable wall stand illustrated installation instructions* ([smarttech.com/kb/171619](http://smarttech.com/kb/171619)) included with the stand for assembly instructions.

---

### **WARNING**

Failure to follow the installation instructions included with the stand could result in personal injury or product damage.

---

### **CAUTION**

Ensure any display you install on the stand weighs between 92 lb. (42 kg) and 200 lb. (91 kg).

---

## Environmental requirements

Before installing the stand, refer to the following environmental requirements.

---

### **CAUTION**

- Do not operate the stand immediately after moving it from a cold location to a warm location. Allow the stand to reach room temperature before operation to prevent possible product damage.
  - Do not place the stand in hot locations, such as near heating equipment.
-

## Considerations when assembling the stand

### **WARNING**

Two people are required to safely assemble the stand and to mount or remove the display.

### NOTES

- You require ample work space to assemble the stand.
- Do not set up or use the stand in an area with excessive levels of dust, dirt, humidity, or smoke.

Review the following recommendations when using the WM-SBID-200 wall mount that is supplied with some SMART display models:

Model(s)	Recommendation
SBID-MX265-V1/2	The wall mount supplied with these models is not compatible with the stand. The wall mount isn't required.
SBID-MX275-V1/2 SBID-MX286-V1/2	Ease of installation may be improved by using the wall mount, but the wall mount isn't required.
SBID-6065S SBID-6075S SBID-6086S SBID-7075R SBID-7086R	The wall mount is required.
SBID-7075-V2 SBID-7086-V2 SPNL-6055 SPNL-6065 SPNL-6075 SBID-6065 SBID-6075	Ease of installation may be improved by using the wall mount, but the wall mount isn't required.
SBID-7075 SBID-7086	The wall mount isn't required.

---

**NOTE**

Please contact SMART Support ([smarttech.com/contactsupport](https://smarttech.com/contactsupport)) if you need a WM-SBID-200 wall mount.

---

## Chapter 3

# Using the stand

Raising and lowering the stand .....	13
Resetting the stand .....	14
Unlocking the height-adjustment safety lock .....	14
Raising and lowering the stand .....	14
Setting height limits .....	15
Setting and using favorite positions .....	16

---

## Raising and lowering the stand

---

### **WARNINGS**

- Ensure the locking bolts are securely tightened before operating the stand.
  - Do not allow children or people who are not able to safely operate the stand to use it.
  - To prevent injury, keep hands and people away from crush and pinch locations on the stand.
  - Operating the stand can create a hand-crushing or hand-pinching hazard. To prevent injury, keep hands and people away from crush and pinch locations on the stand.
  - Allow adequate clearance above and below the stand to ensure safe raising and lowering.
- 

### **CAUTION**

Do not raise and lower the stand for more than two minutes at a time.

---

## Resetting the stand

The stand needs to be reset before you start to use it.

### To reset the stand

1. Connect the stand to a power outlet.
2. Press the 🔔, ✖, and ★ buttons in sequence, and then press down on the control switch for 5 seconds.

---

#### TIP

Don't allow more than one second between button presses.

---

The stand moves up 1 cm and then back down.

## Unlocking the height-adjustment safety lock

The stand's height-adjustment mechanism locks automatically after 20 seconds of inactivity. Unlock the height-adjustment lock before you raise or lower the stand.

### To unlock the stand's height adjustment

Press the 🔔, ✖, and ★ buttons in sequence.

---

#### TIP

Don't allow more than one second between button presses.

---

## Raising and lowering the stand

### To raise the stand

1. Lift up and hold the control switch.

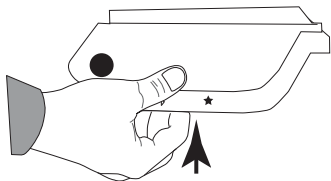

The stand rises.

2. Release the control switch to stop raising the stand.

### To lower the stand

1. Press down and hold the control switch.

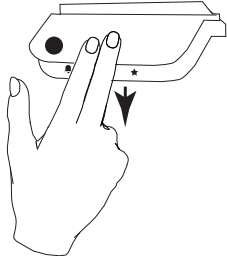



The stand lowers.

2. Release the control switch to stop lowering the stand.

### Setting height limits



You can set an upper and lower limit for the stand's height adjustment. If there's an object that's blocking the stand's adjustment path, the height limits prevent the stand from hitting the object.

#### To set the upper height limit

1. Raise the stand to the height you want to use as the upper limit.
2. While pressing and holding the  button, lift the control switch up until the indicator light flashes.
3. Release the  button and the control switch.

The upper limit is set.

#### To set the lower height limit

1. Lower the stand to the height you want to use as the lower limit.
2. While pressing and holding the  button, press the control switch down until the indicator light flashes.
3. Release the  button and the control switch.

The lower limit is set.

## Setting and using favorite positions

You can save up to two positions in the stand's memory. You can then raise or lower the stand to these favorite positions.

### To set a favorite position

1. Raise or lower the stand to the height you want to set as the favorite position.
2. Press the ★ button for two seconds.

The status light flashes white two times. After the stand saves the position, the status light appears solid white.

### To raise or lower the stand to a favorite position

1. Lift up and hold the control switch to raise the stand.

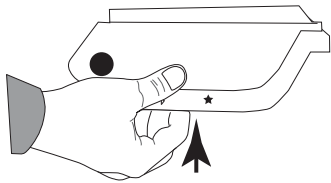

OR

Press down and hold the control switch to lower the stand.

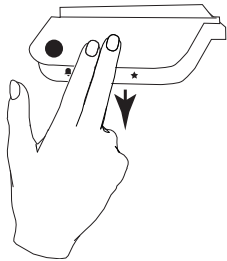

The stand rises or lowers until it reaches a favorite position.

2. Release the control switch within one second.



**To raise or lower the stand to a favorite position automatically**

Double-tap the control switch from the bottom to raise the stand or from the top to lower it.

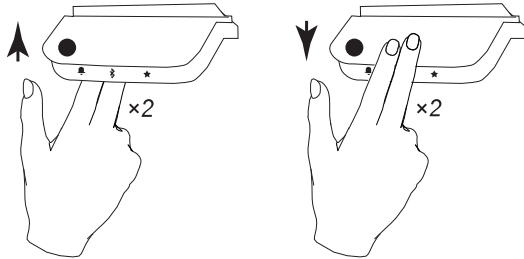

The stand rises or lowers until it reaches a favorite position.

---

**TIP**

To stop the stand from rising or lowering, tap the control switch once.

---

**To erase all favorite positions from the stand's memory**

Press the ★ button for eight seconds.

The status light flashes red.

## Chapter 4

# Troubleshooting the stand

Resolving general issues .....	18
Using the status light .....	19
Factory resetting the stand .....	19

This section describes how to troubleshoot the wall stand.

## Resolving general issues

Issue	Possible solution
The stand does not raise or lower	<ul style="list-style-type: none"><li>• Ensure the power cable is connected to the stand.</li><li>• Check all cables and ensure that they are not damaged.</li><li>• Ensure the switch on the power bar is turned on.</li><li>• Ensure the actuators and the control panel are connected to the control box.</li><li>• Unplug the power cable for the stand. Wait 15 minutes and then reset the stand.</li></ul>
The display doesn't fit on the stand.	<ul style="list-style-type: none"><li>• Ensure you're using the mounting plate supplied with the SMART display.</li><li>• If you're using the stand with a third-party display, ensure the stand supports the display's dimensions and mounting patterns (see <a href="https://smarttech.com/kb/171628">smarttech.com/kb/171628</a>).</li></ul> <hr/> <p><b>TIP</b></p> <p>If the display is outside of the stand's supported dimensions, use a SMART wall mount (see <a href="https://smarttech.com/kb/171405">smarttech.com/kb/171405</a>).</p>

## Using the status light



The status light indicates the stand's current status:

Status	Status light	Notes
The stand is locked.	Not lit	The stand is locked after you first turn it on.
You attempt to use the stand while it's locked.	Momentarily flashes red	The status light momentarily flashes red to indicate that the stand is locked.
The stand is unlocked.	Not lit	The stand locks after 20 seconds of non-use.
The stand is in the process of locking.	Momentarily flashes red	The status light momentarily flashes red to indicate that the stand is locked.
You turn on the stand.	Momentarily flashes red	The stand is locked after you first turn it on.
There is a problem.	Green	Contact SMART Support ( <a href="https://smarttech.com/contactsupport">smarttech.com/contactsupport</a> ).

## Factory resetting the stand

If the stand lowers but does not move when you try raising it or if you replace the controller, perform a factory reset by following the steps below.

### To factory reset the stand

1. Connect the stand to a power outlet.
2. Press and hold the  and  for eight seconds.



The indicator light flashes red three times when the factory reset is complete.

**SMART TECHNOLOGIES**

[smarttech.com/support](https://smarttech.com/support)

[smarttech.com/contactsupport](https://smarttech.com/contactsupport)

[smarttech.com/kb/171627](https://smarttech.com/kb/171627)