

Technical Specifications

55375 Impression 30 Imaging Laptop Cart

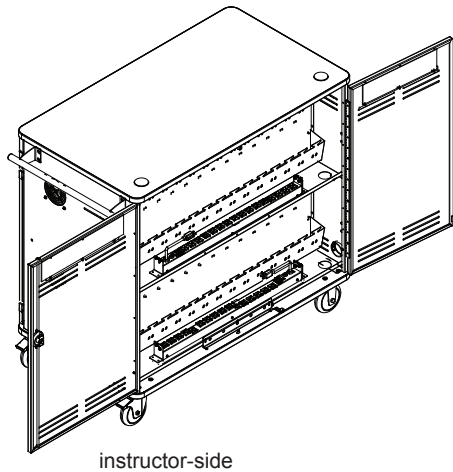

instructor-side

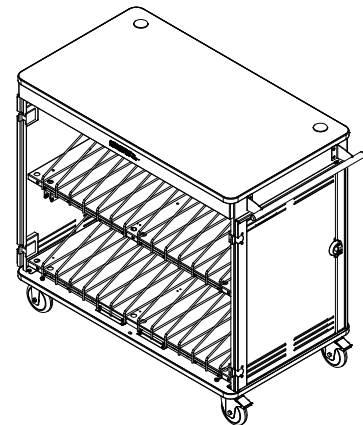
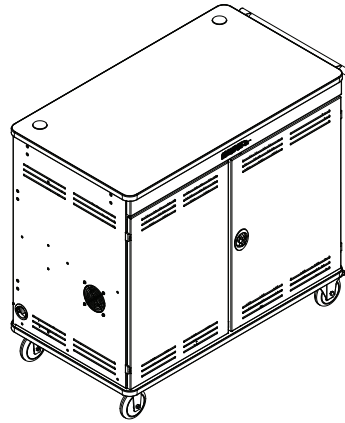

205 Westwood Ave, Long Branch, NJ 07740
Phone: 866-94 BOARDS (26273) / (732)-222-1511
Fax: (732)-222-7088 | E-mail: sales@touchboards.com

The Impression 30 Imaging Laptop Cart is designed to securely store, transport, and recharge up to 30 full-size laptops. The Impression 30 Imaging Laptop Cart adds features specifically designed to manage imaging applications where laptops will be powered and the hard drives imaged while charging. This application generates far more heat inside the cart. It is generally understood that a 10°C (18°F) rise in temperature can reduce electronic life up to 50%, and even compromise warranty. The Impression 30 addresses this issue with both chimney-effect natural convection ventilation supplemented by powered ventilation fans. 5" balloon wheels provides easy transport from computer lab to classroom over irregular surfaces, a 19" rack-mount (1RU) for a Netgear or other Ethernet switch, an auxiliary power strip to power peripherals and the Ethernet switch, an electronic charge timer to prevent 30 laptops from drawing more than 15 amps, and a generous supply of 3/8" Velcro® wire ties that secure laptop transformers and the RJ45 Ethernet cables to each laptop.

Features and Benefits

- 30 laptop version with easy-access to electrical power
- Durable powder coated steel chassis
- Rack-mount space (1RU) for Ethernet switch through rear doors
- RJ45 cords (not included) provide data to each laptop
- Doors and side panels are effectively ventilated to keep laptops cool
- Airflow is supplemented by dual ventilation fans that exhaust the heat generated while charging and imaging laptops
- Space is available on the laptop charge block shelves or side panel to mount a wireless access point
- Padded shelves and rubber-coated dividers cushion and protect laptops
- Scratch and impact-resistant 1 1/8" high-pressure laminate worksurface
- Double-bolt, locking doors provide security and easy-access
- Student-side doors have wrap-around 270° hinges to allow faster loading and unloading of laptops
- Directional, lockable 5" balloon wheels make the unit extremely mobile for easy transport between classrooms
- Cable grommets are strategically placed throughout for effective cord management
- Plastic-coated dividers protect laptops from damage
- Two 16-unit power strips with 15-amp breaker and reset button plug into electronic cycle timer
- Our smart electronic timer charges 15 laptops at a time, limiting current draw by switching between two power strips, providing charging for up to 30 laptops
- Extra 7-outlet power strip with surge suppression supplies power to wireless access point, imaging switch, and/or ventilation fan
- Standard 15' retractable UL listed 15-amp power cord reel provide quick and easy power-access
- Electrical system consists of UL listed components
- One standard handle provides control and mobility
- Pull-down cord management system keeps charge cords organized in a tray, correctly positioned above each laptop
- Smart electronic timer charges 15 laptops at a time, limiting current draw by switching between two power strips, providing charging capabilities for up to 30 laptops
- Rear doors feature acrylic windows to view Ethernet switch status lights and charge timers when doors are closed and locked
- Warranted to be free of all defects in materials and workmanship with a 10-year warranty

Base Options

DW - Directional Wheels

Color Options

Standard laminate / color combinations

White Fiesta / Cool White (WFCW)

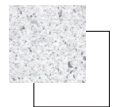

Wild Cherry / Black (CHB)



Indigo Organix / Black (IB)



Standard color combination refers to the quickest deliverable product color combination. Custom laminates and color combinations are available-additional lead-times and up-charges may apply. Call 1-800-235-1262 for further information.

Construction

- The worksurface and base panel is constructed from 1 $\frac{1}{16}$ " thick NAUF (no added urea formaldehyde) composite board with .030 high-pressure laminate on one face, and a balancing phenolic backer on the opposing face
- 16-gauge side panels, doors, and shelves
- Worksurface edges are covered with 3mm vinyl
- All metal components are finished with a scratch-resistant powder coat epoxy
- Each Impression 30 Imaging Cart is factory-assembled, packaged, and shipped on its own skid (handle and cord management brackets to be installed by customer)

Specifications

Capacity	30 laptops
Storage slots	2 $\frac{3}{4}$ "W x 16 $\frac{5}{16}$ "D x 14 $\frac{1}{16}$ "H
Ethernet switch capacity	(1RU) 17 $\frac{3}{4}$ "W x 22 $\frac{1}{2}$ "D x 2"H
Electrical	Two 16-outlet (125V) power strips, each containing a 15-amp breaker, on/off switch and a 12' nominal 14 AWG, 3-wire power cord. Outlets and imaging switch are accessible from the instructor-side of the unit. UL-listed components.
Cooling fans	60 CFM, 27 dB (2 fans included)
Cycle Timer	15-amp, 120 volt, 60Hz with a 15-240 minute timer, 14AWG power cord
5" balloon / directional wheels	weight capacity 325 lbs each
Cord reel	15' retractable, 15-amp, 125V, 12AWG, with breaker, UL-listed
Unit weight (nominal)	340 lbs
Shipping weight (nominal)	390 lbs
Meets or exceeds applicable ANSI-BIFMA test standards	

Specifications subject to change without notice

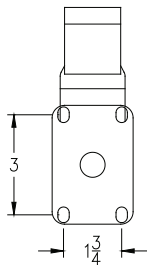
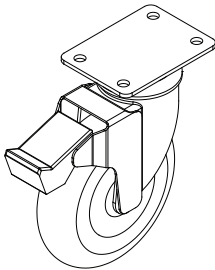

Not included:

- Imaging Ethernet switch
- Wireless access point
- laptops & charging transformers
- RJ45 cords

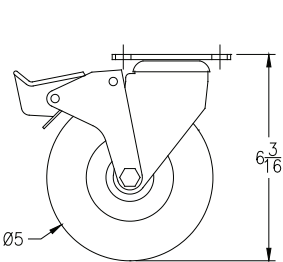

5" balloon / directional wheel

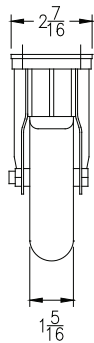

outlet spacing on each 16-outlet power strip

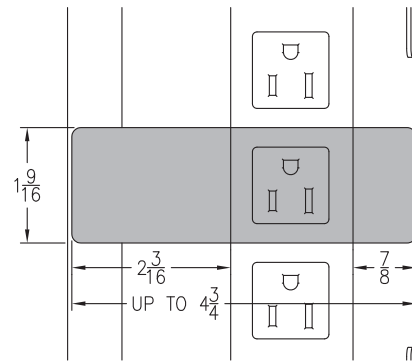

Note: Two swivel directional locking 5" balloon wheels can be rotated and locked at 180° intervals to be rigid, or unlocked to be swivel, and allow the unit to be extremely mobile for easy transport between classrooms.

Impression 30 Imaging Laptop Cart

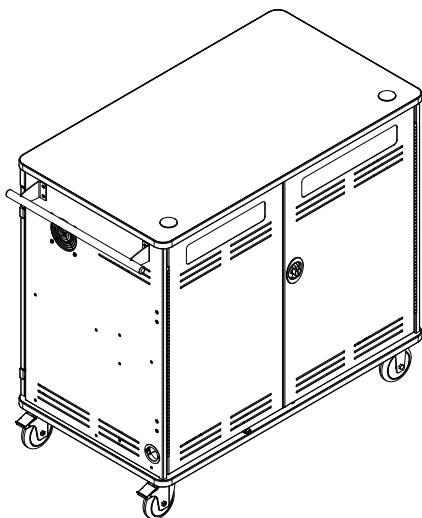
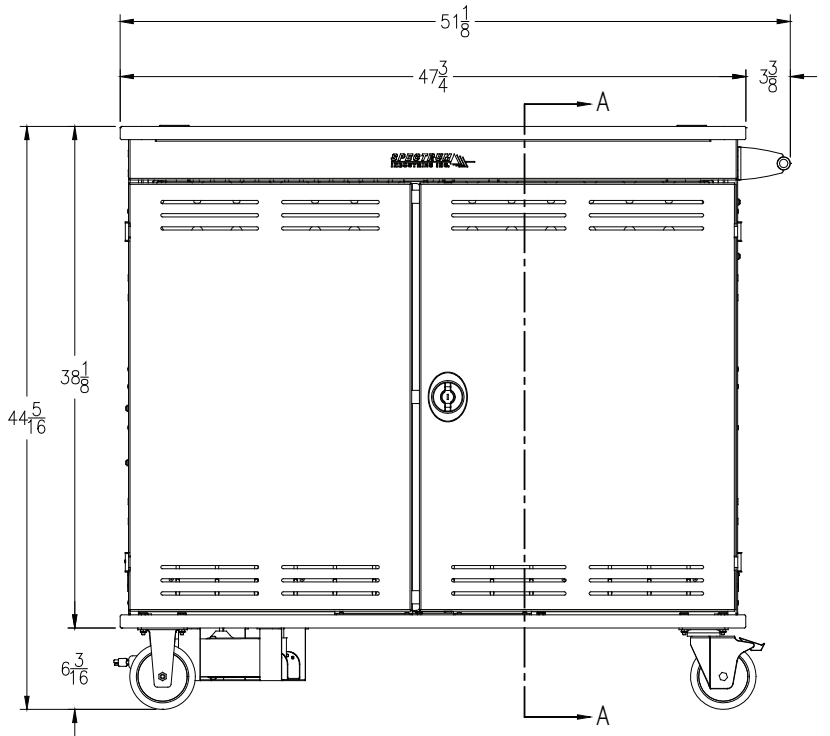
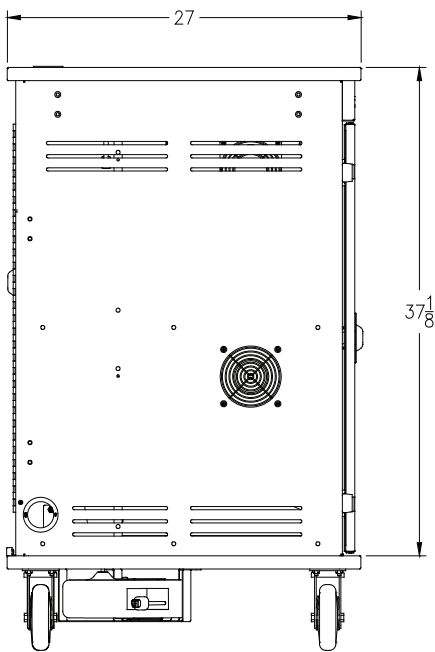
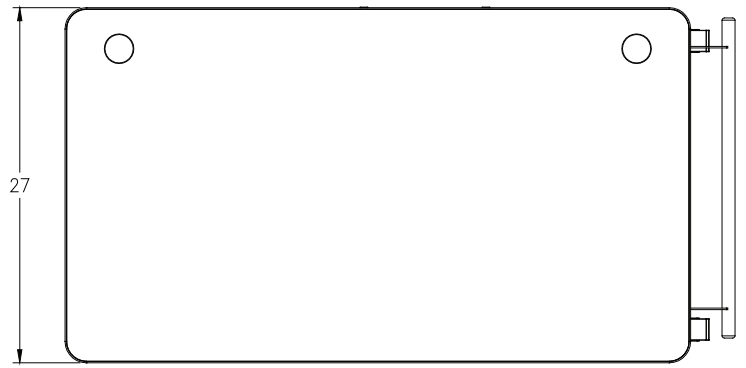
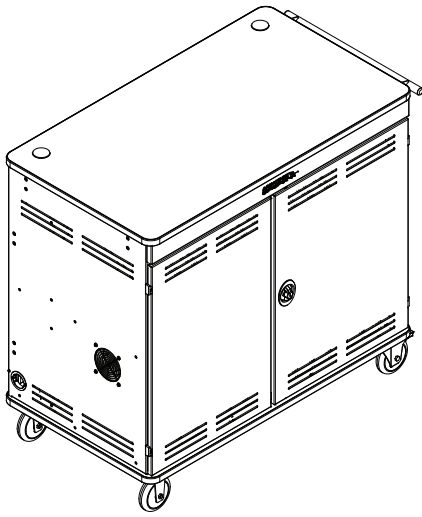

instructor-side view

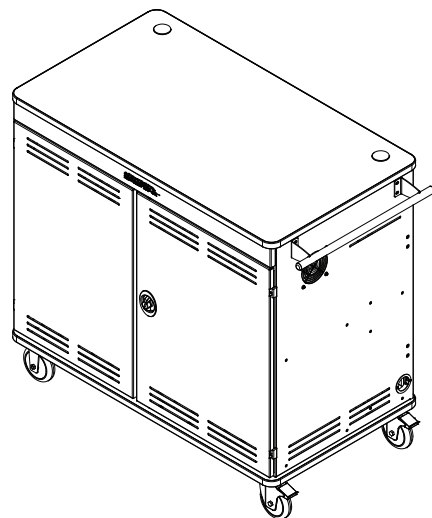

student-side view

The pull-down wire trays provide easy access to power cords. After the cords are in place, the trays flip-up and lock into a horizontal position.

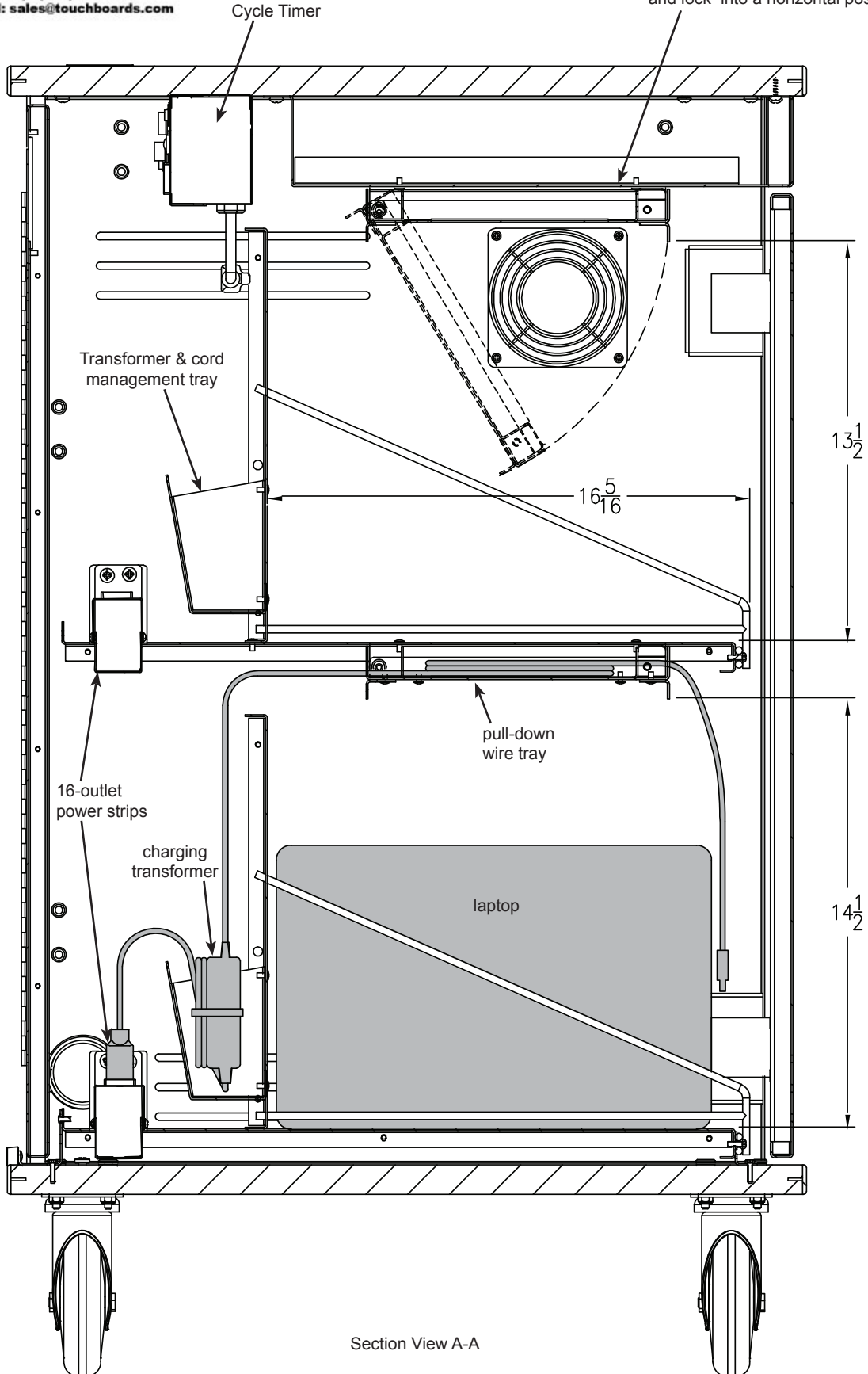

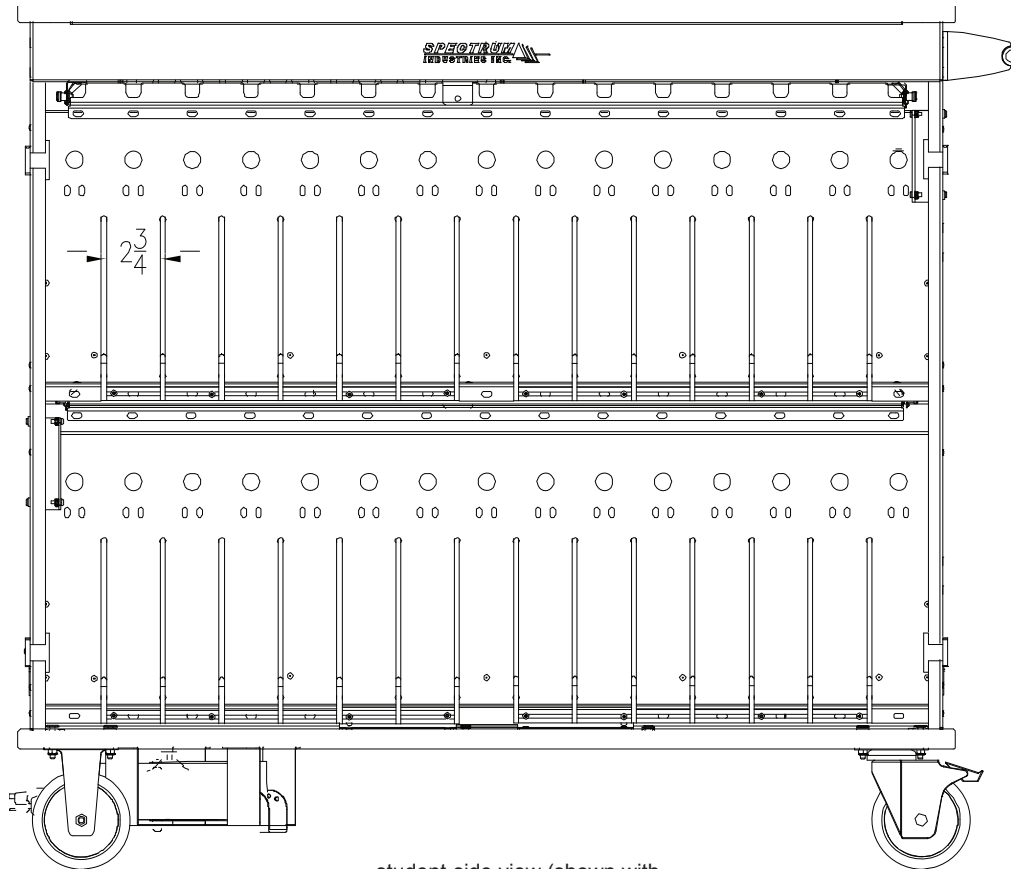

student-side view (shown with doors removed for clarity)

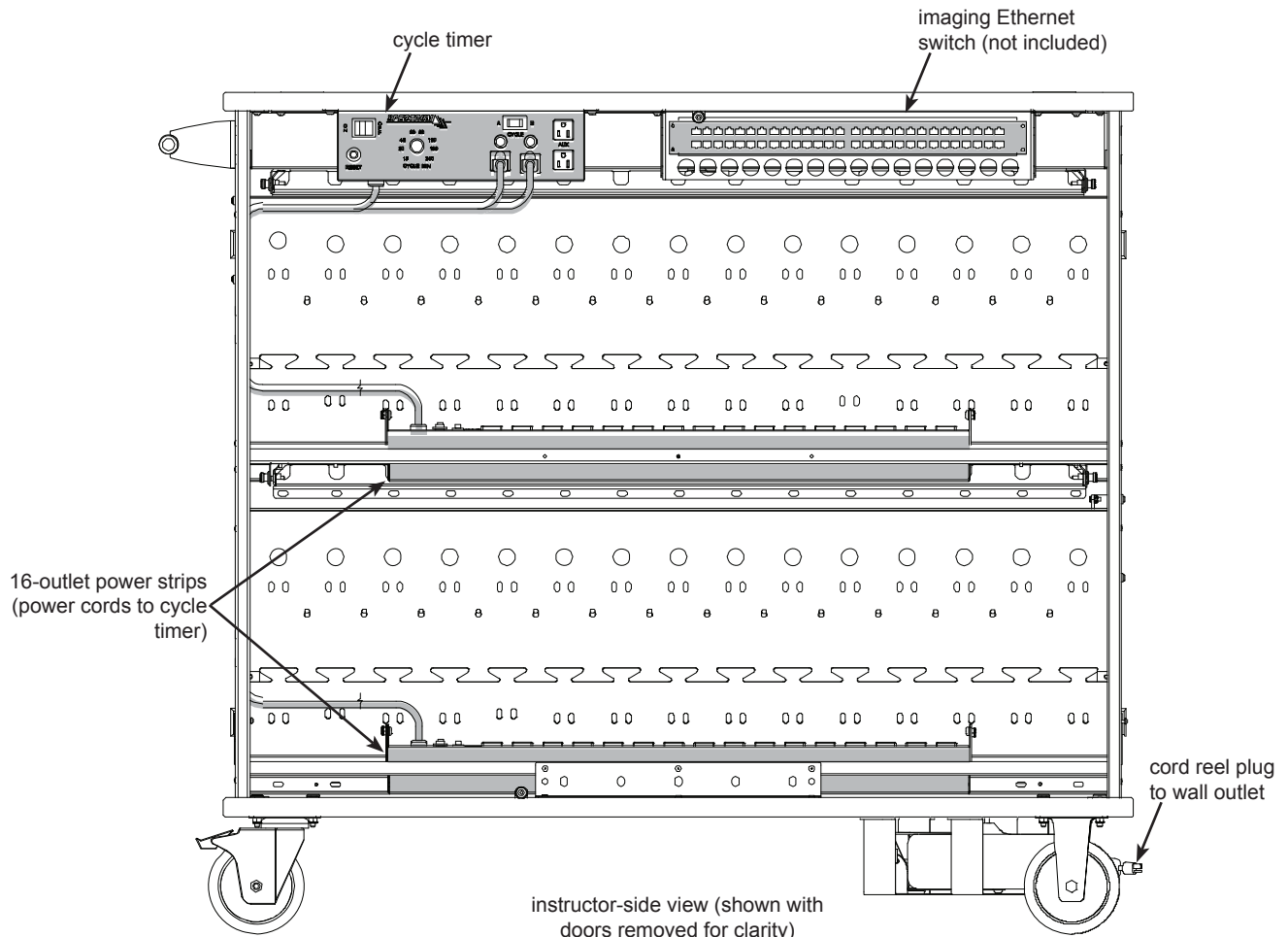

instructor-side view (shown with doors removed for clarity)

Optional Cycle Timer

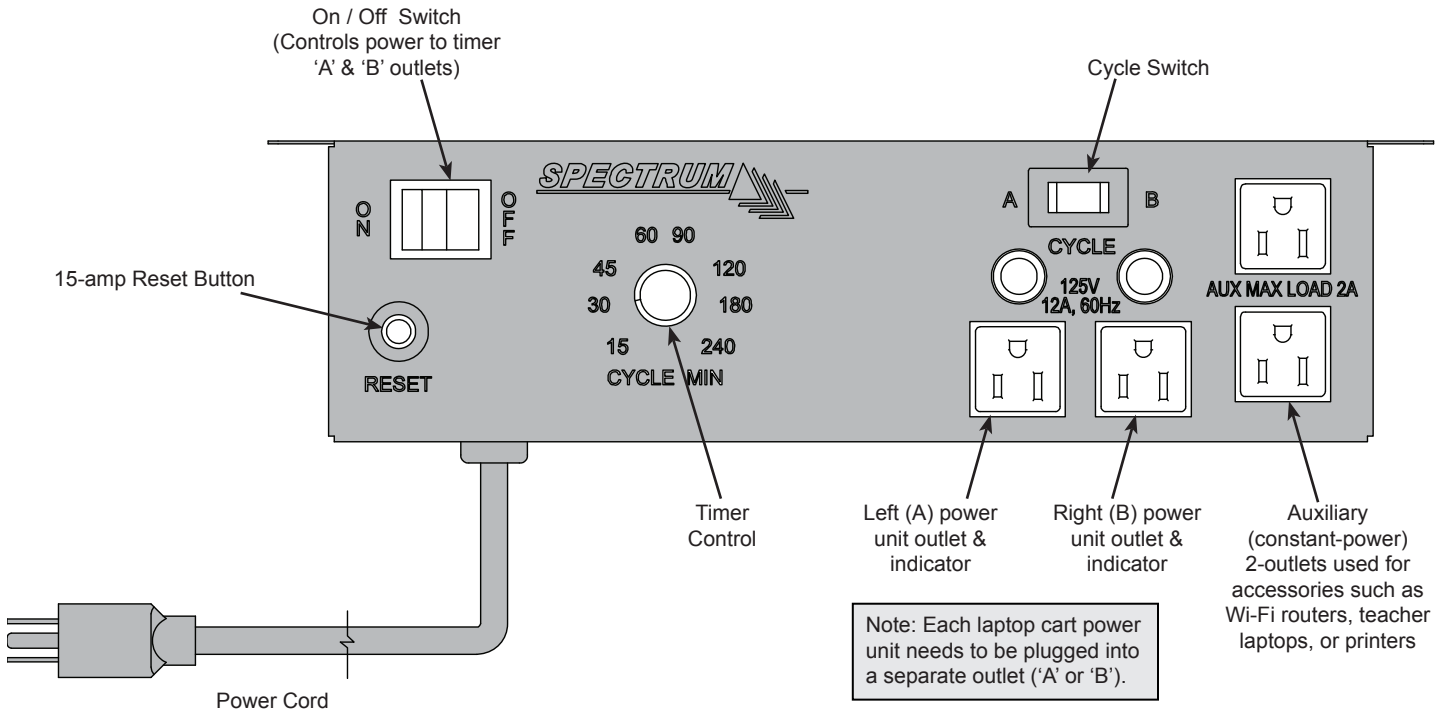

Using Timer

The timer prevents overload by alternating power between both power units in the cart, providing charging to multiple laptops during the day. The power units plug into the outlets labeled 'A' or 'B'.

The timer control can be adjusted between 15-240 minutes. This is the number of minutes a power unit will be "hot" before the timer switches to the other power unit. 15 minutes can be used as the default setting, but the time setting will depend on the laptop size, battery capacity, frequency of laptop use, and the time available for charging between uses. Lower minute settings should be used if the laptops are being used more frequently.

- To cycle charge both 'A' and 'B' sides, keep the cycle switch in the middle 'Cycle' position, then set the timer control to the desired cycling increment. After the side 'A' time expires, the timer will activate side "B" for the same period of time and will continue to cycle until the On/Off switch is set to the "OFF" position.
- To manually-override the timer function, and charge side 'A' only, switch the cycle switch from the middle to the 'A' position.
- To manually-override the timer function, and charge side 'B' only, switch the cycle switch from the middle to the 'B' position.

Specifications

- 12-amp, 120 volt, 60Hz
- 15-240 minute timer
- 14 AWG power cord

⚠ CAUTION ⚠

- Do not use the auxiliary outlets to charge multiple laptops (use the 'A' and 'B' outlets only.) Auxiliary outlets are for peripheral use only.
- Switch the timer power switch OFF before unplugging or plugging-in the main power unit plugs
- Total equipment load not to exceed 12-amps per power unit.
- For indoor use only. Do not install or store the unit where it will be exposed to weather. Keep dry.
- For added safety, plug the timer into a grounded three-prong receptacle controlled by a GFI (Ground Fault Interrupter) circuit breaker.

Warranty

WE WILL MAKE IT RIGHT FOR YOU!

Spectrum is committed to provide complete customer satisfaction. Each of our products are manufactured from the best materials available and each product is stringently monitored throughout the production process through our P.A.C.E. program (Product Assurance to meet Customer Expectations). Our Customer Service Help Line 1-800-235-1262 is ready to provide immediate attention to any questions, comments or concerns. We are available to answer your calls Monday through Friday from 7 am to 5 pm CST, excluding observed holidays. In addition your product comments or concerns are welcome via e-mail at: spectrum@spectrumfurniture.com.

Warranty Statement

We guarantee all Spectrum products to be free of all defects in materials and workmanship, for the original owner, for a period of ten years. Any item deemed defective by Spectrum or the original manufacturer, under normal use conditions, will be repaired or replaced at Spectrum's discretion. This warranty applies to all products manufactured and distributed by Spectrum except the products listed below.

Items that have a varying warranty include, but are not limited to, the following:

- Adjustable Crank/Electric Desk Legs (1 yr)
- Flat Panel Desk Gas Cylinders (1 yr)
- Upholstered Soft-Goods (5 yrs)
- Adjustable Height & Stacking Chair Parts – including frames, gas cylinders, wood and plastic parts, and control handles (7 yrs)
- Adjustable Height & Stacking Chair Casters (2 yrs)
- Chair Upholstery & Textiles (2 yrs of normal use of Soft Goods, Adjustable Height, Stacking, Wood and Metal Chairs)
- Chair Upholstery - Graded-In Fabrics and C.O.M (no warranty)
- Height Adjustable Columns and Lifts (1 yr)
- General Use Casters (1 yr)
- Electrical – Electri-Pak, Power Communication Modules, and special order ECA electrical items (1 yr)
- Electrical - Power Strips & Electrical Timers (1 yr)
- Electrical Surge Suppressors (lifetime)
- Electrical - Retractable Power Cords (1 yr)
- Keyboard/Mouse Trays (1 yr)
- Flat Panel Monitor Arm – General Parts (5 yrs)
- Flat Panel Monitor Arm – Gas Cylinders (2 yrs)
- CRT Monitor Arm (1 yr)

Warranty is void if product is not used for its intended purpose or subjected to an unusual application, multiple-shift use, alteration, accident, abuse or abnormal wear and tear. Representations of colors on-line and in printed materials are meant to be a close reference to the actual colors but not an exact match. Slight variations in color and texture of wood stains, powder coating, laminates, fabrics and other materials are normal in different manufacturing lots; as such these variations are not considered defects.

DESIGNED FOR INDOOR USE ONLY – Unless specifically stated in the product specifications, Spectrum's products have been designed and constructed for indoor use only. Moving or using outdoors, or on excessively rough surfaces, may cause damage to the products and will void the warranty. If an outdoor application is desired please contact us to discuss potential custom design solutions.

The warranty, as stated above, supersedes any previous warranties and is effective as of 9/1/2010



205 Westwood Ave, Long Branch, NJ 07740
Phone: 866-94 BOARDS (26273) / (732)-222-1511
Fax: (732)-222-7088 | E-mail: sales@touchboards.com



INDOOR AIR QUALITY
Indoor Advantage | Furniture

