

Technical Specifications

55260	Standard Media Director V2
55259	with Overbridge Control Console™ (also requires 96507 insert panel)

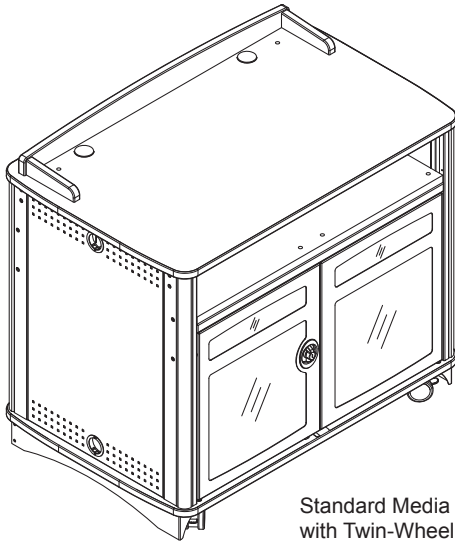

Standard Media Director V2
with Twin-Wheel casters
55260TW

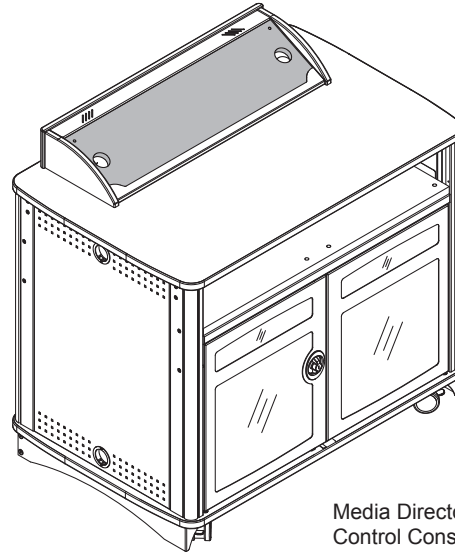

Media Director V2 with Overbridge
Control Console and Twin-Wheel casters
55259TW
shown with optional insert panel (shaded)

Spectrum's Media Director is designed to simplify the use and integration of a multi media lectern. We've designed the Media Director so that integrating podium lecterns couldn't be easier. A total of 52 rack units of rack rail are easily accessible from both front and rear to offer flexibility for the audiovisual setup of your choice. Quick-release doors and coordinated pass-through grommets simplify integration even further. Need to use monitor arms or a power/communication module? The Media Director includes standard cutouts on the worksurface for 2 arms and 1 module that double as grommets when not used. Overbridge models use an overbridge console specifically for the installation of training and presentation controls. Don't limit your integration potential – let the Media Director help you achieve your AV goals.

Features and Benefits

- Front and rear rack-rail equipment mounting simplifies installation for any equipment configuration with enough space for an internal CPU
- Standard rack rail brackets allow the front and rear rack rails to be moved further inside the unit, if necessary, to accommodate larger knobs and plugs
- Double-bolt, keyed locking front and rear doors provide security and easy-access
- Blank overbridge console version allows custom cutouts and installation of presentation controllers
- 3" swivel locking Twin-Wheel (TW) casters, and Toe Kick (TK) versions available
- Quick-release door hinges allow doors to be removed for full-access
- Removable acrylic viewing / access panel on the front door provides easy monitoring and access to internal equipment
- Ventilated side panels keep equipment cool
- Audience-side vented openings provide enhanced sound quality when speakers are installed
- Scratch and impact resistant 1" high-pressure laminate worksurface
- Two 2" cable grommets (left and right) on the worksurface or overbridge provide cable access
- Cable grommets throughout the unit keep wires and cords manageable
- Removable acrylic viewing / access panels on the front doors provide easy monitoring and access to internal equipment
- With enough storage space for an internal CPU, left or right-mountable rack-rail simplifies installation for any equipment configuration
- Pre-drilled left and right monitor arm mounting holes allow easy installation of a monitor arm
- Quick-change logo panel simplifies adding or changing logos
- Optional adjustable-height, flip-up shelf provides a convenient additional worksurface
- Optional steel handle provides easy mobility
- Wide variety of options and accessories allow unit to be configured to most situations
- SCS Indoor Advantage Certified; meets or exceeds applicable ANSI-BIFMA test standards
- Warranted to be free of all defects in materials and workmanship for 10 years, electrical system 2 years
- Designed and assembled in Chippewa Falls, WI, USA

Base Options

TW - 3" Twin-Wheel casters
TK - Toe Kick

Color Options

See spectrumfurniture.com for complete color options and combinations.

Construction

- The worksurface, mid, and base panels are constructed from 1" thick NAF (No Added Formaldehyde) composite board with .030" high-pressure laminate on one face, and a balancing phenolic backer on the opposing face
- Metal components consist of 16-gauge and 20-gauge steel
- 16-gauge steel doors and corner columns
- Worksurface edges are covered with 3mm vinyl
- All metal components are finished with a scratch-resistant powder coat epoxy
- Solid wood corner trim
- Each Media Director V2 Lectern is factory-assembled with casters, packaged, and shipped on its own skid

Specifications

Total internal area (mid section)	39.625"W x 27.75"D x 6.375"H
Total internal area (lower section)	39.625"W x 27.25"D x 24.9375"H
CPU area	12"W x 25"D
Standard rack rail	52RU (four sets of 13RU)
3" Twin-Wheel casters	weight capacity 165 lb each
Optional flip-up shelf	23"W x 27.75"D x 1" thick, can support a maximum of 50 lb. Shelf hinges lock into place in the upright position, Adjustable height
Worksurface grommet	7.25"W x 3.875"D
Available cutout area in blank overbridge panel	26.25"W x 8.1875"D
Unit weights (nominal)	254 lb - with casters and surround 274 lb - with toe kick and surround 235 lb - with overbridge
Shipping weights (nominal)	334 lb - with casters and surround 354 lb - with toe kick and surround 315 lb - with overbridge

Specifications subject to change without notice

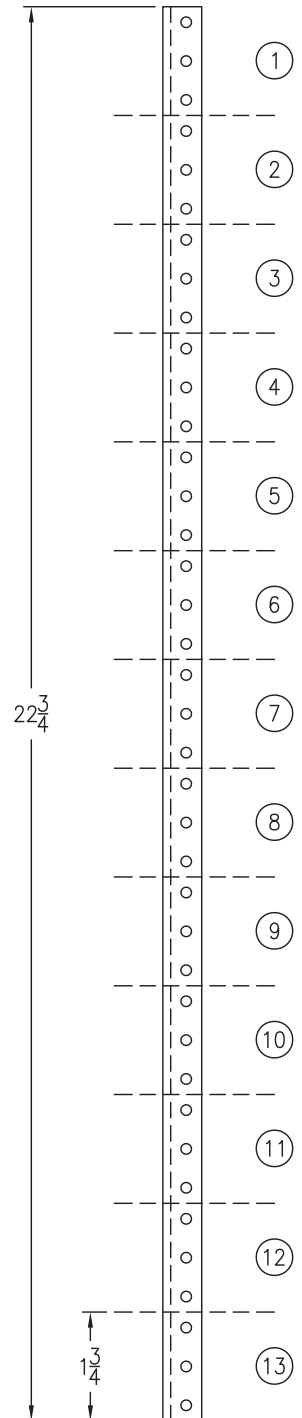
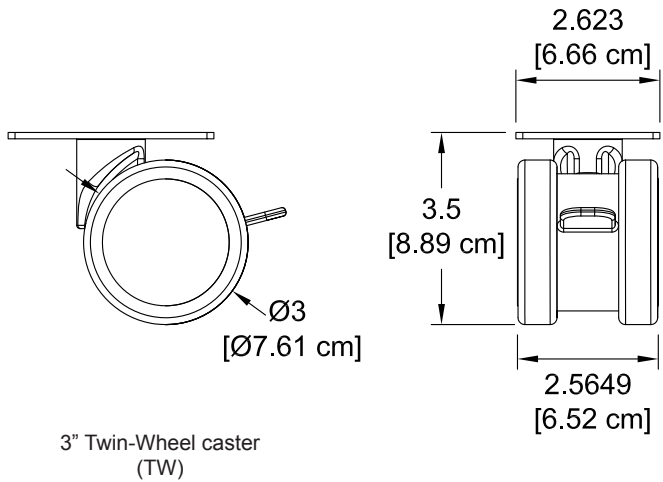

13RU available

Models

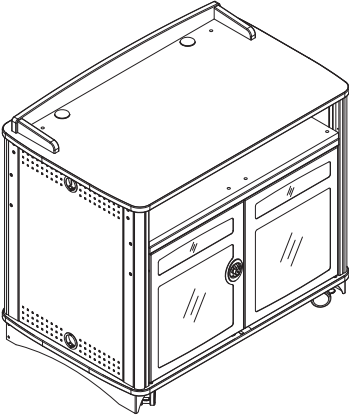
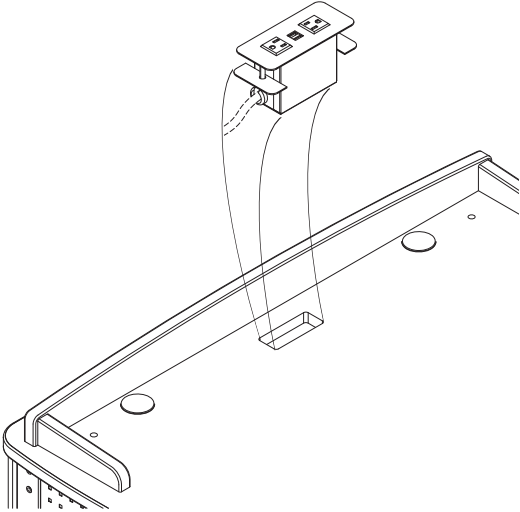
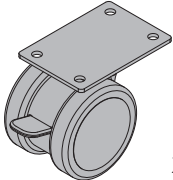
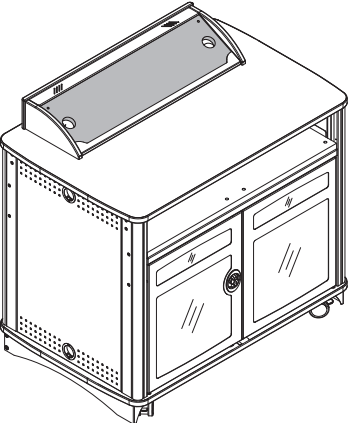
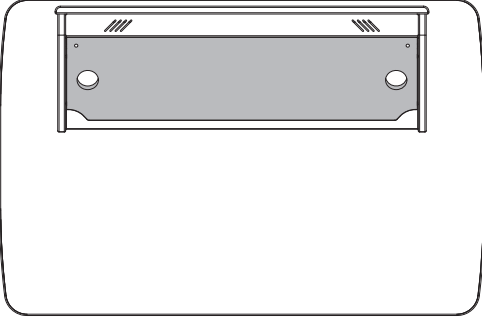
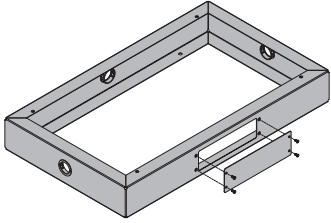
	Worksurface:	Base Options:
<p data-bbox="219 289 461 312">Standard MDV2 Lectern</p>  <p data-bbox="493 1083 553 1106">55260</p>	<p data-bbox="938 342 1130 443">99044 Optional Cove Power Module requires custom worksurface cutout</p>  <p data-bbox="605 982 1122 1106">Surround worksurface can be modified with a 5.25"W x 2"D cutout to accept an optional Cove Power Module (not included). Worksurface includes two 2" grommet holes with covers for routing cords from worksurface, and two .375" holes with plugs for optional monitor arm mounting.</p>	 <p data-bbox="1386 728 1422 751">X 4</p> <p data-bbox="1211 779 1474 802">(TW) 3" Twin-Wheel casters</p>
<p data-bbox="175 1142 509 1192">MDV2 Lectern with Overbridge Control Console</p>  <div data-bbox="131 1709 553 1829" style="border: 1px solid black; padding: 5px;"> <p data-bbox="142 1719 548 1818">Note: The insert panel shown (<i>shaded</i>) is <u>not</u> included with the lectern or overbridge. This option needs to be ordered separately to complete the overbridge.</p> </div> <p data-bbox="493 1892 553 1915">55259</p>	 <p data-bbox="605 1734 1122 1808">Overbridge with blank insert panel for custom cutouts (see p.8 for dimensions). Overbridge is not available separately. Includes two 2" grommet holes with covers.</p>	 <p data-bbox="1227 1493 1451 1516">(TK) Standard Toe Kick</p>

Media Director V2 with TW casters and surround
 (shown with optional handle, flip-up shelf, pull-
 out drawer, and adjustable keyboard tray)

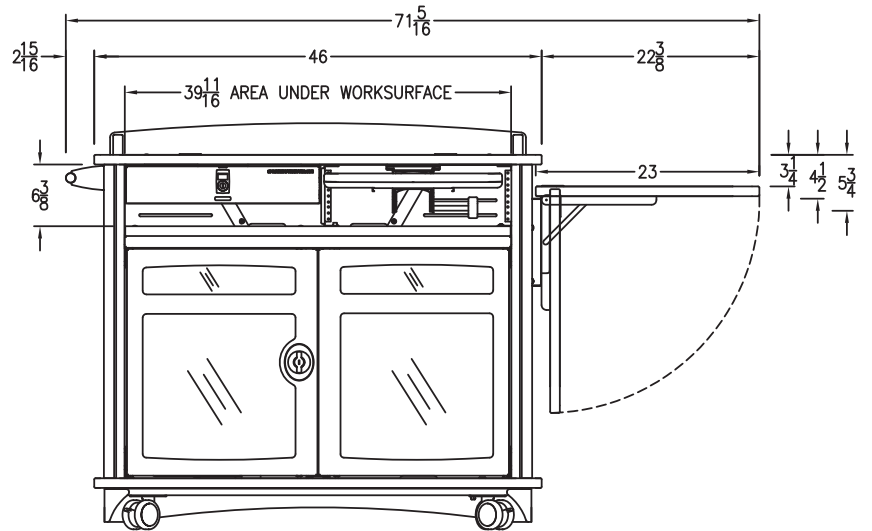
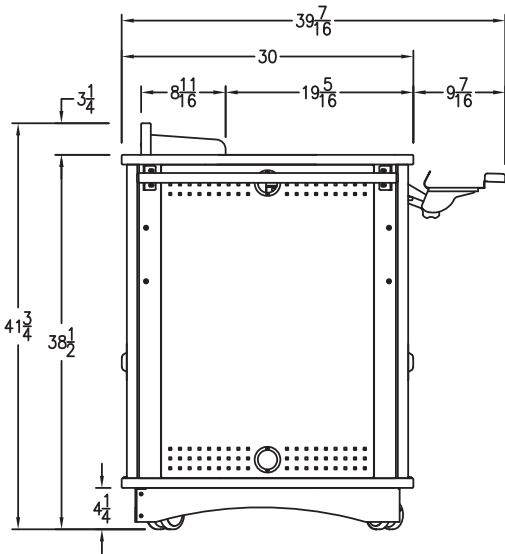
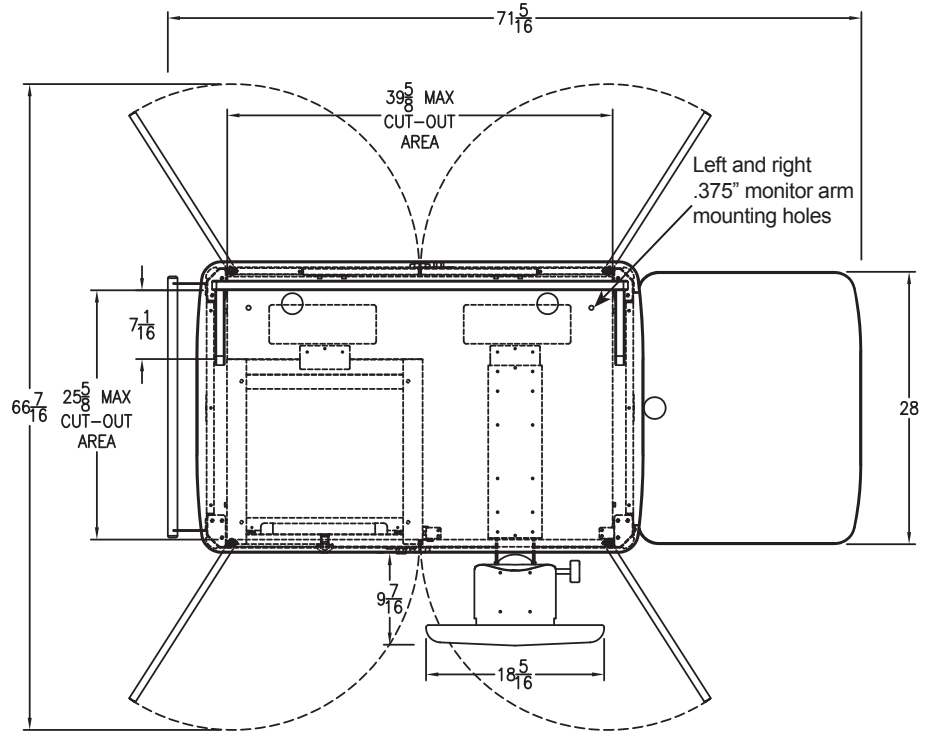
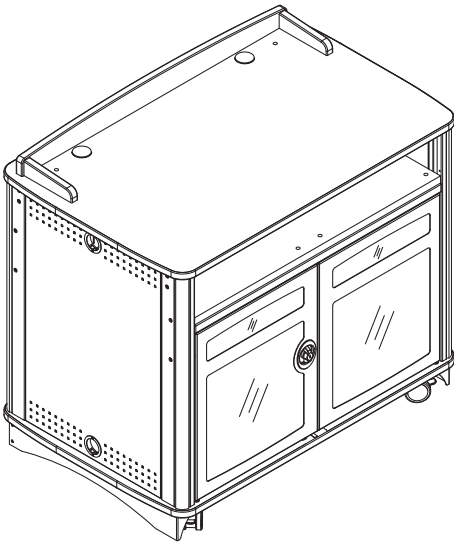

Note: Modified worksurface cutouts should be reviewed by Spectrum to ensure clearance of brackets, keyboard slides, or other objects under the worksurface.

Media Director V2 with Toe Kick and surround
(shown with optional keyboard tray)

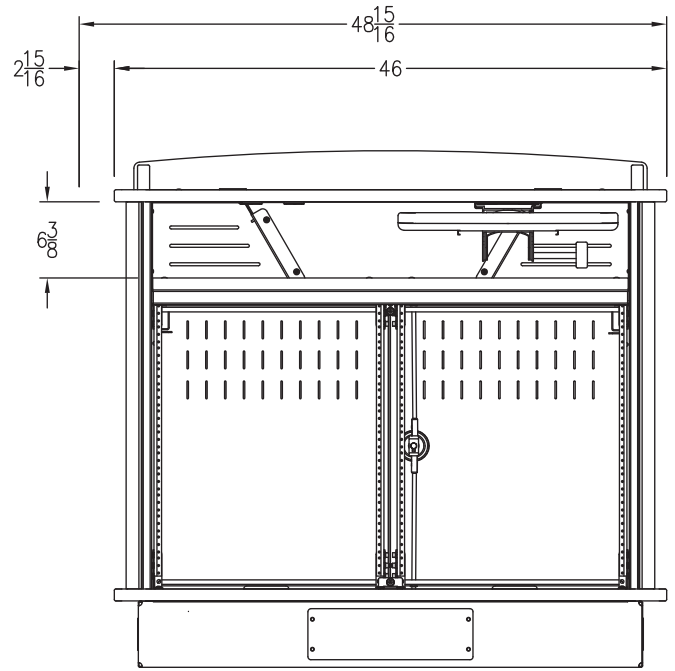
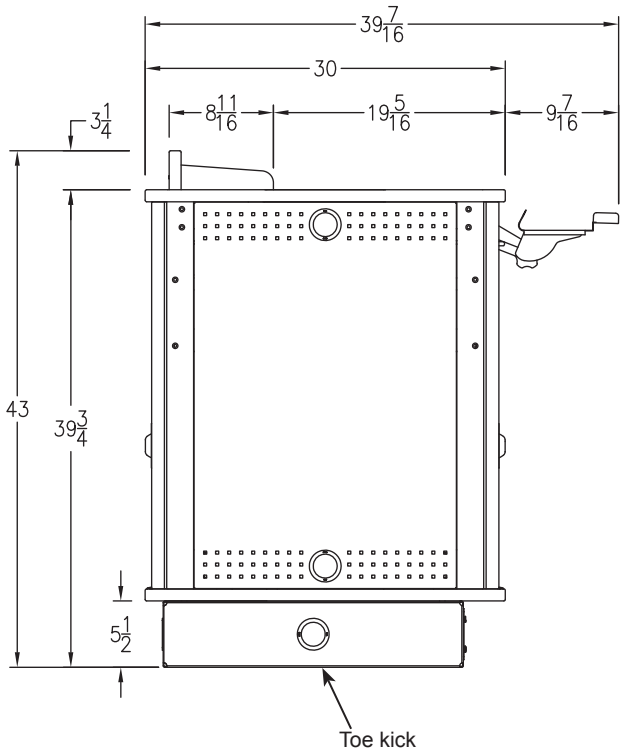

(shown with doors removed)

Media Director Lecterns include two mid-panel cutouts measuring 11"W x 4"D to rack rail area below

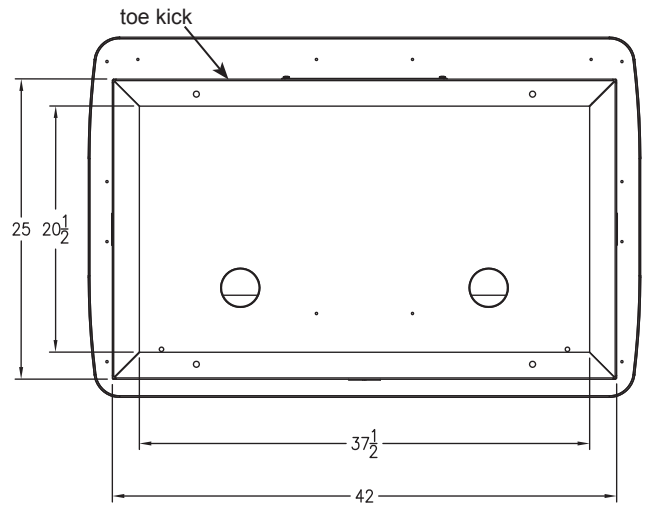
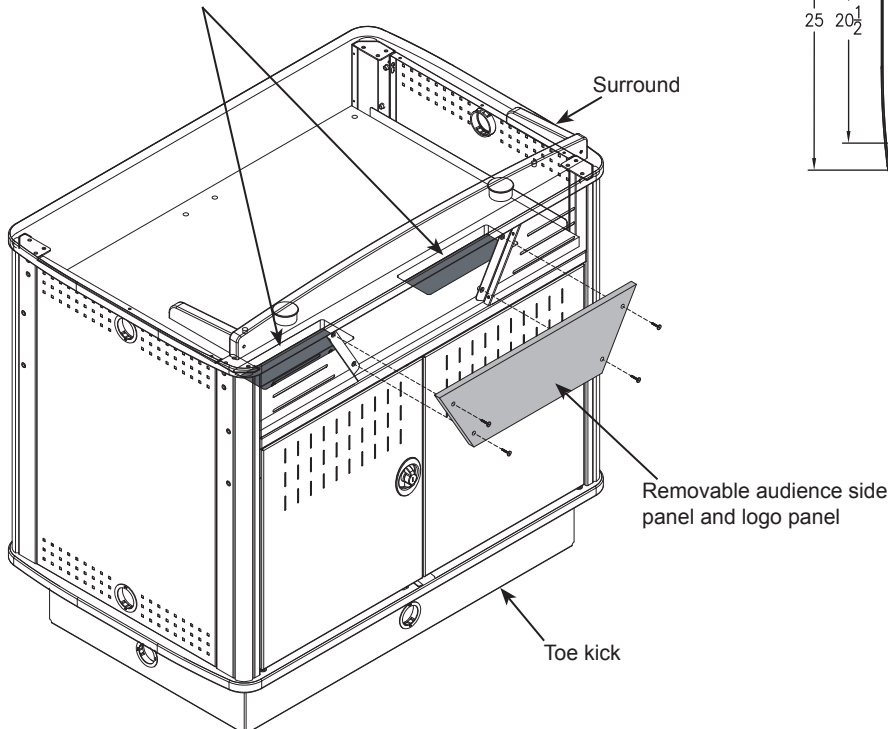

Bottom view

Media Director V2
section view

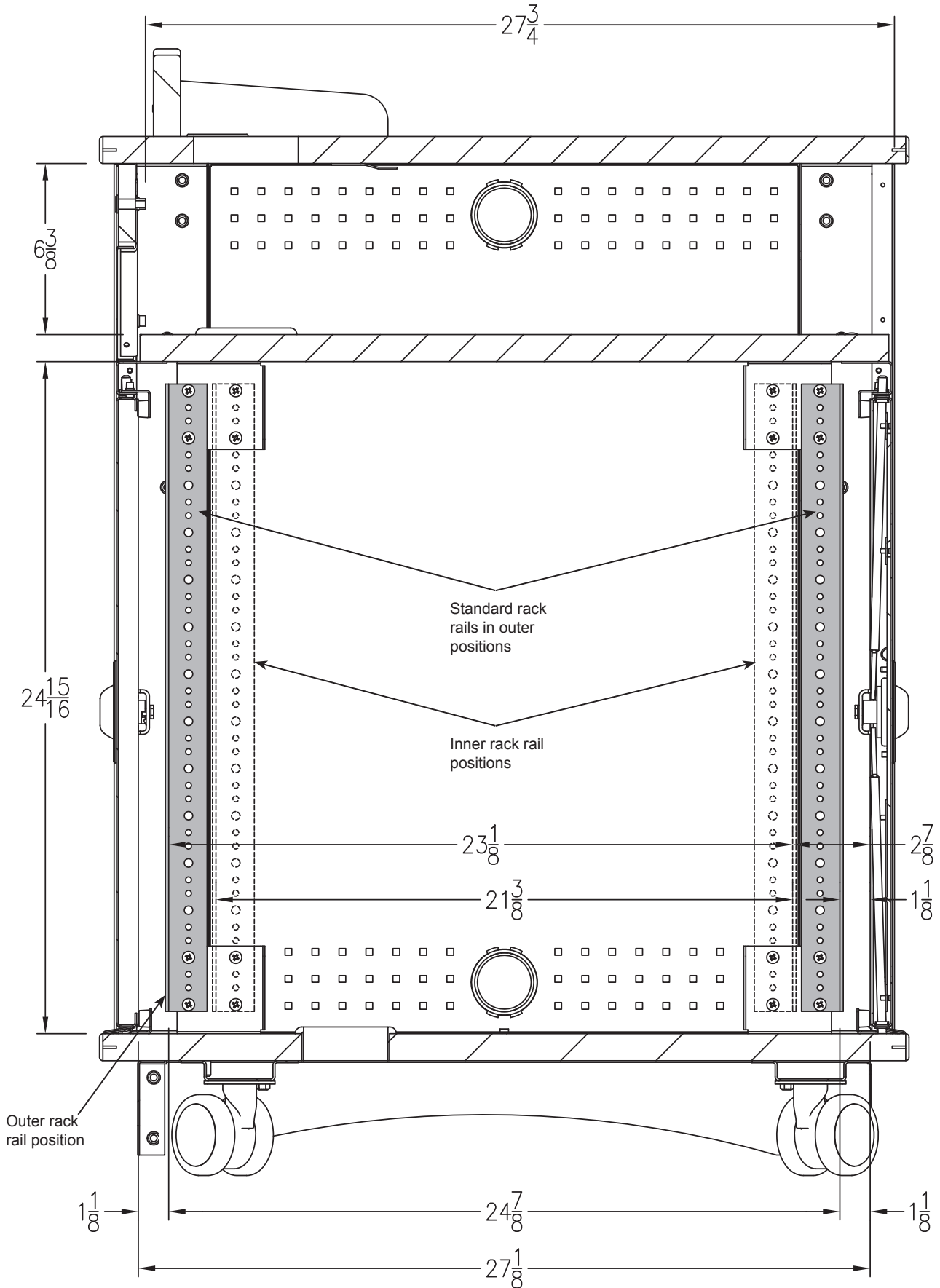

Media Director V2 with Overbridge
Control Console and twin wheels

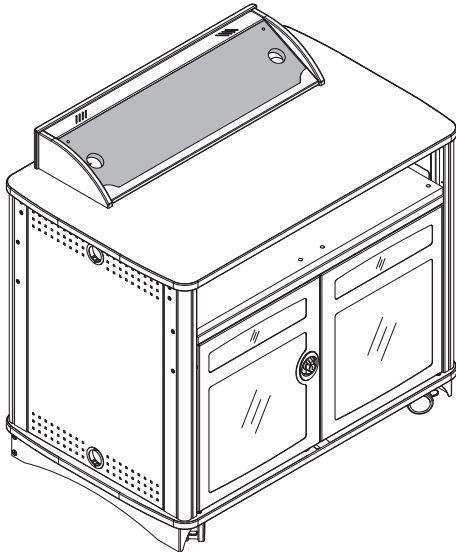

Note: The insert panel shown (*shaded*) is not included with the lectern or overbridge. This option needs to be ordered separately to complete the overbridge.

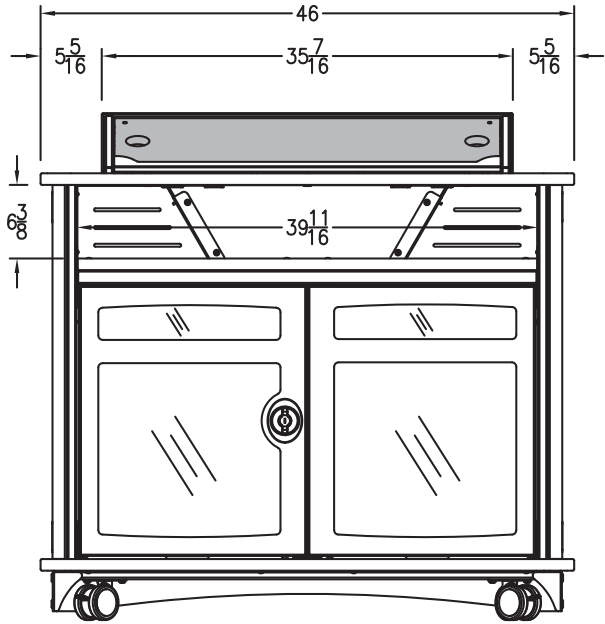
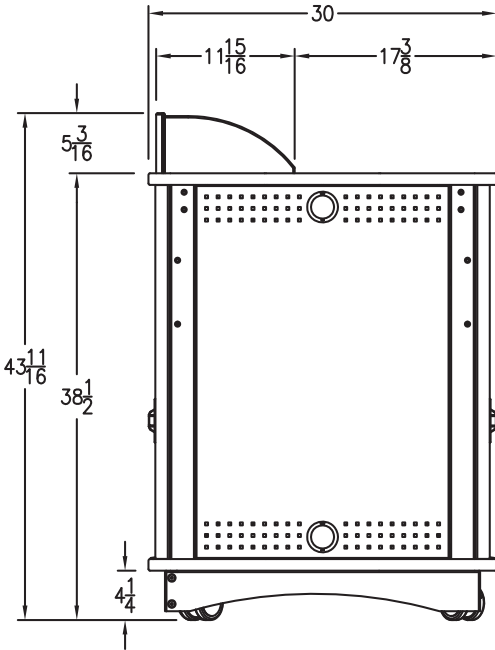
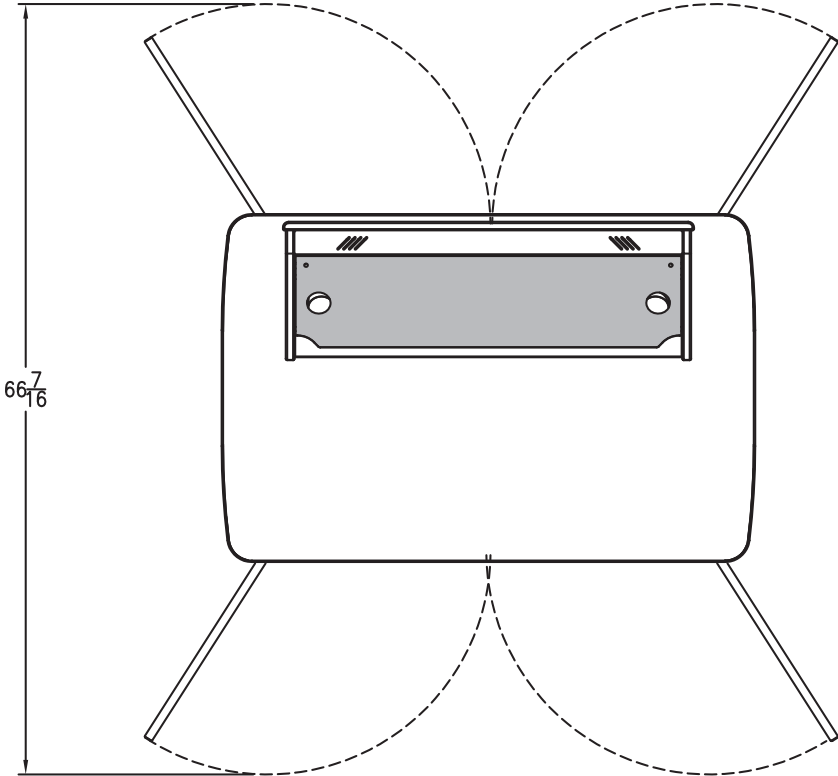

Media Director V2 overbridge panel blank
(flat view)

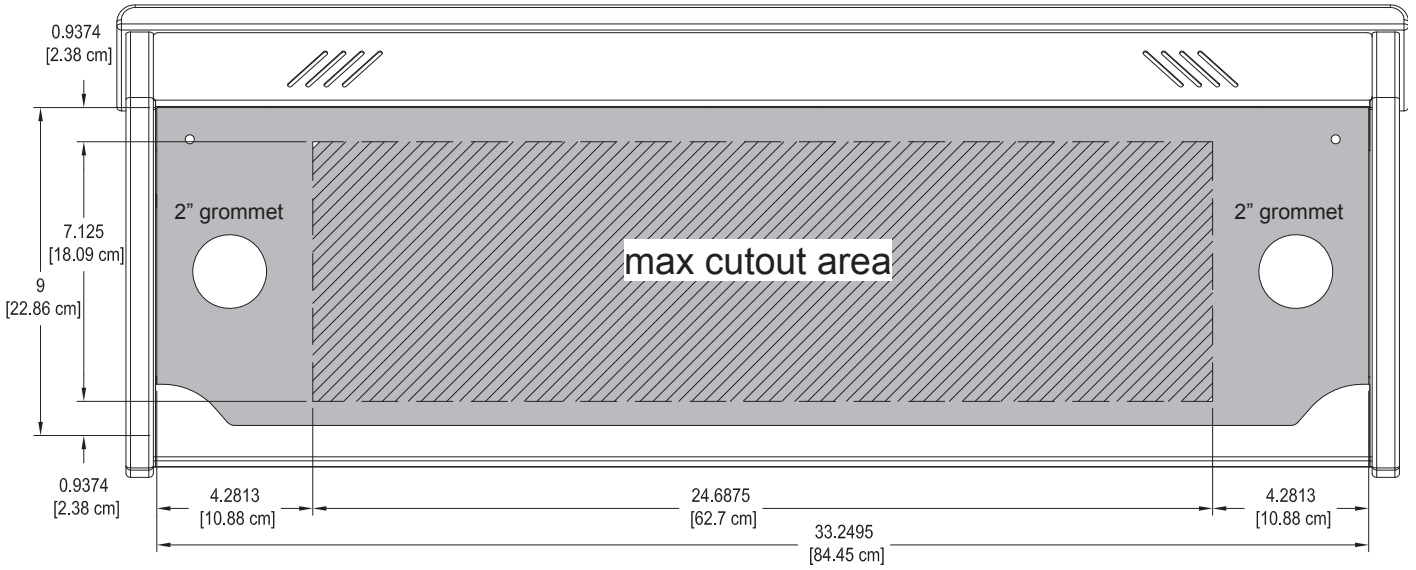

Note: The Overbridge Control Console™ has been designed for many of the currently available controllers on the market, however, modified cutouts should be reviewed by Spectrum to ensure clearance of brackets, keyboard slides, or other objects under the worksurface.

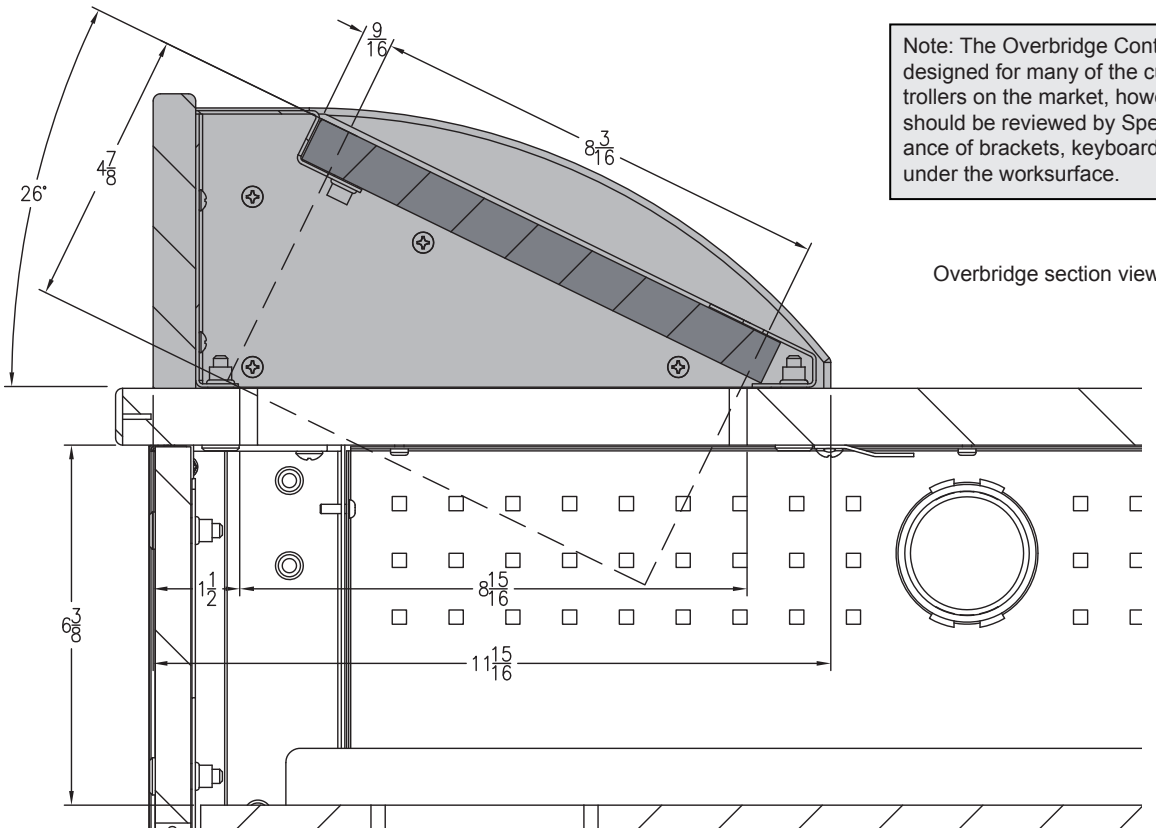

Overbridge section view

Note: The insert panel shown (shaded) is not included with the lectern or overbridge. This option needs to be ordered separately to complete the overbridge. This insert panel is horizontally symmetrical and can be easily removed, rotated, and re-installed if a cutout needs to be relocated to the opposite side of the overbridge.

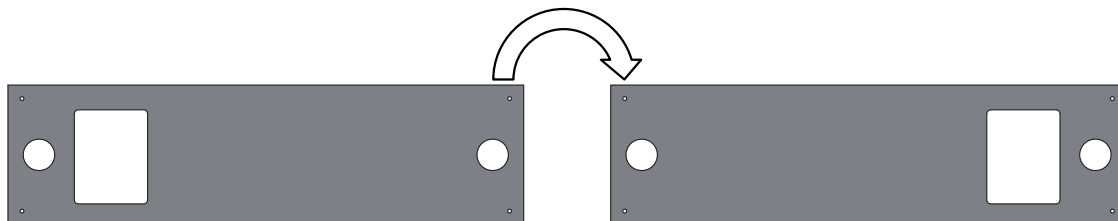

Accessories

Note: The flip-up shelf and steel handle can be mounted on either side of the lectern. Both can be mounted on the same side, but the shelf needs to be mounted in a lower position to provide enough clearance for the handle.

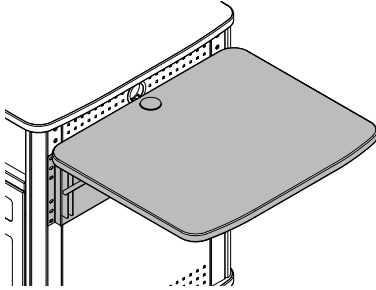

Flip-Up Shelf - 55263

(mounts on left or right side, max two per unit)
includes 2" grommet 23"W x 27.375"D
(35 lb max capacity)

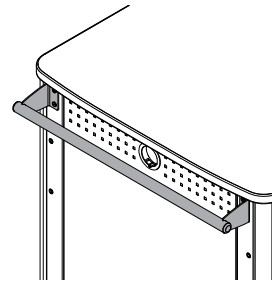

Steel Handle - 55265

(mounts on left or right side,
max two per unit)

Note: Power and communication wiring for document cameras, laptop computers, and/or projectors placed on the flip-up shelf should be routed on top of the audience-side of the shelf. Use of the shelf grommet hole for wiring will result in pinching of the cords when the shelf is folded.

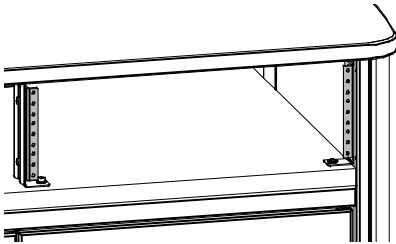

Upper Rack Rail Kit (3RU) - 55266

(max 2 per unit)

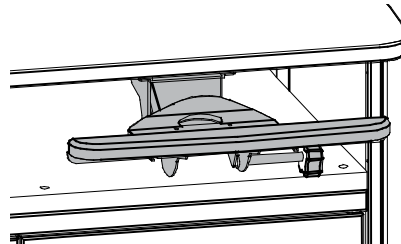

Adjustable Econo Keyboard Tray - 95520

18.375"W x 17.75"D
(max 2 per unit)

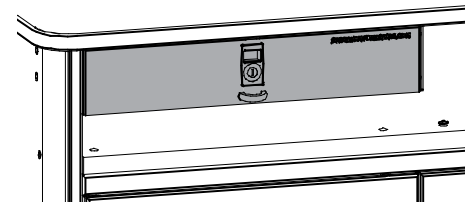

Pull-Out Drawer - 55264

18.813"W x 15.25"D x 3.125"H
(max 1 per unit)

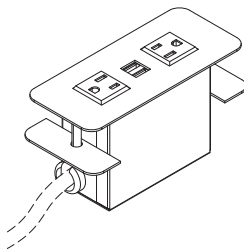

Cove Power Module - 99044

- Two power receptacles per module
- Two USB charge ports (not data-compatible)
- Thumbscrew clamps
- Requires worksurface cutout
- ETL listed
- Available in Black or Silver

Cutout required:	5.25"W [13.3 cm] x 2"D [5.1 cm] (mounts to surface thicknesses up to 1.5")
Power cord:	9' [274 cm] with 90° flat plug with 45° rotation
Power receptacles:	12A, 120 VAC spill-resistant
USB charging ports:	2.1A (10.5W)
Dimensions:	6"W [15.2 cm] x 2.5"D [6.35 cm] x 3.18"H [8.1 cm]
Unit weight:	2.29 lb [1 kg]

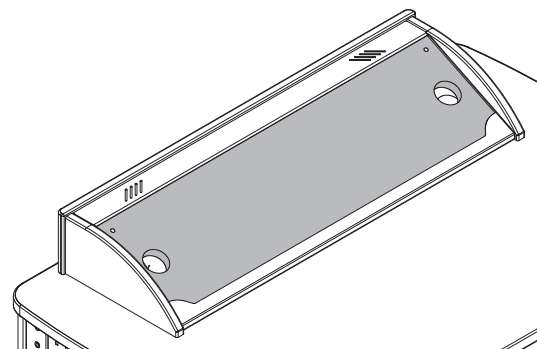

Overbridge Insert Panel 96507 - blank panel 96507mod - panel with cutout(s)

Required for overbridge version-contact Spectrum to specify cutout size(s) and position(s)
(overbridge not available separately)

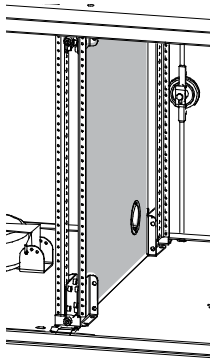

Security Panel - 55262

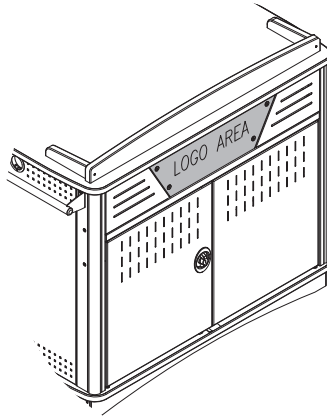

Custom-Cut Logo Panel - 55261
(audience-side)

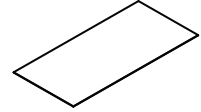

Non-Slip CPU Pad - 95518
11"W x 23"D

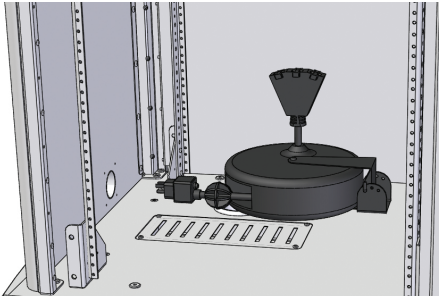



Retractable Cord Reel - 99029

15' [457.2 cm] retractable, 12 AWG, with breaker, (mounts horizontally inside lectern to base panel) 10 lbs [.45 kg]

⚠ The cord reel is intended to provide temporary access to electrical outlets for Spectrum mobile lecterns. Check local electrical codes prior to installation.

Note: When installed, the optional cord reel takes up 3RU from the bottom of the rack rail.

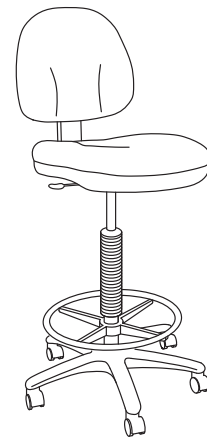

Adjustable Drafting Stool - 38202

- 40-52" height-adjustment via pneumatic cylinder
- 360° swivel
- Tilting backrest
- 18" diameter fixed foot ring
- 5-star base



Flat Panel Monitor Arm

- 95512** - "Light-Duty" for monitors weighing 2-13 lb [.9-5.9 kg]
- 95522** - "Medium-Duty" for monitors weighing 7.5-25 lb [2.5-11.4 kg]
- 95509** - "Heavy-Duty" for monitors weighing 12-31 lb [5.4-14 kg]
- Six mounting options (clamp, thru-desk, wall, grommet hole, side bolt, reverse wall)
- Compatible with all VESA® monitors – includes 75mm and 100mm VESA® adapters
- Cable management concealed in arm

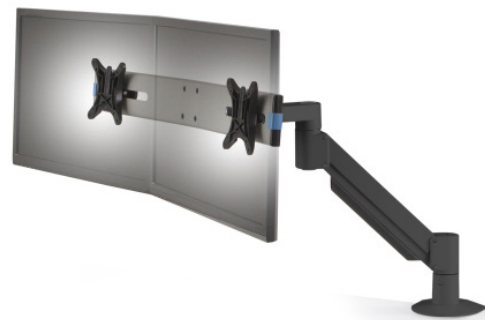

Dual Flat Panel Monitor Arm - 95533

- Weight range: 3.5-13 lb [1.6-5.9 kg] per monitor
- Six mounting options (clamp, thru-desk, wall, grommet hole, side bolt, reverse wall)
- Compatible with all VESA® monitors – includes 75mm and 100mm VESA® adapters
- Cable management concealed in arm

Rack-mount Accessories

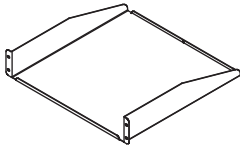

Cantilever Shelf - 2RU - 97504

- 16ga steel
- Shelf: 17.5"W [44.45 cm] x 18"D [45.7 cm] x 3.5"H [8.89 cm]
- Weight capacity: 50 lb [22.7 kg]
- Shipping weight: 8.1 lb [3.7 kg]

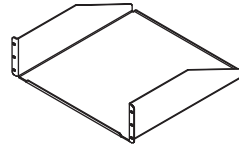

Cantilever Shelf - 3RU - 97502

- 16ga steel
- Shelf: 17.5"W [44.45 cm] x 18"D [45.7 cm] x 5.25"H [13.33 cm]
- Weight capacity: 80 lb [36.3 kg]
- Shipping weight: 9.2 lb [4.2 kg]

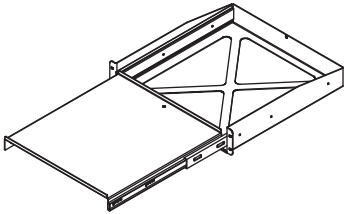

Pull-Out Shelf - 2RU - 97505

- 16ga steel
- 17.09"W [43.42 cm] x 18.12"D [46.03 cm] x 3.5"H [8.89 cm]
- Weight capacity: 50 lb [22.7 kg]
- Shipping weight: 15.6 lb [7.1 kg]

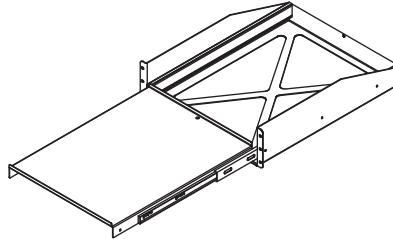

Pull-Out Shelf - 3RU - 97503

- 16ga steel
- 17.09"W [43.42 cm] x 22.11"D [56.14 cm] x 5.25"H [13.33 cm]
- Weight capacity: 80 lb [36.3 kg]
- Shipping weight: 18.5 lb [8.4 kg]

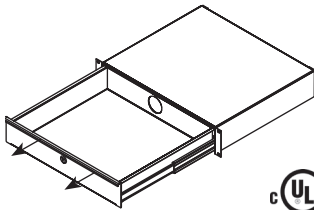

Locking Drawer - 2RU - 97523

- 16ga steel
- Drawer: 15.97"W [40.56 cm] x 14.56"D [36.98 cm] x 3"H [7.63 cm]
- Weight capacity: 50 lb [22.7 kg]
- Shipping weight: 15.85 lb [7.2 kg]

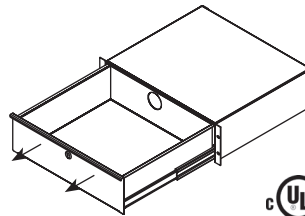

Locking Drawer - 3RU - 97522

- 16ga steel
- Drawer: 15.97"W [40.56 cm] x 14.56"D [36.98 cm] x 5.25"H [13.33 cm]
- Weight capacity: 50 lb [22.7 kg]
- Shipping weight: 18.5 lb [8.4 kg]

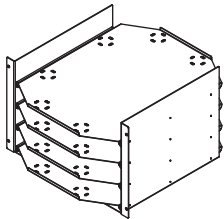

LT-4 Laptop Storage Unit - 7RU - 97517

- Holds four full-size laptops
- 16ga & 20ga steel
- 18.75"W [47.94 cm] x 20.5"D [52.11 cm] x 12.25"H [31.11 cm]
- Shipping weight: 30 lb [13.6 kg]

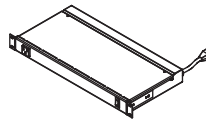

9-Outlet Power Strip - 1RU - 99021

- 8 outlets rear (breaker-protected)
- 1 convenience outlet front
- 115VAC, 60 Hz, 15 amps max
- 9' power cord
- Front LED power switch
- Enhanced surge protection
- ETL-listed, UL-listed
- 19"W [48.27 cm] x 9.25"D [23.5 cm] x 1.74"H [4.41 cm]
- Shipping weight: 8.7 lb [3.9 kg]

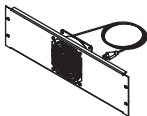

Single Fan - 3RU - 97507

- 50 cfm
- 120V~50/60 Hz, 15/13W
- RoHS
- 19"W [48.27 cm] x 1.56"D [3.97 cm] x 5.25"H [13.33 cm]
- Shipping weight: 3.78 lb [1.7 kg]

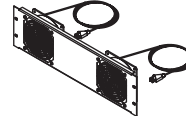

Double Fan - 3RU - 97506

- 100 cfm
- 120V~50/60 Hz, 15/13W
- RoHS
- 19"W [48.27 cm] x 1.56"D [3.97 cm] x 5.25"H [13.33 cm]
- Shipping weight: 5.47 lb [2.5 kg]

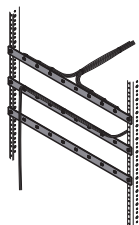

Wire Lace Kit - 95517

- Provides wire management
- Mounts to standard rack rails
- Includes (3) lace straps and mounting screws
- Includes (12) 5.5" zip ties
- Shipping weight: 1.25 lb [.57 kg]

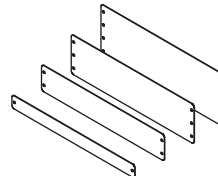

Rack-Mount Blanks

1RU - 97510 **3RU - 97512**
2RU - 97511 **4RU - 97513**

- Fills rack spaces where components are not needed
- 16 ga steel
- Shipping weight: <1 lb [.45 kg]

See spectrumfurniture.com for the latest accessories and detailed warranty information.

Warranty

We will make it right for you!

Spectrum is committed to provide complete customer satisfaction. Each of our products is manufactured from the best materials available and each product is stringently monitored throughout the production process through our P.A.C.E. program (Product Assurance to meet Customer Expectations).

We expressly warrant that Spectrum products will be of good quality and workmanship and free from defect for the period set out in the warranty table below from the date of delivery. This warranty shall not apply to defects or damage resulting from misuse, abuse, neglect, improper care, modification or repair not authorized by Spectrum, or any other cause outside the control of Spectrum. Spectrum will, at its sole option, either repair or replace the defective product.

This warranty is exclusive; no other warranty, written or oral, is expressed or implied. This warranty is given by Spectrum to Buyer and to no other person or legal entity. No Spectrum dealer, distributor, agent or employee is authorized to make any modification or addition to this warranty.

NOTWITHSTANDING ANYTHING TO THE CONTRARY, SPECTRUM WILL NOT UNDER ANY CIRCUMSTANCES BE LIABLE FOR INDIRECT OR LIQUIDATED DAMAGES, INCLUDING CONSEQUENTIAL, INCIDENTAL AND SPECIAL DAMAGES. IN NO EVENT SHALL SPECTRUM'S LIABILITY, WHETHER UNDER CONTRACT OR WARRANTY, IN TORT OR OTHERWISE, EXCEED THE PURCHASE PRICE RECEIVED BY SPECTRUM FOR THE PRODUCT AT ISSUE AND "RECALL ACTION" EXPENSES. SPECTRUM SHALL NOT BE SUBJECT TO ANY OTHER OBLIGATIONS OR LIABILITIES, WHETHER ARISING OUT OF BREACH OF CONTRACT, WARRANTY, TORT (INCLUDING NEGLIGENCE AND STRICT LIABILITY) OR OTHER THEORIES OF LAW, WITH RESPECT TO PRODUCTS SOLD OR SERVICES RENDERED BY SPECTRUM, OR ANY UNDERTAKINGS, ACTS OR OMISSIONS RELATING THERETO.

Our Customer Service Department is ready to provide immediate attention to any questions, comments or concerns. They are available to answer your calls Monday through Friday from 7 am to 5 pm CST. In addition your product comments or concerns are welcome via e-mail at: spectrum@spectrumspectrumfurniture.com.

Warranty Table

Item	Warranty Period
Adjustable Crank / Electric Desk Legs	• 1 Year
Flat Panel Desk Gas Cylinders	
Chairs <ul style="list-style-type: none"> • Adjustable Height Chair Parts – including frames, gas cylinders, wood and plastic parts, control handles, casters • Adjustable Height Chair Upholstery • In-Stock Upholstery • Graded-In Fabrics and Customer Owned Material 	<ul style="list-style-type: none"> • 7 Years • 2 Years • 2 Years • No Warranty
Height Adjustable Columns and Lifts	• 1 Year
General Use Casters	
Electrical (including timers and LINAK actuators)	• 2 Years
Keyboard / Mouse Trays	• 1 Year
Flat Panel Monitor Arms <ul style="list-style-type: none"> • Flat Panel Monitor Arm – General Parts • Flat Panel Monitor Arm – Gas Cylinders 	• 10 Years
Desks and Lecterns <ul style="list-style-type: none"> • Computer Desk Chassis • Cart Chassis • Lectern Chassis 	• 10 Years

