

# ANTHROCART®

AnthroCarts have been solving furniture challenges since 1984.

As the senior member of our product line, the AnthroCart continues to win new fans with its large selection of accessories, plus the flexibility and mobility you expect from Anthro. If you can't find your solution in our other product families, you're bound to find it in AnthroCarts.

## PRODUCT SPECIFICATIONS

**Shelves:** 1" thick 45 lb. industrial-grade particle board with high-pressure, scratch-resistant laminate. Vinyl contour edge banding coordinates with the metal color.

**Legs and Tubes:** 16 gauge steel, 1.5" diameter, with a baked-on, powder coat finish.

**Casters:** Soft rubber, black, twin wheel 2.375" casters; front two locking. 4" and 5" casters are also available (see AnthroCart: Accessories).

**Weight Capacity:** 150 lbs.

**Colors:** See Color Choices at the top of the following pages for available colors.

**Warranty:** Lifetime Warranty against manufacturing defects.



A large selection of accessories makes it easy for Mike to configure his UltraCompact Cart.

## ANTHROCART WORKSTATIONS

### 24", 30" AND 36" WIDE ANTHROCARTS



GT03BK shown above.

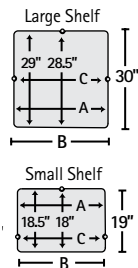

- Our most popular Cart since 1984! Shelves adjust to any height on the legs, and an open design makes it easy to access your equipment.
- Comes with 2 shelves (1 Large and 1 Small), 3 legs, 1 base tube and 4 casters (2.375" size, front 2 locking).
- Upgrade to 4" casters by adding a "4" to the end of your Cart's part number (Ex. GT03BN4). Upgrade to Glides by adding "GL" to the end of your Cart's part number (Ex. GT03BNGL).

PRODUCT	Height	Width (A)	Width (B)	Width (C)	Weight	Part #	Price
24"w x 30"d	28"	24"	25.25"	22"	56 lbs.	GT03xx	\$299
30"w x 30"d	28"	30"	31.25"	28"	67 lbs.	GT26xx	\$349
36"w x 30"d	28"	36"	37.5"	34"	77 lbs.	GT16NRxx	\$399

**QS** QuickShip available for 24"w and 30"w Anthrocart in Bone Laminate (BN) only.

### 48", 60", AND 72" WIDE ANTHROCARTS



H12BN shown above.

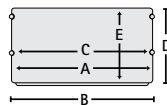

- The 48"w AnthroCart comes with 1 large shelf, 4 legs, 1 base tube, and 4 casters (2.375" size, front 2 locking).
- The 60"w and 72"w AnthroCarts come with 1 large shelf, 4 legs, a 1.5" deep front metal lip for strength and wrist support, 1 base tube, and 6 casters (2.375" size, front 2 locking).
- Upgrade to 4" casters by adding a "4" to the end of your Cart's part number (Ex. H12BN4). Upgrade to Glides by adding "GL" to the end of your Cart's part number (Ex. H12BNGL).

PRODUCT	Height	Width (A)	Width (B)	Width (C)	Depth (D)	Depth (E)	Weight	Part #	Price
48"w	28"	48"	49.25"	46"	30"	30"	80 lbs.	H12xx	\$419
60"w	28"	60"	61.25"	58"	32"	30"	110 lbs.	H24xx	\$539
72"w	28"	72"	73.25"	70"	32"	30"	122 lbs.	H31xx	\$639

**QS** QuickShip available for 48"w Anthrocart in Bone Laminate (BN) only.



205 Westwood Ave, Long Branch, NJ 07740  
 Phone: 866-94 BOARDS (26273) / (732)-222-1511  
 Fax: (732)-222-7088 | E-mail: sales@touchboards.com

6/13

## COLOR COMBINATIONS

Select your product colors from the following swatches. Replace "zz" with a 2-letter Metal Code and "xx" with a 2-letter Laminate or Combo Code.

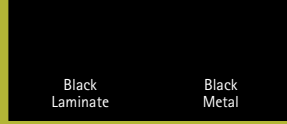

Black Combo (BK)

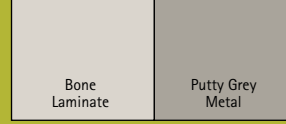

Bone Combo (BN)

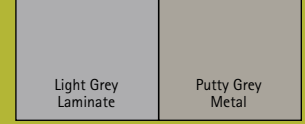

Light Grey Combo (LG)

## MINICART



GT23LG shown above.

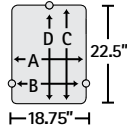

- Anthro's smallest cart, just 17.25" wide!
- Comes with 2 shelves, 3 legs, 1 base tube, and 4 casters (2.375" size, front 2 locking).
- Available in standard AnthroCart colors Black (BK), Bone (BN), Light Grey (LG) plus bonus colors Cool Grey/Fog (CG/FG) and Silver Satin/Blanc (SS/BC). Same price!
- Upgrade standard casters to 4" or 5" casters by adding a "4" or "5" to the end of the part number (Ex. GT23LG4); upgrade to Glides by adding "GL" to the end of the part number (Ex. GT23LGGL).

PRODUCT	Height	Width (A)	Width (B)	Depth (C)	Depth (D)	Weight	Part #	Price
MiniCart (standard colors)	28"	17.25"	15.5"	21.5"	20.5"	41 lb.	GT23xx	\$279
MiniCart (bonus colors)	28"	17.25"	15.5"	21.5"	20.5"	41 lb.	GT23zz/xx	\$279

MiniCart Bonus Colors:

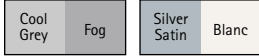

QuickShip available for MiniCart in Bone Laminate (BN) only.

## PRINTERCART

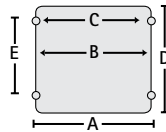

- Comes with 2 shelves, 4 legs, 1 base tube, and 4 casters (2.375" size, front 2 locking).
- Upgrade to 4" casters by adding a "4" to the end of your Cart's part number (Ex. 030BK4). Upgrade to Glides by adding "GL" to the end of your Cart's part number (Ex. 030BKGL).
- Add the 16" w Handle (see AnthroCart: Accessories) to make the Cart easier to maneuver. Try the Equipment Strap (see AnthroCart: Accessories) to hold your equipment securely in place.

PRODUCT	Height	Width (A)	Width (B)	Width (C)	Depth (D)	Depth (E)	Weight	Part #	Price
24"w x 28"h	28"	25.25"	24"	21"	21.5"	13"	54 lbs.	030xx	\$339

## ULTRACOMPACT CART



075BN shown above.

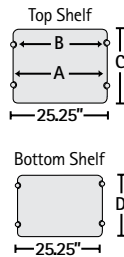

- Tucks away in the tightest spaces, even fits in closets! Can be stacked up to maximize your space with Extension Tubes and an Additional Shelf above (see AnthroCart: Accessories).
- Comes with 2 shelves (the top shelf is 3" deeper than the lower one), 4 legs, 1 retractable Keyboard and Mouse Caddy, 1 base tube, and 4 casters (2.375" size, front 2 locking).
- The retractable Keyboard and Mouse Caddy measures 19.5" w x 8" d. When put away underneath the top shelf, the Caddy gives the Cart an overall depth of 19.75" — when fully extended, it gives an overall depth of 26.75".
- Upgrade to 4" casters by adding a "4" to the end of your Cart's part number. Upgrade to Glides by adding "GL" to the end of your Cart's part number. (Ex. 075BN4)

PRODUCT	Height	Width (A)	Width (B)	Depth (C)	Depth (D)	Weight (2 boxes)	Part #	Price
UltraCompact	31"	23.75"	21.25"	18.75"	15.75"	42 lbs., 10 lbs.	075xx	\$569

## ANTHROCART ACCESSORIES

### CPU SOLUTIONS

#### CPU Roll-out

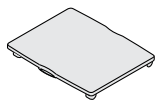

- These stand-alone shelves roll on 2" casters for easy access to your servers and CPUs.
- Holds up to 240 lbs.
- Available in Black (BK) and Light Grey (LG).

PRODUCT	Height	Width	Depth	Weight	Part #	Price
20" wide	3.75"	20"	23"	17 lbs.	CRS20xx	\$139.95

Not recommended for sit-down applications. Does not work with the MiniCart or UltraCompact Cart.

#### CPU Slide-out

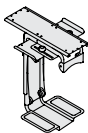

- Attach your CPU under your work surface and pull it out when needed. Rotate the CPU for easy access to the back.
- The adjustable cradle pulls in and out on a 16" track and holds CPUs 3"–9.5" wide, 12–22" high.
- Weight capacity of 70 lbs.
- Available in Black (BK).
- Drill required for installation.

PRODUCT	Weight	Part #	Price
CPU Slide-out	17 lbs.	347BK	\$119.95*

Does not work with 24" wide AnthroCart, IdeaCart, MiniCart, or UltraCompact Cart.

"We have always been pleased with AnthroCarts and are proud to offer them with our autonomic labs."  
 —Peggy S., V.P. Neurophysiology, WR Medical Electronics Co.



### CPU SideRacks

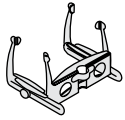

CPU SIDERACK 02



CPU SIDERACK W/ CASTER



CPU SIDERACK - SMALL FORM FACTOR

- Save room on the surface of your Cart by mounting your CPU on the inside or outside of your Cart's legs.
- Measure the width of your CPU, and add 3" to determine how far the SideRack will extend from the side of your Cart.
- Available in Black (BK) or Putty Grey (PG).

#### CPU SideRack 02

- Recommended for Carts 36" wide and larger. Adjusts to fit CPUs 4.5"–10" wide. Weight capacity of 50 lbs.
- Mounts at any height and lifts your CPU approximately 7.5" above the floor when attached in its lowest position.

#### CPU SideRack with Caster

- Recommended for Carts 24" and 30" wide. Adjusts to fit CPUs 4.5"–10" wide and attaches to the base tube. Weight capacity of 100 lbs.
- Comes with a 2.375" caster. If your Cart has larger Casters or Glides, order the same sized Caster for your SideRack as well.

#### CPU SideRack – Small Form Factor

- Adjusts 2.75"–4.25" wide, this smallest CPU holder attaches to the inside of any vertical tube with three fasteners.
- Holds up to 25 lbs.
- Available in standard AnthroCart colors Black (BK) and Putty Grey (PG). Also available in MiniCart bonus colors Silver Satin (SS) and Slate Blue (SB).

PRODUCT	Height	Depth	Weight	Part #	Price
CPU SideRack 02	7.75"	10"	5 lbs.	345zz	\$98.95
CPU SideRack with 2.375" Caster	13.5"	10"	8 lbs.	564zz	\$139.95
CPU SideRack with 4" Caster	13.5"	10"	11 lb.	564zz4	\$159.95
CPU SideRack – Small Form Factor	7"	6.75"	5 lbs.	ZSFzz	\$79.95
5" Caster - Retrofit			3 lbs.	519CA	\$45.95
Glide Retrofit			1 lb.	547GL-RET	\$29.95*

 QuickShip available for CPU SideRack 02 in Putty Grey (PG) only.

 CPU SideRack 02 does not work with 24" or 30" wide AnthroCarts, MiniCart, or UltraCompact Cart.

### CABLE MANAGEMENT KIT

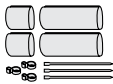

- Comes with two 3" long and two 9" long plastic sleeves, six hook-and-loop cable ties, and six plastic cord handlers.
- Sleeves are rigid plastic pieces that slip over and screw onto legs. Feed cords through the flexible slot on the side.
- Available in Black (BK) or Putty Grey (PG).

PRODUCT	Width	Depth	Weight	Part #	Price
Cable Management Kit	3.5"	1.5"	2 lbs.	CM2zz	\$45.95

### CASTERS

#### 4" Casters

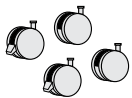

- Casters are twin wheel, soft rubber, and have a positive lock action so the Cart will not move when the casters are in the locked position.
- Adds approximately 1.5" to the height of your Cart.

PRODUCT	Weight	Upgrade (when ordering your Cart)		Retrofit (for your existing Cart)	
		Part#	Price	Part #	Price
1 Caster (non-locking)	3 lbs.	Add "4" to the end of your Cart part number when ordering the Upgrade.	\$20.00	547CA	\$19.95
Set of 4 Casters (2 locking, 2 non-locking)	6 lbs.		\$74.95	540CA	\$79.95
Set of 6 Casters (2 locking, 4 non-locking)	10 lbs.		\$99.00	534CA	\$99.95

#### 5" Casters

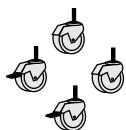

- Suggested for Carts that are moved often, especially over uneven surfaces. Adds 3.5" height to your Cart.
- Heavy-duty, single-wheel caster has solid rubber tread. Brakes on front caster ensure the cart stays put when locked.

PRODUCT	Weight	Part #	Price
1 Caster - Retrofit (non-locking)	3 lbs.	519CA	\$45.95
Set of 4 Casters - Retrofit (2 locking, 2 non-locking)	9 lbs.	515CA	\$162.95
Set of 6 Casters - Retrofit (2 locking, 4 non-locking)	12 lbs.	517CA	\$239.95

## COLOR COMBINATIONS

Select your product colors from the following swatches. Replace "zz" with a 2-letter Metal Code and "xx" with a 2-letter Laminate or Combo Code.

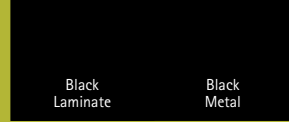

Black Combo (BK)

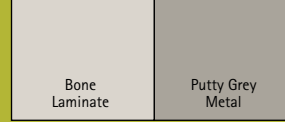

Bone Combo (BN)

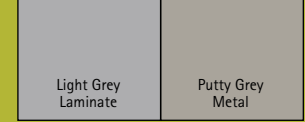

Light Grey Combo (LG)

### CUP HOLDER



- Precision engineered and field tested, this finely tuned apparatus will give you years of cup holding satisfaction.
- At 2" deep, it holds up to 3.5" diameter cup and attaches to the edge of a shelf with a C-clamp.
- Available in Black (BK) or Putty Grey (PG).

PRODUCT	Height	Width	Depth	Weight	Part #	Price
Cup Holder	2"	4.5"	2"	2 lbs.	465zz	\$24.95

### DISKETTE BASKET

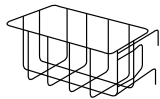

- Keep small items all in one place. Installs on any leg at any height. Wire basket swings under cart and locks in place when not in use.
- Available in Black (BK).

PRODUCT	Width	Depth	Height	Weight	Part #	Price
Diskette Basket	7.5"	5"	3.75"	2 lbs.	312BK	\$79.95

### DOCUMENT STAND

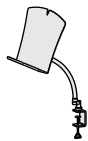

- Comes with steel stand, 10" gooseneck and C-clamp. Attaches onto the edge of any shelf.
- The lip of the steel stand is 2" deep and .5" high to securely hold your documents, a book, or a multi-line phone.
- Available in Black (BK).

PRODUCT	Width	Depth	Height	Weight	Part #	Price
Document Stand	14.25"	2"	11"	4 lbs.	440BK	\$139.95

### DRAWER SOLUTIONS

Drill required for installation. Available in Black (BK) or Putty Grey (PG) unless otherwise noted. Except for FileAround, all Drawers attach to the underside of Shelves.

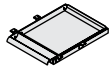

#### Drawer – Pencil 1.75"h

- This metal drawer has a scooped area in front for pencils and pens. Interior measurements are 14.75"w x 20.5"d x 1.75"h.
- ⚠ Does not work with 24" w AnthroCart, MiniCart, PrinterCart, or UltraCompact Cart.

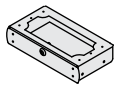

#### Drawer – Shallow 3"h

- This locking metal drawer measures 9" deep to fit on shallow shelves. Interior measurements are 14.75"w x 8.75"d x 2.75"h.
- Available in Black (BK).
- ⚠ Does not work with MiniCart, 60", or 72" wide AnthroCarts.

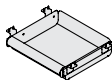

#### Drawer – Small 3"h

- This 3" high metal drawer fits under Large and Small Shelves. Interior measurements are 12.75"w x 12.25"d x 3"h.
- Available in Black (BK) and Putty Grey (PG) plus MiniCart bonus colors Slate Blue (SB) and Silver Satin (SS).



QuickShip available for Small 3" h Drawer in Putty Grey (PG) only.

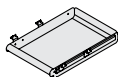

#### Drawer – Large 3"h

- This 3" high metal drawer fits under Standard or Additional Shelves. Interior measurements are 14.25"w x 21.5"d x 3"h.
- ⚠ Does not work with 24" wide AnthroCart, MiniCart, PrinterCart, or UltraCompact Cart.

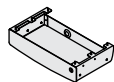

#### Drawer – Zido 4.5"h

- Originally designed for the Zido family, this drawer comes in Cool Grey (CG), which does not match other AnthroCart colors.
- The back of the drawer features a grommeted cord pass-through for power and network cables. Interior measurements are 19"w x 10"d x 3"h.
- ⚠ Does not work with MiniCart, 24" wide PrinterCart, or UltraCompact Cart

Cool Grey (CG)

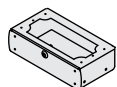

#### Drawer – Shallow 6"h

- This metal, locking drawer measures just 8.25" deep to fit on shallow workstations. Interior measurements are 14.75"w x 8.25"d x 5.75"h.
- Available in Black (BK).
- ⚠ Does not work with MiniCart or UltraCompact Cart, 24", 60", or 72" AnthroCart.



#### Drawer – Large 6"h

- Interior measurements for this locking 6" Drawer are 13.25"w x 16.25"d x 6"h. Comes with 1 drawer divider.
- ⚠ Does not work with 24", 30", or 36" wide AnthroCarts, IdeaCart, MiniCart, or UltraCompact Cart.

(Continued ...)

## ROLLING WITH THE PUNCHES

In 1994, one customer became an Anthro evangelist after the Northridge/Riverside earthquakes. After the quake and aftershocks, her AnthroCart was the only thing left standing. It was on the other side of the room – but still standing.  
Sandy J., Inside Sales

**Drawer – 6" h and 11" h File**

- Lockable metal unit has 2 drawers. One is perfect for office supplies, the other for letter files. The 6" drawer comes with drawer divider.
- Interior measurements for the 6" drawer are 13.25"w x 16.25"d x 6"h. Interior measurements for the 11" drawer are 13.25"w x 16.25"d x 10"h.
- Holds 50 lbs. overall: 20 lbs. in the 6" drawer and 30 lbs. in the 11" drawer.
- Consider the width of your Cart and necessary leg room you will need to determine the feasibility of this Drawer.
- ⚠ Does not work with 24", 30", or 36" wide AnthroCarts, IdeaCart, MiniCart, or UltraCompact Cart.

**FileAround**

- Full-extension glides put everything in easy reach. Two locking casters keep unit in place when drawers are pulled out, and the fifth caster under the file drawer prevents the unit from tipping when drawers are fully extended. Keyed locks protect contents.
- Holds up to 150 lbs. of distributed weight overall: up to 50 lbs. on top, up to 50 lbs. in the 6" drawer, and up to 75 lbs. in the 11" drawer.
- Available in Black (BK).

PRODUCT	Weight Capacity	Locking	Width	Depth	Height	Weight	Part #	Price
Drawer - Pencil 1.75"h	10 lbs.	No	14.75"	21.75"	1.75"	9 lbs.	489zz	\$159.95
Drawer - Shallow 3"h	15 lbs.	Yes	17"	9"	3.25"	9 lbs.	820zz	\$159.95
Drawer - Small 3"h	15 lbs.	No	13"	12.5"	3.25"	7 lbs.	413zz	\$99.95
Drawer - Large 3"h	20 lbs.	No	15"	23"	3.25"	11 lb.	415zz	\$139.95
Drawer - Zido 4.5"h	15 lbs.	Yes	20.5"	11.25"	4.5"	13 lbs.	ZDRCG	\$169.95
Drawer - Shallow 6"h	20 lbs.	Yes	17.25"	8.25"	6.25"	12 lbs.	824zz	\$159.95
Drawer - Large 6"h	20 lbs.	Yes	13.5"	17.5"	6.5"	20 lbs.	275zz	\$239.95
Drawer - 6" h and 11" h File	50 lbs.	Yes	13.5"	17.5"	17.5"	45 lbs.	298zz	\$439.95
FileAround	150 lbs.	Yes	15.5"	18.5"	21.5"	60 lbs.	510zz	\$339.95*

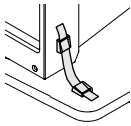
**EQUIPMENT HOLD-DOWN**

- Secure your equipment to a shelf with this handy kit. Attach an adhesive-backed buckle to your equipment and another buckle to the shelf, then feed the strap through the buckles to secure.
- Comes with 4 adhesive buckles, 2 Polypropylene straps (1" wide x 8" long), and 2 alcohol pads for cleaning equipment and shelves.

PRODUCT	Part #	Price
Equipment Hold-down	333BK	\$29.95

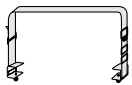
**EQUIPMENT STRAP**

- Keep your equipment in place with this strap. Clamps to the sides of any wood shelf.
- Comes with 1.5" wide Black (BK) nylon strapping with C-clamps on both ends.
- C-clamps are available in Black (BK) or Putty Grey (PG).

PRODUCT	Length	Weight	Part #	Price
Equipment Strap	8'	2 lbs.	385zz	\$39.95

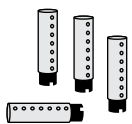
**EXTENSION TUBES**

- Gain added storage above your work surface by combining Extension Tubes with Additional Shelves (see AnthroCart: Accessories) or use alone to create a standing-height workstation. Tubes fit tightly into the legs of your Cart.
- Combine up to two sets (up to 40") for added flexibility.
- Available in Black (BK) or Putty Grey (PG).
- Sets of 3 also available in MiniCart bonus colors Cool Grey (CG) and Silver Satin (SS).

**Set of 3: For 24", 30", 36" wide AnthroCarts and Minicart**

Length	Weight	Part#	Price
5"	3 lbs.	230zz	\$66.95
7"	3 lbs.	237zz	\$72.95
9"	4 lbs.	239zz	\$74.95
12"	5 lbs.	242zz	\$79.95
15"	5 lbs.	233zz	\$84.95
20"	6 lbs.	226zz	\$95.95

**Set of 4: For 48", 60", 72" wide AnthroCarts, PrinterCart and UltraCompact Cart**

Length	Weight	Part#	Price
5"	5 lbs.	232zz	\$74.95
7"	5 lbs.	238zz	\$79.95
9"	5 lbs.	240zz	\$82.95
12"	6 lbs.	243zz	\$89.95
15"	7 lbs.	234zz	\$99.95
20"	8 lbs.	227zz	\$109.95
24"	12 lbs.	301zz	\$119.95
36"	18 lbs.	306zz	\$149.95



QuickShip available for 7" and 20" sets of 3, and 7" and 20" sets of 4 in Putty Grey (PG) only.

## COLOR COMBINATIONS

Select your product colors from the following swatches. Replace "zz" with a 2-letter Metal Code and "xx" with a 2-letter Laminate or Combo Code.

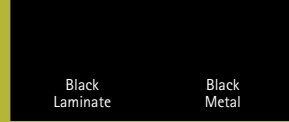

Black Combo (BK)

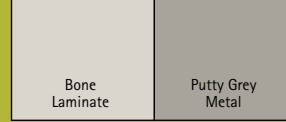

Bone Combo (BN)

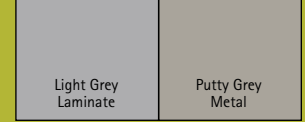

Light Grey Combo (LG)

## FLAT PANEL MONITOR SOLUTIONS

Lots of choices for your flat panel monitor! Pick the features you need. **Note: all mounting options conform to VESA 75mm and 100mm mounting standards.** If you need a different standard or would like to discuss additional monitor solutions, give us a call!

### Flat Panel Monitor Arm

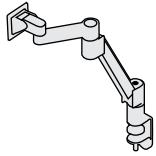

- These steel arms have a vertical travel range of 16" and rotate 360°. Travel range depends on the size of your monitor.
- Mount with either a C-clamp to the edge of your cart or drill through a shelf for added security. Clamp opens a maximum of 2" and requires 3.5" of vertical clearance below the shelf.
- Arms extend up to 22" from their mounting point.
- Ten-year warranty against manufacturing defects.
- The Single-Standard and Single-Super Arms are available in Black (BK) and Silver Metallic (SM). The Single-Light is available in Black (BK).

PRODUCT	Supports Monitors Weighing	Weight	Part #	Price
Single - Standard	7.5-25 lbs.	20 lbs.	LCDxx	\$239*
Single - Super	13.5-44 lbs.	20 lbs.	LCD2xx	\$289*
Single - Light	2-13.5 lbs.	20 lbs.	770BK	\$269.95*

⚠ Does not work with 24" or 30" wide AnthroCarts, IdeaCart, MiniCart, 24" wide PrinterCart or UltraCompact Cart.

### Flat Panel Monitor Bar

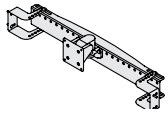

- Add a row of flat panel monitors above your Cart by adding this Flat Panel Monitor Bar with a set of Extension Tubes and an Additional Shelf (see AnthroCart: Accessories).
- Comes with one metal swivel-head Flat Panel Monitor Bracket. Add additional Brackets to support additional monitors. Each Bracket holds up to 22 lbs. The amount of available swivel angle depends on the size of your monitor.
- At assembly, adjust your monitor to a comfortable depth. Install the Bar at any height in 1" increments. Install your monitor anywhere along the bar left to right in 1" increments.
- Available in Black (BK) or Putty Grey (PG).

PRODUCT	Usable Mounting Area	Weight	Part #	Price
48" wide	32"	18 lbs.	673zz	\$289.95
60" wide	44"	21 lb.	675zz	\$329.95
72" wide	56"	25 lbs.	677zz	\$339.95
Additional Flat Panel Monitor Bracket	NA	2 lbs.	681zz	\$149.95

⚠ Does not work with IdeaCart, MiniCart, PrinterCart or UltraCompact Cart.

### Flat Panel Monitor Mount



SINGLE MONITOR

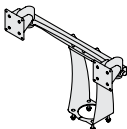

DUAL MONITOR

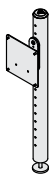

COMPACT FLAT PANEL MOUNT

- Secure your displays to your cart with these mounts. Choose the height, features, and capacity that fit your needs. All meet VESA 75mm and 100mm standards.
- The Single, Dual, and Dual Heavy-duty mounts use a 13" high stand and tilt-and-swivel knuckles to support your monitors. The Single (part #615zz) supports a single display up to 22 lbs. The Dual (part #617zz) supports two displays up to 22 lbs. total and 17" across. The Dual Heavy-duty (part #627zz) supports two displays up to 44 lbs. and 20" across. The mount base is 4.5"w x 4.5"d.
- Need a monitor mount that takes up as little space on your cart as possible? Choose the Flat Panel Mount – Compact 18". A simple 1-1/2"-diameter tube mounts directly to your cart shelf. The tube is 18" long with holes every inch for installation of the –and swivel mount. Holds up to 22 lbs.
- Need a mount that's a little taller? Choose the Extension Tube – Large 26" and add either a one-monitor or two-monitor knuckle to it. The Extension tube is a 2.5"-diameter tube with a 4.5"-diameter base. The tube has holes every inch for installation of a tilt-and-swivel knuckle assembly. Choose the Single (part #ZPMSzz) or Dual (part #ZPMDzz, supports two displays up to 44 lbs. total and 20" across), sold separately.
- Install by drilling through the shelf and securing to the shelf bracket with four bolts. Drill required for installation. 🔩
- Available in Black (BK), Putty Grey (PG), and MiniCart bonus colors Cool Grey (CG) and Silver Satin (SS).

PRODUCT	Weight	Part #	Price
Single Monitor	7 lbs.	615zz	\$209.95
Dual Monitor	12 lbs.	617zz	\$299.95
Heavy-Duty Dual Monitor (not pictured)	15 lbs.	627zz	\$339.95
Flat Panel Mount – Compact 18"	4 lbs.	MFP18zz	\$169.95
Extension Tube – Large 26"	5 lbs.	ZET26zz	\$99.95
Single Flat Panel Knuckle for Extension Tube	5 lbs.	ZPMSzz	\$139.95
Dual Flat Panel Knuckle for Extension Tube	17 lbs.	ZPMSDB	\$319.95

QuickShip available for Single Monitor Mount in Putty Grey (PG) only.

## ACCESSORIES MAKE THE OUTFIT

This is true with all Anthro furniture. There are lots and lots of useful and fun accessories to add, so that your Anthro furniture is completely your design.



### FOOTREST



- Elevate your feet with this simple footrest and alleviate pressure on your lower back. Rocking motion keeps your lower legs and feet moving while seated.
- Non-skid pads on the surface keep your feet in place.
- Measures 16.75"w x 12.25"d x 4.5"h.
- Comes in Black.

PRODUCT	Weight	Part #	Price
Footrest	5 lbs.	729BK	\$89.95*

### GLIDES



- For a non-mobile workstation that can compensate for uneven floors, replace Casters with these Glides.
- Replacing the 2.375" Casters with Glides makes your Cart 2" shorter. Consider adding Extension Tubes to compensate.

PRODUCT	Weight	Upgrade (when ordering your Cart)		Retrofit (for your existing Cart)	
		Part # and Price		Part #	Price
1 Glide	1 lb.	Add "GL" to the end of your Cart part number when ordering the Upgrade. Call for pricing.		547GL-RET	\$29.95*
Set of 4 Glides	1 lb.			537GL-RET	\$49.95*
Set of 6 Glides	1 lb.			528GL-RET	\$69.95*

### HANDLES

#### 16"w Handle

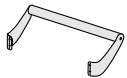

- This 1.25" round handle makes it a breeze to push and steer your Cart. Angled up for easier maneuvering.
- Made of 16 gauge steel. Attaches to the vertical legs with 4 screws. Extends out 5" from the side of your Cart.
- Available in Black (BK) or Putty Grey (PG).

PRODUCT	Weight	Part #	Price
16"w Handle	3 lbs.	EHzz	\$49.95

⚠ Does not work with 24", 30", or 36" wide AnthroCarts, IdeaCart, MiniCart, or UltraCompact Cart.

#### Clamp On Handle

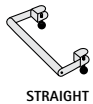

- These smooth, round 1.25" diameter steel handles clamp onto any edge so you can put them where they're comfortable for you.
- The Straight Handle rests parallel to your cart's worksurface and extends 3.25" from the side of the cart.
- The Angled Handle has a 45° angle so it rests above your cart's worksurface. It extends 7.5" from the side of the cart.
- The Straight Handle is available in Black (BK). The Angled Handle is available in Black (BK) or Putty Grey (PG).

PRODUCT	Width	Depth	Weight	Part #	Price
Straight	12"	3.25"	4 lbs.	389BK	\$64.95
Angled	12"	7.5"	3 lbs.	388zz	\$79.95

⚠ Does not work with 48", 60", or 72" wide AnthroCarts, or UltraCompact Cart.

#### MiniCart Handle

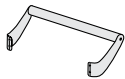

- Angled upwards, this sturdy metal handle attaches to the legs of the MiniCart with 4 screws.
- Available in Black (BK), Putty Grey (PG), Silver Satin (SS), and Slate Blue (SB).

PRODUCT	Width	Depth	Weight	Part #	Price
MiniCart Handle	15.5"	6"	3 lbs.	387zz	\$59.95

 QuickShip available in Putty Grey (PG) only.

⚠ Only works with the MiniCart.

### HOOKS



- An inexpensive metal accessory to wrap your cables, hang your coat, or dangle a clipboard.
- Available in Black (BK) or Putty Grey (PG). Also available in MiniCart bonus colors Silver Satin (SS) or Slate Blue (SB).

PRODUCT	Height	Depth	Weight	Part #	Price
Hooks - Set of 3	1"	1.75"	1 lb.	380zz	\$16.95

## COLOR COMBINATIONS

Select your product colors from the following swatches. Replace "zz" with a 2-letter Metal Code and "xx" with a 2-letter Laminate or Combo Code.

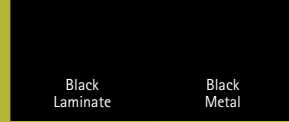

Black Combo (BK)

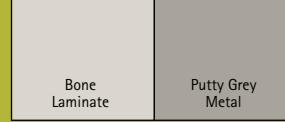

Bone Combo (BN)

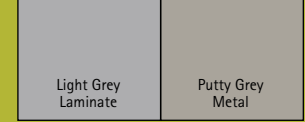

Light Grey Combo (LG)

## KEYBOARD SOLUTIONS

Whether you're looking for ergonomics or just convenience, finding the right Keyboard Solution can make a world of difference in your workstation. And we offer lots of choices. Sometimes the differences between the caddies are subtle, so feel free to call us to find the right solution for you.

### Keyboard and Mouse Caddy, Style A – Deluxe

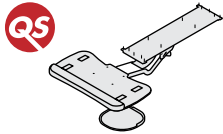

- Caddy moves in and out, up and down, tilts 10° positive and 20° negative, and swivels 360°. Movement ranges from 6" above your work surface to 5.5" below. Swing-out mouse surface pivots out when it's needed and hides away when it's not.
- Made of steel and phenolic with an integrated foam wrist rest. Surfaces are neutral granite color.
- Requires 22" mounting depth. Drill required for installation.

PRODUCT	Width	Depth	Weight	Part #	Price
Keyboard and Mouse Caddy, Style A	19.5"	8"	17 lbs.	149SM	\$339.95

Works with 24"–72" wide AnthroCarts only.

### Keyboard and Mouse Caddy, Style B – Super

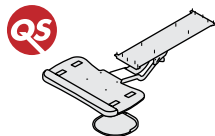

- Caddy moves in and out, up and down, tilts 20° positive and 20° negative, and swivels 360°. Movement ranges from even with your work surface to 6" below. Swing-out mouse surface pivots out when it's needed and hides away when it's not.
- Made of steel and phenolic with an integrated foam wrist rest. Surfaces are neutral granite color.
- Requires 18.5" mounting depth. Drill required for installation.

PRODUCT	Width	Depth	Weight	Part #	Price
Keyboard and Mouse Caddy, Style B	19.5"	8"	7 lbs.	UKMCBK	\$239.95

Works with 24"–72" wide AnthroCarts and PrinterCarts only.

### Keyboard and Mouse Caddy, Style C – Elevate

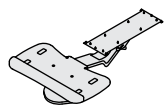

- Caddy moves in and out on an 18.5" track, up and down from 2" above your work surface to 6" below, tilts 20° positive and 10° negative, and swivels 360°. Swing-out mouse surface pivots out when it's needed and hides away when it's not.
- Made of steel and phenolic with an integrated foam wrist rest. Surfaces are neutral granite color.
- Requires 18.5" mounting depth. Drill required for installation.

PRODUCT	Width	Depth	Weight	Part #	Price
Keyboard and Mouse Caddy, Style C	19.5"	8"	13 lbs.	159BK	\$319.95

Does not work with MiniCart or UltraCompact Cart.

### Keyboard Drawer – Basic



- Laminated wood surface moves in and out. Extends 10" in front of the Unit. Assemble the Drawer to fit 3–4" below your large shelf.
- Want to add a mouse surface to your Keyboard Drawer? Consider the Mouse Shelf, Swing-out (Part # 687BK, see AnthroCart: Accessories).
- Drill required for installation.

PRODUCT	Width	Depth	Weight	Part #	Price
20" wide Keyboard Drawer – Basic	20"	11"	8 lbs.	20xx	\$99.95
30" wide Keyboard Drawer – Basic	30"	11"	15 lbs.	30xx	\$124.95

The 20" Keyboard Drawer does not work with MiniCart or UltraCompact Cart. The 30" Keyboard Drawer does not work with 24" or 30" wide AnthroCart, MiniCart, 24" PrinterCart or UltraCompact Cart.

### Keyboard Drawer – Zido

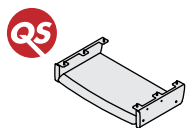

- Originally designed for the Zido family, this drawer comes in Cool Grey (CG), which does not match other AnthroCart colors. Cool Grey (CG)
- Keyboard surface pulls out on full-extension glides. The wood keyboard surface is wrapped in a high-durability Kydex®-brand thermoplastic laminate that resists cracking and chipping.
- Drill required for installation.

PRODUCT	Width	Depth	Weight	Part #	Price
Keyboard Drawer – Zido	19"	11"	12 lbs.	ZKD20CG	\$159.95

Does not work with MiniCart or UltraCompact Cart.



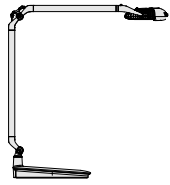

## LIGHT

TASK LIGHT WITH  
OPTIONAL LIGHT BASE

- Single LED light source produces a large footprint of neutral white light and casts just one shadow to provide clean, clear illumination.
- LED uses only 6 watts, and heat-dispersing design extends light life with 50,000-hour lifespan.
- Dual-articulating arm has maximum reach of 28" and a working height of 18". Cord is 8' long. Internal counterbalance provides fingertip adjustability.
- Light clamps to the side of your workstation with a C-clamp. Optional weighted base (Part #912SM) is sold separately.

PRODUCT	Weight	Part #	Price
Light	2 lbs.	910SM	\$295*
Light Base	5 lbs.	912SM	\$69.95*

## METAL TRAY - MINICART

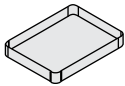

- Two inch lip prevents items from rolling out.
- Mount at any height on the legs. Holds up to 50 lbs.
- Available in Black (BK), Putty Grey (PG), Silver Satin (SS), or Slate Blue (SB).

PRODUCT	Height	Width	Depth	Weight	Part#	Price
Metal Tray - Minicart	2.25"	15.5"	20.5"	10 lbs.	314zz	\$99.95

 QuickShip available for Metal Tray Minicart in Putty Grey (PG) only.

 Only works with the MiniCart.

## MOUSE SOLUTIONS

## Mouse Shelf - Swing-out





- Made of heavy-duty phenolic in neutral granite finish. Attaches to wood surfaces. Drill required for installation. 

PRODUCT	Width	Depth	Weight	Part #	Price
Mouse Shelf - Swing-out	8"	9"	2 lbs.	687BK	\$69.95

 Not recommended for UltraCompact Cart.

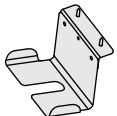
## Mouse Holder



- Store your mouse in this handy holder on the side or front of your workstation. Especially useful in mobile applications to protect your mouse from falling off the worksurface.
- Attaches to any wood surface with two wood screws. Mounting bracket is 5"w x 1"d. Drill required for installation. 
- Available in standard AnthroCart colors Black (BK) and Putty Grey (PG). Also available in MiniCart bonus colors Silver Satin (SS) and Slate Blue (SB).

PRODUCT	Height	Width	Depth	Weight	Part #	Price
Mouse Holder	5"	5.75"	4"	2 lbs.	ZMHzz	\$39.95

## POWER SOLUTIONS

Plug all of your electrical cords into a single strip to keep them organized and accessible. Choose the mounting option and features that are right for you.

## Power Bar

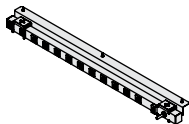

- Rated at 15 amps, 120 Volts. 2" spacing allows AC/DC adapters at each receptacle. Mount under any surface to face forward, down or back; bar is easy to reposition. Covered by One Year Warranty.
- Comes with 12' cord, on/off switch with indicator light, and circuit breaker reset button.
- Available in Silver Metallic (SM), which does not match other AnthroCart colors. Drill required for installation. 

Silver Metallic (SM)

PRODUCT	Height	Width	Depth	Weight	Part #	Price
12 Receptacles	3"	36"	2"	8 lbs.	PBA12SM	\$109.95*
16 Receptacles	3"	48"	2"	12 lbs.	PBA16SM	\$119.95*

 Does not provide surge protection nor work with 24", 30", or 36" wide AnthroCarts, IdeaCart, MiniCart, PrinterCart, or UltraCompact Cart.

## COLOR COMBINATIONS

Select your product colors from the following swatches. Replace "zz" with a 2-letter Metal Code and "xx" with a 2-letter Laminate or Combo Code.

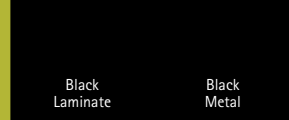

Black Combo (BK)

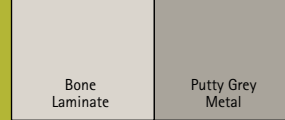

Bone Combo (BN)

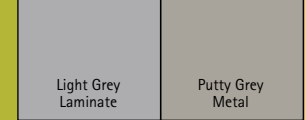

Light Grey Combo (LG)

### Surge Protectors

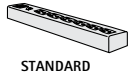

STANDARD

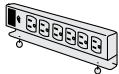

CLAMP-ON

- These UL-listed surge suppressors are 12" long, have 6 outlets and are rated at 15 amps, 120 Volts. Come with on/off switch, on/off indicator light, and circuit breaker reset button. Covered by One Year Limited Warranty.
- Surge Protector - Standard comes in Black (BK) and mounts to a Cart's vertical tubes or under a shelf with integrated mounting hardware.
- Surge Protector - Clamp-on comes in Black (BK). The C-clamp mounts onto the edge of any shelf with two threaded knobs.

PRODUCT	Cord Length	Depth	Weight	Part #	Price
Surge Protector - Standard	15'	2.5"	2 lbs.	520BK	\$84.95
Surge Protector - Clamp-on	15'	2.5"	5 lbs.	BPSBK/BK	\$129.95

### PROBE HOLDERS



SMALL LARGE

- Brackets measure 1.5" wide x 2.5" deep and attach to the bottom of any wood surface with 2 screws. Cushioned cups are open on the bottom and snap into place.
- Cups come in grey and light green. Brackets available in Black (BK) and Putty Grey (PG) plus MiniCart bonus colors Silver Satin (SS) and Slate Blue (SB). Drill required for installation. **F**

PRODUCT	Width	Depth	Height	Weight	Part #	Price
Probe Holder, Small	2.5"	3.5"	2.5"	1 lb.	ZGCSCG	\$44.95
Probe Holder, Large	2.5"	3.5"	4.5"	1 lb.	ZGCLCG	\$49.95

**QS** QuickShip available for Large Probe Holder only.

### RACK - HANGING

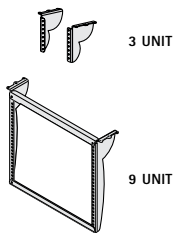

3 UNIT

9 UNIT

- Keep your rack equipment within easy reach. Integrated tapped rails make mounting your equipment a breeze. Use two sets (one in front and one in rear) to securely hold extra long racks. Made of 11 gauge steel and holds up to 100 lbs.
- Available in Black (BK) or Putty Grey (PG). Drill required for installation. **F**

PRODUCT	Bracket Height	Track Height	Width	Weight	Part #	Price
3 Unit	5.75"	5.25"	22"	5 lbs.	RH3zz	\$79.95
9 Unit	18.75"	18.25"	22"	10 lbs.	RH9zz	\$219.95

**⚠** Does not work with MiniCart or UltraCompact Cart.

### SCANNER BRACKET



- Keep your barcode scanner right at hand with this metal bracket. Inside opening on bracket is 1.5"w x 2"d.
- Available in Black (BK) and Putty Grey (PG) plus MiniCart bonus colors Silver Satin (SS) and Slate Blue (SB).
- Installs on any wood surface with two screws. Drill required for installation. **F**

PRODUCT	Height	Width	Depth	Weight	Part #	Price
Scanner Bracket	3.5"	2.25"	5.25"	1 lb.	886SM	\$29.95

### SECURITY CABLE, 36"



- Protect laptops and hard drives from theft with this adapter. The lock attaches to the back of your laptop or hard drive and the cable loops around the legs or brackets of your station. Comes with the cable, lock, and two keys.

PRODUCT	Length	Weight	Part #	Price
Security Cable, 36"	36"	2 lbs.	960SM	\$119.95*

One memorable Customer Service call was from a cranky elderly woman in a remote part of California who had received her new AnthroCart but was unable to put it together. She had no relative nearby to help her, so we contacted her local fire department, hoping they might come to her aid. On hearing who the gal was, they immediately said no (small community, big reputation). We finally contacted the local Boy Scout troop who gave it a shot. And so the story ended happily for all.

**SHELVES**

**Shelves – Additional Large**

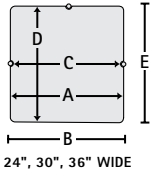

24", 30", 36" WIDE

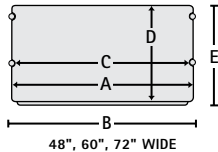

48", 60", 72" WIDE

- Screws into holes in legs to make room for more hardware. Best used in a stand-up application.
- Available in Black (BK), Bone (BN), or Light Grey (LG).

PRODUCT	Width (A)	Width (B)	Width (C)	Depth (D)	Depth (E)	Weight	Part #	Price
24" wide	24"	25.25"	22"	29"	30"	29 lbs.	161xx	\$109.95
30" wide	30"	31.25"	28"	29"	30"	33 lbs.	184xx	\$134.95
36" wide	36"	37.5"	34"	29"	30"	39 lbs.	164xx	\$154.95
48" wide	48"	49.25"	46"	30"	30"	65 lbs.	487xx	\$239.95
60" wide	60"	61.25"	58"	30"	31"	81 lb.	607xx	\$299.95
72" wide	72"	73.25"	70"	30"	31"	98 lbs.	727xx	\$339.95

**Shelves – Additional Small**

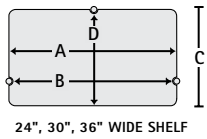

24", 30", 36" WIDE SHELF

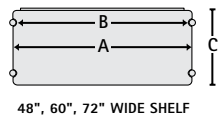

48", 60", 72" WIDE SHELF

- Can be mounted anywhere on the Cart, either below existing shelves or above with the help of Extension Tubes (see AnthroCart: Accessories).
- Lowest position is 9" above floor on a cart with 2.375" casters
- Available in Black (BK), Bone (BN), or Light Grey (LG). MiniCart shelves also available in bonus colors Blanc (BC) and Fog (FG).

PRODUCT	Width (A)	Width (B)	Depth (C)	Depth (D)	Weight	Part #	Price
24" wide	24"	22"	19"	18"	15 lbs.	120xx	\$71.95
30" wide	30"	28"	19"	18"	18 lbs.	108xx	\$89.95
36" wide	36"	34"	19"	18"	24 lbs.	112xx	\$109.95
48" wide	48"	46"	21.75"	NA	44 lbs.	486xx	\$199.95
60" wide	60"	58"	21.75"	NA	59 lbs.	606xx	\$259.95
72" wide	72"	70"	21.75"	NA	69 lbs.	726xx	\$319.95

**QS** QuickShip available for 24" wide and 48" wide Shelf in Bone Laminate (BN) only.

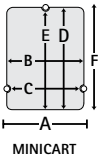

MINICART

MINICART	Width (A)	Width (B)	Width (C)	Depth (D)	Depth (E)	Depth (F)	Weight	Part #	Price
	18.75"	17.25"	15.5"	21.5"	20.5"	22.5"	13 lbs.	103xx	\$79.95

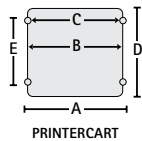

PRINTERCART

PRINTERCART	Width (A)	Width (B)	Width (C)	Depth (D)	Depth (E)	Weight	Part #	Price
24" wide	25.25"	24"	21"	22"	12"	18 lbs.	107xx	\$89.95

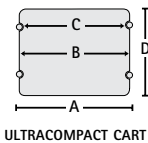

ULTRACOMPACT CART

ULTRACOMPACT CART	Width (A)	Width (B)	Width (C)	Depth (D)	Weight	Part #	Price
	25.25"	23.75"	21.25"	15.75"	15 lbs.	138xx	\$75.95

## COLOR COMBINATIONS

Select your product colors from the following swatches. Replace "zz" with a 2-letter Metal Code and "xx" with a 2-letter Laminate or Combo Code.

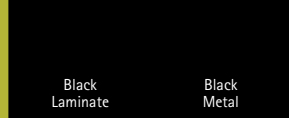

Black Combo (BK)

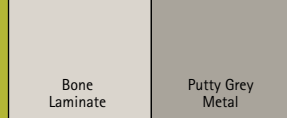

Bone Combo (BN)

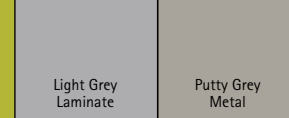

Light Grey Combo (LG)

### Shelf - Metal Base

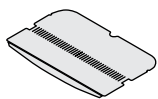

- Make use of the space at the bottom of your Cart for your hardware, books or manuals.
- Comes with a strap and buckle to hold your equipment. Rests on the base tube.
- Holds up to 75 pounds.
- When installed on a cart with 2.375" casters, the shelf is 5" above the floor.
- Available in Black (BK) or Putty Grey (PG). MiniCart shelf also available in Silver Satin (SS) and Slate Blue (SB).

PRODUCT	Width	Depth	Weight	Part#	Price
Metal Base Shelf for UltraCompact Cart	24"	14"	9 lbs.	MBUCzz	\$84.95
Metal Base Shelf for 24" wide AnthroCart	24"	14"	9 lbs.	MB2414zz	\$84.95
Metal Base Shelf for Minicart	17"	14"	6 lbs.	MBMCzz	\$64.95

### WIRE BASKET SHELF - MINICART

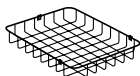

- Attaches to the legs of the MiniCart at any height. Open wire weave keeps contents visible.
- Weight capacity of 30 lbs.
- Available in Black (BK), Putty Grey (PG), Silver Satin (SS), or Slate Blue (SB).

PRODUCT	Height	Width	Depth	Weight	Part #	Price
Wire Basket Shelf - Minicart	2.25"	15.5"	19.75"	5 lbs.	313zz	\$69.95

 Only works with the MiniCart.

# Touchboards

205 Westwood Ave, Long Branch, NJ 07740  
 Phone: 866-94 BOARDS (26273) / (732)-222-1511  
 Fax: (732)-222-7088 | E-mail: [sales@touchboards.com](mailto:sales@touchboards.com)