

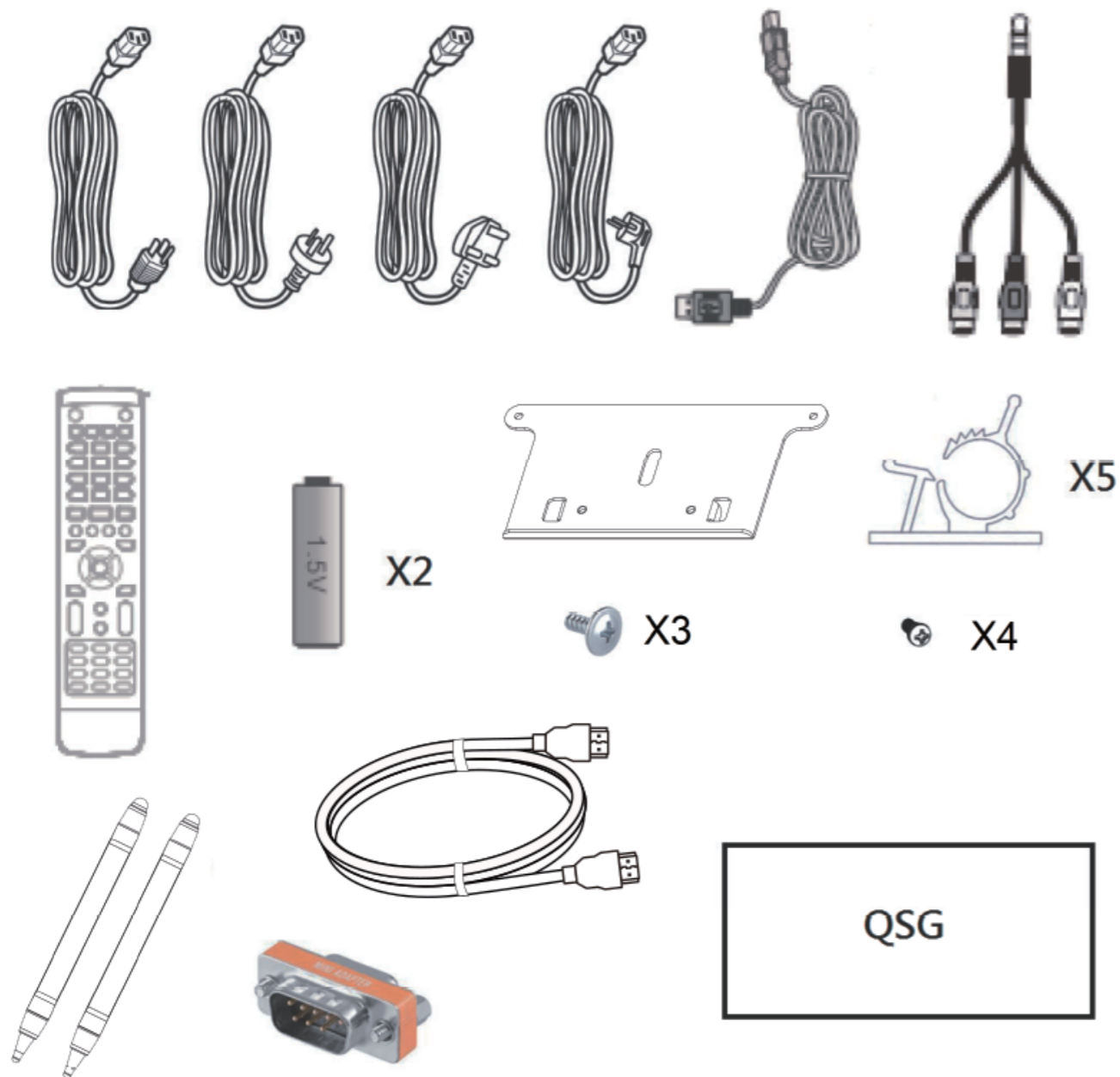

# ViewBoard IFP50 series Commercial Touch Display Quick Start Guide

## 1 Package Contents

- Power cable x 4
- Remote control
- AAA battery x 2
- USB cable
- AV cable
- Stylus pen x 2
- Quick start guide
- RS232 adapter
- Clamp x 5
- Plate
- Screw x 7
- Input compatible with HDMI



## 2 Wall Mount Kit Specifications (VESA)

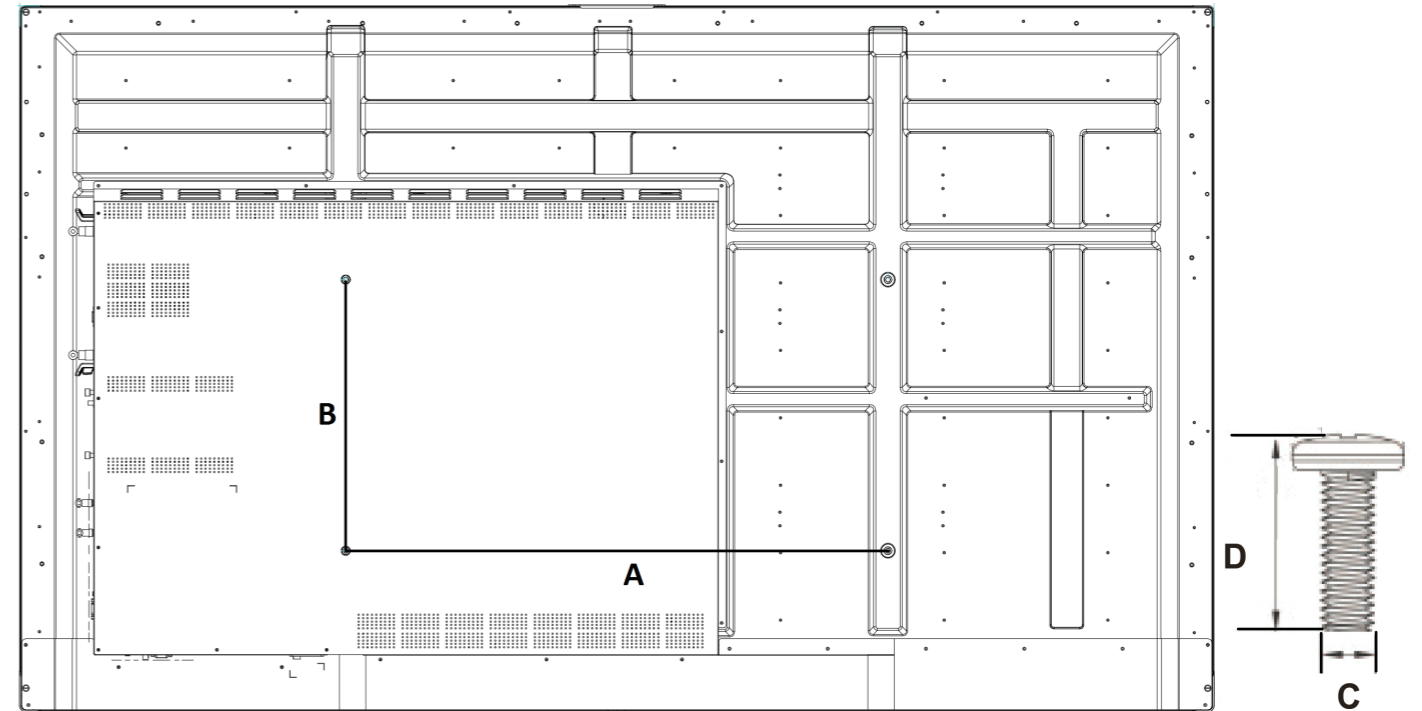

inch	VESA Spec. (A x B)	Standard Screw (C x D)	Quantity
IFP5550 - 55"	400 x 400 mm	M8 x 25 mm	4
IFP6550 - 65"	600 x 400 mm	M8 x 25 mm	4
IFP7550 - 75"	800 x 400 mm	M8 x 25 mm	4
IFP8650 - 86"	800 x 600 mm	M8 x 25 mm	4

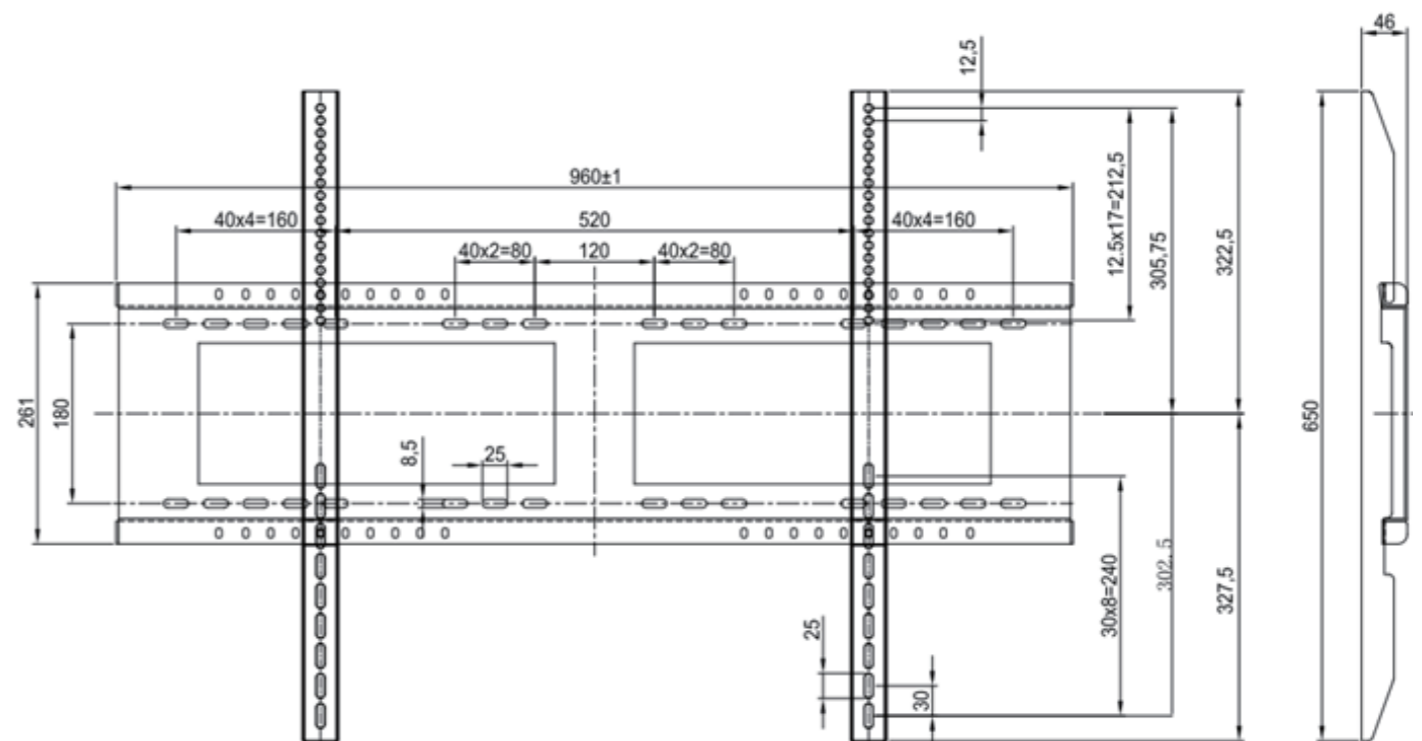

### Installation Environment Attention

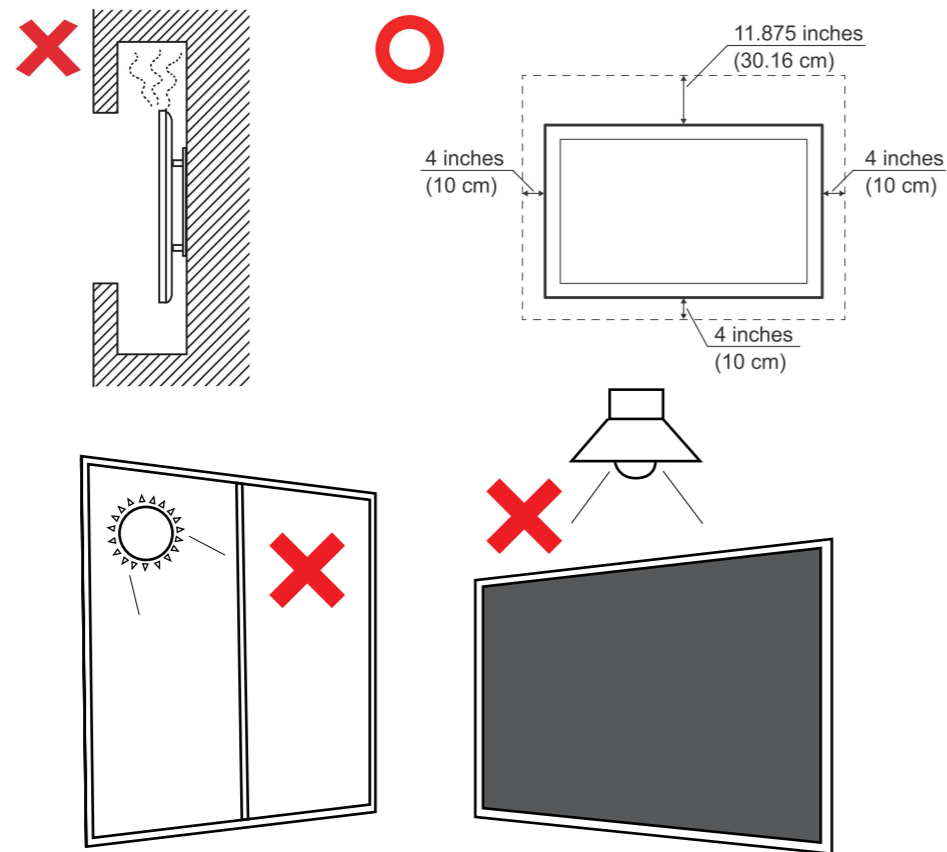

### 3 Control Panel Overview

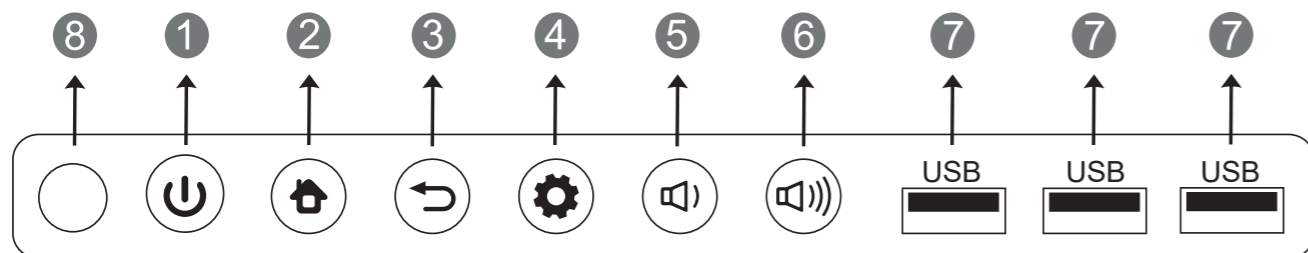

Item	Description
1	Press the key to turn on the device Press the key to turn off/on the display backlight only Press and hold the key to turn off the device
2	Back to Embedded player main interface
3	Return to Embedded player previous level
4	Call up function menu
5	Decrease volume
6	Increase volume
7	USB port for Embedded Player and internal PC
8	Receives signals from the remote control

### 4 Terminal Interface Overview

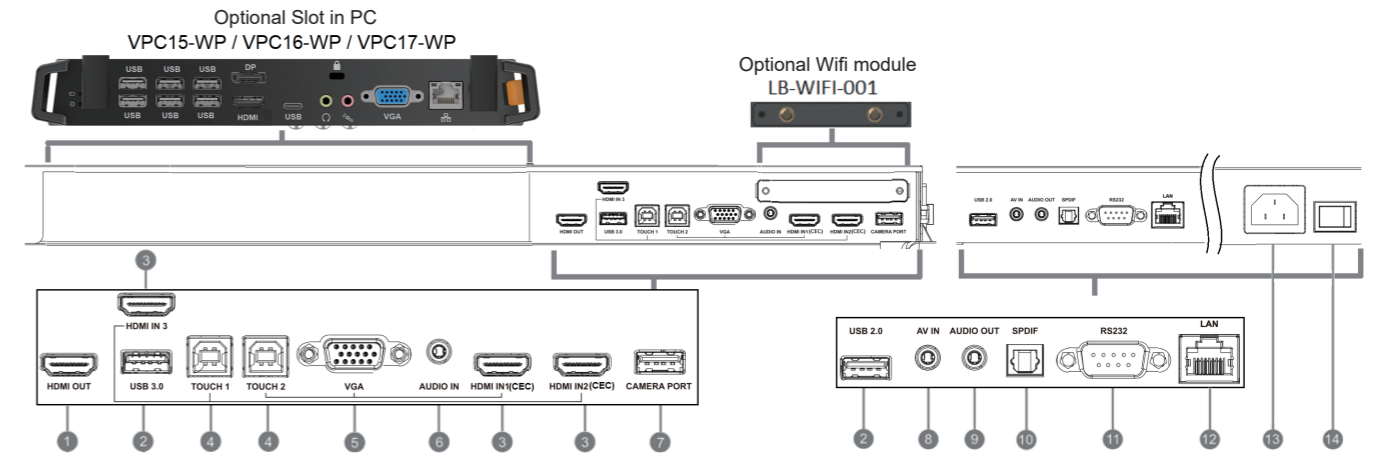

Item	Description
1	Extend content out to another display device
2	USB port for Embedded Player
3	High-definition multimedia interface signal input, connect to PC with HDMI output, set-top box, or other video device HDMI 1, 2, 3 support up to 3840x2160@60Hz, HDCP 2.2 HDMI 1, 2 support HDMI CEC(One Touch Play, System Standby, partial Remote Control Pass Through)
4	Touch signal output to the external PC Touch 1 for HDMI IN 2 and 3 Touch 2 for HDMI IN 1 and VGA IN
5	External computer image input
6	External computer audio input
7	Camera port for Embedded Player and Slot-in PC
8	Composite video and audio input
9	Audio output to the external speaker
10	SPDIF output
11	Serial interface, used for mutual transfer of data between devices
12	Standard RJ45 (10M/100M/1G) Internet connection interface (This network port is used for Embedded Player and Slot in PC)
13	AC power input
14	Power On / Off switch

## 5 Remote Control Overview

- |  |   |
|--|---|
| 1  :<br>Press to turn the display ON/OFF                       | 21  :<br>Press to scroll down                                     |
| 2  :<br>Mute / Unmute  | 22 ENTER:<br>Enter button. Press it to select options.            |
| 3 DISPLAY :<br>Display information of the current input source | 23  , D. USB:<br>Writing software startup                         |
| 4 P.MODE :<br>Blank screen                                     | 24 ESC/EXIT, D. SETUP:<br>Shortcut button to exit dialog boxes    |
| 5 FREEZE :<br>Freeze screen                                    | 25 EPG :<br>Back  |
| 6 Numeric button:<br>Numeric input button                      | 26 FAV, SPACE:<br>PC 'Space' button                               |
| 7  , ALT+TAB:<br>Press to switch between PC applications       | 27 CH. +, CH. - :<br>CH+ : PC previous page<br>CH- : PC next page |
| 8 0 :<br>Numeric input button                                  | 28 VOL+, VOL- :<br>Increase / Decrease volume                     |
| 9  , ALT+F4 :<br>Close current PC window                       | 29 F1:<br>Windows F1 Function                                     |
| 10 INPUT:<br>Source selection button                           | 30 F2:<br>Windows F2 Function                                     |
| 11 MENU:<br>Press to display Menu                              | 31 F3:<br>Windows F3 Function                                     |
| 12 RED+ALT:<br>Screen capture                                  | 32 F4:<br>Windows F4 Function                                     |
| 13 GREEN+TAB:<br>PC 'Tab' button                               | 33 F5:<br>Windows F5 Function                                     |
| 14 YELLOW+DESKTOP:<br>Switch to slot in PC desktop             | 34 F6:<br>Windows F6 Function                                     |
| 15 BLUE+BACKSPACE:<br>PC 'Backspace' button                    | 35 F7:<br>Windows F7 Function                                     |
| 16  , 19 MENU:<br>PC 'Windows' button                          | 36 F8:<br>Windows F8 Function                                     |
| 17  , D. TITLE:<br>PC 'Menu' button                            | 37 F9:<br>Windows F9 Function                                     |
| 18  :<br>Press to scroll up                                    | 38 F10:<br>Windows F10 Function                                   |
| :<br>Press to scroll left                                      | 39 F11:<br>Windows F11 Function                                   |
| 20  :<br>Press to scroll right                                 | 40 F12:<br>Windows F12 Function                                   |

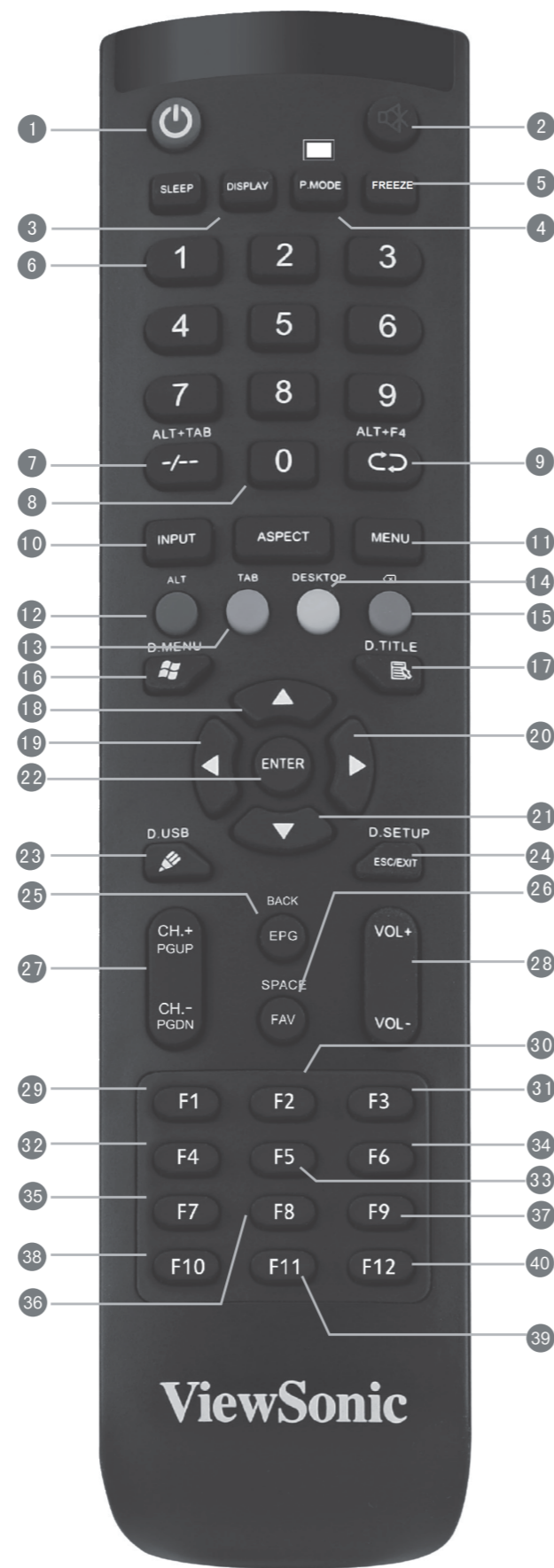

## 6 Connecting an External PC

- To display video and sound from an external PC follow the instructions below:  
**Note:** External PCs can also be connected to the display via HDMI cable.
  - Connect a VGA cable (15-pin) from your external PC to the VGA IN port on the display.
  - Connect an audio cable from the AUDIO OUT port on your external PC to the AUDIO IN port on the display.
- Connect a USB cable to the external PC from the TOUCH OUT port of the display.  
**Note:** For optimal results, select 1920x1080p as the external computer's input resolution.

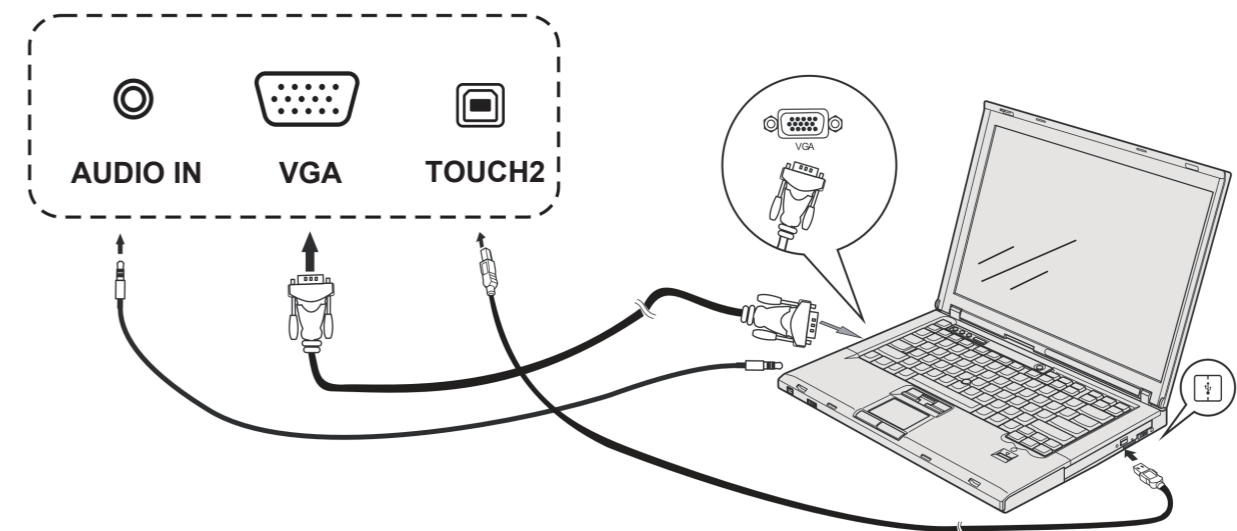

## 7 RS232 Connections

When you use an RS232 serial port cable to connect your display to an external computer, certain functions can be controlled by the PC, including power on/off, volume adjustment and more.

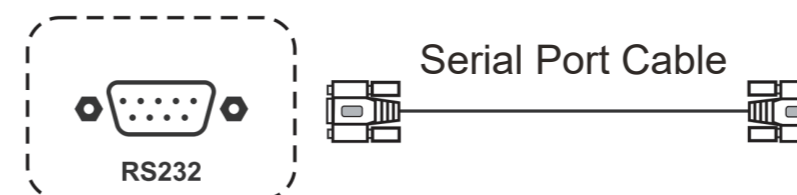

## 8 Connecting USB Peripherals

1. USB Peripherals: Plug the USB device cable into the USB IN port.
2. Networking and modem cables: Plug the router cable into the LAN IN port.
3. Microphone: Plug the microphone cable into the MIC port.

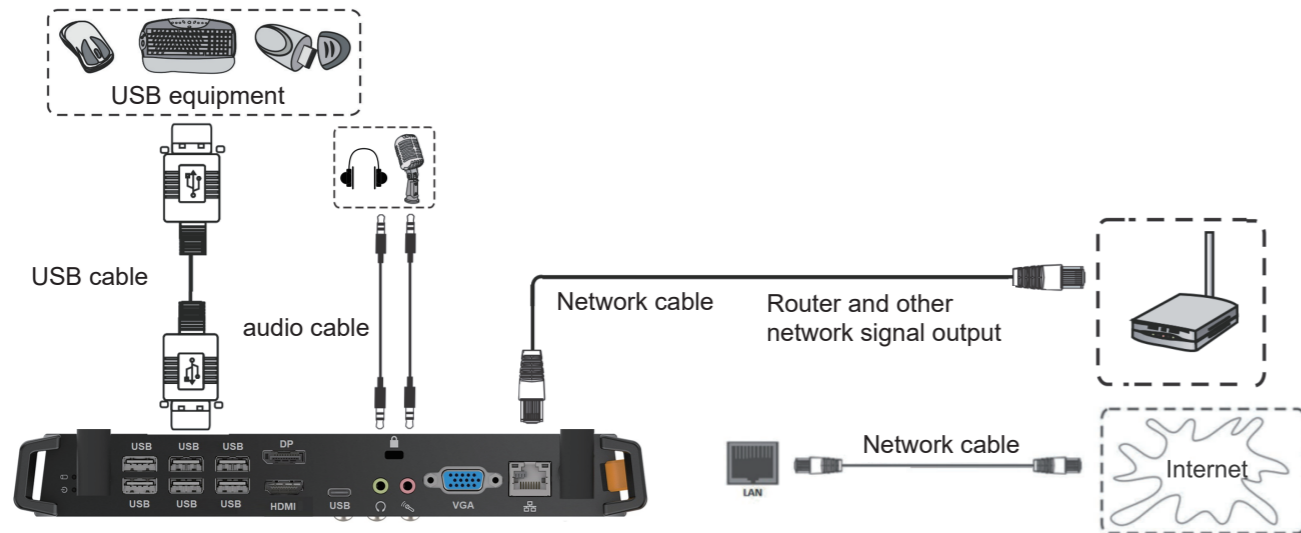

## 9 HDMI Connections

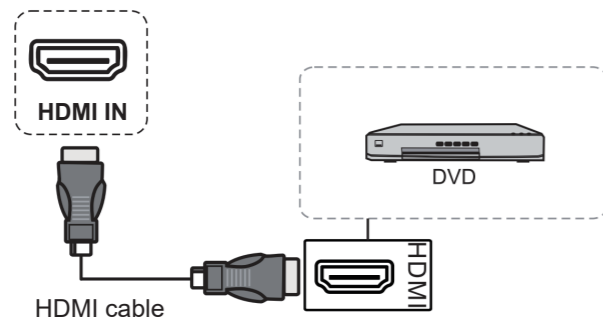

## 10 General Setting

Input sources, Volume, Back light, and Flicker free

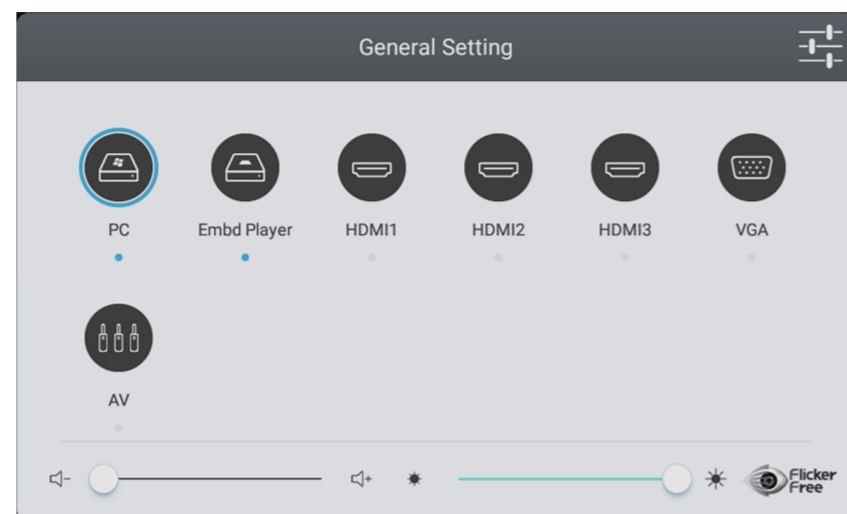

## 11 More OSD settings

### Audio Setting

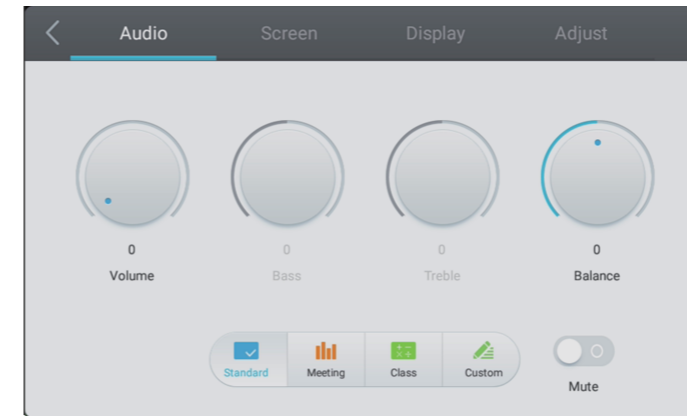

### Screen Setting

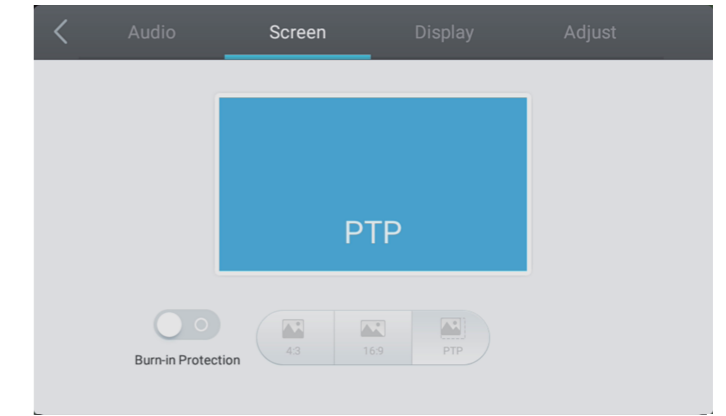

### Display Setting

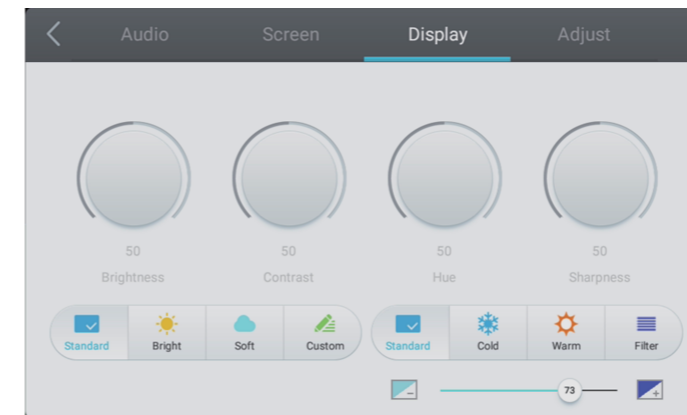

### Adjust Setting

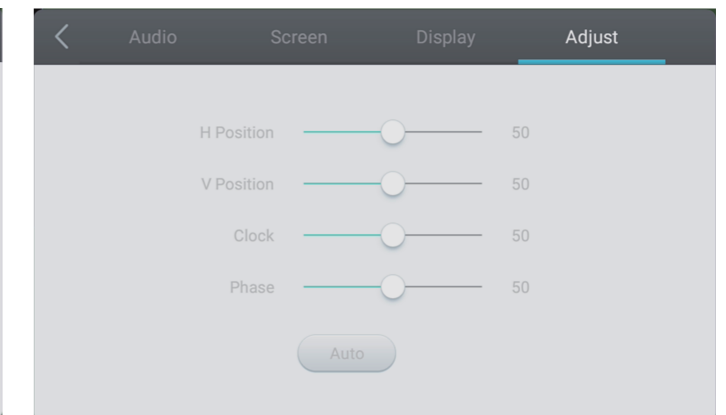







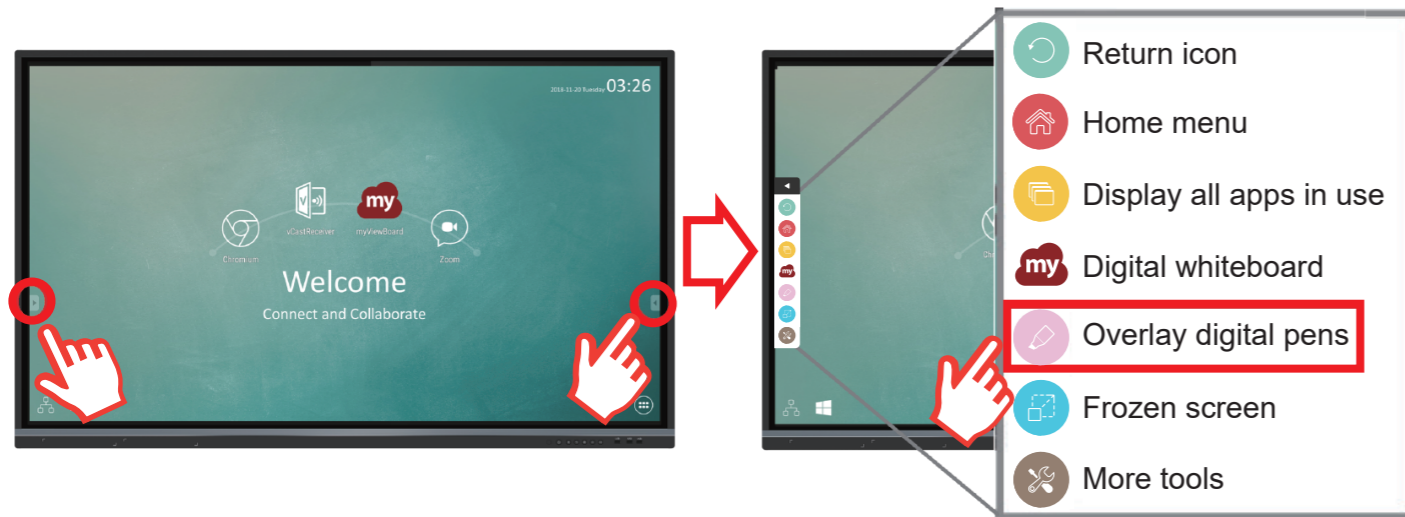

Item	Description	Item	Description
	Click to launch annotation app		Click to open web browser
	Click to show wireless screen sharing app		Click to open cloud meeting
	Click to switch to Slot-in PC source		Click to pop up app list

## 12 Annotation(Overlay digital pens)







Tool bar tigger icons are on the edge of the ViewBoard laucher



















Item	Description
 Pen	Click the pen tool icon and pop up the "Pen, Clear, and Save option" tool bar       
	① Digital pen With four colors options in red, black, blue, and green (rotate in sequence), that can annotate overlay any input source. Note: the default setting of digital pen supports up to 10-point writing
	② Digital highlighter pen With the transparency setting and four color options of yellow, orange, blue, and green (rotate in sequence). The default setting is 10-point marking
	③ Brush Click the "brush icon" to clean all the digital inking on the screen
	④ Save as Click to save the on-screen image into internal storage
	⑤ Writing mode Transparent mode: Screen won't be frozen, the screen resolution won't be reduced to 1080P. Opaque mode: Screen will be frozen, the screen resolution will be reduced to 1080P.
	⑥ Picture save Speed priority: Save the on-screen image to 1920x1080, the save speed is fast. Quality priority: Save the on-screen image to 3840x2160, it will spend around 10 seconds for saving. Note: In opaque(non-transparent) mode, the user can't select the Picture Save setting.
⑦ Close Click to close the digital pen icon	

## 13 myViewBoard Software

### Floating Bar

-  Move the Floating Bar.
  -  Switch between presentation and preparation modes.
  -  Paste from the clipboard onto the canvas.
  -  Open the embedded browser.
  -  Go to the previous page.
  -  Go to the next page.
  -  Add a new page.
1. New MyViewBoard File
  2. Open File
  3. Save File

	Full Screen Capture	
	Toolbar Move Button	Click/Touch and hold to move the toolbar to Left side, Right side, or bottom of the screen.
	File Button	
	 <ol style="list-style-type: none"> <li>1. New MyViewBoard File</li> <li>2. Open File</li> <li>3. Save File</li> </ol>	<ol style="list-style-type: none"> <li>4. Save As File</li> <li>5. Export</li> <li>6. Email</li> </ol>
	Import resources (image, video, audio...) to the whiteboard	
	Infinite Canvas Button	Click – Use two hands to zoom in/out on/of the working panel
	Selection Button	Select objects, text, and pictures to get other tools
	Pen Button	Writing tools, changing colors, transparency, thickness, etc.
	Using eraser to erase objects or clean the page	
	Shape/Line Button	Create shapes, select shape colors, insert arrows.
	Textbox	Creates a Textbox
	Undo Button	Undo previous actions
	Redo Button	Redo previous actions
	Page Toggle Button	Select pages, sort pages, delete pages
	Showing or hiding the current host information.	
	Whiteboard background management menu.	

# 14 ViewBoard Cast

Working with ViewBoard® Cast software, the vCastReceiver app, will allow ViewBoard® to receive mobile users' screens, photos, videos, annotations, and camera.

### Network information

- ViewBoard® and mobile devices need to link to the same LAN network subnet.
- Ports :
  - TCP 56789, 25123, 8121 & 8000
  - UDP 48689, 25123
- Port for activation:
  - Port: 8001

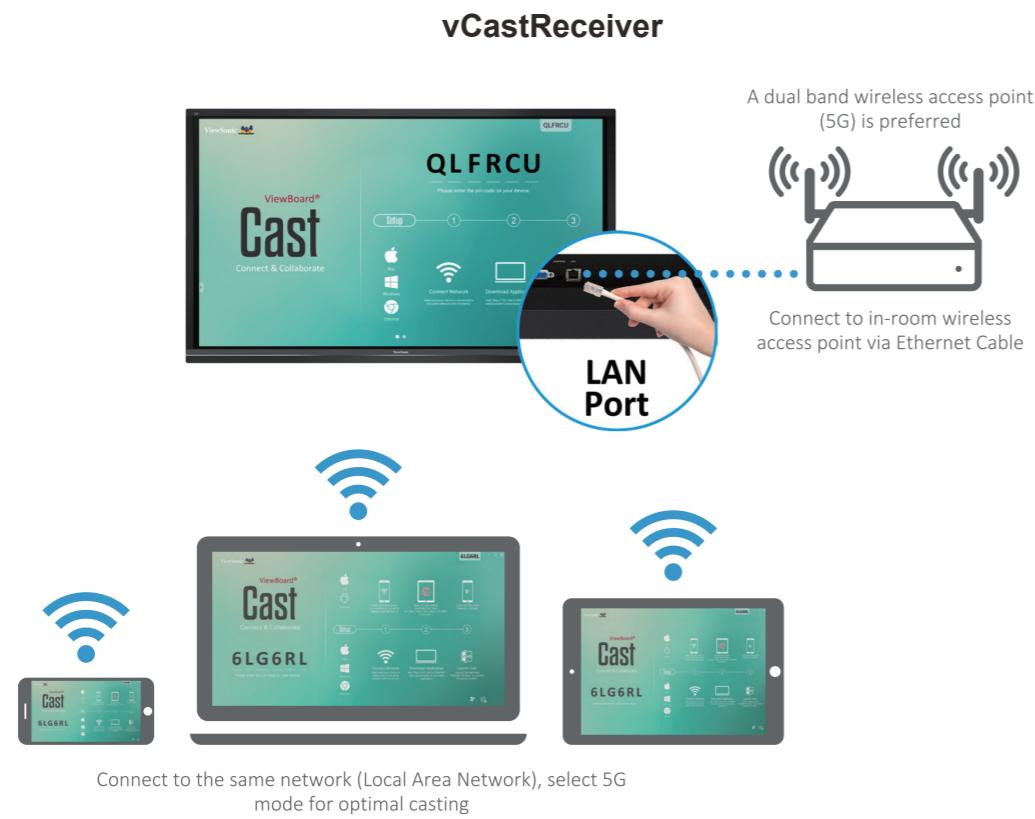

# 15 Folders

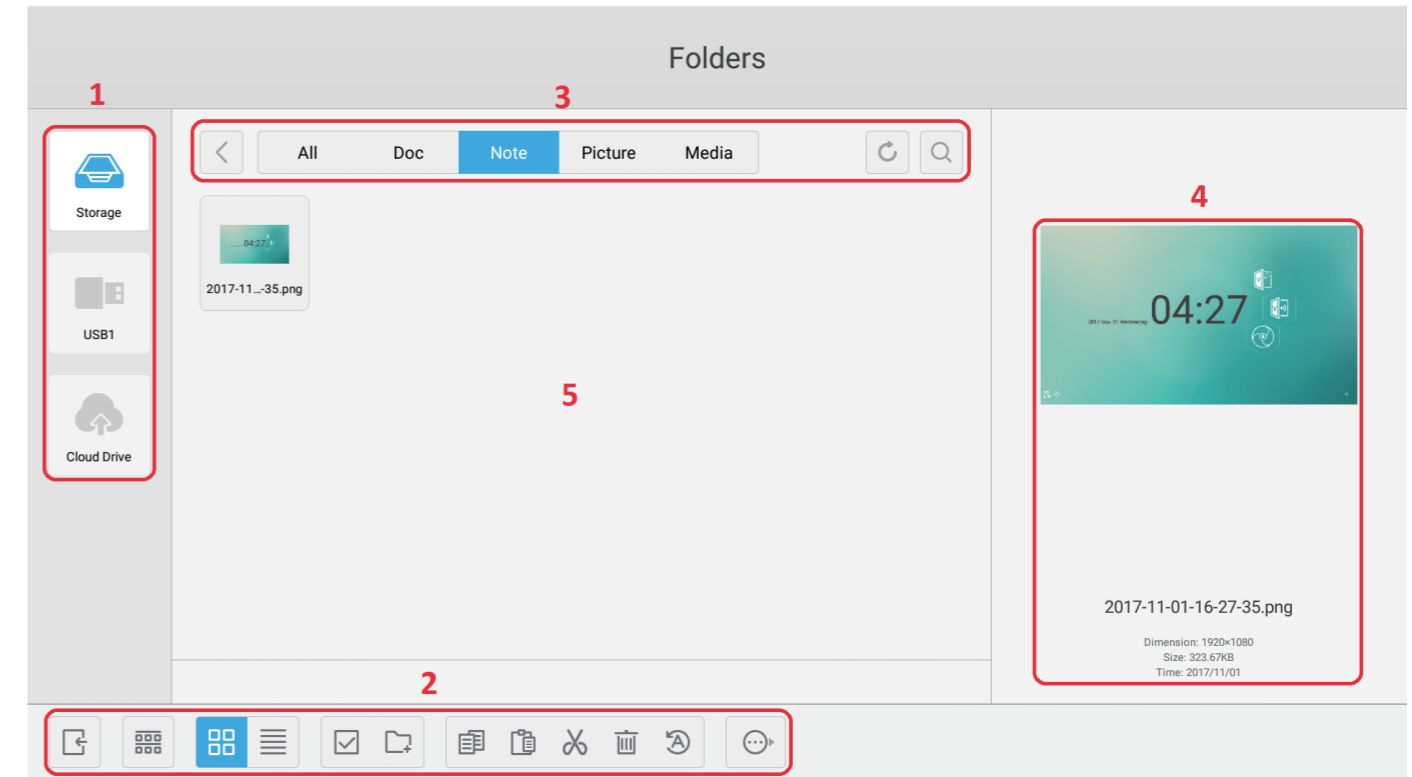

Item	Description
Exit	Click to exit.
Sort	Click to sort files.
Thumbnail	Click to display files by thumbnail.
List	Click to display files by list.
Select	Click to select file.
Add folder	Click to add folder.
Copy	Click to copy file.
Paste	Click to paste file.
Cut	Click to cut file.
Delete	Click to delete file.
Rename	Click to rename file.
More	Click to show more functions.