

# FSR WE-IPAD2/IPAD2NB INSTALLATION INSTRUCTIONS

244 Bergen Boulevard, Woodland Park, NJ 07424, Phone: 973.785.4347 - Fax: 973.785.4207

1. REMOVE COVER FROM BASE AS SHOWN.

2. SECURE BASE TO WALL (SEE BACK OF THIS PAGE).

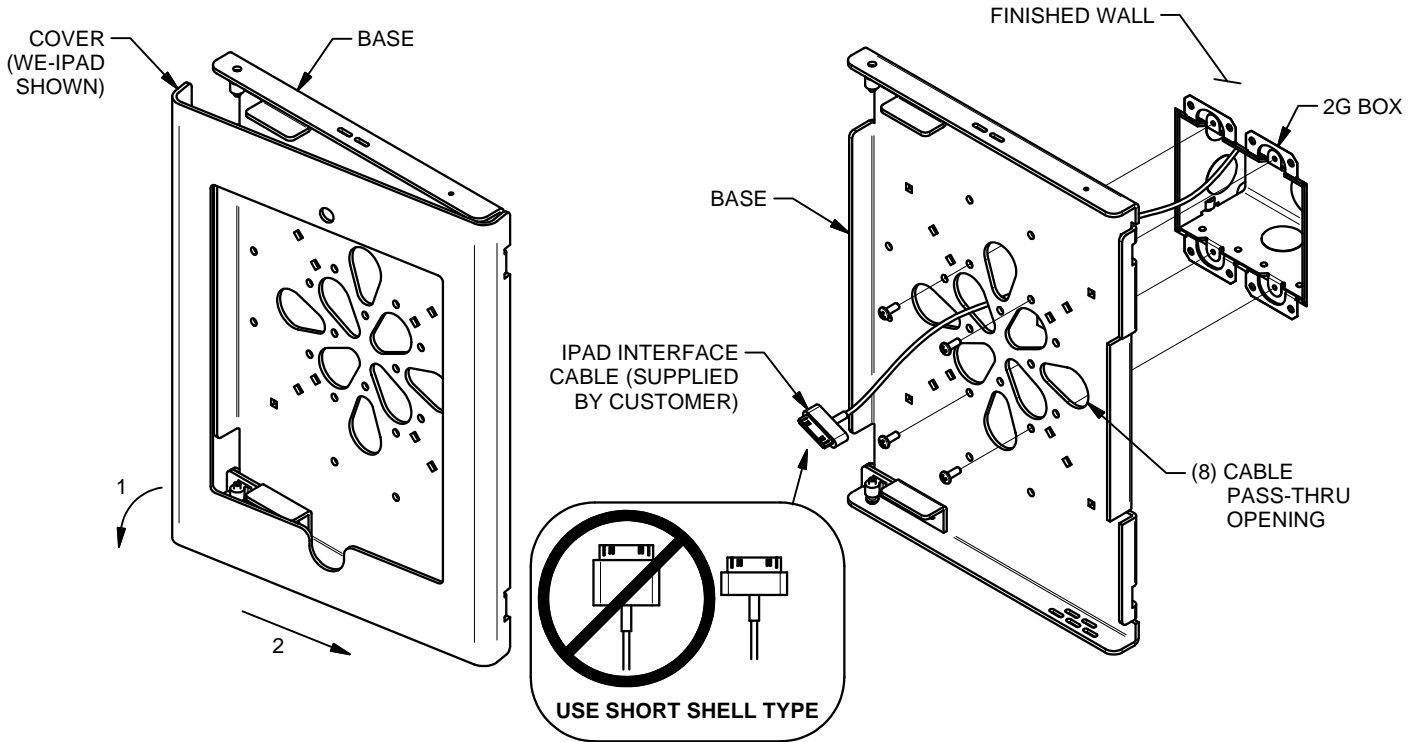

3. INSTALL PROVIDED SILICON SLEEVE TO IPAD (SUPPLIED BY CUSTOMER) AND MAKE ELECTRICAL CONNECTIONS AS REQUIRED. POSITION IPAD IN BASE AND SUPPORT IPAD FROM FALLING.

4. REINSTALL COVER AS SHOWN WHILE SUPPORTING IPAD FROM FALLING.

5. TIGHTEN (2) LOCKING SCREW COMPLETELY WITH SUPPLIED DRIVER. DO NOT OVER TIGHTEN.

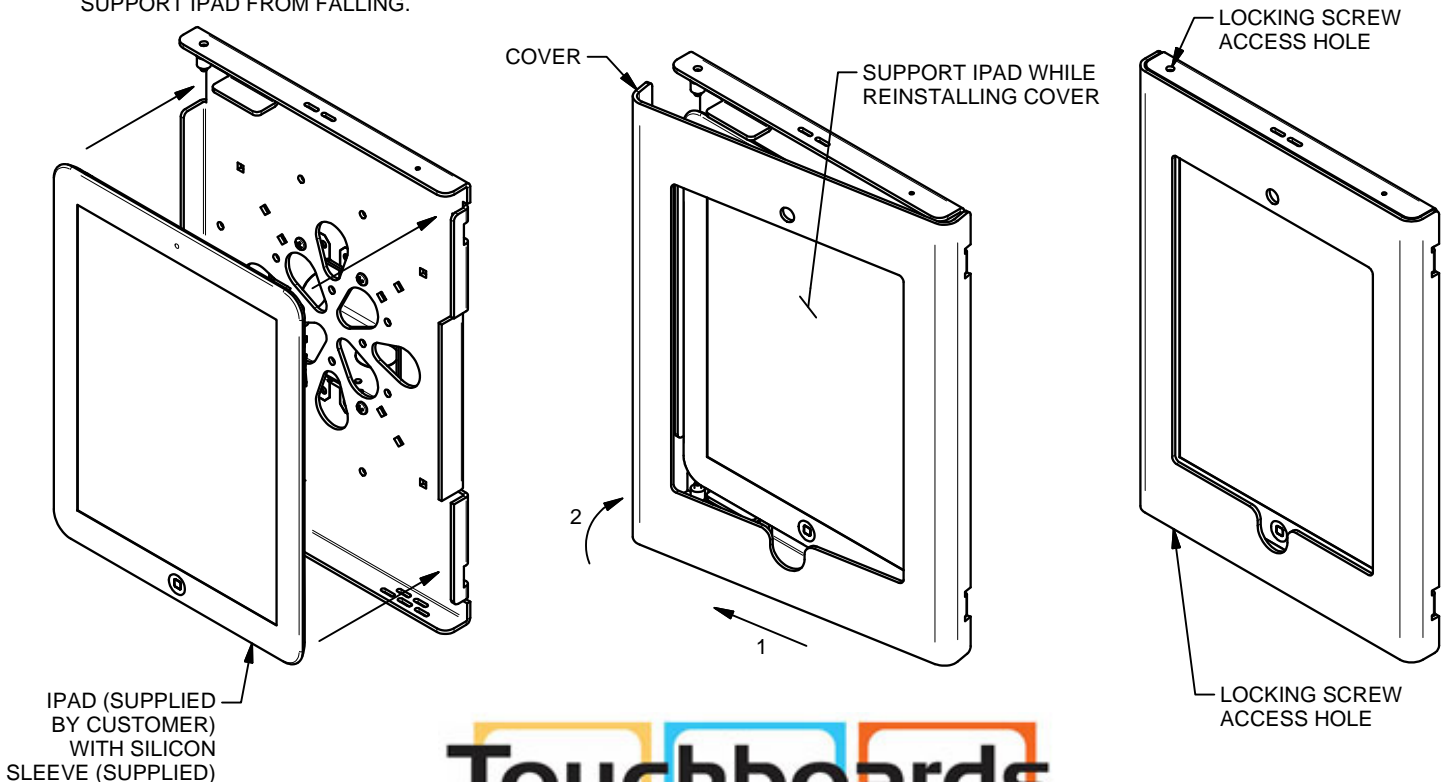

## Touchboards

205 Westwood Ave, Long Branch, NJ 07740  
 Phone: 866-94 BOARDS (26273) / (732)-222-1511  
 Fax: (732)-222-7088 | E-mail: sales@touchboards.com

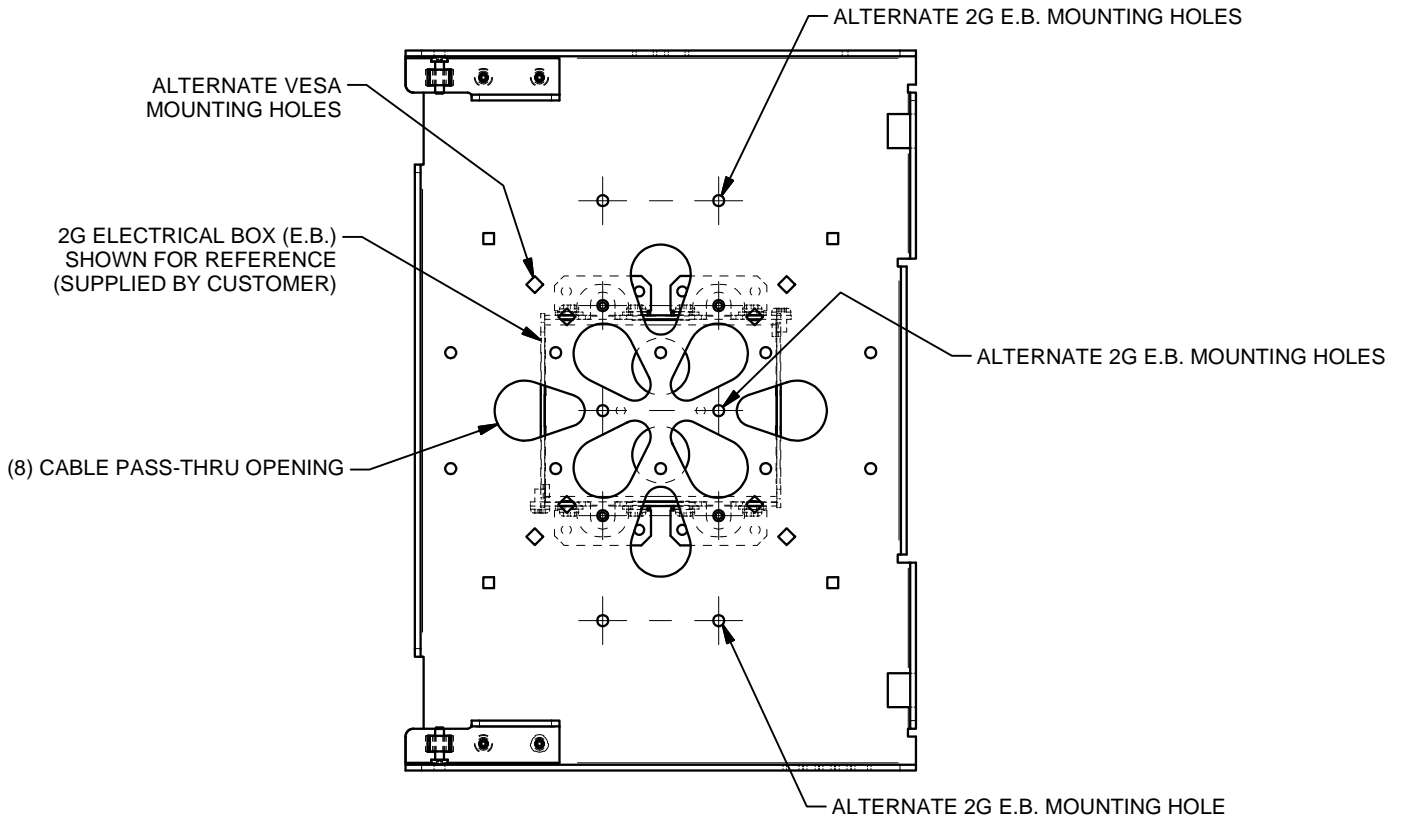

OR

