

# FEEL THE DIFFERENCE

Weller®  
Erem

## THE PROVEN CHOICE. EVERY TIME.

### Technology

#### Special tool steel

Machined from high grade laminated tool steel for strength and toughness

#### Invisible Magic Spring licensed

- return Magic Spring internally mounted
- constant opening and closing force
- 1 million operations guaranteed

#### Selflocking screwing system

- machined surfaces hold together by an interlocking precision screw
- ensures wobble free operation
- eliminates blade overlap

#### Blade opening limited from 4 mm to 7 mm

reduces operator fatigue by limiting the handle spread

### Cut – blade specificity

#### Cut

Blade finished to ensure sharpness and alignment

#### A choice of 3 cut options

- Semi Flush
- Flush
- Super Full Flush

#### Additional accessory:

Safety device for holding wire scraps

### Service

#### Guarantees

perfect functioning of cutters / pliers and the quality of the steel. Each tool being made with care and precision.

#### Resharpener Service

All Weller Erem side and tip cutters except those with carbide insert blades can be resharpened for free up-to three times. Carriage charges will apply.

### Series 2400 MagicSense

#### Blade hardening

by induction heat treatment to 63–65 HRC Rockwell to impart strength and long life

#### Grips

- soft for operator and reduce fatigue
- firm for increased operator control
- non slip for better grip

#### Ergonomic shape

- automatically positions the operators hand to spread pressure evenly over the tool handles to reduce the incidence of trauma disorders to the fingers, hand, wrist and arm

#### ESD safe

## For more information please contact

Weller Tools GmbH  
info@weller-tools.com  
www.weller-tools.com

Online catalog available at  
weller-tools.com under  
"DOWNLOAD CENTER/BROCHURES"

## THE PERFECT CUT

Strong, sharp and precise - every time



Side cutters for use in medical device manufacturing



Tip cutters to remove fine pitch SMD ICs



Tungsten-carbide cutter for the preparation of cardio-vascular stents



Ergonomic cutter with small cutting head



Tweezers for biology and laboratory applications



Tweezers for use in the jewelry industry

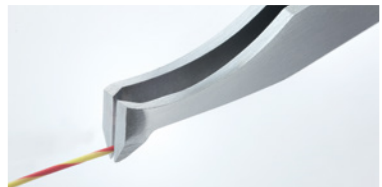

Cutting tweezers for electronics and medical laboratory applications

Weller®

Weller Tools GmbH  
Carl-Benz-Straße 2  
74354 Besigheim

Tel: +49 (0) 7143 580-0  
Fax: +49 (0) 7143 580-108

www.weller-tools.com

Weller® and Erem® are registered trademarks of  
Apex Brands, Inc. | © 2022

### 3 Sizes

	Micro		Medium		Maxi	
	<b>Series 600 / 2600</b>		<b>Series 500</b>		<b>Series 800 / 2800</b>	
					<b>Series 2400 MagicSense</b>	
Width a	9,0 mm	9,0 mm	11,0 mm	11,0 mm	13,5 mm	13,5 mm
Thickness b	6,0 mm	6,0 mm	6,0 mm	6,0 mm	7,2 mm	7,2 mm

### How to choose the right tool?

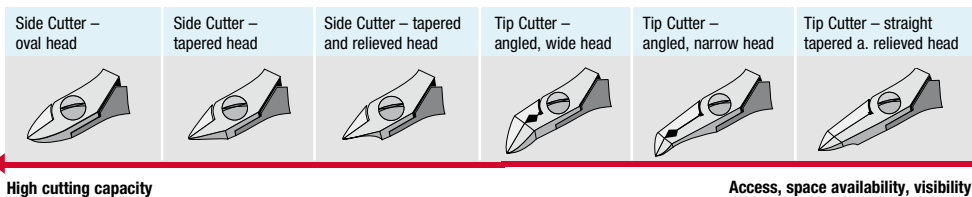

### Cutting Capabilities

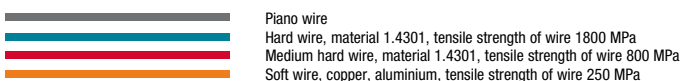

### Type Type of Cut Cutting Capacity

#### Series 600 Micro & 2600

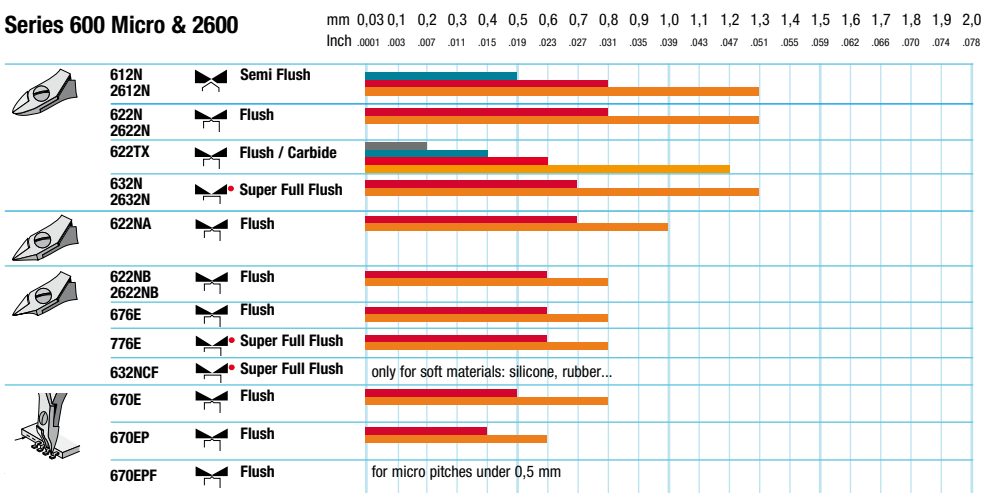

#### Series 2400 MagicSense

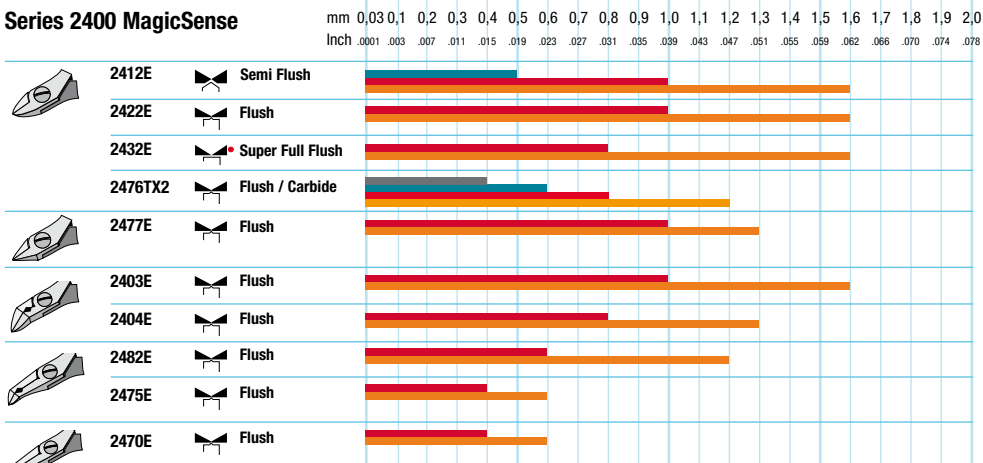

#### Series 500 Medium

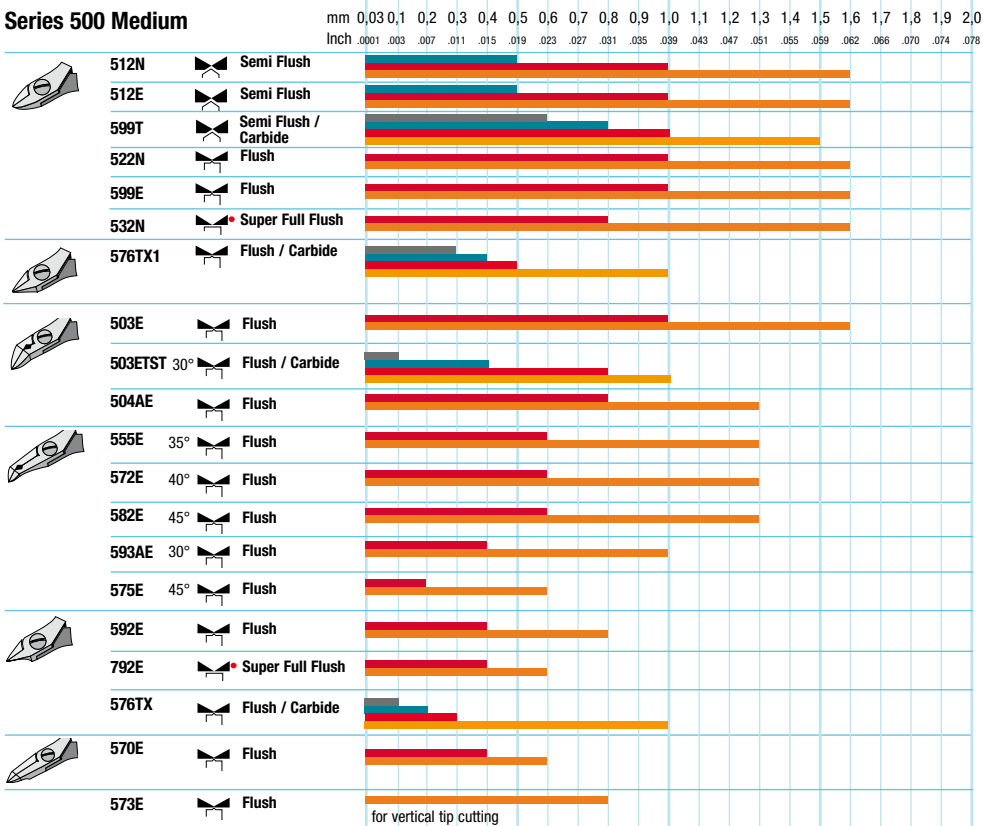

#### Series 800 Maxi & 2800

