

8100 SA 11 Zyklop Metal Ratchet Set with switch lever, 1/4" drive, imperial, 28 pieces  
The Zyklop Metal Ratchet Switch, 1/4"



<b>EAN:</b>	4013288173850	<b>Size:</b>	205x90x55 mm
<b>Part number:</b>	05004021001	<b>Weight:</b>	680 g
<b>Article number:</b>	8100 SA 11	<b>Country of origin:</b>	CZ
		<b>Customs tariff number:</b>	82041100

- Extremely slim ratchet with long lever
- Return angle of only 5°
- Convenient direction change thanks to switchover lever
- With Take it easy tool finder: colour coding by size

Incredibly compact set arrangement with many tools in a minimum of space. A completely new ratchet set feeling thanks to the unique textile boxes that are very robust and durable. They can be positioned upright for tidy storage on the workshop shelf. Additional surface protection due to textile outer material. Low weight and volume for simpler mobility. "Take it easy" Tool Finder with colour coding according to sizes.



**Web link**

[https://products.wera.de/en/zyklop\\_ratchets\\_and\\_accessories\\_the\\_zyklop\\_ratchets\\_the\\_zyklop\\_ratchets\\_1\\_4\\_the\\_zyklop\\_metal\\_ratchet\\_switch\\_1\\_4\\_8100\\_sa\\_11.html](https://products.wera.de/en/zyklop_ratchets_and_accessories_the_zyklop_ratchets_the_zyklop_ratchets_1_4_the_zyklop_metal_ratchet_switch_1_4_8100_sa_11.html)

Wera - 8100 SA 11  
05004021001 - 4013288173850

Wera Werkzeuge GmbH  
Korzter Straße 21-25  
D-42349 Wuppertal  
Tel: +49 (0)2 02 / 40 45-0  
E-Mail: info@wera.de

# 8100 SA 11 Zyklop Metal Ratchet Set with switch lever, 1/4" drive, imperial, 28 pieces

## The Zyklop Metal Ratchet Switch, 1/4"



### Zyklop Metal Switch

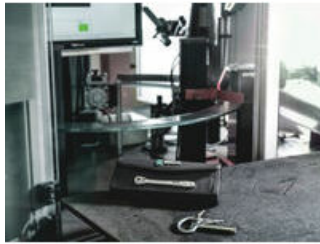

Due to the ever-more confined working environment, space is becoming more and more an issue for the application of ratchets. Our product developers therefore intensively occupied themselves with the issue of confined working spaces, and Wera has now solved this problem. The extremely slim and robust Zyklop Metal ratchet with a long lever was what emerged. When the change in direction needs to be quick, the Zyklop Metal Switch ratchet is the right tool. When the socket must not get lost and a coincidental change of direction has to be avoided at all cost, the Zyklop Metal Push is the correct choice.

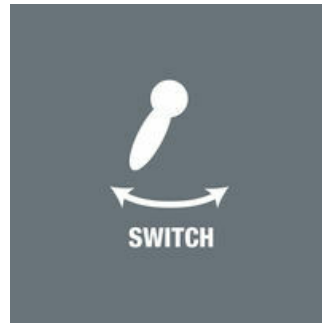

Due to the ever-more confined working environment, space is becoming more and more an issue for the application of ratchets. Our product developers therefore intensively occupied themselves with the issue of confined working spaces, and Wera has now solved this problem. The extremely slim and robust Zyklop Metal ratchet with a long lever was what emerged. When the change in direction needs to be quick, the Zyklop Metal Switch ratchet is the right tool. When the socket must not get lost and a coincidental change of direction has to be avoided at all cost, the Zyklop Metal Push is the correct choice.

### Slim design



Forged, full metal ratchet (chrome-molybdenum) that is extremely robust with a long service life; slim design to enable work in very confined spaces.

### Reversible



Switch lever for convenient change of direction.

#### Web link

[https://products.wera.de/en/zyklop\\_ratchets\\_and\\_accessories\\_the\\_zyklop\\_ratchets\\_the\\_zyklop\\_ratchets\\_1\\_4\\_the\\_zyklop\\_metal\\_ratchet\\_switch\\_1\\_4\\_8100\\_sa\\_11.html](https://products.wera.de/en/zyklop_ratchets_and_accessories_the_zyklop_ratchets_the_zyklop_ratchets_1_4_the_zyklop_metal_ratchet_switch_1_4_8100_sa_11.html)

Wera - 8100 SA 11  
05004021001 - 4013288173850

Wera Werkzeuge GmbH  
Korzter Straße 21-25  
D-42349 Wuppertal  
Tel: +49 (0)2 02 / 40 45-0  
E-Mail: [info@wera.de](mailto:info@wera.de)

# 8100 SA 11 Zyklop Metal Ratchet Set with switch lever, 1/4" drive, imperial, 28 pieces

## The Zyklop Metal Ratchet Switch, 1/4"



### Small return angle



Fine-pitched with 72 teeth for a return angle of only 5°

### Take it easy tool finder system



Take it easy tool finder system - with profile and size colour-coding for quick and easy tool selection. Colour-coded system for hexagon drive screws (L-Keys, Zyklop bit sockets), external hex drive screws and nuts (Joker wrenches, Zyklop sockets and Zyklop bit sockets with holding function), and TORX® drive screws (L-Keys, Zyklop bit sockets).

### Textile boxes



The textile boxes offer dramatically improved portability, and are space-saving to boot! This means you can now carry the same collection of tools, in a much more compact and comfortable package. The hassle of running back and forth for the right tools has now become a thing of the past. And the much lower weight of a set makes carrying more convenient than ever before. The textile box including the tool will even survive a fall undamaged.

### Secure hold and easy removal

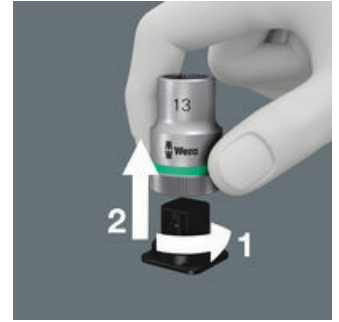

The all new smooth turning mechanism guarantees both secure and rattle-free storage, yet allows easy removal of the tool.

### Web link

[https://products.wera.de/en/zyklop\\_ratchets\\_and\\_accessories\\_the\\_zyklop\\_ratchets\\_the\\_zyklop\\_ratchets\\_1\\_4\\_the\\_zyklop\\_metal\\_ratchet\\_switch\\_1\\_4\\_8100\\_sa\\_11.html](https://products.wera.de/en/zyklop_ratchets_and_accessories_the_zyklop_ratchets_the_zyklop_ratchets_1_4_the_zyklop_metal_ratchet_switch_1_4_8100_sa_11.html)

Wera - 8100 SA 11  
05004021001 - 4013288173850

Wera Werkzeuge GmbH  
Korzter Straße 21-25  
D-42349 Wuppertal  
Tel: +49 (0)2 02 / 40 45-0  
E-Mail: [info@wera.de](mailto:info@wera.de)

# 8100 SA 11 Zyklop Metal Ratchet Set with switch lever, 1/4" drive, imperial, 28 pieces

## The Zyklop Metal Ratchet Switch, 1/4"



### Set contents:

#### 8004 A Zyklop Metal Ratchet with switch lever and 1/4" drive, 1/4" x 141 mm



05004004001 1x 1/4" x 141 mm



#### 8790 HMA Zyklop 1/4" socket, 3/16" x 23 mm



05003514001 1x 3/16" x 23 mm

05003515001 1x 7/32" x 23 mm

05003516001 1x 1/4" x 23 mm

05003517001 1x 9/32" x 23 mm

05003518001 1x 5/16" x 23 mm

05003519001 1x 11/32" x 23 mm

05003520001 1x 3/8" x 23 mm

05003521001 1x 7/16" x 23 mm

05003522001 1x 1/2" x 23 mm



#### 8794 LA Zyklop extension with free-turning sleeve, long, 1/4", 1/4" x 150 mm



05003526001 1x 1/4" x 150 mm



#### 8794 A Zyklop wobble extension, 1/4", 1/4" x 56 mm



05003527001 1x 1/4" x 56 mm



#### 8784 A1 Zyklop bit adaptor, 1/4", 1/4" x 37 mm



05003529001 1x 1/4" x 37 mm



#### 851/1 Z bits, PH 1 x 25 mm



05072070001 1x PH 1 x 25 mm

05072072001 1x PH 2 x 25 mm

05072074001 1x PH 3 x 25 mm



#### 855/1 Z bits, PZ 1 x 25 mm



05072080001 1x PZ 1 x 25 mm

05072082001 1x PZ 2 x 25 mm



#### 867/1 TORX® bits, TX 10 x 25 mm



05066485001 1x TX 10 x 25 mm

05066486001 1x TX 15 x 25 mm

05066487001 1x TX 20 x 25 mm

05066488001 1x TX 25 x 25 mm

05066489001 1x TX 27 x 25 mm

05066490001 1x TX 30 x 25 mm



### Web link

[https://products.wera.de/en/zyklop\\_ratchets\\_and\\_accessories\\_the\\_zyklop\\_ratchets\\_the\\_zyklop\\_ratchets\\_1\\_4\\_the\\_zyklop\\_metal\\_ratchet\\_switch\\_1\\_4\\_8100\\_sa\\_11.html](https://products.wera.de/en/zyklop_ratchets_and_accessories_the_zyklop_ratchets_the_zyklop_ratchets_1_4_the_zyklop_metal_ratchet_switch_1_4_8100_sa_11.html)

Wera - 8100 SA 11  
05004021001 - 4013288173850

Wera Werkzeuge GmbH  
Korzter Straße 21-25  
D-42349 Wuppertal  
Tel: +49 (0)2 02 / 40 45-0  
E-Mail: info@wera.de

# 8100 SA 11 Zyklop Metal Ratchet Set with switch lever, 1/4" drive, imperial, 28 pieces

The Zyklop Metal Ratchet Switch, 1/4"



## 840/1 Z bits, 5/32" x 25 mm



05135074001	1x	5/32" x 25 mm
05135075001	1x	3/16" x 25 mm
05135076001	1x	1/4" x 25 mm
05135079001	1x	7/32" x 25 mm

### Web link

[https://products.wera.de/en/zyklop\\_ratchets\\_and\\_accessories\\_the\\_zyklop\\_ratchets\\_the\\_zyklop\\_ratchets\\_1\\_4\\_the\\_zyklop\\_metal\\_ratchet\\_switch\\_1\\_4\\_8100\\_sa\\_11.html](https://products.wera.de/en/zyklop_ratchets_and_accessories_the_zyklop_ratchets_the_zyklop_ratchets_1_4_the_zyklop_metal_ratchet_switch_1_4_8100_sa_11.html)

Wera - 8100 SA 11  
05004021001 - 4013288173850

Wera Werkzeuge GmbH  
Korzter Straße 21-25  
D-42349 Wuppertal  
Tel: +49 (0)2 02 / 40 45-0  
E-Mail: [info@wera.de](mailto:info@wera.de)