

ELEVATE WIND

Tiered Soft Seating



MOORECO™



CONSTRUCTION & FEATURES:

- Modular seating creates a multitude of spaces for establishing privacy, collaboration or relaxation.
- Coordinates with other members of the Elevate Wind soft seating family to configure in multiple arrangements. Ganging devices included.
- Top stitched sewing details in upholstery. Textiles available through graded-in fabric program, or COM by approval. Includes nylon glides.
- Manufactured in the USA from commercial grade ¾" plywood and hardwoods.
- Twelve year limited warranty on seating. SCS Indoor Advantage Gold Certified.
- Prop 65 and CAL 117-2013 compliant. 400 lb. capacity.

AVAILABLE UPGRADES:



Two or more fabrics



Power Add-On



Tablet Arm Add-On



CAL 133 Compliance



Moisture Barrier

ELEVATE WIND:

Lounge Chair
TS1020

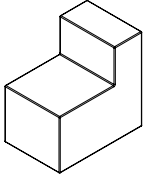

30"H x 20"W x 30"D • 77 lbs

2-Sided Lounge Chair
TS1021

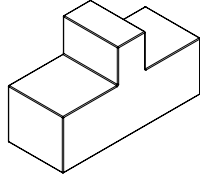

30"H x 20"W x 50"D • 115 lbs

1-½ Seat Lounge Chair
TS1022

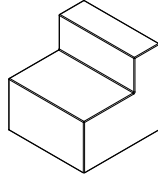

30"H x 30"W x 30"D • 115 lbs

2-Sided 1-½ Seat Chair
TS1023

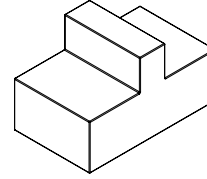

30"H x 30"W x 50"D • 155 lbs

Loveseat
TS1024

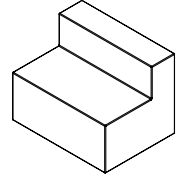

30"H x 40"W x 30"D • 145 lbs

2-Sided Loveseat
TS1025

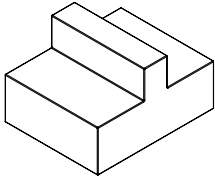

30"H x 40"W x 50"D • 195 lbs

Corner Lounge Chair
TS1026

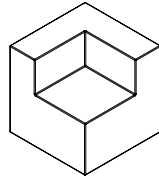

30"H x 30"W x 30"D • 97 lbs

Sofa
TS1027

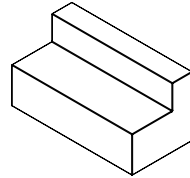

30"H x 60"W x 30"D • 231 lbs

1-½ Seat Bench
TS1028

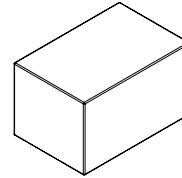

18"H x 30"W x 20"D • 80 lbs

2-Seat Bench
TS1029

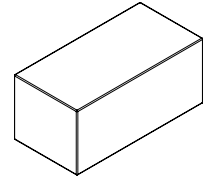

18"H x 40"W x 20"D • 120 lbs

3-Seat Bench
TS1030

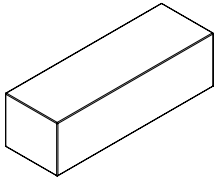

18"H x 60"W x 20"D • 160 lbs

Octagonal Ottoman
TS1031

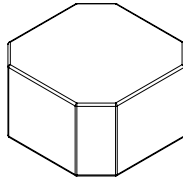

18"H x 32"W x 32"D • 134 lbs

Quartile Bench
TS1032

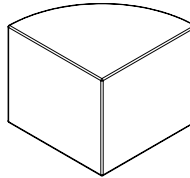

18"H x 28"W x 20"D • 80 lbs

Quartile Chair
TS1033

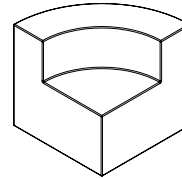

30"H x 42"W x 30"D • 100 lbs

Cube
TS1034

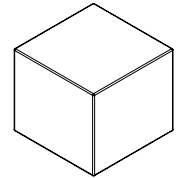

18"H x 20"W x 20"D • 35 lbs

Round Ottoman – 20"
TS1035

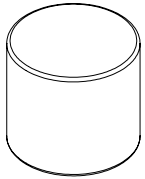

18"H x 20"W x 20"D • 33 lbs

Round Ottoman – 24"
TS1036

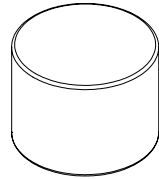

18"H x 24"W x 24"D • 35 lbs

90° Inside Arch
TS1037

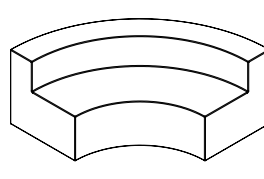

30"H x 85"W x 60"D • 274 lbs

90° Outside Arch
TS1038

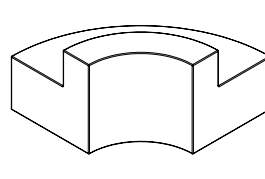

30"H x 70.5"W x 50"D • 240 lbs

90° Arch
TS1039

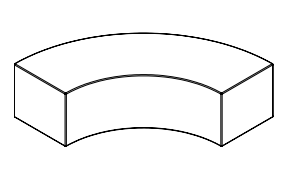

18"H x 60"W x 20"D • 164 lbs

Crescent Bench
TS1040

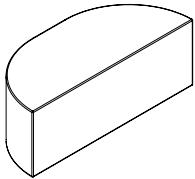

18"H x 50"W x 20"D • 143 lbs

Hexagonal Ottoman
TS1041

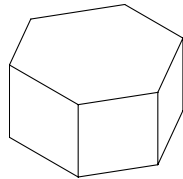

18"H x 37"W x 32"D • 148 lbs

Wedge Pillow
TS1042

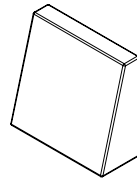

17"H x 18"W x 7.5"D • 4 lbs

POWER OPTIONS:

Face-Up Electrical

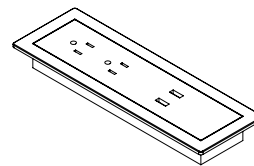

Pop-Up Electrical

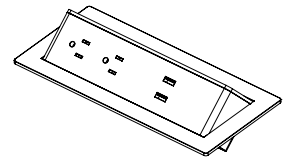

FABRIC OPTIONS:

A full list of graded-in fabrics is available at moorecoinc.com/price-guides. COM fabrics available on approval. View fabrics at mayerfabrics.com or memosamples.com

[VIEW FABRIC GUIDE](#)



MOORECO INC
2885 Lorraine Avenue | Temple, TX 76501
p: 800.749.2258 | f: 866.888.7483
moorecoinc.com

Soft seating ships FOB Tennessee
Rev 06-03-2022