

# SERIES 102 ERSADUR LONGLIFE SOLDERING TIPS

■ All i-CON stations with i-TOOL, i-TOOL NANO or i-TOOL PICO soldering iron

**0102PDLF01/SB**  
pencil point, recessed, 0.1 mm  $\varnothing$

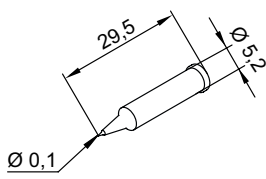

**0102PDLF02/SB**  
pencil point, 0.2 mm  $\varnothing$

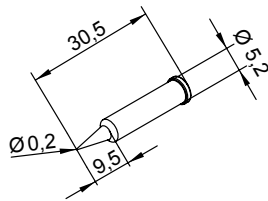

**0102PDLF03/SB**  
pencil point, recessed, 0.3 mm  $\varnothing$

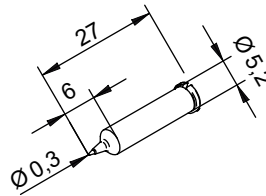

**0102PDLF03L/SB**  
pencil point, extended, 0.3 mm  $\varnothing$

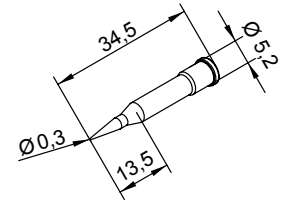

**0102PDLF04/SB**  
pencil point, 0.4 mm  $\varnothing$

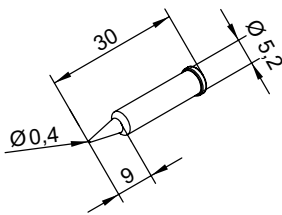

**0102PDLF04L/SB**  
pencil point, extended, 0.4 mm  $\varnothing$

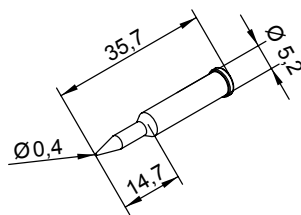

**0102PDLF05L/SB**  
pencil point, extended, 0.5 mm  $\varnothing$

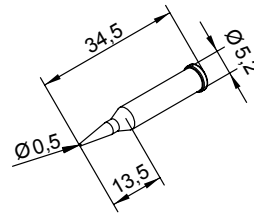

**0102PDLF06/SB**  
pencil point, extended, 0.6 mm  $\varnothing$

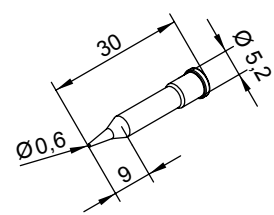

**0102PDLF06L/SB**  
pencil point, extended, 0.6 mm  $\varnothing$

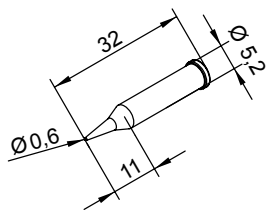

**0102PDLF07/SB**  
pencil point, 0.7 mm  $\varnothing$

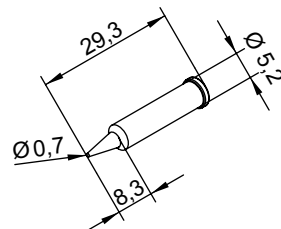

**0102PDLF08L/SB**  
pencil point, extended, 0.8 mm  $\varnothing$

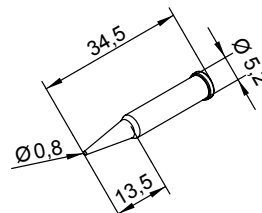

**0102PDLF10/SB**  
pencil point, 1.0 mm  $\varnothing$

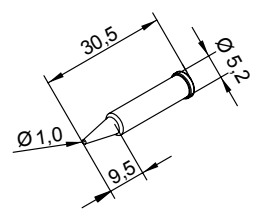

**0102CDLF04/SB**  
chisel-shaped, 0.4 mm

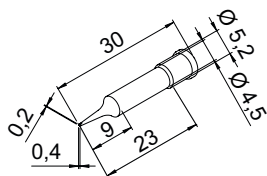

**0102CDLF12/SB**  
chisel-shaped, 1.2 mm

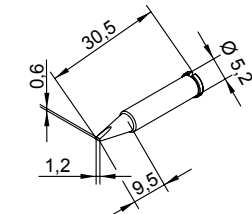

**0102CDLF16/SB**  
chisel-shaped, 1.6 mm

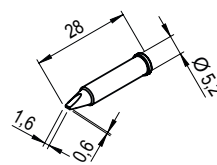

**0102CDLF18L/SB**  
chisel-shaped, extended, 1.8 mm

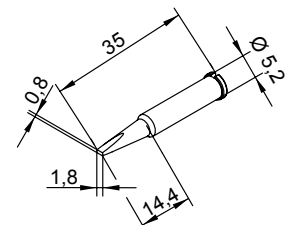

**0102CDLF20/SB**  
chisel-shaped, 2.0 mm

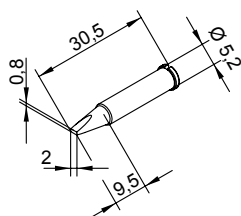

**0102CDLF24/SB**  
chisel-shaped, 2.4 mm

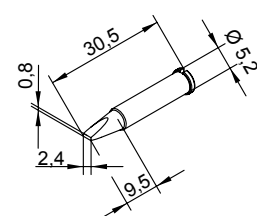

**0102CDLF24L/SB**  
chisel-shaped, 2.4 mm

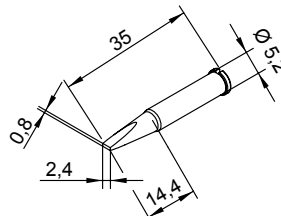

**0102CDLF32/SB**  
chisel-shaped, 3.2 mm

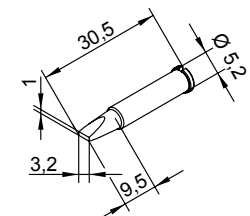

**0102CDLF50/SB**  
chisel-shaped, 5.0 mm

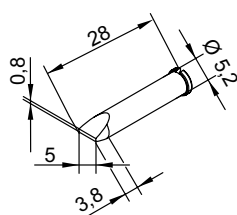

**0102CDLF65/SB**  
chisel-shaped, 6.5 mm

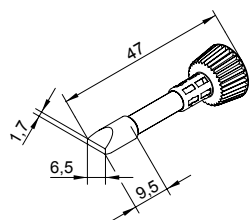

**0102CDLF080C/SB**  
chisel-shaped, conical, 8.0 mm

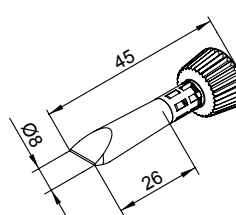

**0102CDLF100/SB**  
chisel-shaped, 10.0 mm

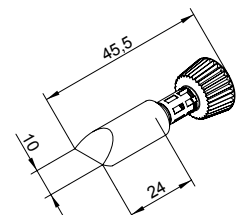

Dimensions without pre-tinning

# SERIES 102 ERSADUR LONGLIFE SOLDERING TIPS

■ All i-CON stations with i-TOOL, i-TOOL NANO or i-TOOL PICO soldering iron

**0102CDLF100C/SB**  
chisel-shaped, conical, 10.0 mm

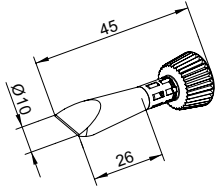

**0102CDLF120C/SB**  
chisel-shaped, conical, 12.0 mm

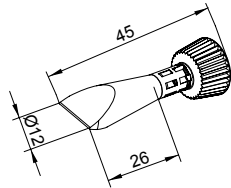

**0102CDLF200/SB**  
angled face, 20.0 mm

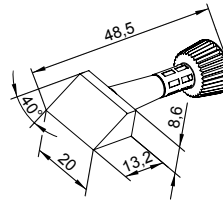

**0102SDLF04/SB**  
pencil point, bent, 0.4 mm  $\phi$

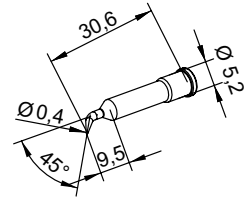

**0102SDLF06/SB**  
pencil point, bent, 0.6 mm  $\phi$

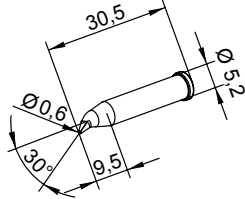

**0102SDLF06L/SB**  
pencil point, bent, extended, 0.6 mm  $\phi$

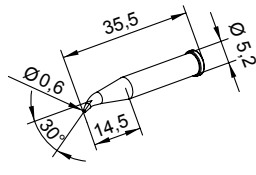

**0102SDLF08L/SB**  
pencil point, bent, extended, 0.8 mm  $\phi$

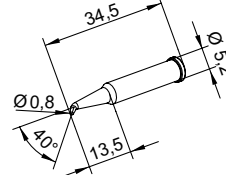

**0102SDLF18/SB**  
chisel-shaped, bent, 1.8 mm  $\phi$

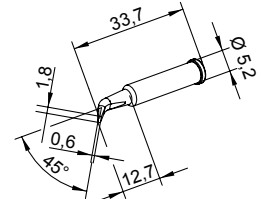

**0102ADLF13/SB**  
angled face, 1.3 mm  $\phi$

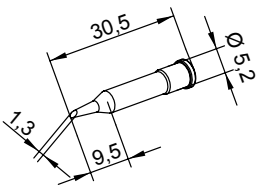

**0102ADLF15/SB**  
angled face, 1.5 mm  $\phi$

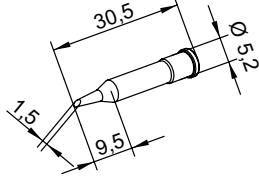

**0102ADLF20/SB**  
angled face, 2.0 mm  $\phi$

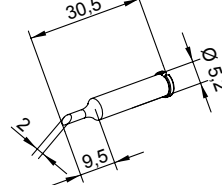

**0102ADLF40/SB**  
angled face, 4.0 mm  $\phi$

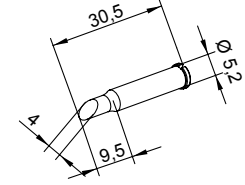

**0102ZDLF100/SB**  
WICK-TIP, 10.0 mm

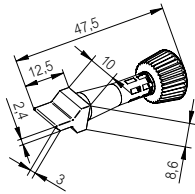

**0102ZDLF150/SB**  
WICK-TIP, 15.0 mm

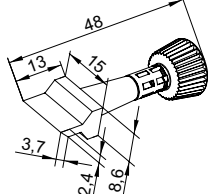

**0102ZDLF200/SB**  
WICK-TIP, 20.0 mm

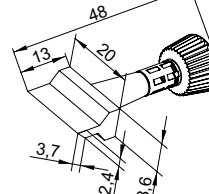

**0102BDLF20/SB**  
PLCC blade

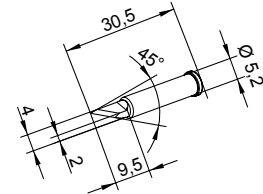

**0102WDLF16/SB**  
PowerWell with concave portion, 1.6 mm  $\phi$

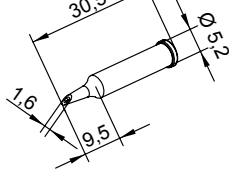

**0102WDLF23/SB**  
PowerWell with concave portion, 2.3 mm  $\phi$

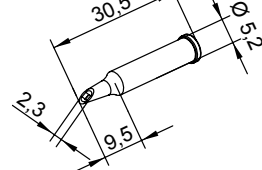

**0102WDLF35/SB**  
PowerWell with concave portion, 3.5 mm  $\phi$

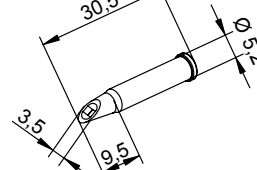

**0102CDLF24A/SB**  
chisel-shaped, asymmetric, 2.4 mm

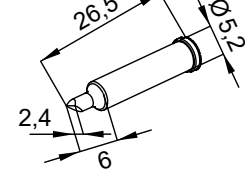

**0102CDLF46A/SB**  
chisel-shaped, asymmetric, 4.6 mm

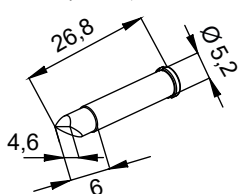

**0102CDLF80A/SB**  
chisel-shaped, asymmetric, 8.0 mm

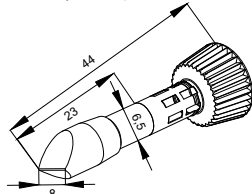

**0102YDLF1224/SB**  
slotted, angled face, ID 1.2 mm, OD 2.4 mm

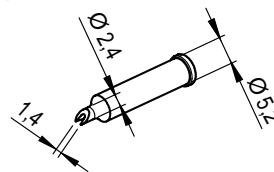

**0102YDLF1852**  
slotted, angled face, ID 1.8 mm, OD 5.2 mm

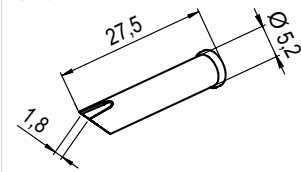

Dimensions without pre-tinning