

ZW Series Node Bracket Kit (ZW-BRACKET)

Items included: Bracket, 3 screws, and 3 rivets (1 extra). To attach the bracket to a ZW data node or router node, remove the battery cover. Insert 2 rivets through the holes on the cover on both ends, or arms, of the bracket to snap the bracket to the cover. Place the cover back on the node. Use the 3 screws to mount the node in the bracket to a wall or other surface. Tighten the pre-installed screw in the bracket hinge when finished.

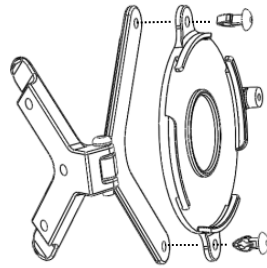

Attaching battery cover
to bracket with rivets

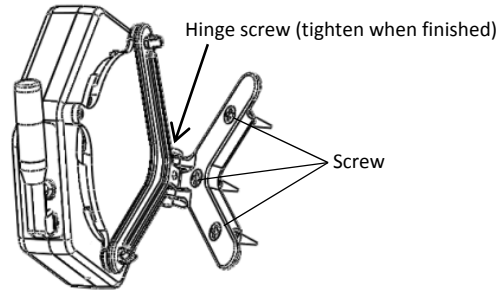

Bracket attached to node;
mounting screws in place