

Wall Mounted Monitor Arm

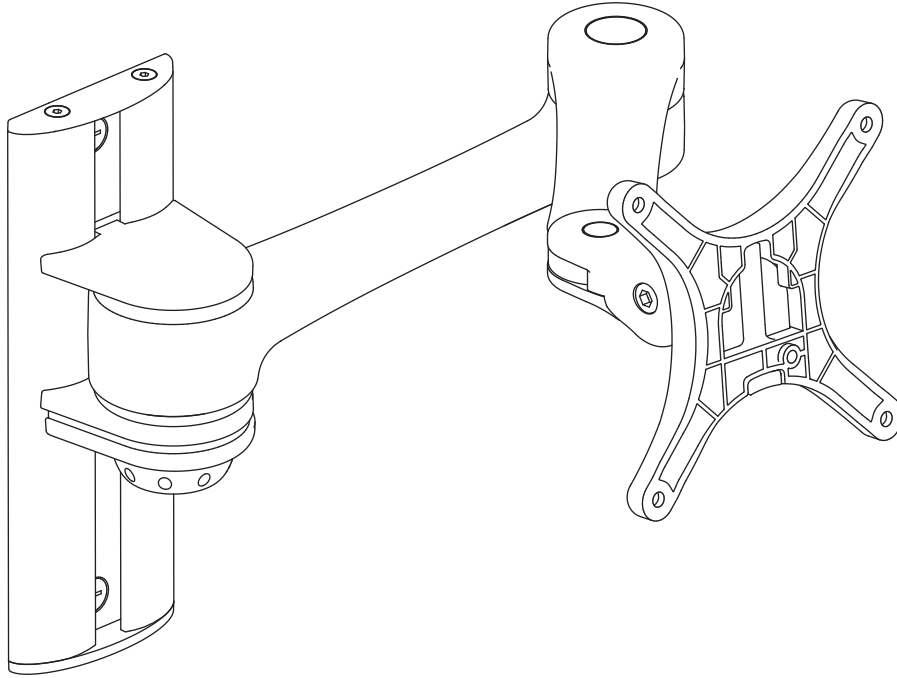

COMPONENT CHECKLIST

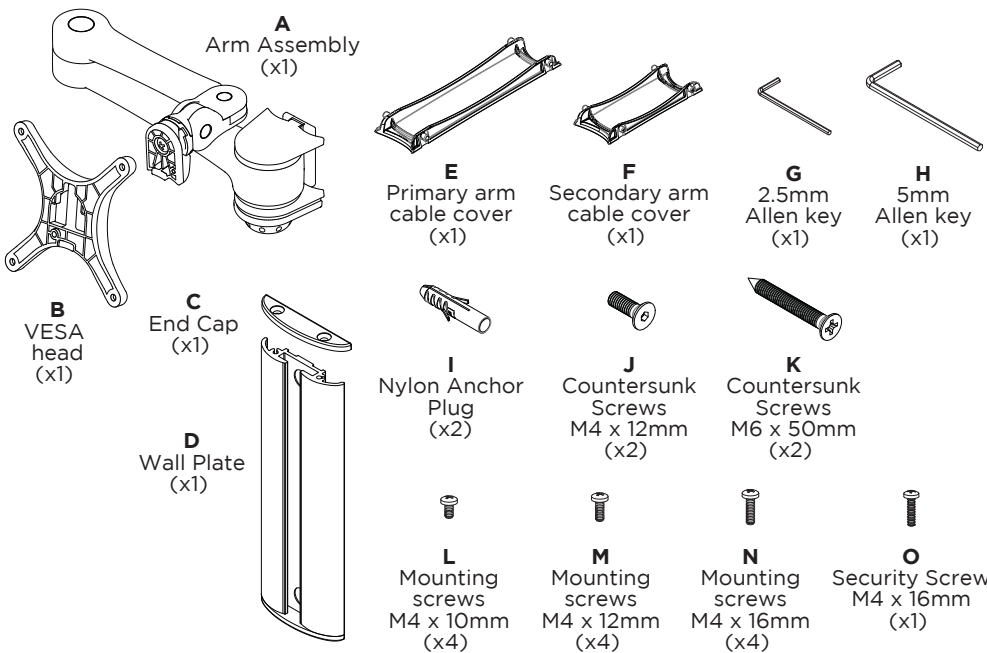

Wall

REQUIRED TOOLS

- Power Drill
- Drill Bit
- Phillips Head Screwdriver

WEIGHT RANGE

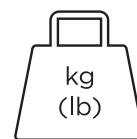

kg
(lb)

0 - 8kg
(0 - 17.6lbs)

IMPORTANT INFORMATION

- ! Please ensure this product is installed as per these installation instructions.
- ! The manufacturer accepts no responsibility for incorrect installation.

1. Position Wall Plate

As a guide, it is recommended that the bottom of the Wall Plate be positioned approximately 140mm (5 1/2") above the desktop.

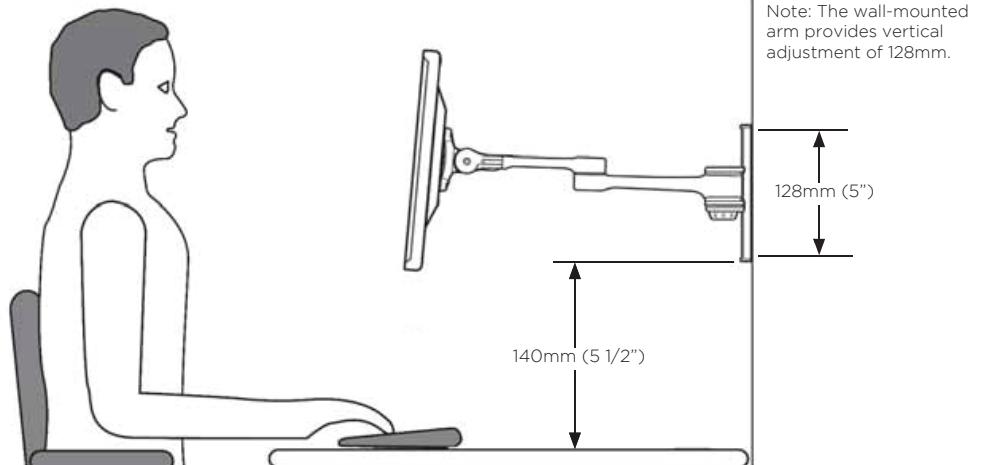

2. Choose the appropriate installation procedure depending on your wall type

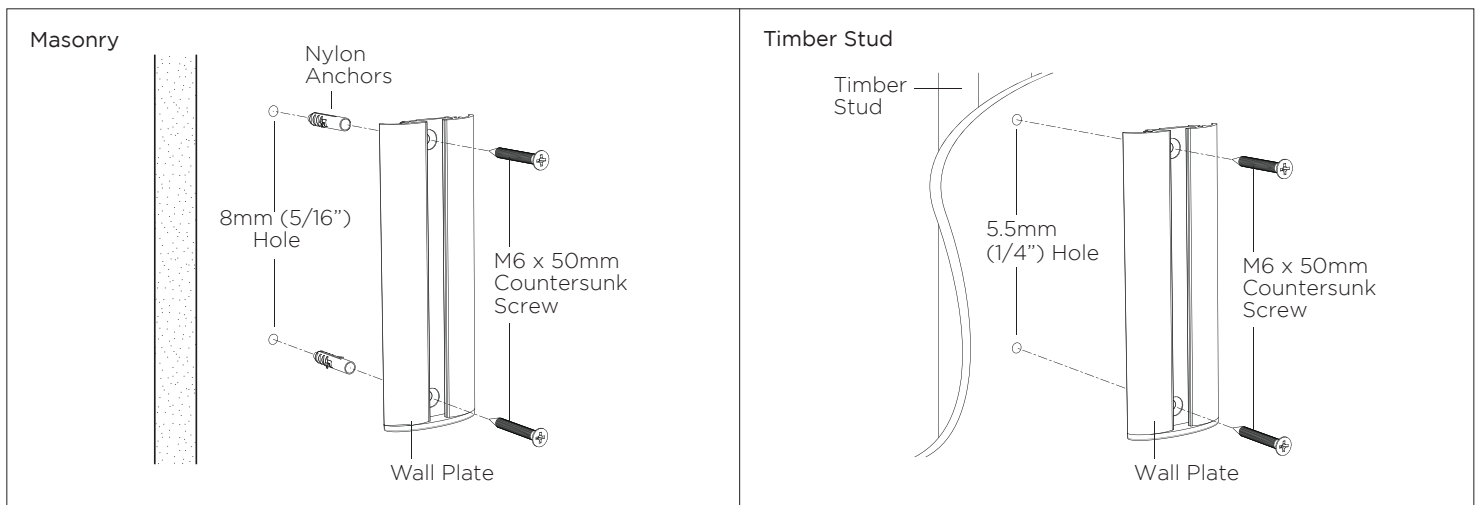

3. Mount Arm Assembly

3.1 Unlock the Locking Dial before inserting the Arm Assembly into the Wall Plate

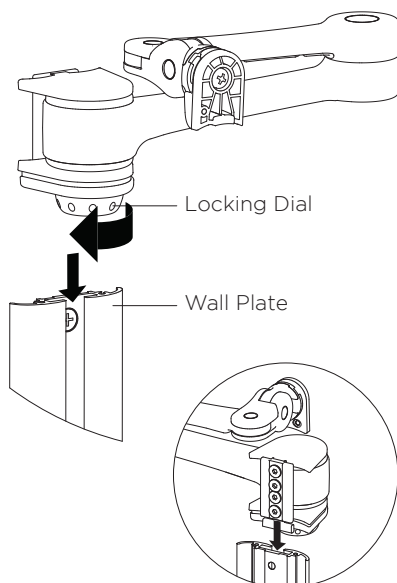

3.2 Slide the Arm Assembly to the preferred height and lock to secure the arm

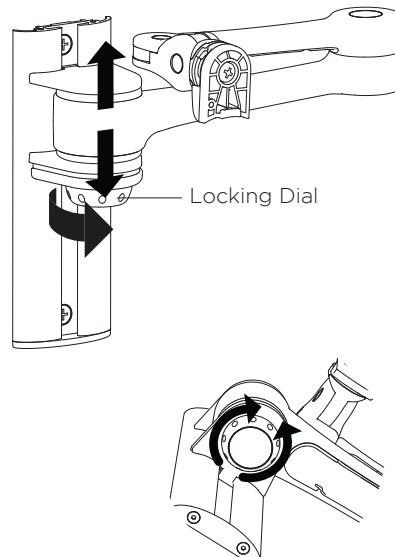

3.3 Secure the End Cap with the supplied M4x12mm Countersunk Screws and 2.5mm Allen Key

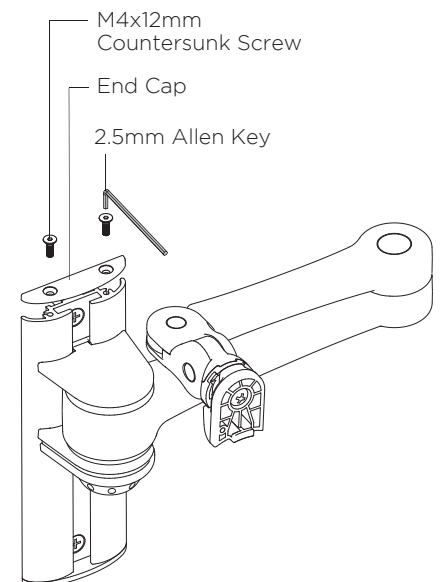

4. Install VESA monitor head

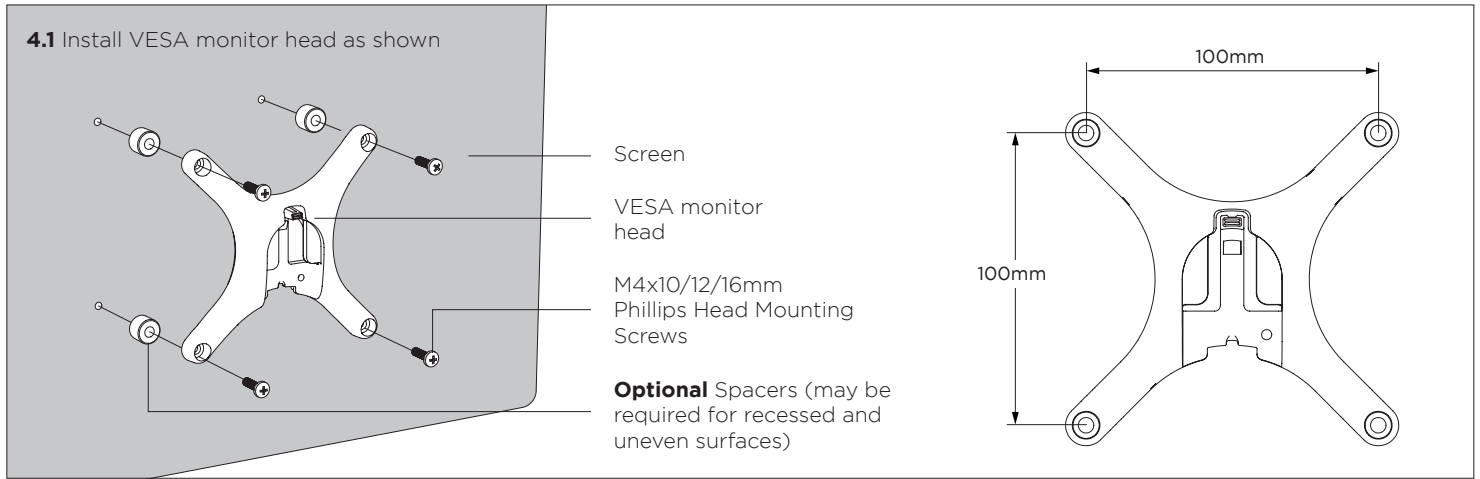

5. Mounting Monitor

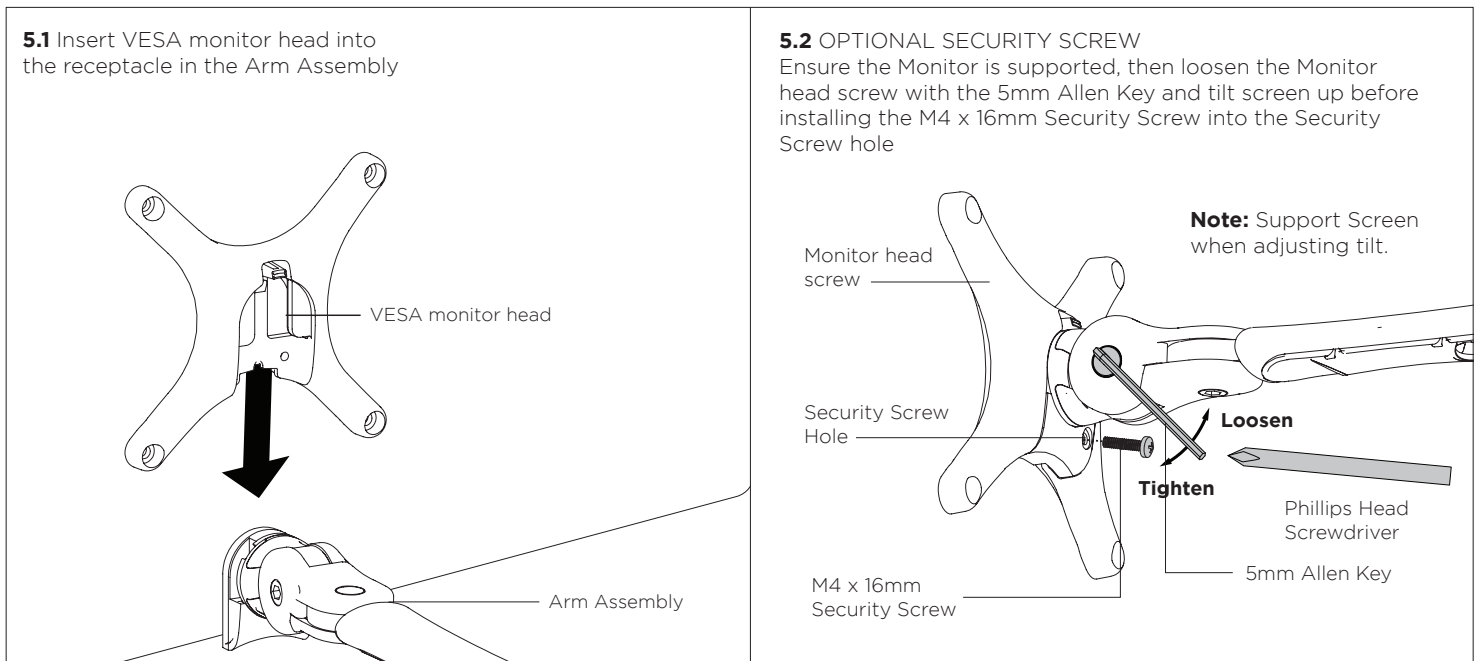

6. Adjusting Height

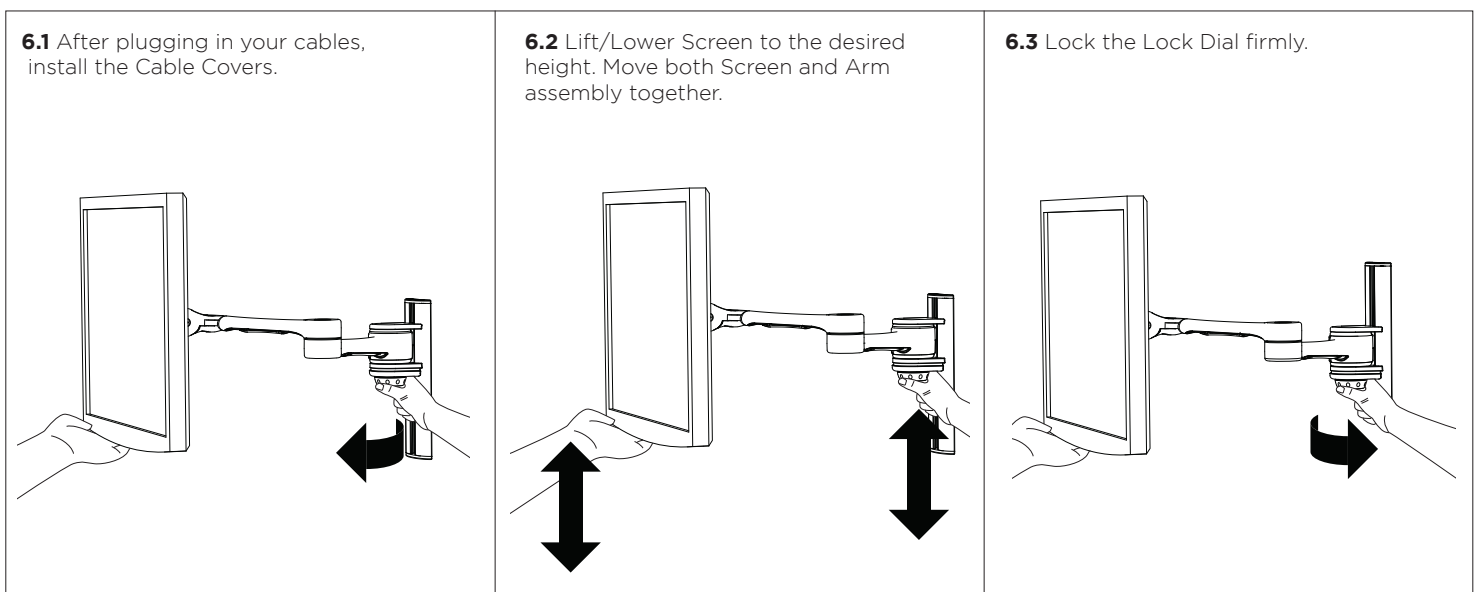

7. Cable Management

7.1 After plugging in your cables, install the Cable Covers. Insert Cable Coversup into Lock Slots.

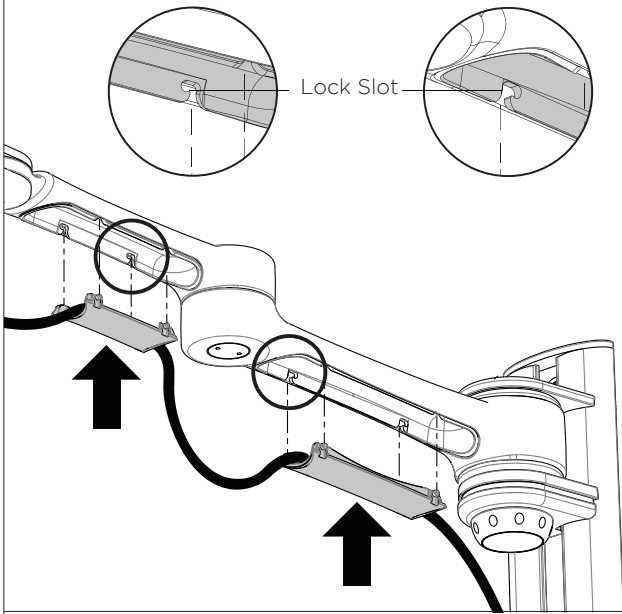

7.2 Push Cable Covers away from Elbow Joint to secure in place.

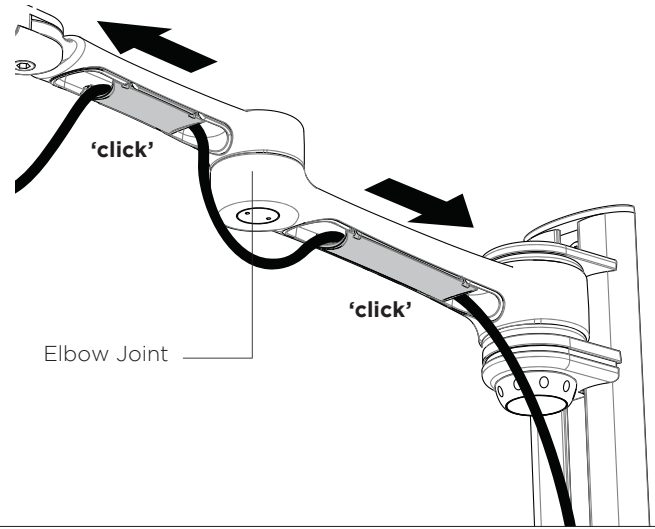

7.3 Cable Clips and Cable Stops can be installed to further manage cables.

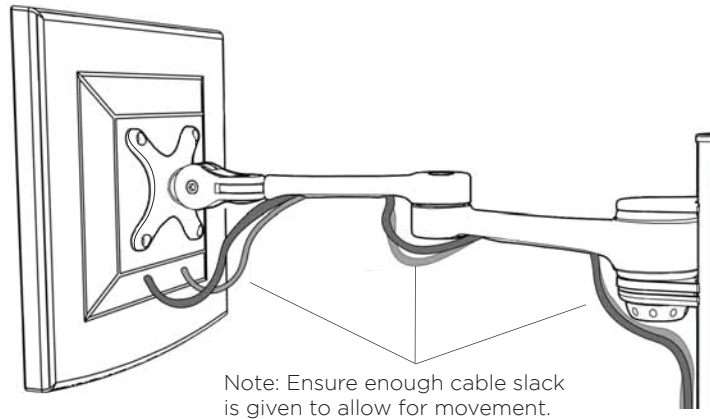

8. Adjusting the Display Bracket

Portrait/ Landscape

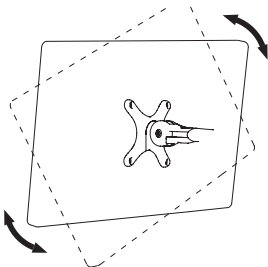

No Allen Key necessary

Tilt (Screen angle up/down)

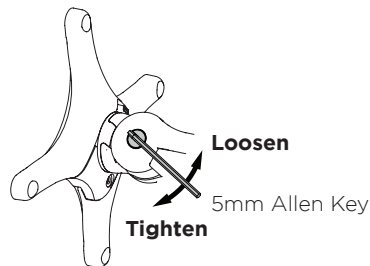

Note: Support Screen when adjusting tilt.

Pan (Screen angle left/right)

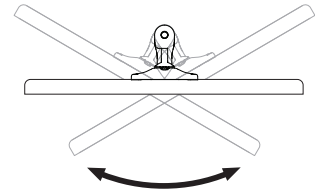

No Allen Key necessary