



[www.jbctools.com](http://www.jbctools.com)

## INSTRUCTION MANUAL



**0032589**

Curved Guide Nozzle  
for GALExxx-B

This manual corresponds to the following references:

**0032589** for solder wire  $\varnothing$  0.8-1.2 mm / 0.031-0.047 in

## Packing List

The following items are included:



### Curved Guide Nozzle

for GALE ..... 1 unit

Manual ..... 1 unit

Ref. 0032591

## Features

The curved guide nozzle is designed to be used with Guide Kit GALExxx-B assembled to Auto Feed Soldering Iron ALE250-B.

**Note:** The curved guide nozzle works only with some of the C245 cartridges. Compatible cartridges see table below.

These cartridges are 20 mm longer than the C245 standard cartridges.

## Compatible Cartridges\*

	Cartridge Ref.	A [mm / in]	B [mm / in]
	C245230	$\varnothing$ 0.3 / $\varnothing$ 0.012	13.5 / 0.531
	C245201	$\varnothing$ 0,6 / $\varnothing$ 0.024	9 / 0.354
	C245803	$\varnothing$ 1 / $\varnothing$ 0.039	10.5 / 0.413
	C245806	1.2x0.7 / 0.047x0.028	10 / 0.394
	C245807	2.2x1 / 0.087x0.039	10 / 0.394
	C245845	$\varnothing$ 2.2 / $\varnothing$ 0.087	10 / 0.394
	C245256	$\varnothing$ 3.5 / $\varnothing$ 0.138	10.5 / 0.413

## Compatible Outlet Nozzles\*

Outlet Nozzle Ref.	suitable for solder wire $\varnothing$	working <u>without</u> wire perforation	working <u>with</u> wire perforation
0033986		0.80 - 0.82 mm/0.032 - 0.033 in	0.80 mm/0.032 in
0033987		0.90 - 1.10 mm/0.036 - 0.044 in	1.00 mm/0.040 in
0033988		1.14 - 1.27 mm/0.045 - 0.051 in max. wire $\varnothing$ 1.20 mm / 0.047 in working with curved guide nozzle	1.20 mm/0.047 in

\*not included, sold separately

## Changing the Guide Nozzle

**Note:** If you replace a straight guide nozzle with a curved one, then C250 cartridges must be replaced with C245 cartridges. For compatible cartridges, see page 2.

To change the guide nozzle, unload the solder wire, disconnect the tool from the control unit and let it cool down. Then detach the clips from the tool cable, loosen the guide set fixing screw (1) and remove the guide set (2) from the tool.

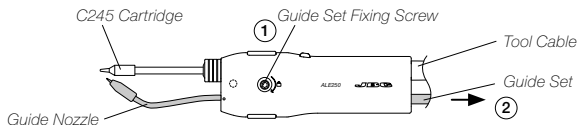

Unscrew the guide nozzle (3) from your guide set. Then, unscrew the outlet nozzle (4) and set it apart. If the outlet nozzle is stuck onto the guide nozzle because of the flux, soak it in alcohol to release it.

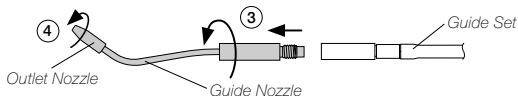

Screw your outlet nozzle (5) onto the new curved guide nozzle and then screw the new guide nozzle (6) onto the guide set. **Note:** There is an outlet nozzle size for each soldering wire diameter. The use of the nozzle is necessary as its inner diameter is adjusted to the solder wire diameter and guides the wire with greater precision.

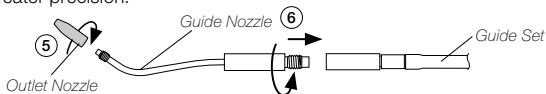

Insert the guide set (7) into the tool and adjust its position. Leave a gap of 5 to 7 mm (0.197 to 0.276 in) between the cartridge tip and the outlet nozzle (8). Once the position is adjusted, tighten the fixing screw (9). Use the clips to attach the guide set to the tool cable.

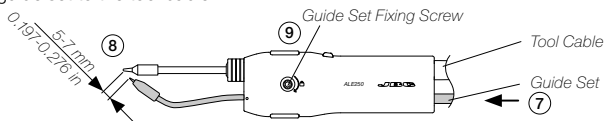

## Specifications

**0032589**

**Curved Guide Nozzle for GALExxx-B**

Ref.: **0032589**

- Suitable for solder wire diameter: See page 2
- Total Net Weight: 9 g / 0.02 lb
- Package Dimensions / Weight: 40 x 55 x 90 mm / 33 g  
(L x W x H) 1.57 x 2.17 x 3.54 in / 0.07 lb

Complies with CE standards.  
ESD safe.

# JBC

### Warranty

JBC's 2 year warranty covers this equipment against all manufacturing defects, including the replacement of defective parts and labour.

Warranty does not cover product wear or misuse.

In order for the warranty to be valid, equipment must be returned, postage paid, to the dealer where it was purchased.



This product should not be thrown in the garbage.

In accordance with the European directive 2012/19/EU, electronic equipment at the end of its life must be collected and returned to an authorized recycling facility.



[www.jbctools.com](http://www.jbctools.com)