

UEI Accessories

TEST INSTRUMENTS™



ATPC: Pipe Clamp Adapter

Clips & Adapters

ATPC	Pipe Clamp Adapter for use with K-type inputs
ATPC2	K-type Clamp style temperature adapter.
AWL1	FIREFLY Wristlight™ LED light attaches to wrist, fingers, or test leads
AAC	Push-on alligator clips with insulators for pointed test leads, 1 pair
AAC3	Screw-on alligator clips, 1 pair
ACF1	110V AC female adapter connector to insulated battery clips, for HA1
ATHA1	Gas valve thermocouple adapter
ALS1	Line Splitter
CPA1	Capacitance adapter for DMMs
DLMAT2	MicroAmp adapter for DMMs
TA2K	Dual input differential temperature adapter for DMMs
ACS1	Velcro pipe straps for thermocouple probes
ATTEXT	10' Extension for K-type thermocouples



Test Leads

ATL55	UL listed insulated test leads for industry standard multimeters
ATL59	UL listed insulated test leads for Phoenix Clamp Meter Series™
ATL60	Test lead, microwave diode booster for all DMM (except DM5B)
ATL85	Vinyl insulated test leads for M1K
ATL91	Test lead set for IRT20
ATL130	Rubber insulated test leads, twist lock (pr.) for MCP9A
ATL135	Test leads for IRT3 & DMEG3
ATL190	Kelvin clip leads for CLM100 & CLM100B
ATL250	Test leads for DM5B
ATL301KIT	Deluxe test lead kit
ATLFSG	Flame safeguard relay kit, w/test lead and alligator clips

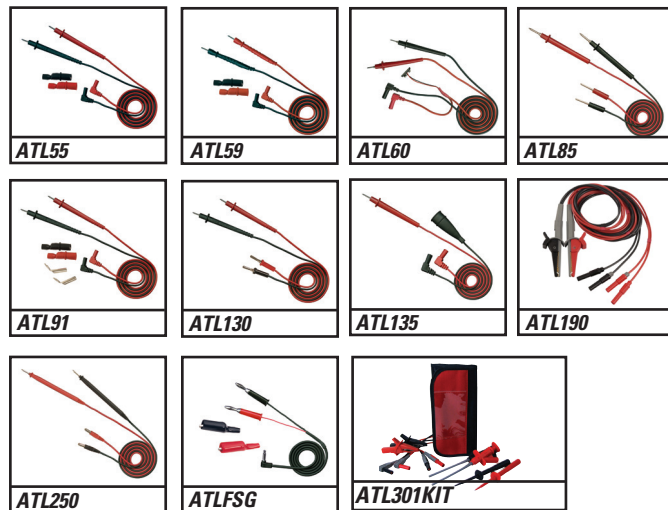

Carrying Cases

AC73	Soft carrying case (15 x 12 x 3")
AC75	Large soft carrying case (18 x 12 x 3")
AC504	Hard carrying case (12.5 x 7.5 x 3.5")
AC506	Large hard carrying case (16 x 11 x 3.75")
AC509	Eagle hard carrying case (19 x 14 x 3.5")
AC319	Soft carrying case (5.5 x 7.5 x 2.5")
AC519	Soft carrying case (5.5 x 10.5 x 2.5")



Accessories

J-Type Temperature Probe

ATT19	Oven clip, flat blade 48" cord. DT301, DT302, DT304 (-40°-950°F / -40°-510°C)
ATT26	Liquid probe and 48" cord. DT301, DT302, DT304 (-40°-1,550°F / -40°-850°C)
ATT27	4' Standard bead probe. DT301, DT302, DT304 (-40°-950°F / -40°-510°C)
ATT30	8" Liquid probe & handle. DT301, DT302, DT304 (-40°-1,550°F / -40°-850°C)

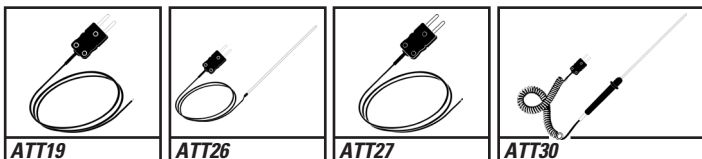

K-Type Temperature Probe

ATT29	4' Standard fiber glass coated. DT301, DT302, DT304, DL389, DL379, DL369, DL259, DL250, & TA2K (-40° to 950°F / -40° to 510°C)
ATT29A	4' Standard fluoroplastic coated FDA approved. DT301, DT302, DT304, DL389, DL379, DL369, DL259, DL250, & TA2K (-40° to 950°F / -40° to 510°C)
ATT29APACK	10 PACK 4' Standard fluoroplastic coated FDA approved.
ATT36	8" Surface probe and handle. DT301, DT302, DT304, DL389, DL379, DL369, DL259, DL250, DT200, & TA2K (-40° to 950°F / -40° to 510°C)
ATT39	Temperature probe for the DT301, DT302, DT304 (-40° to 950°F / -40° to 510°C)
ATT50	8" Liquid probe & handle. DT301, DT302, DT304, DM520, DL297T, DL295, DL250, & TA2K (-40° to 1,550°F / -40° to 850°C)
ATT70	Temperature plug adapter. DL259, DL289, DL279, DL269, DM397, DM393, UTL33T
ATT100	6" Liquid probe and handle. DT301, DT302, DT304, DL389, DL379, DL369, DL259, DL250, & TA2K (-40° to 950°F / -40° to 510°C)

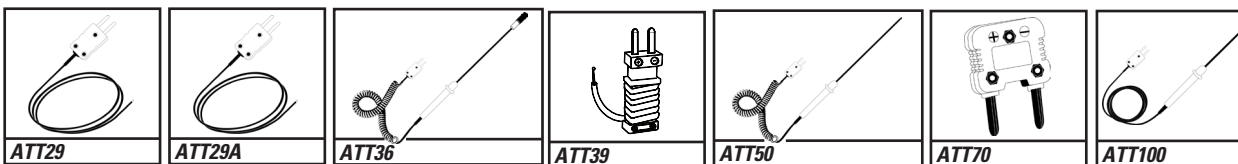

Thermistor

ATT31	External temperature probe. DTH31 (-4° to 158°F / -20° to 70°C)
ATT55A	4" Liquid temperature probe with 30" cord. DT20A, DT15A
ATT56A	4" Air temperature probe with 30" cord. DT20A, DT15A
ATT57A	4" Surface temperature probe with 30" cord. DT20A, DT15A
ATT58A	Sealed probe with 15' cord. DT20A, DT15A
ATT62	Sealed probe with 15' cord. DT40 (-40° to 300°F / -40° to 150°C)
ATT64	Air probe with 15' cord. DT40 (-40° to 300°F / -40° to 150°C)

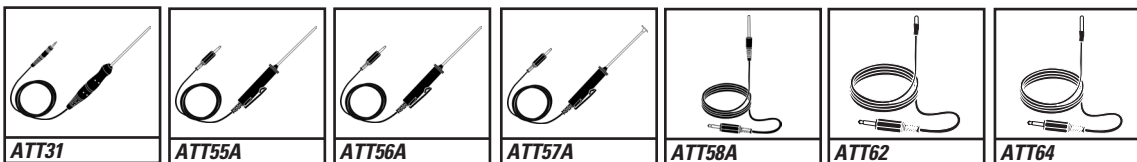

Distributed By:

UEI
TEST INSTRUMENTS™

1-800-547-5740 • Fax: (503) 643-6322
www.ueitest.com • Email: info@ueitest.com

IN CANADA

Phone: 1-877-475-0648 • Fax: (604) 278-8299
www.ueitest.com • Email: infocanada@ueitest.com

IN EUROPE

Phone: +44 1707 375550 • Fax: +44 1707 393277

