

Vizol S 0.21% INTENSIVE

eye drops

Instruction for use - please read attentively

The drops are designed to relieve **dry eye problems** and **regenerate** the eye surface.

COMPOSITION

Sodium chloride, sodium dihydrogen phosphate dihydrate, disodium phosphate anhydrous, sodium hyaluronate 0.15%, dexpanthenol 2%, purified water.

Preservative-free.

PURPOSE

Vizol S INTENSIVE eye drops are designed to relieve mild to moderate dry eye problems, stabilise the tear film, lubricate the eye and smooth its surface.

They also relieve disturbances in the case of:

- mechanical irritation of the eye surface (caused by wearing lenses, diagnostic or surgical interventions on the eye),
- mechanical irritation due to external factors (wind, sun, chlorinated water, pharmacotherapy)
- eye strain (working for long periods on a computer).

The application of the drops provides faster relief of the mentioned conditions.

Vizol S INTENSIVE has a twofold effect: it contains sodium hyaluronate, which **moistens and** stabilises the tear film, and dexpanthenol, which soothes, protects **and helps regenerate the eye surface**.

Dry eye problems can be relieved and thus complications can be prevented.

Eye dryness can be caused by:

- surgical intervention, eye injuries or presence of a foreign object in the eye,
- disorder of the tear film caused by lack of tears or their excessive evaporation, which can lead to damage of the eye surface and discomfort,
- environment (central heating, air conditioning, neon lights, smoke and wind),
- working for long periods on a computer,
- use of decongestive eye drops,
- aging,
- wearing contact lenses,
- gender (hormonal changes in women during pregnancy, breast-feeding, menstruation or menopause),
- medication (for treating depression, hypertension, for prevention of pregnancy)
- disease (rheumatoid arthritis, diabetes, asthma, thyroid problems, glaucoma)

Vizol S INTENSIVE eye drops can be used while wearing contact lenses.

WARNINGS AND PRECAUTIONS

Do not use Vizol S INTENSIVE:

- in the case of hypersensitivity (allergy) to sodium hyaluronate, dexpanthenol or any other ingredient of Vizol S INTENSIVE eye drops.

In the case of an allergic reaction, stop using the product immediately and contact a doctor.

Other remarks:

- If you notice that the Vizol S INTENSIVE bottle or applicator is damaged do not use the product.
- To ensure safe application and hygiene, each bottle should be used by one person only.
- There are no known interactions between Vizol S INTENSIVE and contact lens solutions, other eye drops or topical eye ointments. If you use another eye product, wait at least 15 minutes between applications.

Note:

Immediately after application of the drops, your sight might be reduced. It is therefore recommended that during this short period of time you refrain from driving a car or operating a vehicle or machine but wait until your sight becomes sharp again.

PRODUCT SAFETY

The applicator technology includes a filter that makes the product **safe for use**, as it prevents contamination of the solution after opening.

The product does not contain preservatives, which reduces the possibility of irritation and damage to the surface of the eye.

The product is generally well tolerated. However, if you notice any side effects, contact your doctor or pharmacist.

INSTRUCTIONS FOR USE

The drops can be used several times a day, as required.

Apply 1-2 drops in the eye, blink several times to distribute the solution evenly across the surface of the eye. They do not contain preservatives and therefore their application is not harmful for the eye.

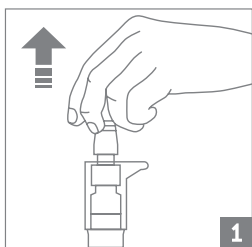

1. Remove the stopper from the pump.

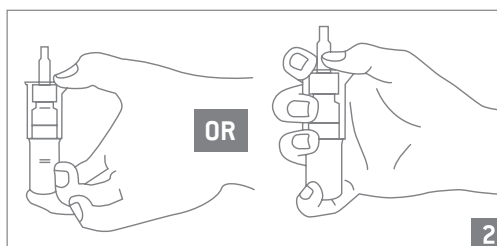

2. Grasp the pump by hand in one of the two ways shown in Image 2.

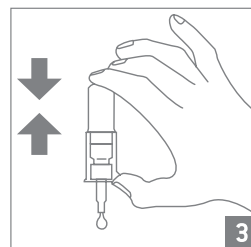

3. Turn the bottle upside down and activate the pump by pressing it, until the first drop appears.

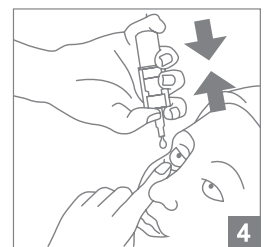

4. Hold the bottle upside down and by pressing the pump, instil prescribed number of drops into the eye.

TRY THE OTHER EYE DROPS FROM THE VIZOL S PRODUCT LINE:

PRODUCT	PURPOSE	COMPOSITION	CAUSE OF DISTURBANCES	MODE OF APPLICATION	USE WITH CONTACT LENSES	FEELING AFTER APPLICATION
Vizol S 0.21% FAST RELIEF	Relieving mild dry eye symptoms	sodium hyaluronate 0.21%	Long-lasting computer work, eye fatigue while driving and traveling, wearing lenses, allergy, foreign object, external factors (dry air, smoke)	Apply 1-2 drops in the eye, several times a day, or as required.	Yes	Immediate relief and refreshment. Long-lasting feeling of moistening.
Vizol S 0.4% LONG EFFECT	Relieving severe dry eye symptoms	sodium hyaluronate 0.4%	Aggressive external factors (wind, sun, dry air), centrally heated and air- conditioned spaces, aging, pharmacotherapy		No	Immediate relief and long effect of moistening. Long-lasting feeling of comfort and lubrication. The product can momentarily blur vision.
Vizol S INTENSIVE	Relieving dry eye symptoms and regenerating eye surface	sodium hyaluronate 0.15% dexpantenol 2%	Mechanical eye irritants: wearing lenses, surgical or diagnostic interventions, medication.		Yes	Immediate refreshment and long-lasting feeling of comfort and moistening.

MANUFACTURER

JADRAN-GALENSKI LABORATORIJ d.d. Svilno 20, 51000 Rijeka, Croatia

EXPIRY DATE

Printed on the packaging.

Expiry date after opening is 180 days.

Do not use the product after its expiry date.

STORAGE

Keep the product at a temperature of up to 25 °C in its original packaging.

Keep out of sight and reach of children.

PACKAGING

10 ml



REVISION DATE

April 2021

Key to symbols on the product



Please read the Instructions for use



CE mark



Manufacturer



Sterile, aseptic processing technique



Lot no.



Keep at a temperature up to 25 °C



Shelf life / Expiry date



Caution, check the Instructions for use
(for important warnings/precautions)

Additional symbols on the box:

Vizol S INTENSIVE



Regeneration and hydration in case of
mechanical eye irritations and drug therapy.



Double action in case of **mild to moderate**
dry eye symptoms.



Alleviation of eye discomfort and irritation
while wearing lenses.



Expiry date after opening **6 months.**