

THE GALLERIA AT FT. LAUDERDALE  
 2414 E. Sunrise Blvd, Ft.Lauderdale, FL 33304  
**SECOND LEVEL**  
**LEASE PLAN**



3344 Peachtree Road, N.E.  
 Suite 1400  
 Atlanta, Georgia 30326

- General Notes:
- This exhibit is diagrammatic. It is intended only for the purpose of indicating the location of the demised premises within the project. It does not purport to show the exact or final location of columns, walls, stairways or other Architectural, Structural, Mechanical or Electrical elements. The landlord reserves the right to eliminate, to add and to make changes to the sizes and/or locations of such elements as may be required from time to time.
  - Dimensions and areas, where indicated for individual premises, are measured under the following:
    - Centerline to Centerline of demising walls
    - Exterior face of all exterior walls
    - To the exterior face of any corridor or bldg. service wall
  - The tenant, the Tenant's Architect & the Tenant's contractor have complete and total responsibility to verify all conditions and dimensions, and all utility connection points, in the field before starting any design, documentation & construction work.

REVISION DATE  
**3-1-2021**

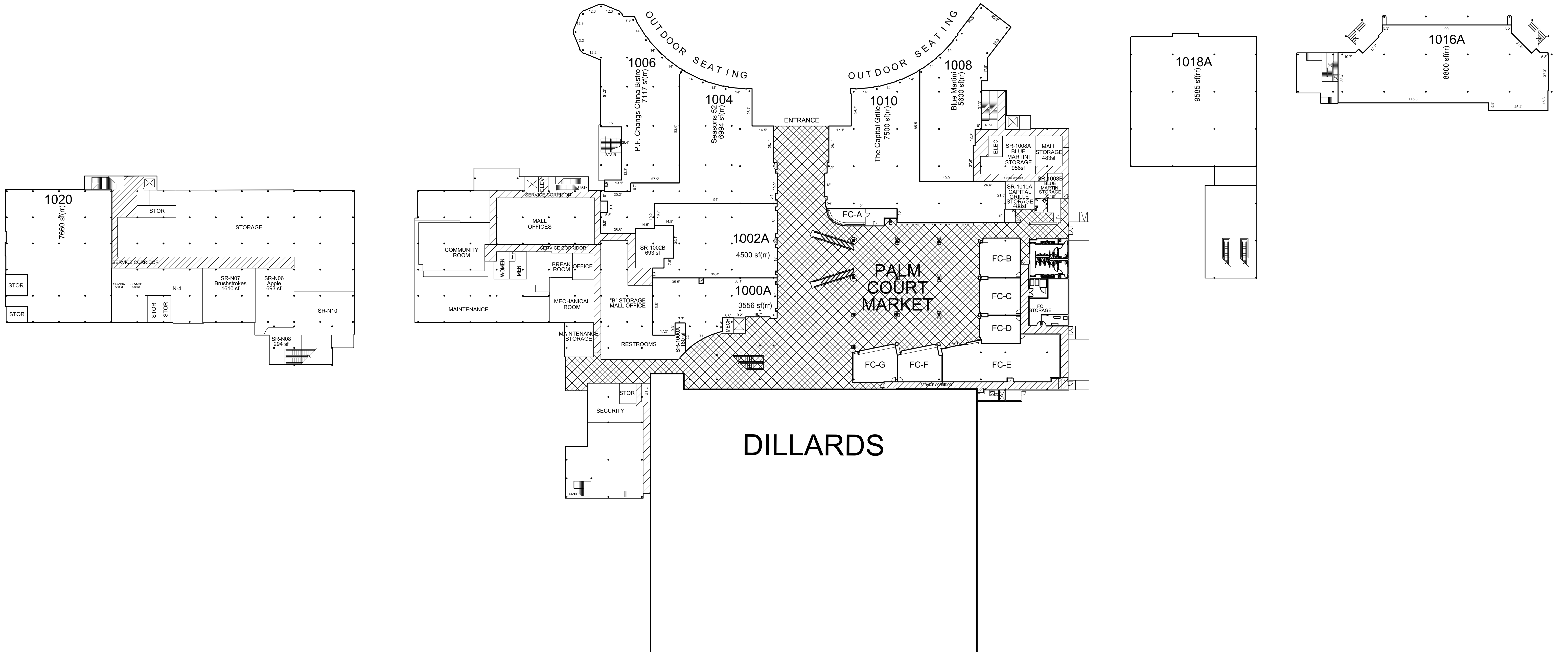

PALM COURT MARKET	
FC-A	Stefano Versace Gelato 616 sf(rr)
FC-B	986 sf(rr)
FC-C	870 sf(rr)
FC-D	Charleys Philly Steaks 687 sf(rr)
FC-E	2785 sf(rr)
FC-F	Tossed 896 sf(rr)
FC-G	Tobu 893 sf(rr)

**THE GALLERIA AT FT. LAUDERDALE**  
2414 E. Sunrise Blvd, Ft.Lauderdale, Fl. 33304

**FIRST LEVEL**

**LEASE PLAN**

3344 Peachtree Road, N.E.  
Suite 1400  
Atlanta, Georgia 30326

REVISION DATE

**3-1-2021**

General Notes:

1 This exhibit is diagrammatic. It is intended only for the purpose of indicating the location of the demised premises within the project. It does not purport to show the exact or final location of columns, walls, stairways or other Architectural, Structural, Mechanical or Electrical elements. The landlord reserves the right to eliminate, to add and to make changes to the sizes and/or locations of such elements as may be required from time to time.

2 Dimensions and areas, where indicated for individual premises, are measured under the following:  
A.) Centerline to Centerline of demising walls  
B.) Exterior face of all exterior walls  
C.) To the exterior face of any corridor or bldg. service wall

3 The tenant, the Tenant's Architect & the Tenant's contractor have complete and total responsibility to verify all conditions and dimensions, and all utility connection points, in the field before starting any design, documentation & construction work.