

MACYS
259,453 sf

J C PENNEY
155,916 sf

578
SEAQUEST
18,899 sf

150
BECKER
FURNITURE
WORLD
38,683 sf

VON MAUR

138,721 sf

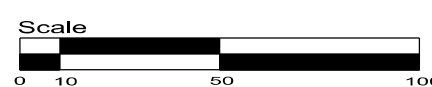

KIOSK TENANTS	
3503	28 sf(rr)
3505	350 sf(rr)
3510	215 sf(rr)
3519	200 sf(rr)
3540	Playring Pagoda 200 sf(rr)

ROSEDALE CENTER

10 Rosedale Center, Roseville, MN. 55113

FIRST LEVEL

LEASE PLAN



3344 Peachtree Road, N.E.
Suite 1400
Atlanta, Georgia 30326

REVISION DATE
1-1-2021

General Notes:
1 This exhibit is diagrammatic. It is intended only for the purpose of indicating the location of the demised premises within the project. It does not purport to show the exact or final location of columns, walls, stairways or other Architectural, Structural, Mechanical or Electrical elements. The landlord reserves the right to eliminate, to add and to make changes to the sizes and/or locations of such elements as may be required from time to time.
2 Dimensions and areas, where indicated for individual premises, are measured under the following:
A.) Centerline to Centerline of demising walls
B.) Exterior face of all exterior walls
C.) To the exterior face of any corridor or bldg. service wall
3 The tenant, the Tenant's Architect & the Tenant's contractor have complete and total responsibility to verify all conditions and dimensions, and all utility connection points, in the field before starting any design, documentation & construction work.

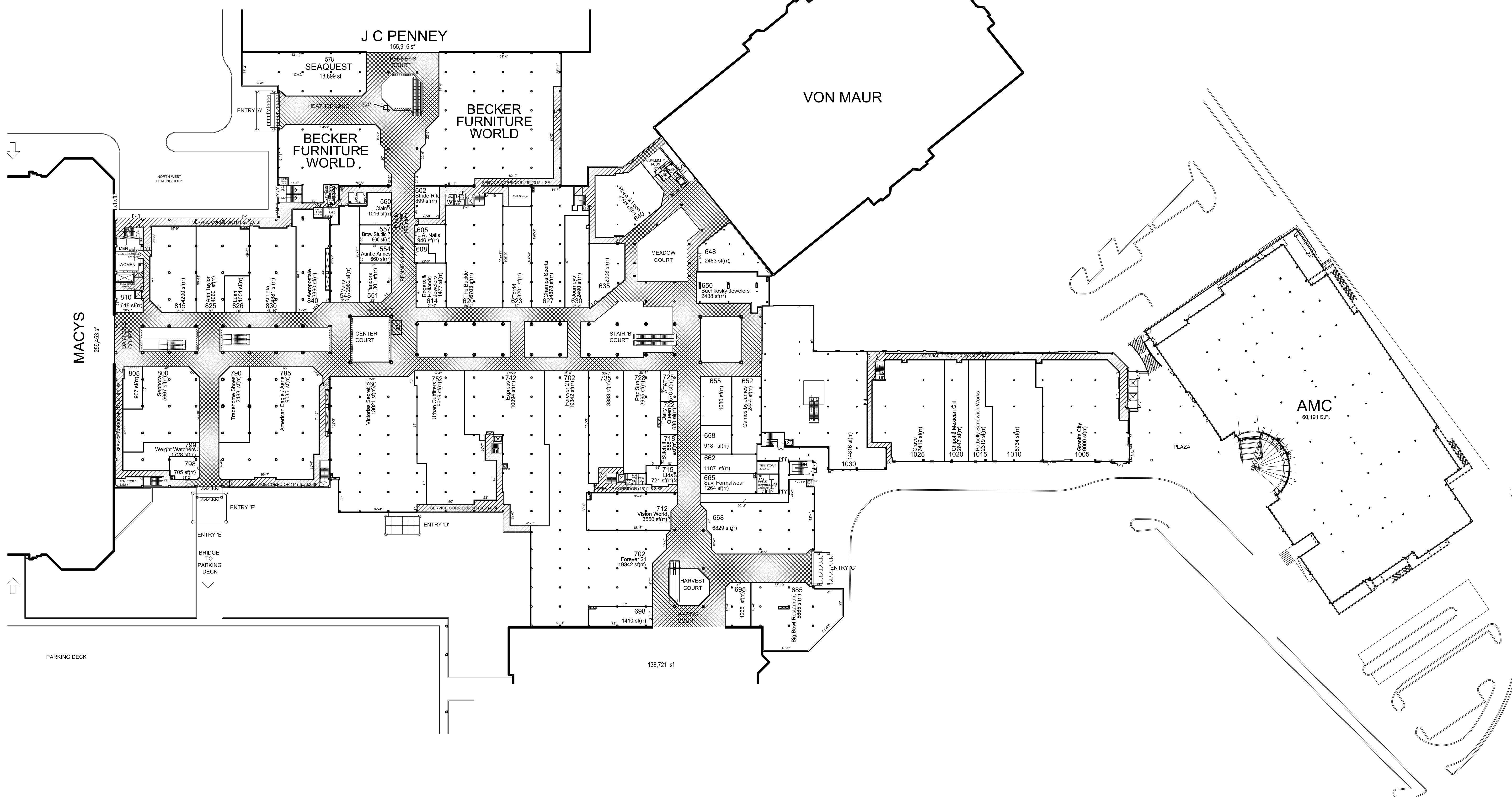

KIOSK TENANTS	
3507	16 sf(r)
3535	150 sf(r)

ROSEDALE CENTER

10 Rosedale Center, Roseville, MN. 55113

SECOND LEVEL

LEASE PLAN



3344 Peachtree Road, N.E.
Suite 1400
Atlanta, Georgia 30326

REVISION DATE

1-1-2021

General Notes:

- This exhibit is diagrammatic. It is intended only for the purpose of indicating the location of the demised premises within the project. It does not purport to show the exact or final location of columns, walls, stairways or other Architectural, Structural, Mechanical or Electrical elements. The landlord reserves the right to eliminate, to add and to make changes to the sizes and/or locations of such elements as may be required from time to time.
- Dimensions and areas, where indicated for individual premises, are measured under the following:
 - A.) Centerline to Centerline of demising walls
 - B.) Exterior face of all exterior walls
 - C.) To the exterior face of any corridor or bldg. service wall
- The tenant, the Tenant's Architect & the Tenant's contractor have complete and total responsibility to verify all conditions and dimensions, and all utility connection points, in the field before starting any design, documentation & construction work.