



8150

**Forshee Drive
Jacksonville, FL 32219**

119,300 SF
FOR LEASE

www.westsideindustrialpark.com





8150 Forshee Drive

Property Specifications

Westside Industrial Park is the largest industrial park in Northeast Florida, and home to a high percentage of the paramount manufacturing and distribution facilities in the Jacksonville market. Availabilities within the park offer quick access to major highways, ports and the airport.

Westside Industrial Park occupants benefit from the park's adjacency to the UPS regional distribution center, the CSX intermodal yard, and close proximity to a high caliber labor force. In addition, the Norfolk Southern intermodal yard is within three miles, and most major trucking companies are within five miles.

Available	119,300 s.f.	Drive-ins	2 (12' x 14')
Office (s.f.)	±3,498 s.f.	Fire protection	ESFR
Year built	2006	Lighting	LED
Clear height	30'	Truck court	160' 50' concrete apron
Column spacing	40' x 52'	Auto parking	49 spaces
Docks doors	22 (9' x 10')	Power	800 amps 270/480 volt 3-phase electrical system



Site Plan

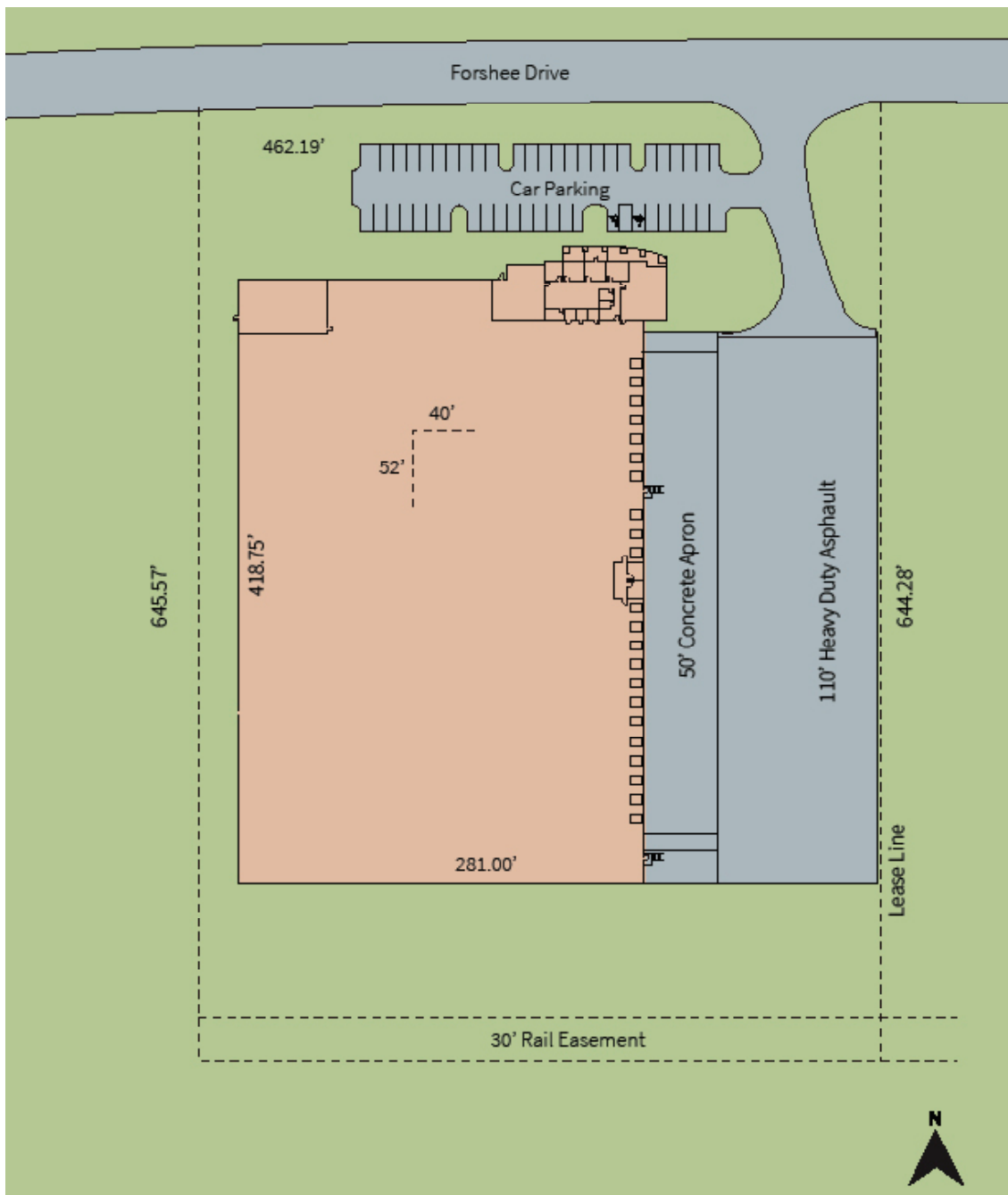



Notable Drive Times

Savannah, GA	142 miles
Orlando, FL	154 miles
Tampa, FL	209 miles
Charleston, SC	242 miles
Atlanta, GA	345 miles
Miami, FL	359 miles
Montgomery, AL	366 miles
Charlotte, NC	387 miles
Baltimore, MD	846 miles
Houston, TX	862 miles

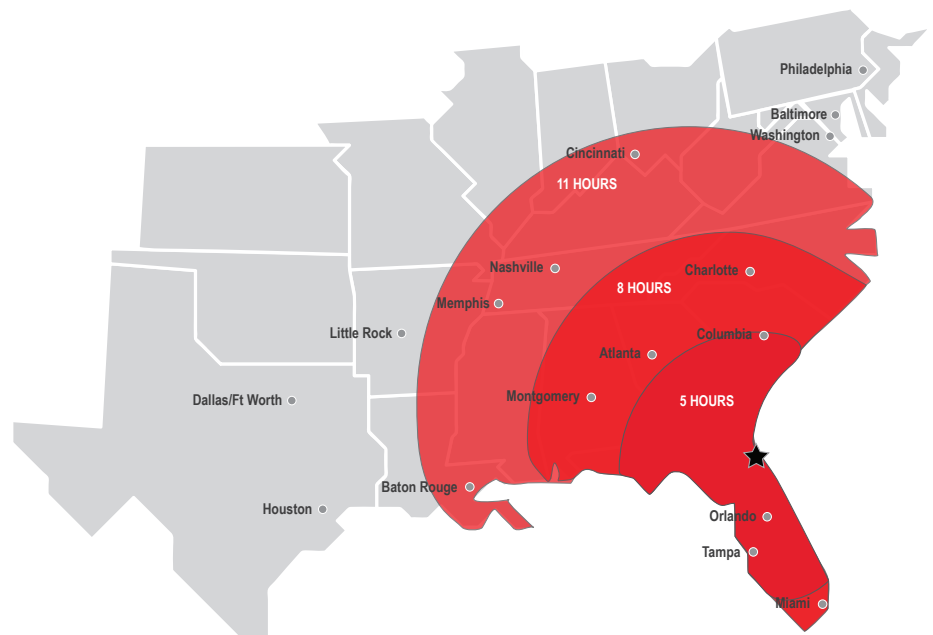

Contact info

Luke Pope, SIOR
 Executive Managing Director
luke.pope@jll.com
 +1 904 356 4550

Ross Crabtree
 Executive Vice President
ross.crabtree@jll.com
 +1 904 559 3915

DISCLAIMER
 Jones Lang LaSalle Brokerage, Inc.
 © 2023 Jones Lang LaSalle IP, Inc. All rights reserved. All information contained herein is from sources deemed reliable; however, no representation or warranty is made to the accuracy thereof.

