



Wood Lane, London W12

Guide price £1,550,000 Leasehold





Description

A new landmark Cassini Tower, an iconic addition in White City with its sweeping curves, this 35-storey architectural gem offers a sought-after 2-bedroom luxury apartment.

Indulge in a lifestyle of sophistication situated on the 22nd floor offering enviable views over Water Gardens, the apartment boasts 2 double bedrooms - one with en-suite bathroom, a family bathroom, an expansive open-plan living area and reception room, complemented by a wrap-around balcony that bathes the entire space in ample natural light.

The development features a range of upscale amenities, including swimming pool, hydro-pool, sun terrace, sauna, steam room, gym, personal training rooms, and treatment rooms. Other offerings include a 24-hour concierge, business lounge, residents' club lounge, café, multiple events space, entertainment suite, and two private cinemas.

Expected completion in Q1 2024.

pictures are for illustration purposes only, floorplans shown for approximate measurements only and are not necessarily to scale

- New landmark in White City
- Stunning 22nd floor view
- 2 bedrooms
- 2 bathrooms
- Open-plan living/kitchen area
- Private wrap-around balcony
- Underfloor heating throughout
- Comfort cooling
- 24hr concierge
- Luxury resident facilities



Floorplan

984 sq ft | 91 sq m

CASSINI TOWER

APPROXIMATE GROSS INTERNAL FLOOR AREA 984 SQ.FT (91.4 SQ.M)

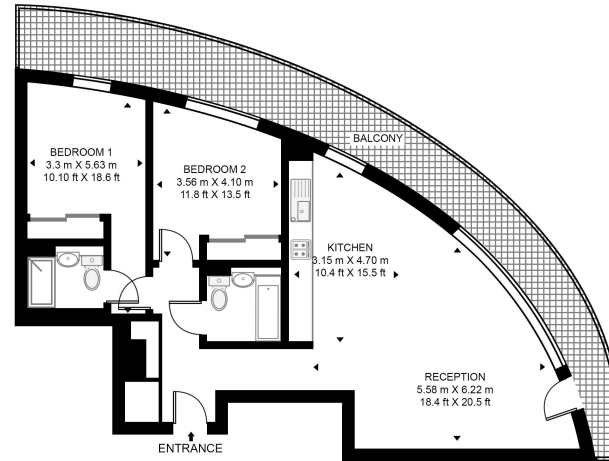

TWENTY SECOND FLOOR



This floor plan has been defined by the RICS Code of Measurement. This floor plan and all others are for approximate representative purposes only and upon usage is agreed to as such by the client.
WWW: hdvirtualart.com | TEL: 0203.974.1567 | EMAIL: info@hdvirtualart.com

Kensington
387 Kensington High Street,
London W14 8QA
+4420 7087 5696
lettingskensington@eu.jll.com

Urban living, your way.

jll.co.uk/residential

© 2019 Jones Lang LaSalle IP, Inc. All rights reserved. All information contained herein is from sources deemed reliable; however, no representation or warranty is made to the accuracy thereof.

