



Brick Kiln One, Station Road, London SE13 5FP



## Brick Kiln One, London, SE13 5FP

### Leasehold

***A stunning one bedroom apartment located in the Portrait Development in Central Lewisham.***

### Key Features

- 1 Bedroom
- 1 Bathroom
- 6th Floor modern apartment
- Large balcony
- Close to transport links
- Direct links to Canary Wharf
- Direct links to Central London
- EPC: B

---

A stunning one bedroom apartment located on the 6th floor in the Portrait development in Central Lewisham. Offering quick and easy access into Central London and Canary Wharf as well as a range of good local amenities.

The accommodation comprises open plan living space with a fitted kitchen and lounge that opens onto a balcony which offers far reaching London views. Good sized bedroom with fitted wardrobes, a separate contemporary bathroom and plenty of fitted cupboards.

The Portrait development is based in the centre of Lewisham, Portrait is a high-rise development and comprising of one to three-bedroom apartments and penthouses. The property was built by Muse and designed by architect, PRP. Close-by transport links come courtesy of Lewisham station, which is serviced by the DLR and National Rail trains.









## Brick Kiln One, Station Road, London, SE13

Approximate Area = 531 sq ft / 49.3 sq m

For identification only - Not to scale

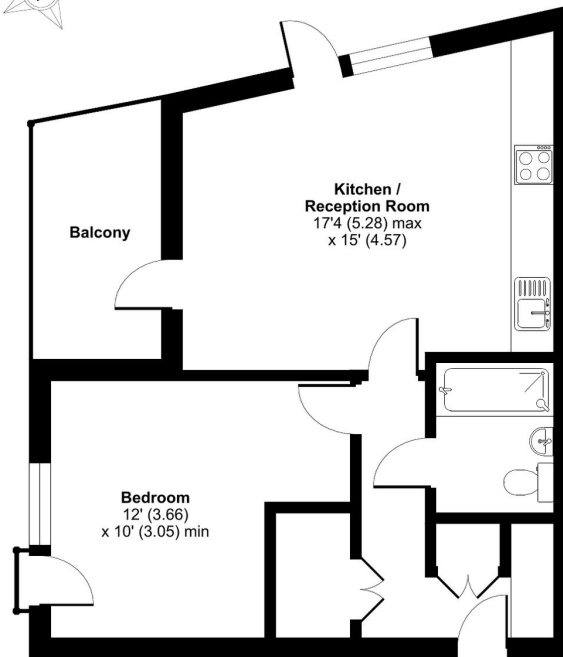

SIXTH FLOOR



Floor plan produced in accordance with RICS Property Measurement Standards incorporating International Property Measurement Standards (IPMS2 Residential). © rdcheom 2023. Produced for JLL Residential. REF: 1042681

22 College Approach,  
Greenwich, SE10 9HY

Sales, Lettings & Property Management

Tel: 020 8858 9986

[residential.jll.co.uk](https://residential.jll.co.uk)

