



Distel Apartments, Telegraph Avenue, Greenwich, London SE10 0TG



## Distel Apartments, Greenwich, London, SE10

Leasehold (993 years remaining)

***Situated on the fifth floor in the ever popular 'Enderby Wharf' development a short walk from both North Greenwich & Cutty Sark.***

### Key Features

- 1 Bedrooms
- Private balcony
- Close to mainline and DLR stations
- Council Tax: C
- Service Charge: £1,970.79 p/a
- Ground Rent: £300 p/a
- Beautifully presented
- EPC: B

---

The accommodation comprises large entrance hall with built in cupboards, open plan kitchen / reception room (25' x 12') which opens onto a private balcony. One double bedroom with built in wardrobes and a family bathroom.

Distel Apartments offers a range of amenities to enhance the residents' lifestyle including a gym, concierge services and communal spaces.

The local area of Greenwich is known for its rich history, beautiful parks, and attractions. Within walking distance from Distel Apartments, you can find attractions such as Greenwich Park, the Royal Observatory, Greenwich Market, and the Cutty Sark. There are also numerous dining options, boutique shops, and cultural venues in the vicinity.















## Telegraph Avenue, London, SE10

Approximate Internal Area = 547 sq ft / 50.8 sq m

Balcony = 58 sq ft / 5.4 sq m

For identification only - Not to scale

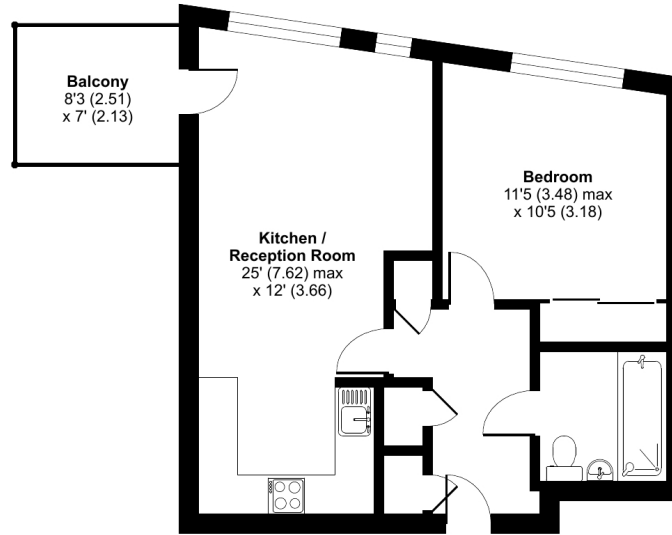

FIFTH FLOOR



Floor plan produced in accordance with RICS Property Measurement Standards incorporating International Property Measurement Standards (IPMS2 Residential). © nlshecom 2024. Produced for JLL Residential. REF: 1145353

22 College Approach, Greenwich, London, SE10 9HY

Sales, Lettings & Property Management

Tel: 020 885 9986

[residential.jll.co.uk](https://residential.jll.co.uk)

