



Christchurch Terrace, London SW3

Price £675 per week - Unfurnished





Description

An immaculate second floor apartment in a charming conversion on Christchurch Terrace. The apartment comprises two double bedrooms, one bathroom, reception room, separate kitchen and guest cloakroom. Christchurch Terrace is ideally situated for the shops, restaurants and transport links that Chelsea has to offer.

Being a Cadogan Estate tenant offers a number of benefits including no administration, referencing or inventory fees, a dedicated 24 hour emergency service, access to the Cadogan Concierge and access to beautiful communal gardens and tennis courts by application.

As well as paying the rent, you may also be required to make permitted payments. Please visit jll.co.uk/fees for details of fees which may be payable when renting a property. If your tenancy does not qualify as an AST, additional fees may apply.

- Two double bedrooms
- One bathroom
- Reception room
- Separate kitchen
- Guest cloakroom
- Second floor
- Unfurnished
- Approx. 662 sq ft (61 sq m)
- EPC: C



Floorplan

662 sq ft | 62 sq m

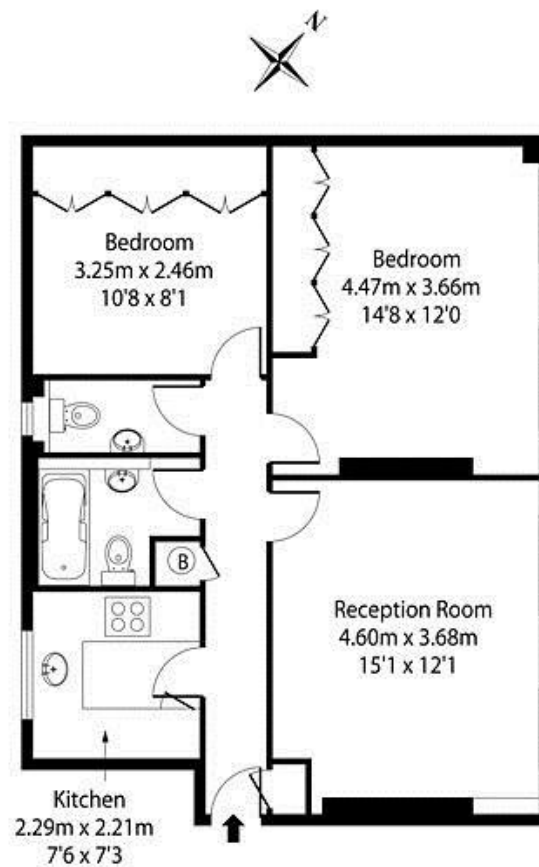

APPROX. GROSS INTERNAL FLOOR AREA 662 SQ FT / 61.49 SQ M

Chelsea
2 Cale Street,
London SW3 3QU
020 7399 5010
chelsealettings@eu.jll.com

Urban living, your way.

jll.co.uk/residential

© 2019 Jones Lang LaSalle IP, Inc. All rights reserved. All information contained herein is from sources deemed reliable; however, no representation or warranty is made to the accuracy thereof.

