



## Draycott Place, London SW3

Price £385 per week - Furnished







# Description

A well presented lower ground floor flat in this period building in the heart of Chelsea. The property consists of one double bedroom, one bathroom, reception room and a fully fitted kitchen. The flat benefits from wooden flooring in the reception room and a patio garden. Draycott Place is close to all the amenities with plenty of shops, bars and restaurants within walking distance.

As well as paying the rent, you may also be required to make permitted payments. Please visit [jll.co.uk/fees](http://jll.co.uk/fees) for details of fees which may be payable when renting a property. If your tenancy does not qualify as an AST, additional fees may apply.

- 1 Double bedroom
- 1 Bathroom
- Reception room
- Fully fitted kitchen
- Patio
- Approx. 423 sq ft (39 sq m)
- Furnished
- EPC: C



# Floorplan

423 sq ft | 39 sq m

Approx. Gross Internal Area \*  
423 Ft<sup>2</sup> - 39.31 M<sup>2</sup>

Illustration For Identification Purposes Only, Not to Scale  
\* As Defined by RICS - Code of Measuring Practice

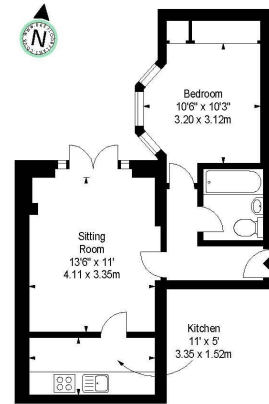

LOWER GROUND FLOOR

Chelsea  
2 Cale Street,  
London SW3 3QU  
+4420 7399 5010  
chelsealettings@eu.jll.com

*Urban living, your way.*

[jll.co.uk/residential](http://jll.co.uk/residential)

© 2019 Jones Lang LaSalle IP, Inc. All rights reserved. All information contained herein is from sources deemed reliable; however, no representation or warranty is made to the accuracy thereof.

