



Harley Street, London W1G

Price £485 per week - Unfurnished





Description

A recently refurbished second floor flat (no lift) in this elegant Grade II listed building situated to the southern end of Harley Street in the heart of Marylebone Village. The property comprises one double bedroom, one shower room, reception room and a fully fitted kitchen. The apartment has been finished to the highest of standards and it is available on an unfurnished basis.

As well as paying the rent, you may also be required to make permitted payments. Please visit jll.co.uk/fees for details of fees which may be payable when renting a property. If your tenancy does not qualify as an AST, additional fees may apply.

- Unfurnished flat
- 1 Double bedroom
- 1 Shower room
- Reception room
- Fully fitted kitchen
- Second floor
- Approx. 626 sq ft (57 sq m)
- EPC: C



Floorplan

626 sq ft | 58 sq m

Approx. gross internal area
626 Sq Ft. / 58.2 Sq M.

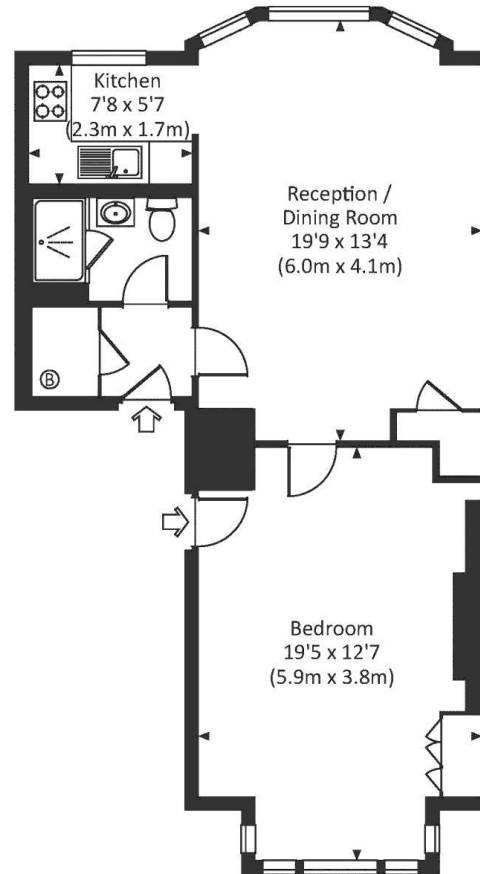

SECOND FLOOR

djd
All measurements are approximate and for illustration purposes
only as defined by the RICS Code of Measuring Practice © 2014
Dowling Jones Design www.dowlingjones.com 020 7610 9933

Mayfair and Marylebone
JLL, 30 Warwick Street,
London W1B 5NH

Urban living, your way.

jll.co.uk/residential

© 2019 Jones Lang LaSalle IP, Inc. All rights reserved. All information contained herein is from sources deemed reliable; however, no representation or warranty is made to the accuracy thereof.

