



New Cavendish Street, London W1G

Price £775 per week - Furnished, Unfurnished





Description

A wonderful three bedroom apartment within a handsome period building in the heart of Marylebone. The apartment comprises three double bedrooms, one bathroom, reception room and a separate eat in kitchen. Crofton House is located just a short walk from Marylebone Village, and within close proximity of Mayfair and the West End.

Having your property professionally managed by The Howard de Walden Estate not only offers exceptional levels of service and high quality, professional property management. Marylebone Village is one of central London's most distinctive and characterful shopping destinations, home to a high proportion of small, independent businesses. Residents of HDWE also benefit from access to an array of discounts within Marylebone Village, resident social opportunities and local events which make Marylebone Village a unique and vibrant place to call home.

As well as paying the rent, you may also be required to make permitted payments. Please visit jll.co.uk/fees for details of fees which may be payable when renting a property. If your tenancy does not qualify as an AST, additional fees may apply.

- Three double bedrooms
- One bathroom
- Reception room
- Separate eat in kitchen
- Unfurnished/furnished at additional cost
- Professional property management
- Eligibility for local discounts in Marylebone Village
- Wifi included
- Approx. 968 sq ft (90 sq m)
- EPC: C



Floorplan

968 sq ft | 90 sq m

APPROX GROSS INTERNAL FLOOR AREA
968 SQ.FT (90 SQ.M.)

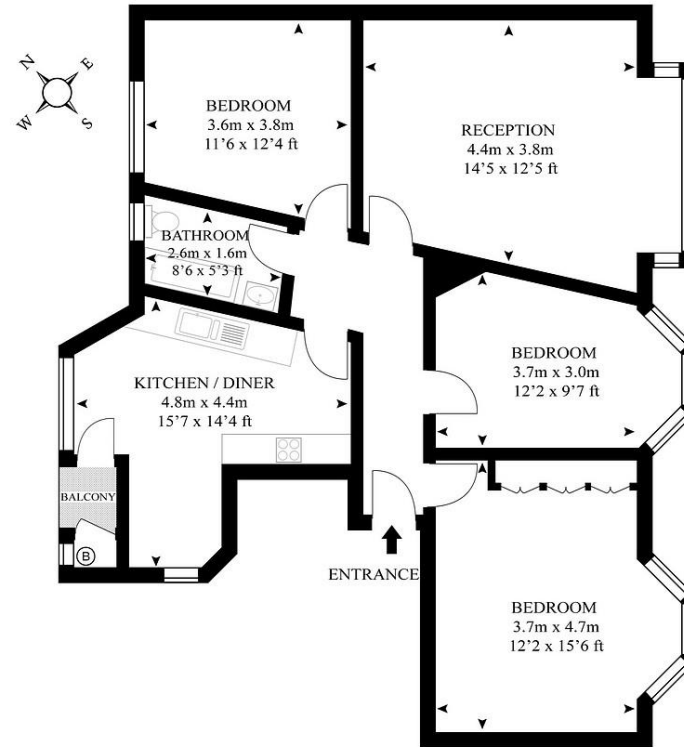

As Defined by RICS - Code of Measuring Practice

The Floor - plans are for representation purposes only and should be used as such by any prospective client.

 Panomatics.com

L00079

Mayfair and Marylebone
JLL, 30 Warwick Street,
London W1B 5NH

Urban living, your way.

jll.co.uk/residential

© 2019 Jones Lang LaSalle IP, Inc. All rights reserved. All information contained herein is from sources deemed reliable; however, no representation or warranty is made to the accuracy thereof.

