



# Cosway Street, London NW1

Asking price £1,445,000 Leasehold







## Description

Situated close to chic Marylebone High Street, Cosway Street is a collection of 49 contemporary one, two and three bedroom homes set around a peaceful communal garden. This landmark building was inspired by the area's Georgian terraces and Victorian mansion blocks and was named winner in the Housing Design Awards in 2019.

One of the first residential developments created and offered for sale by The City of Westminster, Cosway Street is a key part of the Borough's wider housing plan and a striking addition to this sought-after central London neighbourhood.

Cosway Street subtly draws on the local vernacular to offer the best of modern living in one of the capital's most historic districts. The choice of materials, the precise proportions, the gentle curves - every element of the architecture has been considered to ensure the building complements and blends with the Marylebone streetscape. Inside, the energy and pace of London gives way to a beautifully restrained design scheme. From the lobby to the apartments, texture, tone and natural light come together seamlessly in exceptionally well crafted spaces that are both peaceful and inspiring.

Wherever you're headed, Cosway Street is exceptionally well c

- Two bedroom apartment
- Peaceful communal garden
- Private terrace
- Concierge service
- Close to Marylebone station

# Floorplan

958 sq ft | 89 sq m

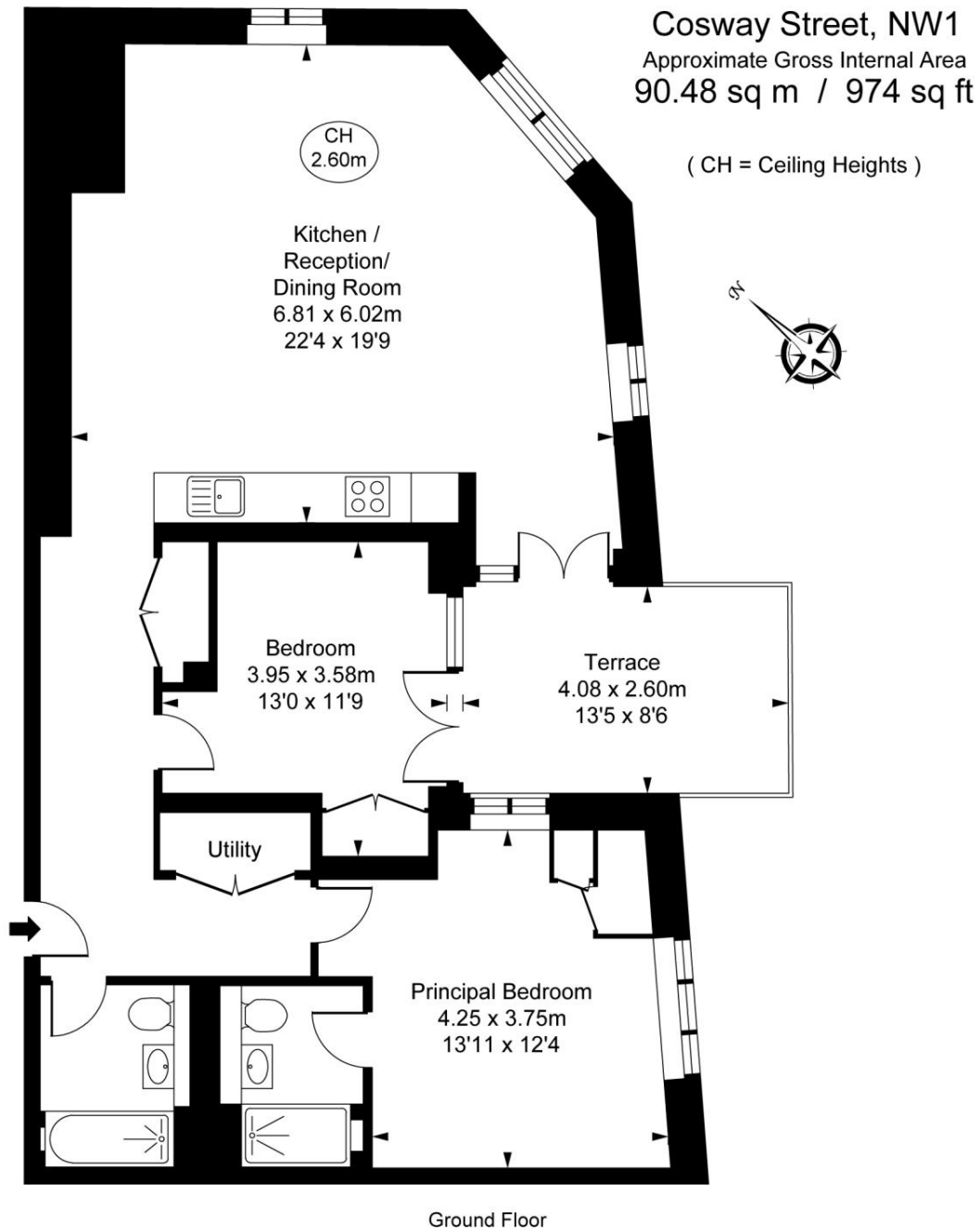

This plan is not to scale. It is for guidance and not for valuation purposes.  
All measurements and areas are approximate only, and have been prepared in accordance with the current edition of the RICS Code of Measuring Practice.  
© Fulham Performance

Mayfair and Marylebone  
13a St George Street,  
London W1S 2FQ  
+44 207 399 5550  
mayfair@jll.com

*Urban living, your way.*

[jll.co.uk/residential](http://jll.co.uk/residential)

© 2019 Jones Lang LaSalle IP, Inc. All rights reserved. All information contained herein is from sources deemed reliable; however, no representation or warranty is made to the accuracy thereof.

