



ONE CLAPHAM

BATTERSEA - LONDON

A MINUTE FROM
THE STATION, JUST
MOMENTS FROM THE
RIVER. ONE CLAPHAM
WELCOMES YOU HOME





BATTERSEA'S EXCITING NEW NEIGHBOURHOOD

Located between the river and the commons, close to Battersea Park, and with sweeping views across the Thames and the London skyline, One Clapham is a destination development.

The area is well-connected with a vibrant metropolitan feel, from the charm of Clapham Old Town to the wide open spaces of the parks, riverside and the bright lights of Chelsea.



BATTERSEA
POWER
STATION

CHELSEA
BRIDGE

RIVER
THAMES

CLAPHAM
COMMON

CHELSEA
FLOWER
SHOW

BATTERSEA
PARK

CHELSEA



CLAPHAM
JUNCTION

ONE CLAPHAM
WELCOMES YOU HOME



£15 BILLION

INVESTMENT BY WANDSWORTH COUNCIL TO BUILD A DEDICATED BATTERSEA DESIGN AND TECH QUARTER

6.5m sq. ft. commercial space

20,000 new homes

25,000 permanent new jobs

80 new community and leisure facilities

58.9%

PRICE GROWTH IN THE LAST DECADE

Rental market outperforms London's average, with a rental growth of 16.1% in the past 12 months.

Rents in the area have risen by 32.2% in the last 5 years, surpassing the London-wide average.

EVERY 05 MINUTES

A TRAIN TO CENTRAL LONDON

Highest number of trains per day in Europe with frequent trains to London Victoria and London Waterloo.

Proximity to two new Northern Line Underground Stations enhances travel options.



KEY STATS



**WITHIN
30 MINS**
OF TOP LONDON UNIVERSITIES

More than 100 schools achieving outstanding and good Ofsted ratings in the area.

Easy access to top London universities like LSE, Imperial College, UCL, and Kings College within a 30-minute commute.

**62.5% OF
RESIDENTS
ARE YOUNG
PROFESSIONALS**

Wandsworth is the London borough with the highest median income, attracting a diverse population of singles, couples and young families who want to settle here.



**VALUE
FOR
MONEY**

Wandsworth provides a competitive pricing advantage compared to neighbouring areas.

Ranked 5th best in Price to Income Ratio among inner London local authorities.

Offers affordable housing options in a sought-after borough.



**1,700
ACRES**
OF GREEN SPACES

Public open space is plentiful in Wandsworth, with Battersea Park, Wandsworth Common and Clapham Common making this one of inner London's greenest boroughs.

Wandsworth has one of the highest proportions of public green space among Inner London boroughs, totalling 1,700 acres.

**VIBRANT
HIGH
STREETS**

St John's Hill, Northcote Road, Battersea Rise, Lavender Hill and Clapham Old Town offer Michelin-starred restaurants, art galleries, shops, bars, and cafes.

Home to the exciting Battersea Power Station, London's most exciting new shopping and leisure destination.

A NEW NEIGHBOURHOOD

One Clapham is an exciting new community in a thriving local area with easy access to the river and the centre of the capital. Enjoy the best of London life here, from the commons and parks to the boutiques and bars.

Walk for just a few minutes to discover the delightful neighbouring districts, from the independent shops and cafes of St John's Hill and Northcote Road to laid-back Lavender Hill.

Spend time with friends in the pubs, bars and restaurants of Clapham Old Town and Battersea Rise, explore the old school charm of Chelsea and Fulham, new neighbourhood of Battersea Power Station, and the Nine Elms cultural and leisure hub.



Hannah Battersea 05 MINS WALK



07 MINS WALK



Northcote Road Market 10 MINS WALK



The Northcote 06 MINS WALK



Albert Bridge 11 MINS TAXI

BATTERSEA & BEYOND



Battersea Power Station 12 MINS TAXI



LOCAL HIGHLIGHTS

RESTAURANTS

- 01 Taverna Trastevere 06 MINS WALK
- 02 Hannah Battersea 06 MINS WALK
- 03 Sinabro 07 MINS WALK
- 04 Soif Bistro & Wine Bar 09 MINS WALK
- 05 Flour to the People Pizza! 06 MINS TAXI
- 06 Hatched 07 MINS WALK
- 07 Minnow 07 MINS TAXI
- 08 Megan's Battersea Power Station 12 MINS TAXI
- 09 Wright Brothers Battersea Power Station 12 MINS TAXI



08

CAFÉS

- 10 Story Coffee 04 MINS WALK
- 11 Blank Street Coffee 05 MINS WALK
- 12 Bluebird Brothers 05 MINS WALK
- 13 Bistro Union 10 MINS TAXI
- 14 Black Sheep Coffee & Cocktails 12 MINS TAXI



17

PUBS and BARS

- 15 Northcote Records 07 MINS WALK
- 16 Vagabond 07 MINS WALK
- 17 The Old Bank 08 MINS WALK
- 18 Humble Grape 10 MINS WALK
- 19 Little Bird 10 MINS WALK
- 20 The Latchmere 06 MINS TAXI
- 21 The Lighthouse 06 MINS TAXI
- 22 The Prince Albert 07 MINS TAXI
- 23 No. 32 The Old Town 08 MINS TAXI
- 24 Control Room B - Battersea Power Station 12 MINS TAXI

RETAIL and GROCERY

- 25 Whole Foods Market 04 MINS WALK
- 26 Waitrose 05 MINS WALK
- 27 Marks & Spencer 05 MINS WALK
- 28 Asda Superstore 07 MINS WALK
- 29 Battersea General Store 12 MINS TAXI

LIFESTYLE

- 30 Clapham Grand 01 MIN WALK
- 31 Third Space 01 MINS WALK*
- 32 F45 Training 03 MINS WALK
- 33 Battersea Arts Centre 08 MINS WALK
- 34 Wandsworth Common Tennis Courts 06 MINS TAXI
- 35 Clapham Picturehouse 10 MINS TAXI



24

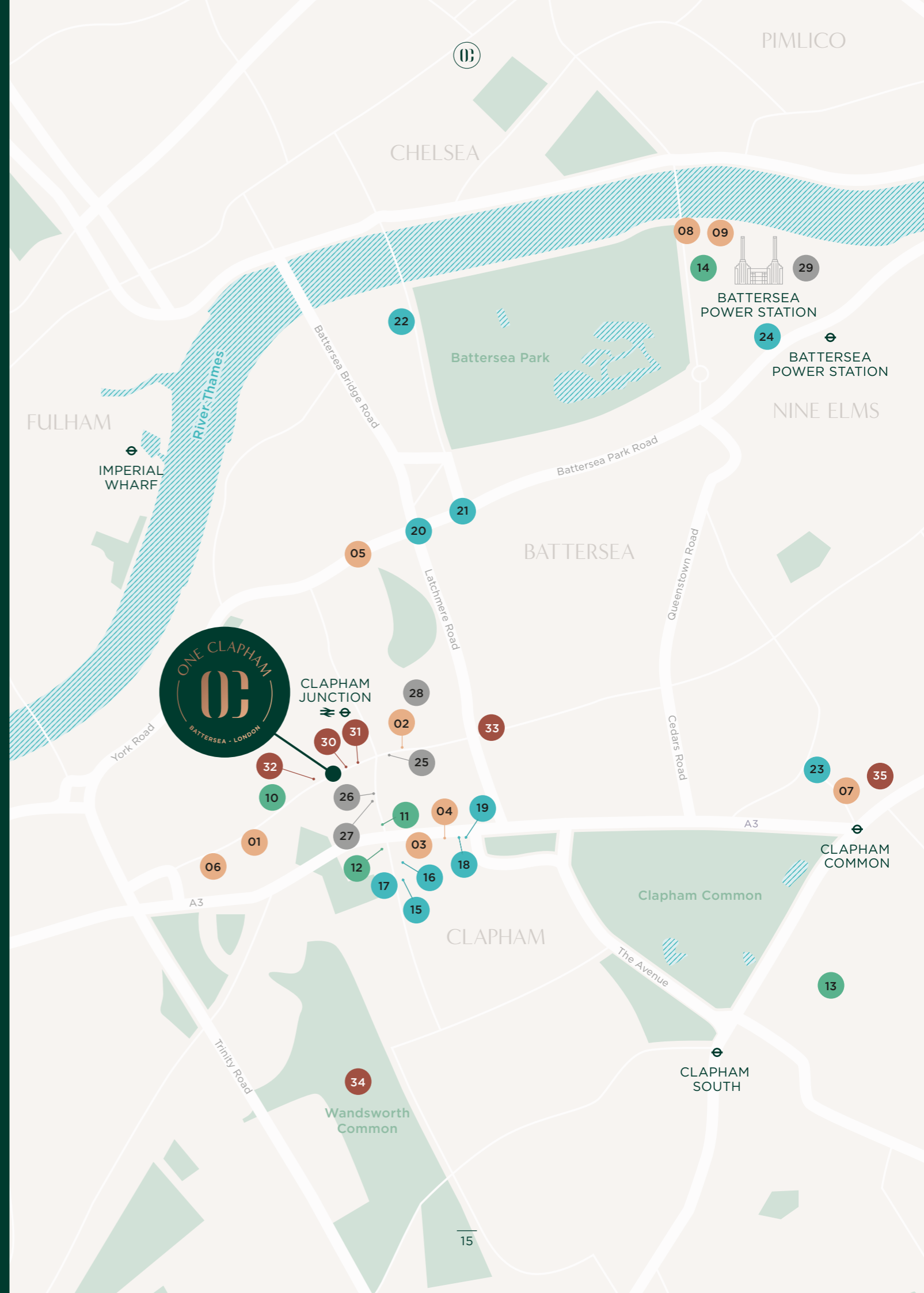

LIVE CLOSE TO NATURE



Battersea Park 24 MINS WALK

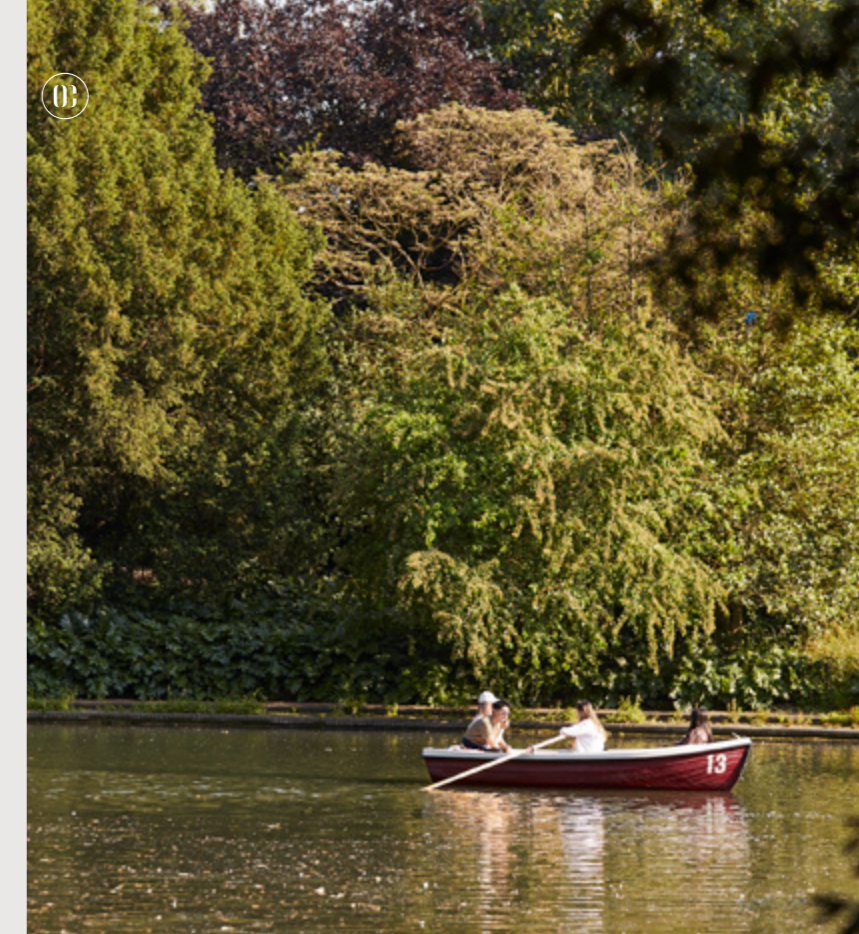

Battersea Park Boating Lake 30 MINS WALK

GREEN SPACES

At One Clapham nature is everywhere, from trees and wildflower gardens around the apartments to 600 acres of parks, commons and wide open green spaces in the surrounding area.

Just a short walk from your door, Clapham Common, Wandsworth Common and Battersea Park are criss-crossed by jogging paths and punctuated by playgrounds and ponds, tennis courts, cafés and cricket nets.

Walk along the riverside path and woodland trails in Battersea Park. Experience the vibrant atmosphere at Clapham Common, where you can listen to live music at the charming Victorian bandstand, help grow food in the community allotment, and enjoy life your way.

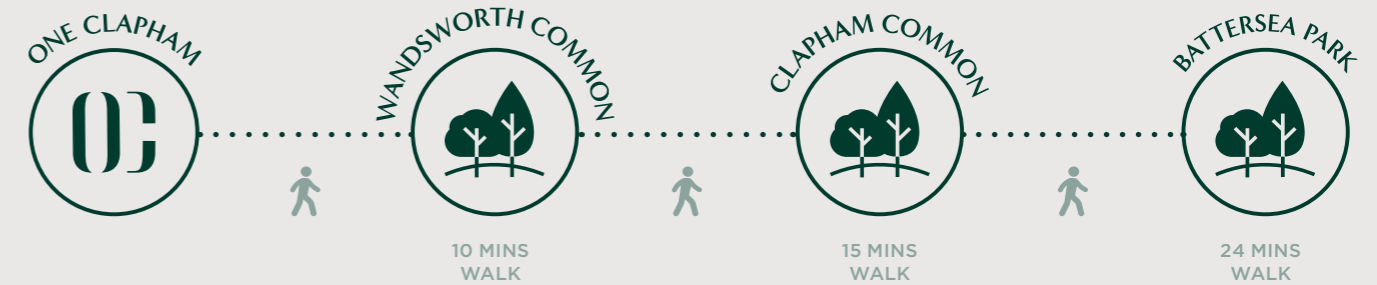

A PLACE FOR LEARNING

London is a global centre for education and One Clapham lies at the heart of a vibrant student community. With seven leading universities within 30 minutes, it's the perfect place to live and learn.

UNIVERSITY OF WESTMINSTER

22 MINS

KING'S
College
LONDON

25 MINS



London South Bank University

25 MINS

UCL

25 MINS

ual: london college of communication

26 MINS

LSE

THE LONDON SCHOOL OF ECONOMICS AND POLITICAL SCIENCE

27 MINS

Imperial College London

27 MINS

TRAVEL TIMES BY PUBLIC TRANSPORT



View our education guide in full by scanning the QR code

30

NURSERIES IN SW11 ALONE

Every kind of early learning, all within walking distance for little legs.

100+

PRIMARY SCHOOLS IN WANDSWORTH

With a higher percentage rated Outstanding than all but four boroughs**.

06

SECONDARY SCHOOLS RATED OUTSTANDING

An array of community and independent schools within two miles of One Clapham.

07

TOP UNIVERSITIES 30 MINS AWAY

London is home to more world-class universities than any other city.

PRIMARY SCHOOLS

Thomas's Battersea 06 MINS TAXI

Eaton House 06 MINS TAXI

The Dominic School 08 MINS TAXI

Newton Preparatory School 10 MINS TAXI

SECONDARY SCHOOLS

Chestnut Grove School 10 MINS*

Harris Academy Battersea 12 MINS*

Ashcroft Technology Academy 19 MINS*

Le Retrait Roman Catholic

Girls School 21 MINS*

Northwood Senior 22 MINS*

Streatham & Clapham High School 25 MINS*

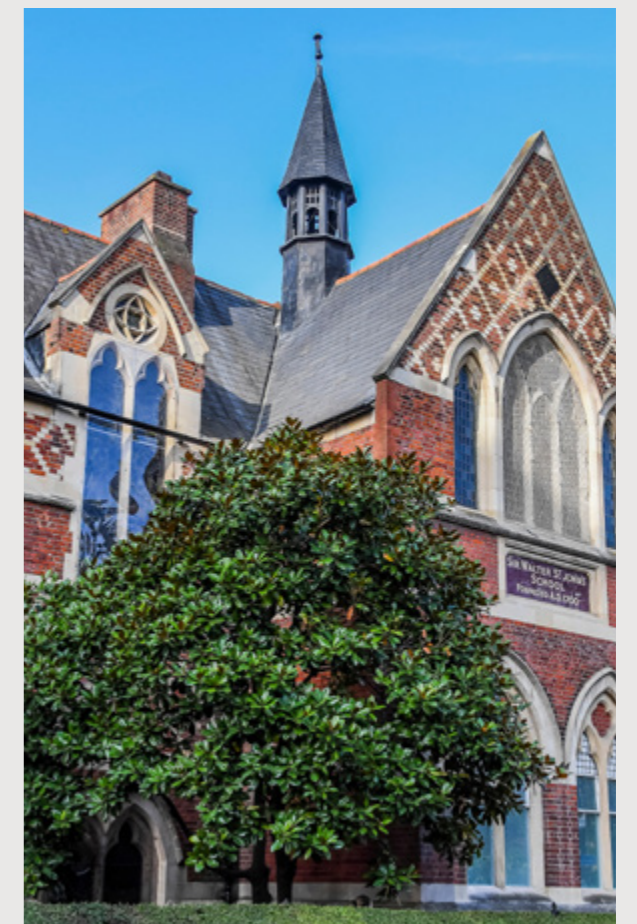

Thomas's Battersea 06 MINS TAXI

CAPITAL CONNECTIONS

With one of London's best-connected stations on your doorstep, and just one stop from zone one, the City and West End are just moments away.

Cycle along the river, take an Uber Boat into town, or catch a fast train to the countryside, beach or airport.



NATIONAL RAIL

(From Clapham Junction)



American Embassy



Battersea Power Station



Buckingham Palace



The London Eye



OVERGROUND

(from Clapham Junction - 01 min walk)



NORTHERN LINE

(from Battersea Power Station)

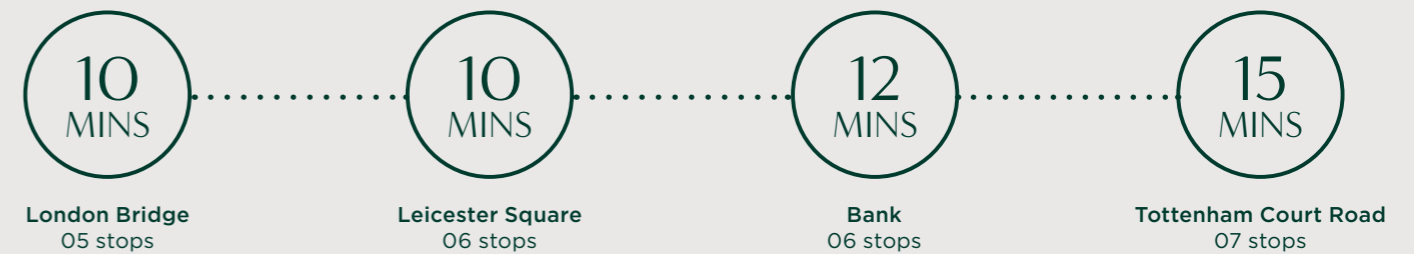

RIVER BOAT

(from Battersea Power Station Pier)

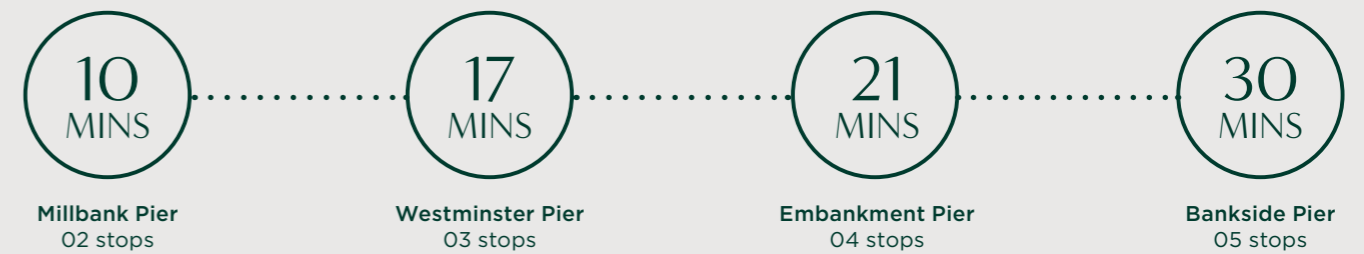



A LASTING LEGACY

This distinctive collection of apartments designed by award-winning architects and designers uses modern materials that reference and respect the site's rich history, connecting the past to the present.





WHERE PAST MEETS PRESENT

Each building has distinctive brickwork and patterns inspired by local landmarks.

From the Edwardian terraces of Eckstein Road, to the diamond motifs and colours of St Mark's Church, the development respects and reflects the local architectural heritage.





One Clapham is a new neighbourhood, created with care and a focus on wellness. From sun decks and lawns to wooded walks and quiet corners, there's plenty of space to rest and relax.

THE COURTYARD

In this sunny south-facing space, you can make the most of all seasons, meeting with friends on a lazy summer's day to soak up the sun or enjoy the cool shade of the woodland trail. During autumn, as the days take on a golden hue, you delight in the rich colours that climb the courtyard walls.

THE SQUARE

Sun-dappled and shaded by poplar and plane trees, The Square is a social space with community events and markets throughout the year.

SWALE GARDENS

With native trees and sunken gardens, whimsical paths and comfy benches, Swale Gardens is a space where you can rest and relax.

FLORAL PASSAGE

With considered planting, this linear park is a thread that connects visitors and residents with each other and supports the diverse local ecosystem.



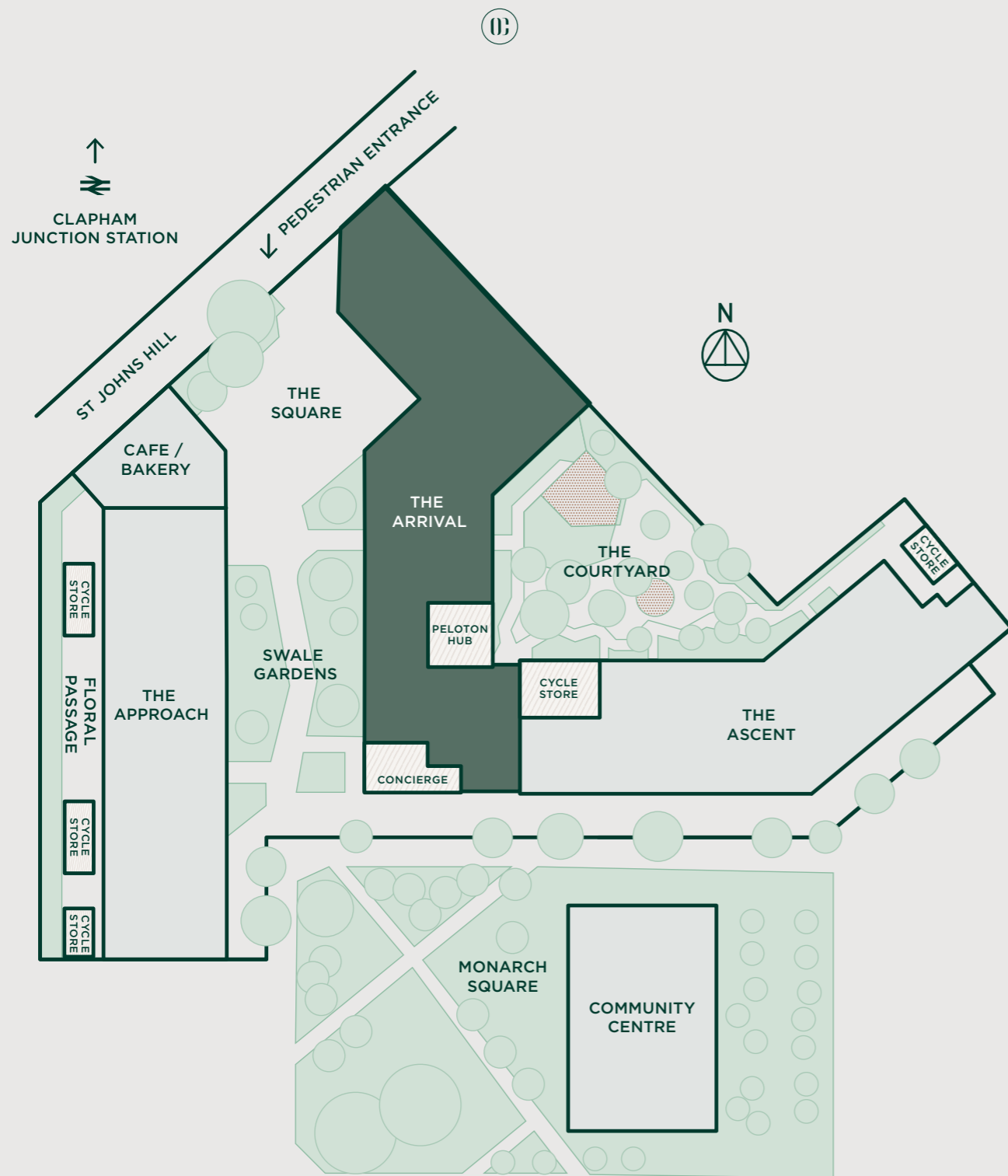

AWARD-WINNING
ONE CLAPHAM
 BRINGS TOGETHER
 SIX UNIQUE
 BUILDINGS TO CREATE
 A NEW CONNECTED
 COMMUNITY.



To explore One Clapham,
 please scan this QR code





CONCIERGE

First impressions are important.
At One Clapham a friendly
24-hour concierge service
welcomes you home every day.



To explore the concierge,
please scan this QR code



Unique partnership with:



PELOTON HUB

Plug in, tune out and zone in on your goals in the Peloton Hub. With online classes at your fingertips, you can charge up or wind down, exercise by yourself or with your neighbours.

This light and airy studio space is great for yoga and workouts. One Clapham makes it easy to put wellbeing at the centre of your life.

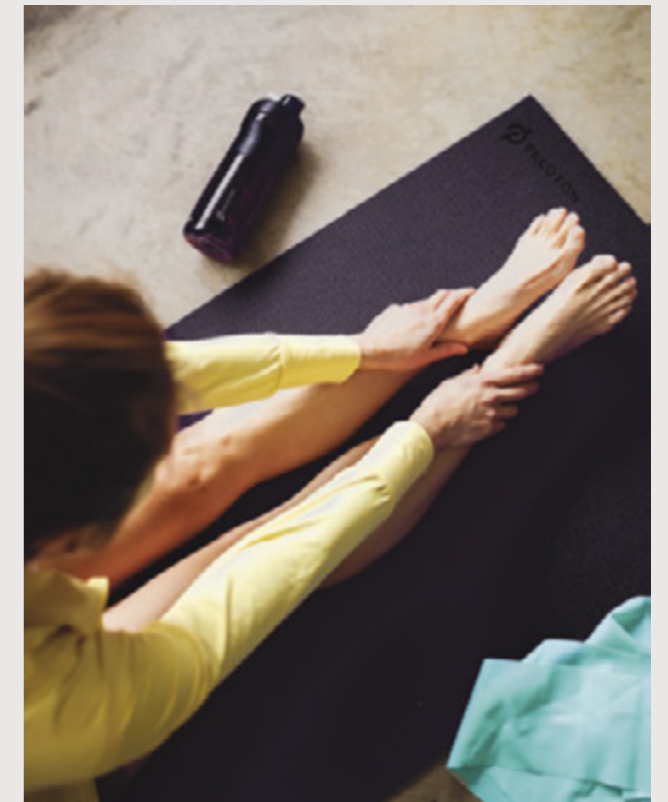

To explore the Peloton Hub, please scan this QR code

WELCOME HOME

You'll find craft and comfort in every room. From burnished bronze ironmongery and smart black fittings to chic chrome and brass, the mixed metals inspired by the industrial past are aesthetically authentic and built to last.



LIVING/DINING 1BED

- 01 NATURAL WASHED OAK EFFECT PARQUET FLOORING
- 02 ENERGY EFFICIENT DOWNLIGHTS
- 03 GLAZED DOOR ONTO BALCONY



KITCHEN 1BED

- 01 SLIM SHAKER WALL CABINETS IN NATURAL OAK EFFECT FINISH
- 02 LOW-LEVEL AND TALL CABINETS IN EMERALD GREEN FINISH
- 03 MARBLE EFFECT, SOLID SURFACE WORKTOP WITH OFF-WHITE HUES

03

03

02

01

02

03

BATHROOM 1BED

- 01 CURVED FRAME WALL MIRROR
- 02 STYLISH BRUSHED BRONZE SHOWER HEAD AND SHOWER HANDSET
- 03 LARGE TERRAZZO-EFFECT PORCELAIN FLOOR AND WALL TILES





03

02

01

LIVING DINING 2 BED

- 01 NATURAL WASHED OAK EFFECT PARQUET FLOORING
- 02 GLAZED DOOR ONTO BALCONY



KITCHEN 2 BED

- 01 INTEGRATED SIEMENS APPLIANCES CREATE A SPACE FULL OF MODERN FUNCTIONALITY
- 02 LOW-LEVEL AND TALL CABINERY IN EMERALD GREEN FINISH
- 03 VERTICAL METRO TILED SPLASHBACK IN GLAZED OFF-WHITE FINISH

03

03

02

01

03

BATHROOM 2/3 BED

- 01 WHITE MARBLE EFFECT PORCELAIN
- 02 FOREST GREEN METRO WALL TILES
- 03 MONOCHROME GEOMETRIC PORCELAIN TILES





03

03

02

01

03

BEDROOM MASTER BEDROOM

- 01 TIMBER EFFECT DOORS
- 02 ENERGY EFFICIENT DOWNLIGHTS
- 03 HALF-MOON FEATURE HANDLES

03



EN-SUITE SHOWER 2/3 BED

- 01 TERRAZZO EFFECT PORCELAIN TILES
- 02 CURVED FRAME WALL MIRROR
- 03 BLACK SLIDING SHOWER SCREEN

01

03

02





SPECIFICATION

INTERIOR FINISHES

- Entrance door with bronze finish ironmongery
- White painted internal doors with linear groove profile and bronze finish handles
- White painted square edge skirtings and architraves
- Natural / grey washed oak, luxury wood effect parquet flooring to kitchen, living and dining areas (Incl. studio open-plan bedrooms)
- Full-height built-in wardrobes to master bedroom, with grey and timber effect doors and half-moon feature handles. Internally painted, with shelving and black finish hanging rails
- Carpet to bedrooms
- Painted walls and ceilings finished in white matt emulsion

KITCHENS (DESIGN FEATURES/CABINETRY)

- Individually designed layouts
- Marble effect, solid surface worktop with off-white hues
- Vertical metro tiled splashback in glazed off-white finish
- Feature slim shaker wall cabinets in natural oak-effect finish
- Low-level / tall cabinetry in forest green finish
- Handle-less door design
- Concealed, under wall cabinet LED strip lighting
- Black finish sockets with USB charging point

APPLIANCES

Studio and One-bedroom apartments

- Single lever mixer-tap in stylish brushed black finish
- Single bowl, inset sink in black finish
- Siemens 4-ring touch control induction hob, black ceramic finish
- Siemens integrated combination microwave / oven
- Siemens integrated fixed canopy extractor
- Siemens integrated 70/30 fridge-freezer
- Integrated slimline dishwasher
- Washer/dryer located in utility cupboard

APPLIANCES

Two & Three-bedroom apartments

- Single lever mixer-tap in stylish brushed black finish
- 1 ½ bowl sink in black finish
- Siemens black integrated multi-function single oven
- Siemens black integrated microwave
- Siemens integrated fixed canopy extractor
- Siemens integrated 70/30 fridge-freezer
- Integrated dishwasher
- Washer/dryer located in utility cupboard
- Siemens 4-ring touch control induction hob, black glass finish

BATHROOM and SHOWER rooms

Shower room — Studio apartments & Bathroom — One-bedroom apartments

- Large format terrazzo-effect porcelain floor and wall tiles – Blue vertical metro wall tiles above vanity height
- Bespoke, feature vanity with semi recessed basin, integrated storage and solid surface countertop
- Curved frame wall mirror, glass shelving and wall mounted shaver socket
- Feature wall-mounted, cross head tap design in brushed bronze finish
- Dual flush wall-mounted WC pan with soft close seat
- Brushed bronze, ceiling mounted shower head and wall mounted shower handset
- Brushed bronze, wall-mounted temperature/diverter control
- Brushed bronze, electric heated towel bar
- White single-ended acrylic bath, brushed bronze bath filler. (Studios have low profile shower tray only)
- Black finish, two panel bath/shower screen (Studios include frameless fixed glass shower screen with black wall fixing)

Bathroom — Two & Three-bedroom apartments

- Large format white marble-effect porcelain, low level wall tiles
- Forest green vertical metro wall tiles above vanity height
- Monochrome diagonal stripe porcelain floor tiles
- Bespoke, feature vanity with semi recessed basin, integrated storage and solid surface countertop
- Curved frame wall mirror, glass shelving and wall mounted shaver socket
- Feature wall-mounted, cross head tap design in chrome finish
- Dual flush wall-mounted WC pan with soft close seat
- Chrome finish, ceiling mounted shower head and wall mounted shower handset
- Chrome finish, wall-mounted temperature/diverter control
- Black finish, electric heated towel bar
- White single-ended acrylic bath chrome, finish bath filler
- Black finish, two panel bath/shower screen



BATHROOM and SHOWER rooms

Shower room — Two & Three-bedroom apartments

- Large format Terrazzo-effect porcelain floor tile
- Large format light grey porcelain low level wall tile
- Blue vertical metro wall tiles above vanity height
- Bespoke, feature vanity with semi recessed basin, integrated storage and solid surface countertop
- Curved frame wall mirror, glass shelving and wall mounted shaver socket
- Feature wall-mounted, cross head tap design in chrome finish
- Dual flush wall-mounted WC pan with soft close seat
- Chrome finish, ceiling mounted shower head and wall mounted shower handset
- Chrome finish, wall-mounted temperature/diverter control
- Black finish, electric heated towel bar
- Low profile, white finish shower tray
- Sliding door glass shower screen with black frame

ELECTRICAL FINISHES

- Energy efficient LED ceiling downlighters
- Lighting to utilities where applicable
- Black finish switches and sockets throughout
- USB charging point to living room, kitchen and master bedroom
- High speed broadband available (subject to connection)

Studio apartments

- Television and satellite points to living area

One, Two & Three-bedroom apartments

- Television and satellite point to living areas
- Television point to bedrooms

HEATING and COOLING

- Heating, hot water and power from central system with metered water/ electric supply
- Independently zoned, thermostatically controlled underfloor heating throughout
- Whole-House ventilation
- Comfort cooling to selected rooms in selected apartments. Refer to your sales consultant

BALCONIES

- Glazed door onto balconies and terraces
- Non combustible decking to balconies, Paving slabs to terraces, Resin Bound Gravel to ground floor apartment terraces.

RESIDENT AMENITIES

- 24-hour concierge
- Peloton hub
- Landscaped garden and public realm
- Car parking: secure underground parking spaces, available by separate negotiation
- Cycling storage provision to all apartments

ENTRANCE LOBBIES, LIFTS and HALLWAYS

- Interior designed concierge, entrance lobbies and hallways
- Bespoke desk within concierge, feature lighting and reception lobby
- Carpet floor finishes, painted walls to upper levels communal corridors. Vinyl in front of lifts
- Two passenger lifts located within each entrance lobby serving floor levels

SUSTAINABLE FEATURES

- Mixed recycling facilities
- Landscaping to encourage biodiversity
- Provision for electric vehicle charging points (EVCP)
- Rooftop solar panels

SECURITY and PEACE OF MIND

- Audio/Visual entry system
- Mains supply heat and smoke detectors and fitted with battery back-up, domestic fire sprinkler system
- Multi-point locking and spy hole to apartment entrance doors
- 24-hour monitored CCTV
- Access control to car parks, bicycle storage, main entrance lobby and Peloton hub
- 999-year lease
- Two-year fixtures and fittings warranty
- 10-year warranty

MANAGEMENT COMPANY

- A management company will be appointed to administer the effective operation and maintenance of communal facilities for which a service charge will be levied and apportioned to the benefit offered.

THE ARRIVAL GROUND LEVEL

3A.00.01 1 BED	TOTAL AREA	63.4 sq m	682.2 sq ft
Living/Dining	3.64 × 4.59m	11'11" × 15'1"	
Kitchen	3.59 × 3.21m	11'9" × 10'6"	
Master Bedroom	3.05 × 5.44m	10'0" × 17'10"	
Internal Area	53.3 sq m	573.5 sq ft	
Terrace	6.73 × 1.50m	22'1" × 4'11"	
External Area	10.10 sq m	108.7 sq ft	

3A.00.02 1 BED	TOTAL AREA	69.9 sq m	752.2 sq ft
Living/Dining	3.20 × 5.72m	10'6" × 18'9"	
Kitchen	2.00 × 3.94m	6'7" × 12'11"	
Master Bedroom	3.42 × 4.12m	11'3" × 13'6"	
Internal Area	58.7 sq m	631.6 sq ft	
Terrace	7.44 × 1.50m	24'5" × 4'11"	
External Area	11.20 sq m	120.6 sq ft	

3A.00.03 1 BED	TOTAL AREA	66.7 sq m	717.8 sq ft
Living/Dining	4.96 × 2.96m	16'3" × 9'9"	
Kitchen	3.93 × 4.81m	12'11" × 15'8"	
Master Bedroom	4.96 × 2.75m	15'11" × 9'0"	
Internal Area	57.9 sq m	623.2 sq ft	
Terrace	5.86 × 1.50m	19'3" × 4'11"	
External Area	8.79 sq m	94.6 sq ft	

3B.00.01 1 BED	TOTAL AREA	63 sq m	678.2 sq ft
Living	3.1 × 2.35m	10'2" × 7'9"	
Kitchen/Dining	3.03 × 4.32m	9'11" × 14'2"	
Bedroom	4.72 × 3.25m	15'6" × 10'8"	
Internal Area	51.3 sq m	551.9 sq ft	
Terrace	7.77 × 1.51m	25'6" × 4'11"	
External Area	11.74 sq m	126.3 sq ft	

3B.00.02 1 BED	TOTAL AREA	61.9 sq m	666.6 sq ft
Living	2.67 × 4.01m	8'9" × 13'2"	
Kitchen/Dining	3.20 × 3.96m	10'6" × 13'0"	
Bedroom	4.72 × 3.25m	15'6" × 10'8"	
Internal Area	50.7 sq m	545.5 sq ft	
Terrace	7.45 × 1.51m	24'5" × 4'11"	
External Area	11.2 sq m	121.1 sq ft	

3B.00.03 2 BED	TOTAL AREA	94.6 sq m	1018 sq ft
Living	3.70 × 3.37m	12'2" × 11'1"	
Kitchen/Dining	3.70 × 3.47m	12'2" × 11'4"	
Master Bedroom	4.28 × 3.23m	14'1" × 10'7"	
Bedroom 2	5.87 × 2.75m	19'3" × 9'0"	
Internal Area	80.6 sq m	867.1 sq ft	
Terrace 1	5.51 × 1.50m	18'1" × 4'11"	
Terrace 2	3.80 × 1.51m	12'6" × 4'11"	
External Area	14 sq m	150.8 sq ft	



GROUND LEVEL



SITE MAP

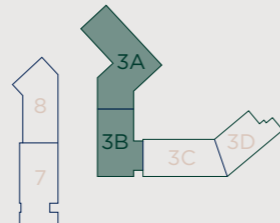

THE ARRIVAL LEVEL 01



3A.01.01 1 BED	TOTAL AREA	60.4 sq m	650.4 sq ft
Living/Dining	3.64 × 4.58m	11'11" × 15'11"	
Kitchen	3.59 × 3.21m	11'9" × 10'6"	
Master Bedroom	3.05 × 5.45m	10'0" × 17'10"	
Internal Area	53.3 sq m	573.5 sq ft	
Balcony	3.80 × 1.88m	12'6" × 6'2"	
External Area	7.14 sq m	76.9 sq ft	

3A.01.02 1 BED	TOTAL AREA	64.4 sq m	693.6 sq ft
Living/Dining	3.20 × 5.72m	10'6" × 18'9"	
Kitchen	2.00 × 3.94m	6'7" × 12'11"	
Master Bedroom	3.42 × 4.12m	11'3" × 13'6"	
Internal Area	58.7 sq m	631.6 sq ft	
Balcony	3.20 × 1.80m	10'6" × 5'11"	
External Area	5.76 sq m	62.0 sq ft	

3A.01.03 2 BED	TOTAL AREA	79.8 sq m	858.8 sq ft
Kitchen/Dining	3.75 × 3.63m	12'4" × 11'11"	
Living	3.51 × 3.63m	11'6" × 11'11"	
Master Bedroom	3.82 × 3.33m	12'6" × 10'11"	
Bedroom 2	3.82 × 3.25m	12'6" × 10'8"	
Internal Area	72.7 sq m	782.6 sq ft	
Balcony	3.95 × 1.79m	12'12" × 5'10"	
External Area	7.07 sq m	76.1 sq ft	

3A.01.04 1 BED	TOTAL AREA	59.8 sq m	643.5 sq ft
Kitchen/Dining	3.10 × 4.28m	10'2" × 14'11"	
Living	3.88 × 3.49m	12'9" × 11'5"	
Master Bedroom	3.71 × 3.24m	12'2" × 10'7"	
Internal Area	53.5 sq m	575.7 sq ft	
Balcony	1.68 × 3.75m	5'6" × 12'4"	
External Area	6.30 sq m	67.8 sq ft	

3A.01.05 2 BED	TOTAL AREA	86.4 sq m	930.1 sq ft
Kitchen/Living/Dining	19'9" × 16'1"	6.01 × 4.91m	
Master Bedroom	3.17 × 4.84m	10'5" × 15'11"	
Bedroom 2	5.84 × 3.32m	19'2" × 10'11"	
Internal Area	75.0 sq m	807.0 sq ft	
Balcony	2.60 × 4.40m	8'6" × 14'5"	
External Area	11.44 sq m	123.1 sq ft	

3A.01.06 1 BED	TOTAL AREA	57.1 sq m	614.9 sq ft
Living/Dining	3.89 × 3.90m	12'9" × 12'9"	
Kitchen	3.15 × 3.90m	10'4" × 12'9"	
Master Bedroom	4.83 × 3.25m	15'10" × 10'8"	
Internal Area	51.0 sq m	549.0 sq ft	
Balcony	3.55 × 1.73m	11'8" × 5'8"	
External Area	6.1 sq m	65.9 sq ft	

3A.01.07 2 BED	TOTAL AREA	87.3 sq m	939.6 sq ft
Kitchen/Dining	4.00 × 4.30m	13'2" × 14'11"	
Living	3.50 × 2.91m	11'6" × 9'6"	
Master Bedroom	5.92 × 2.91m	19'5" × 9'6"	
Bedroom 2	3.95 × 3.24m	12'11" × 10'8"	
Internal Area	76.1 sq m	819.0 sq ft	
Terrace	7.47 × 1.50m	24'6" × 4'11"	
External Area	11.20 sq m	120.5 sq ft	

3A.01.08 1 BED	TOTAL AREA	66.7 sq m	718.0 sq ft
Kitchen/Dining	4.32 × 2.92m	14'2" × 9'7"	
Living	4.31 × 4.45m	14'2" × 14'7"	
Master Bedroom	3.97 × 3.48m	13'0" × 11'4"	
Internal Area	55.4 sq m	596.3 sq ft	
Balcony	7.54 × 1.50m	23'9" × 5'4"	
External Area	11.30 sq m	121.7 sq ft	

LEVEL 01



SITE MAP

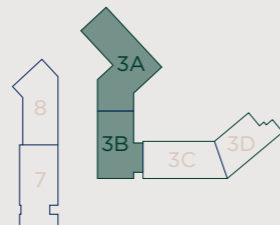

3B.01.01 1 BED	TOTAL AREA	61 sq m	656.3 sq ft
Living	2.97 × 4.23m	9'9" × 13'10"	
Kitchen/Dining	4.01 × 3.93m	13'2" × 12'11"	
Bedroom	3.10 × 4.05m	10'2" × 13'4"	
Internal Area	52.4 sq m	564.5 sq ft	
Balcony	5.99 × 1.43m	19'8" × 4'8"	
External Area	8.5 sq m	91.9 sq ft	

3B.01.02 2 BED	TOTAL AREA	85.8 sq m	923.1 sq ft
Living	4.98 × 4.16m	16'4" × 13'8"	
Kitchen/Dining	3.48 × 3.42m	11'5" × 11'3"	
Master Bedroom	2.75 × 4.76m	9'0" × 15'7"	
Bedroom 2	2.75 × 4.75m	9'0" × 15'7"	
Internal Area	76.7 sq m	825.6 sq ft	
Balcony	6.04 × 1.50m	19'10" × 4'11"	
External Area	9.1 sq m	97.5 sq ft	

3B.01.03 2 BED	TOTAL AREA	77 sq m	828.9 sq ft
Living	3.76 × 3.68m	12'4" × 12'11"	
Kitchen/Dining	3.0 × 4.58m	9'10" × 15'0"	
Master Bedroom	4.72 × 3.25m	15'6" × 10'8"	
Bedroom 2	4.48 × 3.24m	14'8" × 10'7"	
Internal Area	70 sq m	753.5 sq ft	
Balcony	3.95 × 1.78m	13'0" × 5'10"	
External Area	7 sq m	75.5 sq ft	

3B.01.04 1 BED	TOTAL AREA	55.9 sq m	601.2 sq ft
Living/Dining	2.67 × 4.01m	8'9" × 13'2"	
Kitchen/Dining	3.20 × 3.96m	10'6" × 13'0"	
Bedroom	4.72 × 3.25m	15'6" × 10'8"	
Internal Area	50.7 sq m	545.5 sq ft	
Balcony	2.95 × 1.76m	9'8" × 5'9"	
External Area	5.2 sq m	55.7 sq ft	

3B.01.05 1 BED	TOTAL AREA	63.2 sq m	680.1 sq ft
Living	2.23 × 3.36m	7'4" × 11'0"	
Kitchen/Dining	4.14 × 3.36m	13'7" × 11'0"	
Bedroom	4.21 × 3.33m	13'10" × 10'11"	
Internal Area	58.0 sq m	623.8 sq ft	
Balcony	2.95 × 1.78m	9'8" × 5'10"	
External Area	5.2 sq m	56.4 sq ft	

3B.01.06 2 BED	TOTAL AREA	75.1 sq m	808.8 sq ft
Living	3.96 × 3.19m	13'0" × 10'5"	
Kitchen/Dining	2.90 × 4.64m	9'6" × 15'3"	
Master Bedroom	4.71 × 3.25m	15'5" × 10'8"	
Bedroom 2	3.86 × 3.35m	12'8" × 11'0"	
Internal Area	68.1 sq m	732.5 sq ft	
Balcony	1.79 × 3.96m	5'10" × 13'0"	
External Area	7.1 sq m	76.3 sq ft	



THE ARRIVAL LEVEL 02



3A.02.01 1 BED	TOTAL AREA Living/Dining Kitchen Master Bedroom Internal Area Balcony External Area	60.4 sq m 3.64 × 4.59m 3.59 × 3.21m 3.05 × 5.44m 53.3 sq m 3.80 × 1.88m 7.14 sq m	650.4 sq ft 11'11" × 15'1" 11'9" × 10'6" 10' " × 17'10" 573.5 sq ft 12'6" × 6'2" 76.9 sq ft
--------------------------	--	--	--

3A.02.02 1 BED	TOTAL AREA Living/Dining Kitchen Master Bedroom Internal Area Balcony External Area	64.4 sq m 3.20 × 5.72m 2.00 × 3.94m 3.42 × 4.12m 58.7 sq m 3.20 × 1.80m 5.76 sq m	693.6 sq ft 10'6" × 18'9" 6'7" × 12'11" 11'3" × 13'6" 631.6 sq ft 10'6" × 5'11" 62.0 sq ft
--------------------------	--	--	---

3A.02.03 2 BED	TOTAL AREA Kitchen/Dining Living Master Bedroom Bedroom 2 Internal Area Balcony External Area	79.8 sq m 3.75 × 3.63m 3.51 × 3.63m 3.82 × 3.33m 3.82 × 3.25m 72.7 sq m 3.95 × 1.79m 7.07 sq m	858.8 sq ft 12'4" × 11'11" 11'6" × 11'11" 12'6" × 10'11" 12'6" × 10'8" 782.6 sq ft 12'12" × 5'10" 76.1 sq ft
--------------------------	---	--	--

3A.02.04 1 BED	TOTAL AREA Kitchen/Dining Living Master Bedroom Internal Area Balcony External Area	59.8 sq m 3.10 × 4.28m 3.88 × 3.49m 3.71 × 3.24m 53.5 sq m 1.68 × 3.75m 6.30 sq m	643.5 sq ft 10'2" × 14'1" 12'9" × 11'5" 12'2" × 10'7" 575.7 sq ft 5'6" × 12'4" 67.8 sq ft
--------------------------	--	--	--

3A.02.05 2 BED	TOTAL AREA Kitchen/Living/Dining Master Bedroom Bedroom 2 Internal Area Balcony External Area	86.4 sq m 19'9" × 16'1" 3.17 × 4.84m 5.84 × 3.32m 75.0 sq m 2.60 × 4.40m 11.44 sq m	930.1 sq ft 6.01 × 4.91m 10'5" × 15'11" 19'2" × 10'11" 807.0 sq ft 8'6" × 14'5" 123.1 sq ft
--------------------------	--	--	--

3A.02.06 1 BED	TOTAL AREA Living/Dining Kitchen Master Bedroom Internal Area Balcony External Area	57.1 sq m 3.89 × 3.90m 3.15 × 3.90m 4.83 × 3.25m 51.0 sq m 3.55 × 1.73m 6.1 sq m	614.9 sq ft 12'9" × 12'9" 10'4" × 12'9" 15'10" × 10'8" 549.0 sq ft 11'8" × 5'8" 65.9 sq ft
--------------------------	--	---	---

3A.02.07 2 BED	TOTAL AREA Kitchen/Dining Living Master Bedroom Bedroom 2 Internal Area Balcony External Area	84.7 sq m 4.00 × 4.36m 3.50 × 2.91m 5.92 × 2.90m 3.90 × 3.26m 77.7 sq m 4.00 × 1.75m 7.0 sq m	912.0 sq ft 13'2" × 14'3" 11'6" × 9'6" 19'5" × 9'6" 12'10" × 10'8" 836.7 sq ft 13'1" × 5'9" 75.3 sq ft
--------------------------	---	---	--

3A.02.08 1 BED	TOTAL AREA Kitchen/Dining Living Master Bedroom Internal Area Terrace External Area	62.0 sq m 4.31 × 2.92m 4.31 × 4.46m 3.97 × 3.49m 55.7 sq m 3.60 × 1.74m 6.26 sq m	667.0 sq ft 14'2" × 9'7" 14'2" × 14'8" 13'0" × 11'5" 599.5 sq ft 11'10" × 5'9" 67.4 sq ft
--------------------------	--	--	--

LEVEL 02



3B.02.01 1 BED	TOTAL AREA Living Kitchen/Dining Bedroom Internal Area Balcony External Area	61.8 sq m 2.97 × 4.23m 4.01 × 3.93m 3.10 × 4.05m 52.4 sq m 6.26 × 1.50m 9.4 sq m	665.6 sq ft 9'9" × 13'10" 13'2" × 12'11" 10'2" × 13'4" 564.5 sq ft 20'7" × 4'11" 101.1 sq ft
--------------------------	---	---	---

3B.02.02 2 BED	TOTAL AREA Living Kitchen/Dining Master Bedroom Bedroom 2 Internal Area Balcony External Area	89.3 sq m 3.74 × 4.98m 3.42 × 3.48m 2.75 × 4.76m 2.75 × 4.75m 75 sq m 9.53 × 1.50m 14.3 sq m	961.2 sq ft 12'3" × 16'4" 11'3" × 11'5" 9'0" × 15'7" 9'0" × 15'7" 807.3 sq ft 31'3" × 4'11" 153.9 sq ft
--------------------------	---	--	---

3B.02.03 2 BED	TOTAL AREA Living Kitchen/Dining Master Bedroom Bedroom 2 Internal Area Balcony External Area	77 sq m 3.76 × 3.68m 3.0 × 4.58m 4.72 × 3.25m 4.48 × 3.24m 70 sq m 3.95 × 1.78m 7 sq m	828.9 sq ft 12'4" × 12'1" 9'10" × 15'0" 15'6" × 10'8" 14'8" × 10'7" 753.5 sq ft 13'0" × 5'10" 75.5 sq ft
--------------------------	---	--	--

3B.02.04 1 BED	TOTAL AREA Living Kitchen/Dining Bedroom Internal Area Balcony External Area	55.9 sq m 2.67 × 4.01m 3.20 × 3.96m 4.72 × 3.25m 50.7 sq m 2.95 × 1.76m 5.2 sq m	601.2 sq ft 8'9" × 13'2" 10'6" × 13'0" 15'6" × 10'8" 545.5 sq ft 9'8" × 5'9" 55.7 sq ft
--------------------------	---	---	--

3B.02.05 1 BED	TOTAL AREA Living Kitchen/Dining Bedroom Internal Area Balcony External Area	63.2 sq m 2.23 × 3.36m 4.14 × 3.36m 4.21 × 3.33m 58.0 sq m 2.95 × 1.78m 5.2 sq m	680.1 sq ft 7'4" × 11'0" 13'7" × 11'0" 13'10" × 10'11" 623.8 sq ft 9'8" × 5'10" 56.4 sq ft
--------------------------	---	---	---

3B.02.06 2 BED	TOTAL AREA Living Kitchen/Dining Master Bedroom Bedroom 2 Internal Area Balcony External Area	75.1 sq m 3.96 × 3.19m 2.90 × 4.64m 4.71 × 3.25m 3.86 × 3.35m 68.1 sq m 1.79 × 3.95m 7.1 sq m	808.6 sq ft 13'0" × 10'5" 9'6" × 15'3" 15'5" × 10'8" 12'8" × 11'0" 732.5 sq ft 5'10" × 13'0" 76.1 sq ft
--------------------------	---	---	---

3B.02.07 1 BED	TOTAL AREA Living Kitchen/Dining Bedroom Internal Area Balcony External Area	69.1 sq m 3.17 × 3.80m 3.44 × 3.85m 4.30 × 3.86m 64 sq m 1.68 × 3.00m 5 sq m	743.6 sq ft 10'5" × 12'6" 11'3" × 12'8" 14'1" × 12'8" 689.1 sq ft 5'6" × 9'10" 54.5 sq ft
--------------------------	---	---	--

SITE MAP

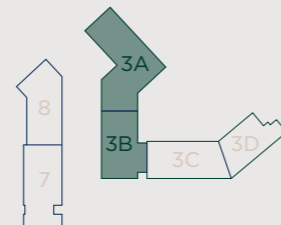

THE ARRIVAL LEVEL 03



3A.03.01 1 BED	TOTAL AREA Living/Dining Kitchen Master Bedroom Internal Area Balcony External Area	60.4 sq m 3.64 x 4.58m 3.59 x 3.21m 3.05 x 5.45m 53.3 sq m 3.80 x 1.88m 7.14 sq m	650.4 sq ft 11'11" x 15'11" 11'9" x 10'6" 10'0" x 17'10" 573.5 sq ft 12'6" x 6'2" 76.9 sq ft
--------------------------	--	--	---

3A.03.02 1 BED	TOTAL AREA Living/Dining Kitchen Master Bedroom Internal Area Balcony External Area	64.4 sq m 3.20 x 5.72m 2.00 x 3.94m 3.42 x 4.12m 58.7 sq m 3.20 x 1.80m 5.76 sq m	693.6 sq ft 10'6" x 18'9" 6'7" x 12'11" 11'3" x 13'6" 631.6 sq ft 10'6" x 5'11" 62.0 sq ft
--------------------------	--	--	---

3A.03.03 2 BED	TOTAL AREA Kitchen/Dining Living Master Bedroom Bedroom 2 Internal Area Balcony External Area	79.8 sq m 3.75 x 3.63m 3.51 x 3.63m 3.82 x 3.33m 3.82 x 3.25m 72.7 sq m 3.95 x 1.79m 7.07 sq m	858.8 sq ft 12'4" x 11'11" 11'6" x 11'11" 12'6" x 10'11" 12'6" x 10'8" 782.6 sq ft 12'12" x 5'10" 76.1 sq ft
--------------------------	---	--	--

3A.03.04 1 BED	TOTAL AREA Kitchen/Dining Living Master Bedroom Internal Area Balcony External Area	59.8 sq m 3.10 x 4.28m 3.88 x 3.49m 3.71 x 3.24m 53.5 sq m 1.68 x 3.75m 6.30 sq m	643.5 sq ft 10'2" x 14'11" 12'9" x 11'5" 12'2" x 10'7" 575.7 sq ft 5'6" x 12'4" 67.8 sq ft
--------------------------	--	--	---

3A.03.05 2 BED	TOTAL AREA Kitchen/Living/Dining Master Bedroom Bedroom 2 Internal Area Balcony External Area	86.4 sq m 19'9" x 16'11" 3.17 x 4.84m 5.84 x 3.32m 75.0 sq m 2.60 x 4.40m 11.44 sq m	930.1 sq ft 6.01 x 4.91m 10'5" x 15'11" 19'2" x 10'11" 807.0 sq ft 8'6" x 14'5" 123.1 sq ft
--------------------------	--	---	--

3A.03.06 1 BED	TOTAL AREA Living/Dining Kitchen Master Bedroom Internal Area Balcony External Area	57.1 sq m 3.89 x 3.90m 3.15 x 3.90m 4.83 x 3.25m 51.0 sq m 3.55 x 1.73m 6.1 sq m	614.9 sq ft 12'9" x 12'9" 10'4" x 12'9" 15'10" x 10'8" 549.0 sq ft 11'8" x 5'8" 65.9 sq ft
--------------------------	--	---	---

3A.03.07 2 BED	TOTAL AREA Kitchen/Dining Living Master Bedroom Bedroom 2 Internal Area Balcony External Area	84.7 sq m 4.00 x 4.36m 3.50 x 2.91m 5.92 x 2.90m 3.90 x 3.26m 77.7 sq m 4.00 x 1.75m 7.0 sq m	912.0 sq ft 13'2" x 14'3" 11'6" x 9'6" 19'5" x 9'6" 12'10" x 10'8" 836.7 sq ft 13'1" x 5'9" 75.3 sq ft
--------------------------	---	---	--

3A.03.08 1 BED	TOTAL AREA Kitchen/Dining Living Master Bedroom Internal Area Terrace External Area	62.0 sq m 4.31 x 2.92m 4.31 x 4.46m 3.97 x 3.49m 55.7 sq m 3.60 x 1.74m 6.26 sq m	667.0 sq ft 14'2" x 9'7" 14'2" x 14'8" 13'0" x 11'5" 599.5 sq ft 11'10" x 5'9" 67.4 sq ft
--------------------------	--	--	--

LEVEL 03



3B.03.01 1 BED	TOTAL AREA Living Kitchen/Dining Bedroom Internal Area Balcony External Area	61.8 sq m 2.97 x 4.23m 4.01 x 3.93m 3.10 x 4.05m 52.4 sq m 6.26 x 1.50m 9.4 sq m	665.6 sq ft 9'9" x 13'10" 13'2" x 12'11" 10'2" x 13'4" 564.5 sq ft 20'7" x 4'11" 101.1 sq ft
--------------------------	---	---	---

3B.03.02 2 BED	TOTAL AREA Living Kitchen/Dining Master Bedroom Bedroom 2 Internal Area Balcony External Area	89.3 sq m 3.74 x 4.98m 3.42 x 3.48m 2.75 x 4.76m 2.75 x 4.75m 75 sq m 9.53 x 1.50m 14.3 sq m	961.2 sq ft 12'3" x 16'4" 11'3" x 11'5" 9'0" x 15'7" 9'0" x 15'7" 807.3 sq ft 31'3" x 4'11" 153.9 sq ft
--------------------------	---	--	---

3B.03.03 2 BED	TOTAL AREA Living Kitchen/Dining Master Bedroom Bedroom 2 Internal Area Balcony External Area	77 sq m 3.76 x 3.68m 3.0 x 4.58m 4.72 x 3.25m 4.48 x 3.24m 70 sq m 3.95 x 1.78m 7 sq m	828.9 sq ft 12'4" x 12'11" 9'10" x 15'0" 15'6" x 10'8" 14'8" x 10'7" 753.5 sq ft 13'0" x 5'10" 75.5 sq ft
--------------------------	---	--	---

3B.03.04 1 BED	TOTAL AREA Living Kitchen/Dining Bedroom Internal Area Balcony External Area	55.9 sq m 2.67 x 4.01m 3.20 x 3.96m 4.72 x 3.25m 50.7 sq m 2.95 x 1.76m 5.2 sq m	601.2 sq ft 8'9" x 13'2" 10'6" x 13'0" 15'6" x 10'8" 545.5 sq ft 9'8" x 5'9" 55.7 sq ft
--------------------------	---	---	--

3B.03.05 1 BED	TOTAL AREA Living Kitchen/Dining Bedroom Internal Area Balcony External Area	63.2 sq m 2.23 x 3.36m 4.14 x 3.36m 4.21 x 3.33m 58.0 sq m 2.95 x 1.78m 5.2 sq m	680.1 sq ft 7'4" x 11'0" 13'7" x 11'0" 13'10" x 10'11" 623.8 sq ft 9'8" x 5'10" 56.4 sq ft
--------------------------	---	---	---

3B.03.06 2 BED	TOTAL AREA Living Kitchen/Dining Master Bedroom Bedroom 2 Internal Area Balcony External Area	75.1 sq m 3.96 x 3.19m 2.90 x 4.64m 4.71 x 3.25m 3.86 x 3.35m 68.1 sq m 1.79 x 3.95m 7.1 sq m	808.6 sq ft 13'0" x 10'5" 9'6" x 15'3" 15'5" x 10'8" 12'8" x 11'0" 732.5 sq ft 5'10" x 13'0" 76.1 sq ft
--------------------------	---	---	---

3B.03.07 1 BED	TOTAL AREA Living Kitchen/Dining Bedroom Internal Area Terrace External Area	69.4 sq m 3.67 x 3.85m 3.00 x 3.80m 4.60 x 3.86m 64.0 sq m 1.80 x 3.00m 5.4 sq m	747.2 sq ft 12'0" x 12'8" 9'10" x 12'6" 13'4" x 12'8" 689.1 sq ft 5'11" x 9'10" 58.1 sq ft
--------------------------	---	---	---

SITE MAP

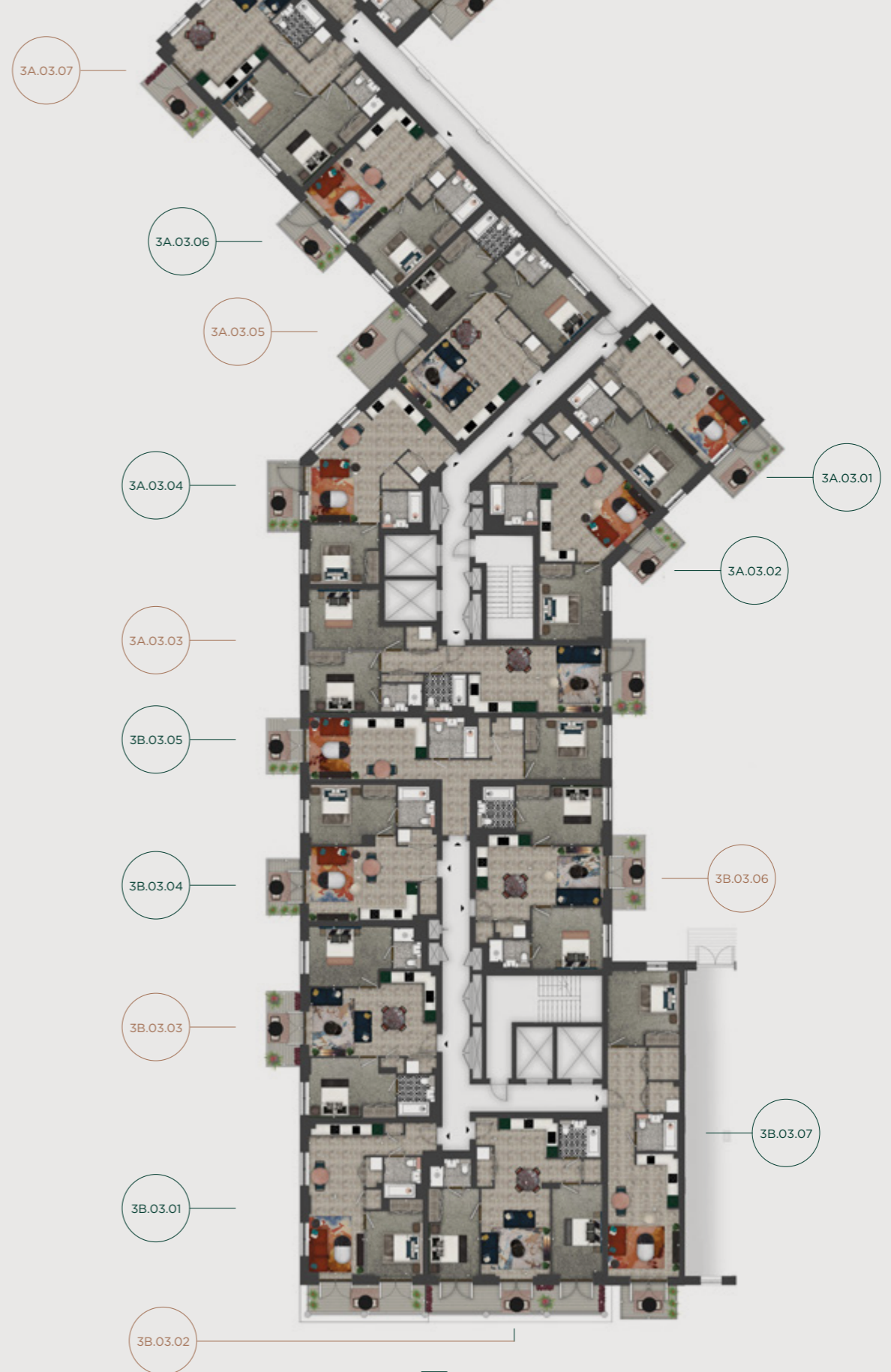
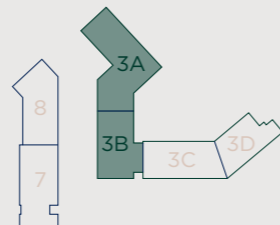

THE ARRIVAL LEVEL 04



3A.04.01 1 BED	TOTAL AREA Kitchen /Living/Dining 20'1" x 13'9"	92.9 sq m 6.39 x 3.40m	1000.2 sq ft 6.13 x 4.18m
	Master Bedroom	6.39 x 3.40m	21'0" x 11'2"
	Internal Area	65.9 sq m	709.3 sq ft
	Terrace	6.45 x 4.19m	21'2" x 13'9"
	External Area	27.0 sq m	290.9 sq ft

3A.04.02 2 BED	TOTAL AREA Kitchen/Dining Living	79.8 sq m 3.75 x 3.63m 3.51 x 3.63m	858.8 sq ft 12'4" x 11'11" 11'6" x 11'11"
	Master Bedroom	3.82 x 3.33m	12'6" x 10'11"
	Bedroom 2	3.82 x 3.25m	12'6" x 10'8"
	Internal Area	72.7 sq m	782.6 sq ft
	Balcony	3.95 x 1.79m	12'12" x 5'10"
	External Area	7.07 sq m	76.1 sq ft

3A.04.03 1 BED	TOTAL AREA Kitchen/Dining Living	59.8 sq m 3.10 x 4.28m 3.88 x 3.49m	643.5 sq ft 10'2" x 14'1" 12'9" x 11'5"
	Master Bedroom	3.71 x 3.24m	12'2" x 10'7"
	Internal Area	53.5 sq m	575.7 sq ft
	Balcony	1.68 x 3.75m	5'6" x 12'4"
	External Area	6.30 sq m	67.8 sq ft

3A.04.04 1 BED	TOTAL AREA Living/Dining Kitchen	99.3 sq m 4.94 x 4.93m 3.86 x 2.37m	1068.7 sq ft 16'2" x 16'2" 12'8" x 7'9"
	Master Bedroom	4.22 x 3.04m	13'10" x 10'0"
	Internal Area	51.4 sq m	553.3 sq ft
	Terrace	8.76 x 4.17m	28'9" x 13'8"
	Balcony	4.40 x 2.58m	14'5" x 8'6"
	External Area	47.88 sq m	515.4 sq ft

LEVEL 04



3B.04.01 1 BED	TOTAL AREA Living Kitchen/Dining	61.8 sq m 2.97 x 4.23m 4.01 x 3.93m	665.6 sq ft 9'9" x 13'10" 13'2" x 12'11"
	Bedroom	3.10 x 4.05m	10'2" x 13'4"
	Internal Area	52.4 sq m	564.5 sq ft
	Balcony	6.26 x 1.50m	20'7" x 4'11"
	External Area	9.4 sq m	101.1 sq ft

3B.04.02 2 BED	TOTAL AREA Living Kitchen/Dining	89.3 sq m 3.74 x 4.98m 3.42 x 3.48m	961.2 sq ft 12'3" x 16'4" 11'3" x 11'5"
	Master Bedroom	2.75 x 4.76m	9'0" x 15'7"
	Bedroom 2	2.75 x 4.75m	9'0" x 15'7"
	Internal Area	75 sq m	807.3 sq ft
	Balcony	9.53 x 1.50m	31'3" x 4'11"
	External Area	14.3 sq m	153.9 sq ft

3B.04.03 2 BED	TOTAL AREA Living Kitchen/Dining	77 sq m 3.76 x 3.68m 3.0 x 4.58m	828.9 sq ft 12'4" x 12'1" 9'10" x 15'0"
	Master Bedroom	4.72 x 3.25m	15'6" x 10'8"
	Bedroom 2	4.48 x 3.24m	14'8" x 10'7"
	Internal Area	70 sq m	753.5 sq ft
	Balcony	3.95 x 1.78m	13'0" x 5'10"
	External Area	7 sq m	75.5 sq ft

3B.04.04 1 BED	TOTAL AREA Living Kitchen/Dining	55.9 sq m 2.67 x 4.01m 3.20 x 3.96m	601.2 sq ft 8'9" x 13'2" 10'6" x 13'0"
	Bedroom	4.72 x 3.25m	15'6" x 10'8"
	Internal Area	50.7 sq m	545.5 sq ft
	Balcony	2.95 x 1.76m	9'8" x 5'9"
	External Area	5.2 sq m	55.7 sq ft

3B.04.05 1 BED	TOTAL AREA Living Kitchen/Dining	63.2 sq m 2.23 x 3.36m 4.14 x 3.36m	680.1 sq ft 7'4" x 11'0" 13'7" x 11'0"
	Bedroom	4.21 x 3.33m	13'10" x 10'11"
	Internal Area	58.0 sq m	623.8 sq ft
	Balcony	2.95 x 1.78m	9'8" x 5'10"
	External Area	5.2 sq m	56.4 sq ft

3B.04.06 2 BED	TOTAL AREA Living Kitchen/Dining	75.1 sq m 3.96 x 3.19m 2.90 x 4.64m	808.6 sq ft 13'0" x 10'5" 9'6" x 15'3"
	Master Bedroom	4.71 x 3.25m	15'5" x 10'8"
	Bedroom 2	3.86 x 3.35m	12'8" x 11'0"
	Internal Area	68.1 sq m	732.5 sq ft
	Balcony	1.79 x 3.95m	5'10" x 13'0"
	External Area	7.1 sq m	76.1 sq ft

3B.04.07 2 BED	TOTAL AREA Living Kitchen/Dining	88 sq m 4.40 x 3.50m 3.77 x 3.80m	946.7 sq ft 14'5" x 11'6" 12'4" x 12'6"
	Master Bedroom	5.19 x 2.75m	17'0" x 9'0"
	Bedroom 2	3.58 x 3.80m	11'9" x 12'6"
	Internal Area	80.8 sq m	869.7 sq ft
	Balcony	1.80 x 3.98m	5'11" x 13'0"
	External Area	7.2 sq m	77 sq ft

SITE MAP

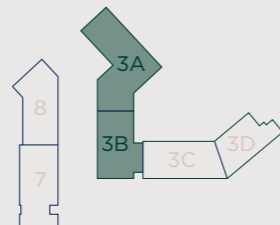

THE ARRIVAL LEVEL 05



3A.05.01 1 BED	TOTAL AREA 71.6 sq m	770.7 sq ft
Kitchen /Living/Dining 20'1" x 13'9"		
Master Bedroom	6.39 x 3.40m	21'0" x 11'2"
Internal Area	65.9 sq m	709.3 sq ft
Balcony	3.80 x 1.50m	12'6" x 4'11"
External Area	5.70 sq m	61.4 sq ft

3A.05.02 2 BED	TOTAL AREA 79.8 sq m	858.8 sq ft
Kitchen/Dining Living		
Master Bedroom	3.75 x 3.63m	12'4" x 11'11"
Bedroom 2	3.51 x 3.63m	11'6" x 11'11"
Bedroom 2	3.82 x 3.33m	12'6" x 10'11"
Bedroom 2	3.82 x 3.25m	12'6" x 10'8"
Internal Area	72.7 sq m	782.6 sq ft
Balcony	3.95 x 1.79m	12'12" x 5'10"
External Area	7.07 sq m	76.1 sq ft

3A.05.03 1 BED	TOTAL AREA 59.8 sq m	643.5 sq ft
Kitchen/Dining Living		
Master Bedroom	3.10 x 4.28m	10'2" x 14'1"
Bedroom 2	3.88 x 3.49m	12'9" x 11'5"
Bedroom 2	3.71 x 3.24m	12'2" x 10'7"
Internal Area	53.5 sq m	575.7 sq ft
Balcony	1.68 x 3.75m	5'6" x 12'4"
External Area	6.30 sq m	67.8 sq ft

3A.05.04 1 BED	TOTAL AREA 57.6 sq m	619.5 sq ft
Living/Dining Kitchen		
Master Bedroom	4.97 x 4.93m	16'4" x 16'2"
Bedroom 2	3.86 x 2.37m	12'8" x 7'9"
Bedroom 2	4.22 x 3.04m	13'10" x 10'0"
Internal Area	51.4 sq m	553.3 sq ft
Balcony	3.80 x 1.62m	12'6" x 5'4"
External Area	6.16 sq m	66.3 sq ft

3B.05.01 1 BED	TOTAL AREA 61.8 sq m	665.6 sq ft
Living Kitchen/Dining		
Bedroom	2.97 x 4.23m	9'9" x 13'10"
Bedroom	4.01 x 3.93m	13'2" x 12'11"
Bedroom	3.10 x 4.05m	10'2" x 13'4"
Internal Area	52.4 sq m	564.5 sq ft
Balcony	6.26 x 1.50m	20'7" x 4'11"
External Area	9.4 sq m	101.1 sq ft

3B.05.02 2 BED	TOTAL AREA 89.3 sq m	961.2 sq ft
Living Kitchen/Dining		
Master Bedroom	3.74 x 4.98m	12'3" x 16'4"
Bedroom 2	3.42 x 3.48m	11'3" x 11'5"
Bedroom 2	2.75 x 4.76m	9'0" x 15'7"
Bedroom 2	2.75 x 4.75m	9'0" x 15'7"
Internal Area	75 sq m	807.3 sq ft
Balcony	9.53 x 1.50m	31'3" x 4'11"
External Area	14.3 sq m	153.9 sq ft

3B.05.03 2 BED	TOTAL AREA 77 sq m	828.9 sq ft
Living Kitchen/Dining		
Master Bedroom	3.76 x 3.68m	12'4" x 12'1"
Bedroom 2	3.0 x 4.58m	9'10" x 15'0"
Bedroom 2	4.72 x 3.25m	15'6" x 10'8"
Bedroom 2	4.48 x 3.24m	14'8" x 10'7"
Internal Area	70 sq m	753.5 sq ft
Balcony	3.95 x 1.78m	13'0" x 5'10"
External Area	7 sq m	75.5 sq ft

3B.05.04 1 BED	TOTAL AREA 55.9 sq m	601.2 sq ft
Living Kitchen/Dining		
Bedroom	2.67 x 4.01m	8'9" x 13'2"
Bedroom	3.20 x 3.96m	10'6" x 13'0"
Bedroom	4.72 x 3.25m	15'6" x 10'8"
Internal Area	50.7 sq m	545.5 sq ft
Balcony	2.95 x 1.76m	9'8" x 5'9"
External Area	5.2 sq m	55.7 sq ft

3B.05.05 1 BED	TOTAL AREA 63.2 sq m	680.1 sq ft
Living Kitchen/Dining		
Bedroom	2.23 x 3.36m	7'4" x 11'0"
Bedroom	4.14 x 3.36m	13'7" x 11'0"
Bedroom	4.21 x 3.33m	13'10" x 10'11"
Internal Area	58.0 sq m	623.8 sq ft
Balcony	2.95 x 1.78m	9'8" x 5'10"
External Area	5.2 sq m	56.4 sq ft

3B.05.06 2 BED	TOTAL AREA 75.1 sq m	808.6 sq ft
Living Kitchen/Dining		
Master Bedroom	3.96 x 3.19m	13'0" x 10'5"
Bedroom 2	2.90 x 4.64m	9'6" x 15'3"
Bedroom 2	4.71 x 3.25m	15'5" x 10'8"
Bedroom 2	3.86 x 3.35m	12'8" x 11'0"
Internal Area	68.1 sq m	732.5 sq ft
Balcony	1.79 x 3.95m	5'10" x 13'0"
External Area	7.1 sq m	76.1 sq ft

3B.05.07 2 BED	TOTAL AREA 88 sq m	946.7 sq ft
Living Kitchen/Dining		
Master Bedroom	4.40 x 3.50m	14'5" x 11'6"
Bedroom 2	3.77 x 3.80m	12'4" x 12'6"
Bedroom 2	5.19 x 2.75m	17'0" x 9'0"
Bedroom 2	3.58 x 3.80m	11'9" x 12'6"
Internal Area	80.8 sq m	869.7 sq ft
Balcony	1.80 x 3.98m	5'11" x 13'0"
External Area	7.2 sq m	77 sq ft



LEVEL 05



SITE MAP

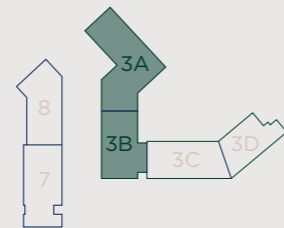

THE ARRIVAL LEVEL 06



3A.06.01 1 BED	TOTAL AREA 71.6 sq m	770.7 sq ft
Kitchen /Living/Dining 20'1" x 13'9"		
Master Bedroom 21'0" x 11'2"		
Internal Area	65.9 sq m	709.3 sq ft
Balcony	3.80 x 1.50m	12'6" x 4'11"
External Area	5.70 sq m	61.4 sq ft

3A.06.02 2 BED	TOTAL AREA 79.8 sq m	858.8 sq ft
Kitchen/Dining 12'4" x 11'11"		
Living 3.51 x 3.63m 11'6" x 11'11"		
Master Bedroom 3.82 x 3.33m 12'6" x 10'11"		
Bedroom 2 3.82 x 3.25m 12'6" x 10'8"		
Internal Area	72.7 sq m	782.6 sq ft
Balcony	3.95 x 1.79m	12'12" x 5'10"
External Area	7.07 sq m	76.1 sq ft

3A.06.03 1 BED	TOTAL AREA 59.8 sq m	643.5 sq ft
Kitchen/Dining 3.10 x 4.28m 10'2" x 14'1"		
Living 3.88 x 3.49m 12'9" x 11'5"		
Master Bedroom 3.71 x 3.24m 12'2" x 10'7"		
Internal Area	53.5 sq m	575.7 sq ft
Balcony	1.68 x 3.75m	5'6" x 12'4"
External Area	6.30 sq m	67.8 sq ft

3A.06.04 1 BED	TOTAL AREA 57.6 sq m	619.5 sq ft
Living/Dining 4.97 x 4.93m 16'4" x 16'2"		
Kitchen 3.86 x 2.37m 12'8" x 7'9"		
Master Bedroom 4.22 x 3.04m 13'10" x 10'0"		
Internal Area	51.4 sq m	553.3 sq ft
Balcony	3.80 x 1.62m	12'6" x 5'4"
External Area	6.16 sq m	66.3 sq ft

3B.06.01 1 BED	TOTAL AREA 61.8 sq m	665.6 sq ft
Living 2.97 x 4.23m 9'9" x 13'10"		
Kitchen/Dining 4.01 x 3.93m 13'2" x 12'11"		
Bedroom 3.10 x 4.05m 10'2" x 13'4"		
Internal Area	52.4 sq m	564.5 sq ft
Balcony	6.26 x 1.50m	20'7" x 4'11"
External Area	9.4 sq m	101.1 sq ft

3B.06.02 2 BED	TOTAL AREA 89.3 sq m	961.2 sq ft
Living 3.74 x 4.98m 12'3" x 16'4"		
Kitchen/Dining 3.42 x 3.48m 11'3" x 11'5"		
Master Bedroom 2.75 x 4.76m 9'0" x 15'7"		
Bedroom 2 2.75 x 4.75m 9'0" x 15'7"		
Internal Area	75 sq m	807.3 sq ft
Balcony	9.53 x 1.50m	31'3" x 4'11"
External Area	14.3 sq m	153.9 sq ft

3B.06.03 2 BED	TOTAL AREA 77 sq m	828.9 sq ft
Living 3.76 x 3.68m 12'4" x 12'1"		
Kitchen/Dining 3.0 x 4.58m 9'10" x 15'0"		
Master Bedroom 4.72 x 3.25m 15'6" x 10'8"		
Bedroom 2 4.48 x 3.24m 14'8" x 10'7"		
Internal Area	70 sq m	753.5 sq ft
Balcony	3.95 x 1.78m	13'0" x 5'10"
External Area	7 sq m	75.5 sq ft

3B.06.04 1 BED	TOTAL AREA 55.9 sq m	601.2 sq ft
Living 2.67 x 4.01m 8'9" x 13'2"		
Kitchen/Dining 3.20 x 3.96m 10'6" x 13'0"		
Bedroom 4.72 x 3.25m 15'6" x 10'8"		
Internal Area	50.7 sq m	545.5 sq ft
Balcony	2.95 x 1.76m	9'8" x 5'9"
External Area	5.2 sq m	55.7 sq ft

3B.06.05 1 BED	TOTAL AREA 63.2 sq m	680.1 sq ft
Living 2.23 x 3.36m 7'4" x 11'0"		
Kitchen/Dining 4.14 x 3.36m 13'7" x 11'0"		
Bedroom 4.21 x 3.33m 13'10" x 10'11"		
Internal Area	58.0 sq m	623.8 sq ft
Balcony	2.95 x 1.78m	9'8" x 5'10"
External Area	5.2 sq m	56.4 sq ft

3B.06.06 2 BED	TOTAL AREA 75.1 sq m	808.6 sq ft
Living 3.96 x 3.19m 13'0" x 10'5"		
Kitchen/Dining 2.90 x 4.64m 9'6" x 15'3"		
Master Bedroom 4.71 x 3.25m 15'5" x 10'8"		
Bedroom 2 3.86 x 3.35m 12'8" x 11'0"		
Internal Area	68.1 sq m	732.5 sq ft
Balcony	1.79 x 3.95m	5'10" x 13'0"
External Area	7.1 sq m	76.1 sq ft

3B.06.07 2 BED	TOTAL AREA 88 sq m	946.7 sq ft
Living 4.40 x 3.50m 14'5" x 11'6"		
Kitchen/Dining 3.77 x 3.80m 12'4" x 12'6"		
Master Bedroom 5.19 x 2.75m 17'0" x 9'0"		
Bedroom 2 3.58 x 3.80m 11'9" x 12'6"		
Internal Area	80.8 sq m	869.7 sq ft
Balcony	1.80 x 3.98m	5'11" x 13'0"
External Area	7.2 sq m	77 sq ft



LEVEL 06



SITE MAP

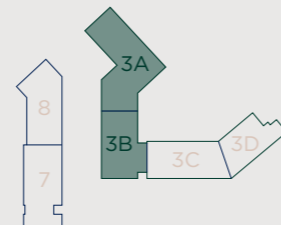

THE ARRIVAL **LEVEL 07**



3A.07.01 1 BED	TOTAL AREA 71.6 sq m	770.7 sq ft
Kitchen /Living/Dining 20'1" x 13'9"		
Master Bedroom 21'0" x 11'2"		
Internal Area	65.9 sq m	709.3 sq ft
Balcony	3.80 x 1.50m	12'6" x 4'11"
External Area	5.70 sq m	61.4 sq ft

3A.07.02 2 BED	TOTAL AREA 79.8 sq m	858.8 sq ft
Kitchen/Dining 12'4" x 11'11"		
Living 3.51 x 3.63m 11'6" x 11'11"		
Master Bedroom 3.82 x 3.33m 12'6" x 10'11"		
Bedroom 2 3.82 x 3.25m 12'6" x 10'8"		
Internal Area	72.7 sq m	782.6 sq ft
Balcony	3.95 x 1.79m	12'12" x 5'10"
External Area	7.07 sq m	76.1 sq ft

3A.07.03 1 BED	TOTAL AREA 59.8 sq m	643.5 sq ft
Kitchen/Dining 3.10 x 4.28m 10'2" x 14'1"		
Living 3.88 x 3.49m 12'9" x 11'5"		
Master Bedroom 3.71 x 3.24m 12'2" x 10'7"		
Internal Area	53.5 sq m	575.7 sq ft
Balcony	1.68 x 3.75m	5'6" x 12'4"
External Area	6.30 sq m	67.8 sq ft

3A.07.04 1 BED	TOTAL AREA 57.6 sq m	619.5 sq ft
Living/Dining 4.97 x 4.93m 16'4" x 16'2"		
Kitchen 3.86 x 2.37m 12'8" x 7'9"		
Master Bedroom 4.22 x 3.04m 13'10" x 10'0"		
Internal Area	51.4 sq m	553.3 sq ft
Balcony	3.80 x 1.62m	12'6" x 5'4"
External Area	6.16 sq m	66.3 sq ft

3B.07.01 1 BED	TOTAL AREA 61.8 sq m	665.6 sq ft
Living 2.97 x 4.23m 9'9" x 13'10"		
Kitchen/Dining 4.01 x 3.93m 13'2" x 12'11"		
Bedroom 3.10 x 4.05m 10'2" x 13'4"		
Internal Area	52.4 sq m	564.5 sq ft
Balcony	6.26 x 1.50m	20'7" x 4'11"
External Area	9.4 sq m	101.1 sq ft

3B.07.02 2 BED	TOTAL AREA 89.3 sq m	961.2 sq ft
Living 3.74 x 4.98m 12'3" x 16'4"		
Kitchen/Dining 3.42 x 3.48m 11'3" x 11'5"		
Master Bedroom 2.75 x 4.76m 9'0" x 15'7"		
Bedroom 2 2.75 x 4.75m 9'0" x 15'7"		
Internal Area	75 sq m	807.3 sq ft
Balcony	9.53 x 1.50m	31'3" x 4'11"
External Area	14.3 sq m	153.9 sq ft

3B.07.03 2 BED	TOTAL AREA 77 sq m	828.9 sq ft
Living 3.76 x 3.68m 12'4" x 12'1"		
Kitchen/Dining 3.0 x 4.58m 9'10" x 15'0"		
Master Bedroom 4.72 x 3.25m 15'6" x 10'8"		
Bedroom 2 4.48 x 3.24m 14'8" x 10'7"		
Internal Area	70 sq m	753.5 sq ft
Balcony	3.95 x 1.78m	13'0" x 5'10"
External Area	7 sq m	75.5 sq ft

3B.07.04 1 BED	TOTAL AREA 55.9 sq m	601.2 sq ft
Living 2.67 x 4.01m 8'9" x 13'2"		
Kitchen/Dining 3.20 x 3.96m 10'6" x 13'0"		
Bedroom 4.72 x 3.25m 15'6" x 10'8"		
Internal Area	50.7 sq m	545.5 sq ft
Balcony	2.95 x 1.76m	9'8" x 5'9"
External Area	5.2 sq m	55.7 sq ft

3B.07.05 1 BED	TOTAL AREA 63.2 sq m	680.1 sq ft
Living/Dining 2.23 x 3.36m 7'4" x 11'0"		
Kitchen/Dining 4.14 x 3.36m 13'7" x 11'0"		
Bedroom 4.21 x 3.33m 13'10" x 10'11"		
Internal Area	58.0 sq m	623.8 sq ft
Balcony	2.95 x 1.78m	9'8" x 5'10"
External Area	5.2 sq m	56.4 sq ft

3B.07.06 2 BED	TOTAL AREA 75.1 sq m	808.6 sq ft
Living 3.96 x 3.19m 13'0" x 10'5"		
Kitchen/Dining 2.90 x 4.64m 9'6" x 15'3"		
Master Bedroom 4.71 x 3.25m 15'5" x 10'8"		
Bedroom 2 3.86 x 3.35m 12'8" x 11'0"		
Internal Area	68.1 sq m	732.5 sq ft
Balcony	1.79 x 3.95m	5'10" x 13'0"
External Area	7.1 sq m	76.1 sq ft

3B.07.07 2 BED	TOTAL AREA 88 sq m	946.7 sq ft
Living 4.40 x 3.50m 14'5" x 11'6"		
Kitchen/Dining 3.77 x 3.80m 12'4" x 12'6"		
Master Bedroom 5.19 x 2.75m 17'0" x 9'0"		
Bedroom 2 3.58 x 3.80m 11'9" x 12'6"		
Internal Area	80.8 sq m	869.7 sq ft
Balcony	1.80 x 3.98m	5'11" x 13'0"
External Area	7.2 sq m	77 sq ft

LEVEL 07



SITE MAP

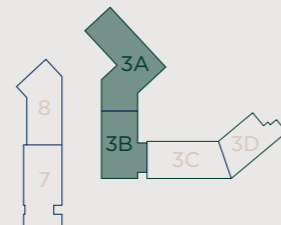

THE ARRIVAL LEVEL 08



3B.08.01 1 BED	TOTAL AREA	61.8 sq m	665.6 sq ft
	Living	2.97 x 4.23m	9'9" x 13'10"
	Kitchen/Dining	4.01 x 3.93m	13'2" x 12'11"
	Bedroom	3.10 x 4.05m	10'2" x 13'4"
	Internal Area	52.4 sq m	564.5 sq ft
	Balcony	6.26 x 1.50m	20'7" x 4'11"
	External Area	9.4 sq m	101.1 sq ft

3B.08.05 1 BED	TOTAL AREA	63.2 sq m	680.1 sq ft
	Living	2.23 x 3.36m	7'4" x 11'0"
	Kitchen/Dining	4.14 x 3.36m	13'7" x 11'0"
	Bedroom	4.21 x 3.33m	13'10" x 10'11"
	Internal Area	58.0 sq m	623.8 sq ft
	Balcony	2.95 x 1.78m	9'8" x 5'10"
	External Area	5.2 sq m	56.4 sq ft

3B.08.02 2 BED	TOTAL AREA	89.3 sq m	961.2 sq ft
	Living	3.74 x 4.98m	12'3" x 16'4"
	Kitchen/Dining	3.42 x 3.48m	11'3" x 11'5"
	Master Bedroom	2.75 x 4.76m	9'0" x 15'7"
	Bedroom 2	2.75 x 4.75m	9'0" x 15'7"
	Internal Area	75 sq m	807.3 sq ft
	Balcony	9.53 x 1.50m	31'3" x 4'11"
	External Area	14.3 sq m	153.9 sq ft

3B.08.06 2 BED	TOTAL AREA	75.1 sq m	808.6 sq ft
	Living	3.96 x 3.19m	13'0" x 10'5"
	Kitchen/Dining	2.90 x 4.64m	9'6" x 15'3"
	Master Bedroom	4.71 x 3.25m	15'5" x 10'8"
	Bedroom 2	3.86 x 3.35m	12'8" x 11'0"
	Internal Area	68.1 sq m	732.5 sq ft
	Balcony	1.79 x 3.95m	5'10" x 13'0"
	External Area	7.1 sq m	76.1 sq ft

3B.08.03 2 BED	TOTAL AREA	77 sq m	828.9 sq ft
	Living	3.76 x 3.68m	12'4" x 12'1"
	Kitchen/Dining	3.0 x 4.58m	9'10" x 15'0"
	Master Bedroom	4.72 x 3.25m	15'6" x 10'8"
	Bedroom 2	4.48 x 3.24m	14'8" x 10'7"
	Internal Area	70 sq m	753.5 sq ft
	Balcony	3.95 x 1.78m	13'0" x 5'10"
	External Area	7 sq m	75.5 sq ft

3B.08.07 2 BED	TOTAL AREA	88 sq m	946.7 sq ft
	Living	4.40 x 3.50m	14'5" x 11'6"
	Kitchen/Dining	3.77 x 3.80m	12'4" x 12'6"
	Master Bedroom	5.19 x 2.75m	17'0" x 9'0"
	Bedroom 2	3.58 x 3.80m	11'9" x 12'6"
	Internal Area	80.8 sq m	869.7 sq ft
	Balcony	1.80 x 3.98m	5'11" x 13'0"
	External Area	7.2 sq m	77 sq ft

3B.08.04 1 BED	TOTAL AREA	55.9 sq m	601.2 sq ft
	Living	2.67 x 4.01m	8'9" x 13'2"
	Kitchen/Dining	3.20 x 3.96m	10'6" x 13'0"
	Bedroom	4.72 x 3.25m	15'6" x 10'8"
	Internal Area	50.7 sq m	545.5 sq ft
	Balcony	2.95 x 1.76m	9'8" x 5'9"
	External Area	5.2 sq m	55.7 sq ft

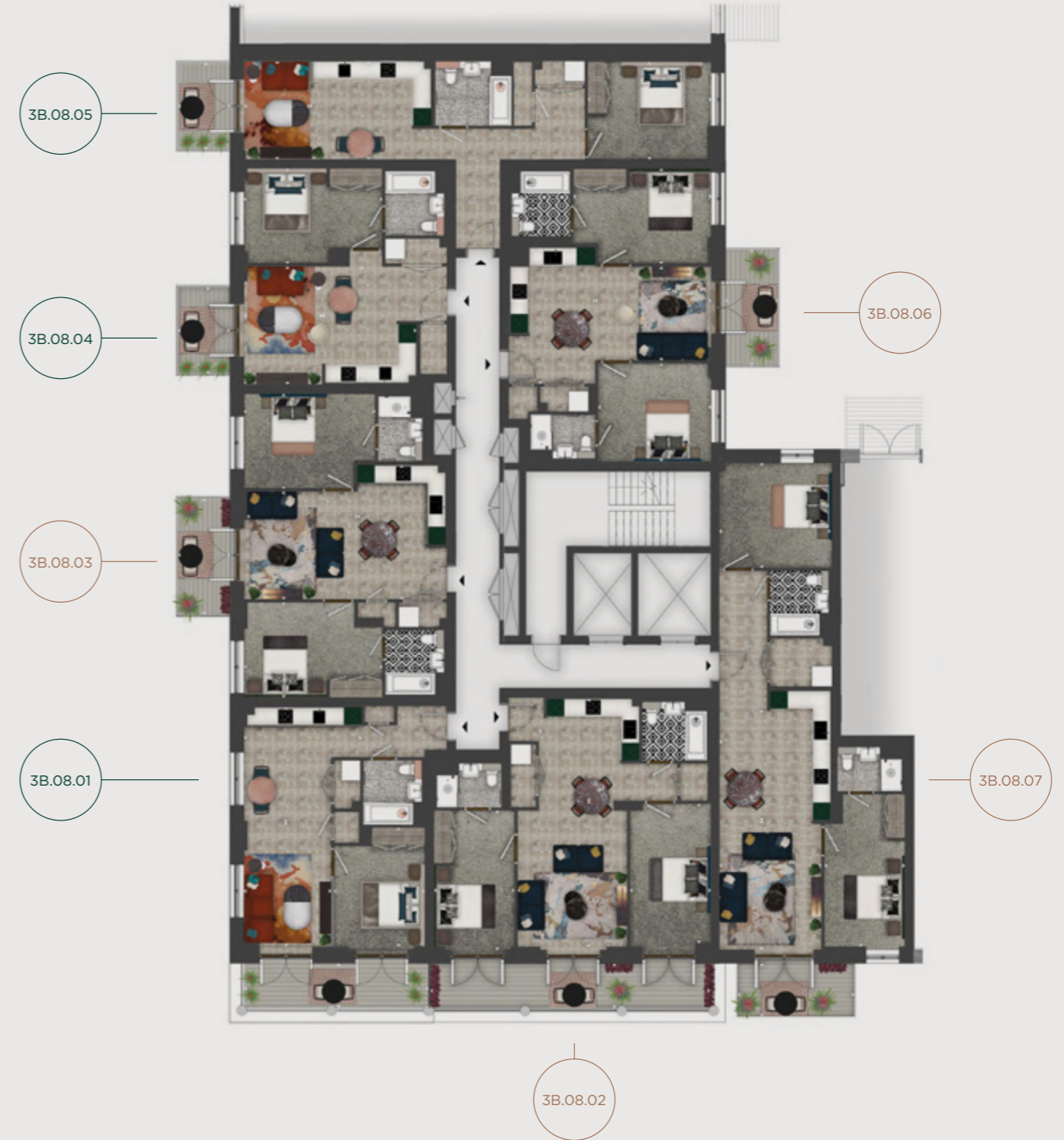

LEVEL 08



SITE MAP

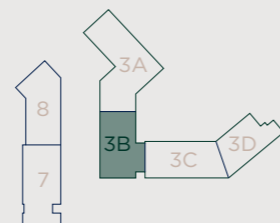

THE ARRIVAL LEVEL 09



3B.09.01 1 BED	TOTAL AREA	61.8 sq m	665.6 sq ft
	Living	2.97 × 4.23m	9'9" × 13'10"
	Kitchen/Dining	4.01 × 3.93m	13'2" × 12'11"
	Bedroom	3.10 × 4.05m	10'2" × 13'4"
	Internal Area	52.4 sq m	564.5 sq ft
	Balcony	6.26 × 1.50m	20'7" × 4'11"
	External Area	9.4 sq m	101.1 sq ft

3B.09.02 2 BED	TOTAL AREA	89.3 sq m	961.2 sq ft
	Living	3.74 × 4.98m	12'3" × 16'4"
	Kitchen/Dining	3.42 × 3.48m	11'3" × 11'5"
	Master Bedroom	2.75 × 4.76m	9'0" × 15'7"
	Bedroom 2	2.75 × 4.75m	9'0" × 15'7"
	Internal Area	75 sq m	807.3 sq ft
	Balcony	9.53 × 1.50m	31'3" × 4'11"
	External Area	14.3 sq m	153.9 sq ft

3B.09.03 2 BED	TOTAL AREA	77 sq m	828.9 sq ft
	Living	3.76 × 3.68m	12'4" × 12'1"
	Kitchen/Dining	3.0 × 4.58m	9'10" × 15'0"
	Master Bedroom	4.72 × 3.25m	15'6" × 10'8"
	Bedroom 2	4.48 × 3.24m	14'8" × 10'7"
	Internal Area	70 sq m	753.5 sq ft
	Balcony	3.95 × 1.78m	13'0" × 5'10"
	External Area	7 sq m	75.5 sq ft

3B.09.04 2 BED	TOTAL AREA	91.8 sq m	988 sq ft
	Living	3.12 × 4.81m	10'3" × 15'9"
	Kitchen/Dining	3.27 × 4.15m	10'9" × 13'7"
	Master Bedroom	3.26 × 4.27m	10'8" × 14'0"
	Bedroom 2	2.75 × 4.71m	9'0" × 15'5"
	Internal Area	77.3 sq m	832.1 sq ft
	Terrace	9.53 × 1.52m	31'3" × 5'0"
	External Area	14.5 sq m	155.9 sq ft

3B.09.05 2 BED	TOTAL AREA	85.8 sq m	923.1 sq ft
	Living	3.99 × 4.34m	13'1" × 14'3"
	Kitchen/Dining	3.90 × 1.91m	12'10" × 6'3"
	Master Bedroom	3.80 × 3.85m	12'6" × 12'8"
	Bedroom 2	3.64 × 3.14m	11'11" × 10'4"
	Internal Area	76.4 sq m	821.8 sq ft
	Terrace	1.50 × 6.27m	4'11" × 20'7"
	External Area	9.4 sq m	101.2 sq ft

3B.09.04

3B.09.03

3B.09.01

3B.09.05

3B.09.02



LEVEL 09



SITE MAP

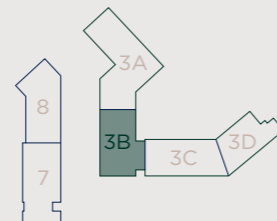

THE ARRIVAL **LEVEL 10**



3B.10.01 1 BED	TOTAL AREA	61.8 sq m	665.6 sq ft
Living	2.97 × 4.23m	9'9" × 13'10"	
Kitchen/Dining	4.01 × 3.93m	13'2" × 12'11"	
Bedroom	3.10 × 4.05m	10'2" × 13'4"	
Internal Area	52.4 sq m	564.5 sq ft	
Balcony	6.26 × 1.50m	20'7" × 4'11"	
External Area	9.4 sq m	101.1 sq ft	

3B.10.04 2 BED	TOTAL AREA	91.8 sq m	988 sq ft
Living	3.12 × 4.81m	10'3" × 15'9"	
Kitchen/Dining	3.27 × 4.15m	10'9" × 13'7"	
Master Bedroom	3.26 × 4.27m	10'8" × 14'0"	
Bedroom 2	2.75 × 4.71m	9'0" × 15'5"	
Internal Area	77.3 sq m	832.1 sq ft	
Terrace	9.53 × 1.52m	31'3" × 5'0"	
External Area	14.5 sq m	155.9 sq ft	

3B.10.02 2 BED	TOTAL AREA	89.3 sq m	961.2 sq ft
Living	3.74 × 4.98m	12'3" × 16'4"	
Kitchen/Dining	3.42 × 3.48m	11'3" × 11'5"	
Master Bedroom	2.75 × 4.76m	9'0" × 15'7"	
Bedroom 2	2.75 × 4.75m	9'0" × 15'7"	
Internal Area	75 sq m	807.3 sq ft	
Balcony	9.53 × 1.50m	31'3" × 4'11"	
External Area	14.3 sq m	153.9 sq ft	

3B.10.05 2 BED	TOTAL AREA	85.8 sq m	923.1 sq ft
Living	3.99 × 4.34m	13'1" × 14'3"	
Kitchen/Dining	3.90 × 1.91m	12'10" × 6'3"	
Master Bedroom	3.80 × 3.85m	12'6" × 12'8"	
Bedroom 2	3.64 × 3.14m	11'11" × 10'4"	
Internal Area	76.4 sq m	821.8 sq ft	
Terrace	1.50 × 6.27m	4'11" × 20'7"	
External Area	9.4 sq m	101.2 sq ft	

3B.10.03 2 BED	TOTAL AREA	77 sq m	828.9 sq ft
Living	3.76 × 3.68m	12'4" × 12'1"	
Kitchen/Dining	3.0 × 4.58m	9'10" × 15'0"	
Master Bedroom	4.72 × 3.25m	15'6" × 10'8"	
Bedroom 2	4.48 × 3.24m	14'8" × 10'7"	
Internal Area	70 sq m	753.5 sq ft	
Balcony	3.95 × 1.78m	13'0" × 5'10"	
External Area	7 sq m	75.5 sq ft	



LEVEL 10

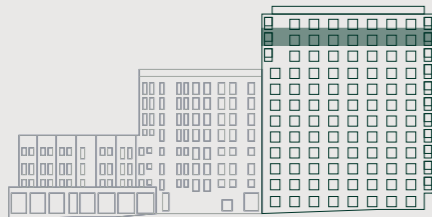

SITE MAP

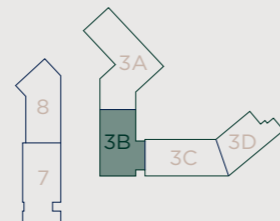

THE ARRIVAL LEVEL 11



3B.11.01 1 BED	TOTAL AREA	61.8 sq m	665.6 sq ft
	Living	2.97 × 4.23m	9'9" × 13'10"
	Kitchen/Dining	4.01 × 3.93m	13'2" × 12'11"
	Bedroom	3.10 × 4.05m	10'2" × 13'4"
	Internal Area	52.4 sq m	564.5 sq ft
	Balcony	6.26 × 1.50m	20'7" × 4'11"
	External Area	9.4 sq m	101.1 sq ft

3B.11.02 2 BED	TOTAL AREA	89.3 sq m	961.2 sq ft
	Living	3.74 × 4.98m	12'3" × 16'4"
	Kitchen/Dining	3.42 × 3.48m	11'3" × 11'5"
	Master Bedroom	2.75 × 4.76m	9'0" × 15'7"
	Bedroom 2	2.75 × 4.75m	9'0" × 15'7"
	Internal Area	75 sq m	807.3 sq ft
	Balcony	9.53 × 1.50m	31'3" × 4'11"
	External Area	14.3 sq m	153.9 sq ft

3B.11.03 2 BED	TOTAL AREA	77 sq m	828.9 sq ft
	Living	3.76 × 3.68m	12'4" × 12'1"
	Kitchen/Dining	3.0 × 4.58m	9'10" × 15'0"
	Master Bedroom	4.72 × 3.25m	15'6" × 10'8"
	Bedroom 2	4.48 × 3.24m	14'8" × 10'7"
	Internal Area	70 sq m	753.5 sq ft
	Balcony	3.95 × 1.78m	13'0" × 5'10"
	External Area	7 sq m	75.5 sq ft

3B.11.04 2 BED	TOTAL AREA	91.8 sq m	988 sq ft
	Living	3.12 × 4.81m	10'3" × 15'9"
	Kitchen/Dining	3.27 × 4.15m	10'9" × 13'7"
	Master Bedroom	3.26 × 4.27m	10'8" × 14'0"
	Bedroom 2	2.75 × 4.71m	9'0" × 15'5"
	Internal Area	77.3 sq m	832.1 sq ft
	Terrace	9.53 × 1.52m	31'3" × 5'0"
	External Area	14.5 sq m	155.9 sq ft

3B.11.05 2 BED	TOTAL AREA	85.8 sq m	923.1 sq ft
	Living	3.99 × 4.34m	13'1" × 14'3"
	Kitchen/Dining	3.90 × 1.91m	12'10" × 6'3"
	Master Bedroom	3.80 × 3.85m	12'6" × 12'8"
	Bedroom 2	3.64 × 3.14m	11'11" × 10'4"
	Internal Area	76.4 sq m	821.8 sq ft
	Terrace	1.50 × 6.27m	4'11" × 20'7"
	External Area	9.4 sq m	101.2 sq ft



LEVEL 11



SITE MAP

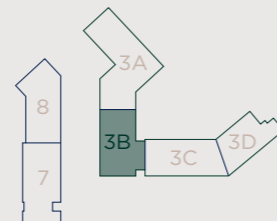

**PURSuing
BETTER,
DIFFERENTLY**

LONDON SPECIALISTS

We've spent over 30 years focused on London, creating outstanding places where people can thrive. Focus means we can commit, we can do that bit extra, so we can spend more time designing, refining and delivering homes people love, in places they want to live.

POSITIVE PARTNERSHIPS



Our business is based on repeat partnerships that put person, place and planet first. By jointly working with our partners, we can amplify the positive impact of the places and homes we co-create, delivering a healthy, low carbon and prosperous future for London.

OUR TEAM

90% of our people are also shareholders in our business, so there's more pride poured into every project. And with our Project Directors having, on average, more than 25 years' experience each, your home is in safe, reassuring hands.

CRAFTED NOT COOKIE CUTTER

No two Mount Anvil developments are the same. Yes, you'll see Mount Anvil hallmarks such as clean, uncluttered elevations, vibrant public realm, and mechanical equipment hidden in the basement rather than on the roof. However, each of our developments are individualised, to fit the community they're in.

CUSTOMER FOCUS

At Mount Anvil, we're committed to making your home buying experience as effortless as possible. Your personal Customer Experience Manager will be there to answer anything and everything you ask about your new home. This focus on customer satisfaction is why 97% of our customers would recommend us to family and friends.

AWARD WINNING

The ultimate accolades for us are happy customers, who want to keep coming back to Mount Anvil. But we aren't averse to the industry celebrating us either. We have won awards for our design, culture, partnerships, health and safety, customer care and sustainability.

A COLLABORATION BETWEEN MOUNT ANVIL AND PEABODY

With Peabody's rich heritage and Mount Anvil's reputation for unparalleled taste and workmanship, One Clapham is set to become a remarkable testament to their collaboration.

THREE WATERS, BOW CREEK E3

MOUNT ANVIL AND PEABODY'S AWARD-WINNING PARTNERSHIP



Peabody creates great places where people want to live, adding value by upholding high design standards, building sustainable, high-quality new homes that stand the test of time and making a positive difference through ongoing commitment to our communities.

BUILDING HISTORY

Formed over 160 years ago by the American financier and philanthropist George Peabody, Peabody is one of the UK's oldest and largest housing associations. Together with Catalyst Housing who joined the Group in 2022, we are responsible for more than 104,000 homes across London and the Home Counties.

STRONG GROWTH

With a growing pipeline, Peabody continues to invest in building quality new homes with high design standards. We create homes in great locations which are safe, easy to maintain and long-lasting. Peabody delivers long-term returns on investment. With an asset base of £8.3bn, Peabody is well placed to build thousands more top quality, well-maintained homes each year.

QUALITY DESIGN & SUSTAINABILITY

Peabody's reputation is one of the most respected in the housing industry, renowned for high quality, innovative design. We work with industry experts and continually monitor quality throughout the design, procurement and development process. We aim to make a positive impact on climate change for our residents, communities and the environment, with an ambition to achieve net zero carbon in our new and existing homes by 2050.

CUSTOMER FOCUS

Over 90% of customers said they would recommend Peabody. Our customers' feedback helps shape the design of our homes and community services based on the needs of each neighbourhood. We value our customers and listen to what they have to tell us. Peabody is proud to have achieved 'Gold' in the independent customer satisfaction awards three years in a row.

SOCIAL IMPACT

In line with our social purpose, Peabody re-invests its surplus to provide more homes and services. We deliver services to 220,000 residents, supporting customers and the wider communities in which we work. We focus on those who need our help the most, working with people and communities to build resilience and promote wellbeing. We invest around £11m each year through our Community Foundation, to support people to be healthier, wealthier and happier.

AWARD WINNING

In recent years, Peabody has been recognised and awarded more than 60 prestigious awards, including the Sunday Times 'Home builder of the Year' and the Grand Prix award at the Evening Standard New Homes Awards. We also work with award winning partners who share our values, high design standards and focus on great customer experience.



The information in this document is indicative and is intended to act as a guide only as to the finished product. The finished product may vary from the information provided. These particulars should not be relied upon as statements of fact or representations and applicants must satisfy themselves by inspection or otherwise as to their correctness. This information does not constitute a contract or warranty. The dimensions given on plans may vary within a tolerance of 5% and are not intended to be used for carpet sizes, appliance sizes or items of furniture. All furniture shown is indicative only, all planting on balconies and terraces are shown for decorative purposes and do not form part of the specification. All kitchen layouts are indicative only and subject to change.

One Clapham is a marketing name and will not necessarily form part of the approved postal address. Applicants are advised to contact Mount Anvil and Peabody to ascertain the availability of any particular property. Your attention is drawn to the fact that in rare circumstances it may not be possible to obtain the exact products or materials referred to in the specification. Mount Anvil and Peabody reserve the right to alter, amend or update the specification, which may include changes in the colour, material or brand specified. In such cases, a similar alternative will be provided.

Mount Anvil and Peabody reserve the right (whether through the planning process or otherwise) to increase the height and/or elevation and/or massing or otherwise (including accommodation) of any block in the development. You'll be regarded, when making a reservation, as being aware and accepting this. This means you'll be expected to accept any consequential change in outlook or amenity because of such changes. Computer-generated images and photography are indicative only and subject to change. Travel times are approximate and calculated via Google.

A destination by



Mount Anvil,
better London living



A destination by

 **Mount Anvil,**
better London living

 **Peabody**