

# For sale or lease

## Auto dealership and service center

Sale price: \$5,100,000 (\$129 PSF)

Lease rate: varies, see below

6250 Florin Road  
Sacramento, CA 95823

- Total building area: ±39,641 SF (5 buildings)
- Total available building SF: ±18,289
  - office, auto repair and storage
- Total site size: ±4.11 acres with ±2.7 acres available for occupancy
- Available building breakdown:
  - **Building 2: \$12,000 per month + NNN**  
±4,499 SF shop/storage
  - **Buildings 3: \$8,900 per month + NNN**  
±9,210 SF shop
  - **Building 4: \$6,500 per month + NNN**  
±4,580 SF shop & yard area
- Excellent visibility to Florin Road
- Curb Cuts: Florin Road (2) and Fawn Way (1)
- Located across from Florin Towne Centre, a ±45 acre, ±600,000 SF shopping center anchored by: Wal-Mart Supercenter, Falling Prices, Chuze Fitness, and Petsmart; also includes Panda Express, Starbucks and McDonald's among other national tenants.
- Zoned: AC, Auto Commercial (per Sacramento County)
- Traffic Counts: Florin Rd & Fawn Way: 32,807 cars per day (*source ESRI*)



# Site plan



--- = Shared access for H2 Autobody

★ = Monument Sign

•••• = Wash bay (1/2 available for shared use)

== = Yard area for Building 4



SITE PLAN NOT TO SCALE



Floor plans

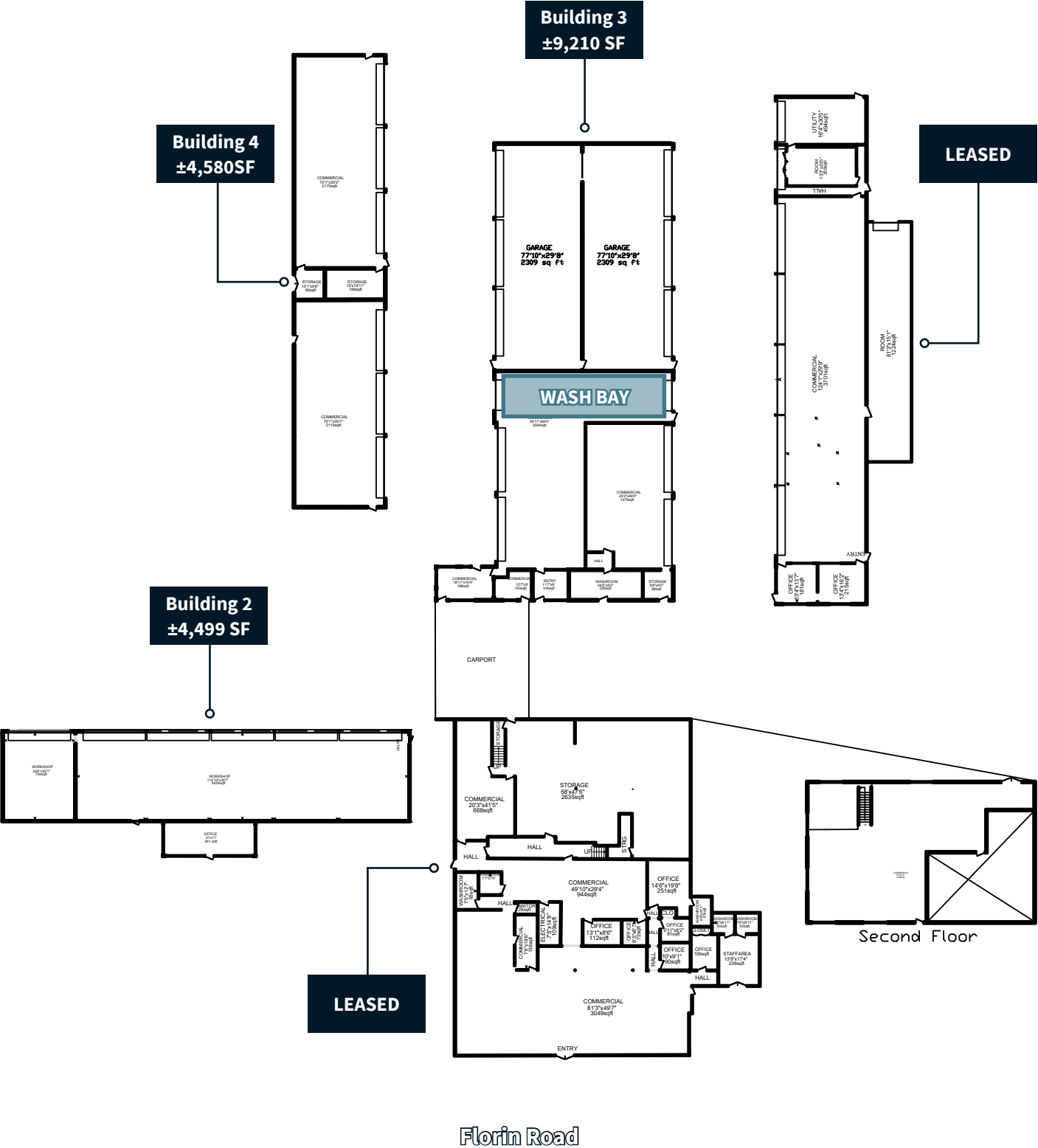

FLOOR PLANS NOT TO SCALE.  
ALL MEASUREMENTS ARE APPROXIMATE.

Vicinity neighbors

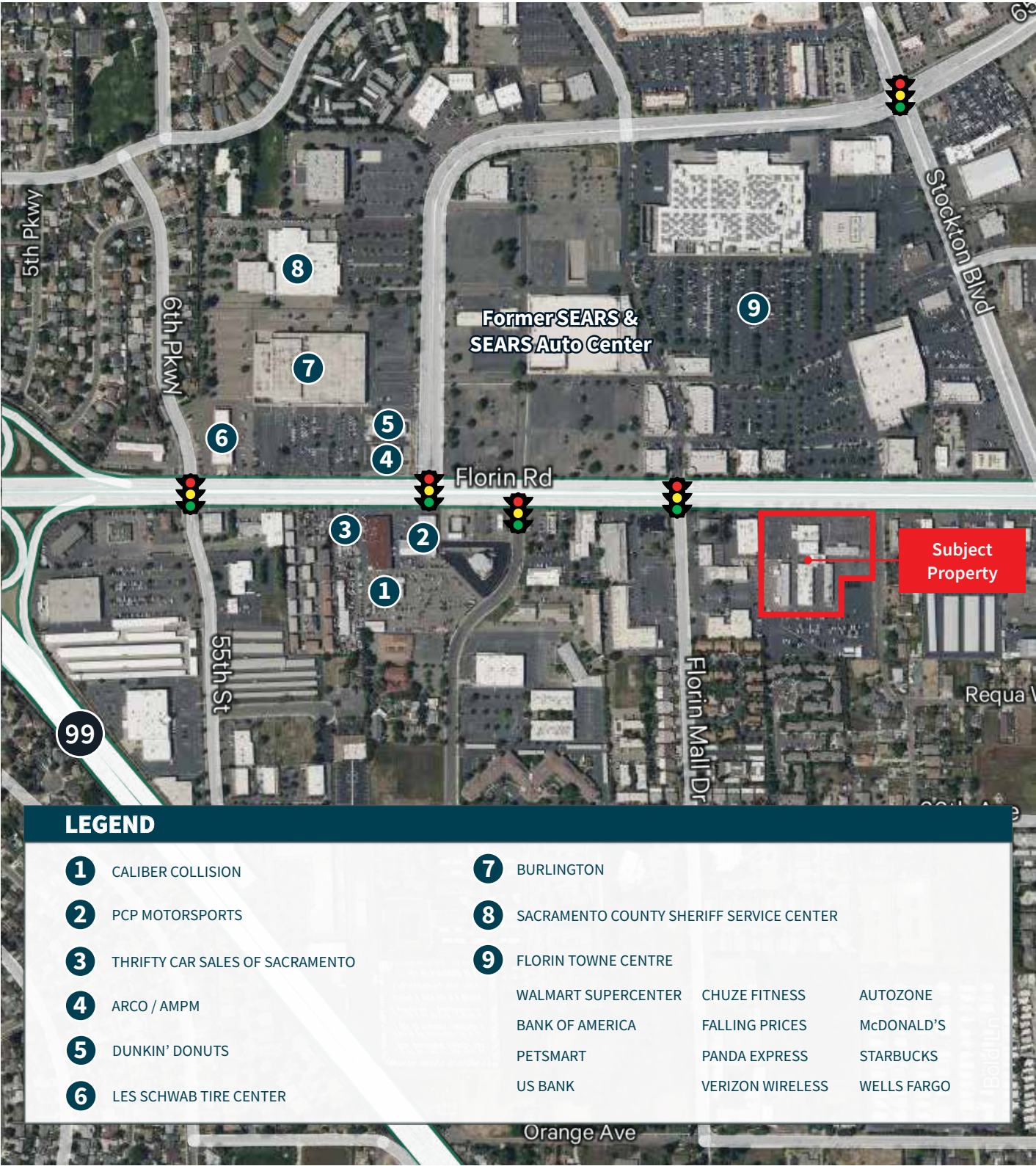

## Location maps

### Street map

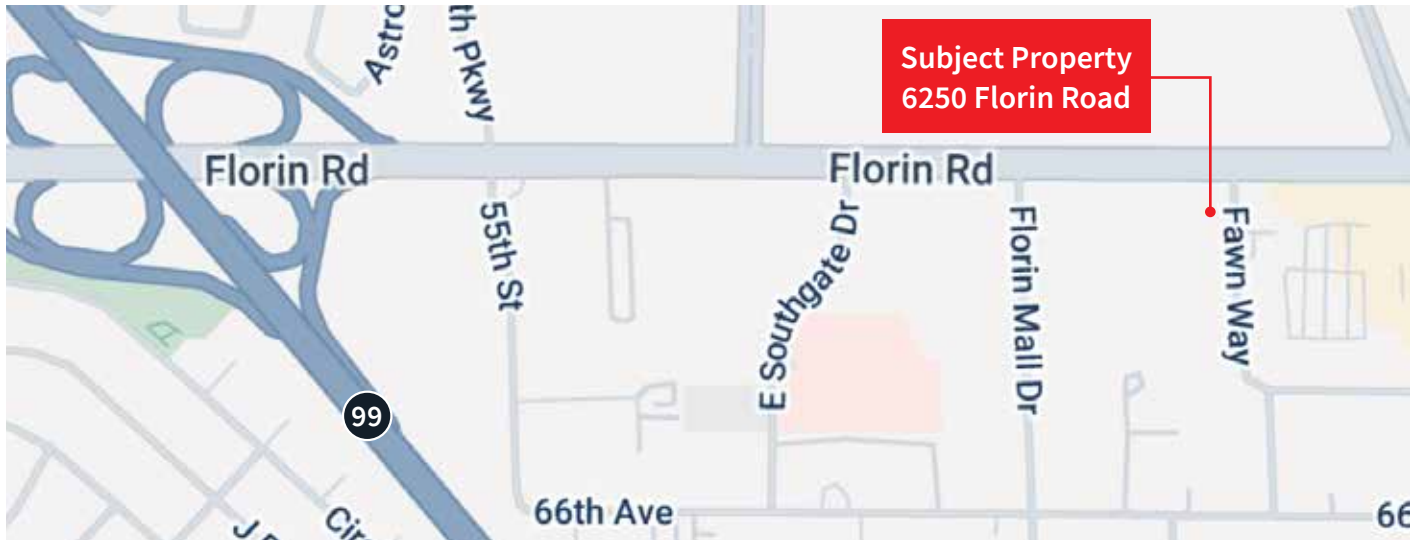

### Regional map

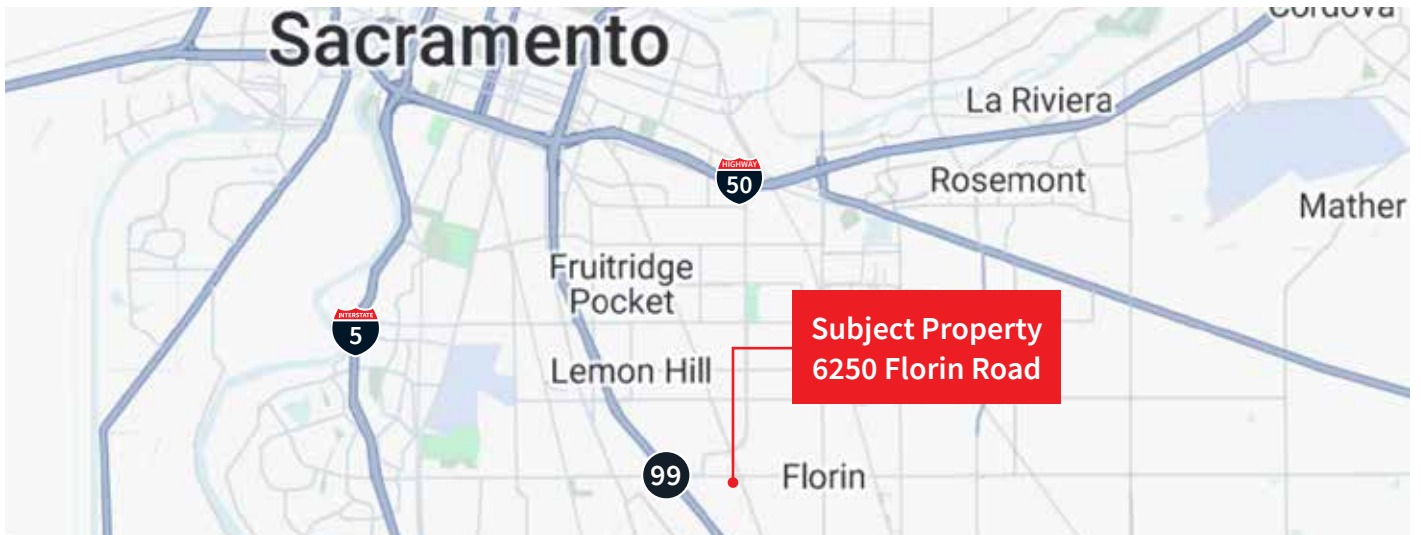

### JLL Automotive Dealership Properties

#### Mike Luca, SIOR

Senior Managing Director

[Mike.Luca@jll.com](mailto:Mike.Luca@jll.com)

+1 916 214 0466

RE Lic. 01447904

#### Dominic Smith

Senior Associate

[Dominic.Smith@jll.com](mailto:Dominic.Smith@jll.com)

+1 916 995 9396

RE Lic. 02106714

#### RJ Jimenez

Associate

[RJ.Jimenez@jll.com](mailto:RJ.Jimenez@jll.com)

+1 940 597 9341

RE Lic. 02248675

Jones Lang LaSalle

Brokerage, Inc.

CA Real Estate License #01856260

Although information has been obtained from sources deemed reliable, JLL does not make any guarantees, warranties or representations, express or implied, as to the completeness or accuracy as to the information contained herein. Any projections, opinions, assumptions or estimates used are for example only. There may be differences between projected and actual results, and those differences may be material. JLL does not accept any liability for any loss or damage suffered by any party resulting from reliance on this information. If the recipient of this information has signed a confidentiality agreement with JLL regarding this matter, this information is subject to the terms of that agreement. ©2025. Jones Lang LaSalle Brokerage, Inc. All rights reserved. JMYERS @LISTINGS\Florin Road\_6250\@Marketing\Brochure