



23045 N. 15th Avenue | Phoenix, AZ 85027

FEATURES

- Rare opportunity to occupy 53,885 SF of Industrial space in the coveted Deer Valley submarket of Phoenix situated on 2.72 acres
- **Office:** 11,600 SF built-out office space can be expanded or reduced to fit tenant requirements
 - 1st Floor: ~6,000 SF & 2nd Floor: ~6,000 SF unfinished
- **Clear height:** 21' - 25'6"
- **Loading:** 7 grade level doors, 2 dock high doors
- New HVAC units installed over the office area
- New evaporative coolers installed over the warehouse area
- **Power:** 2000 Amps, 277/480 V
- Recently re-paved/secure/block wall yard
- **Roof:** Recently re-surfaced
- Evap cooled warehouse
- **Parking stalls:** 47
- **Zoning:** CP/GCP
- 1.4 miles to the Pinnacle Peak Road / I-17 Interchange and 2.3 miles to the Loop 101 via 19th Avenue

REA WEBSITE



[Click or Scan](#)

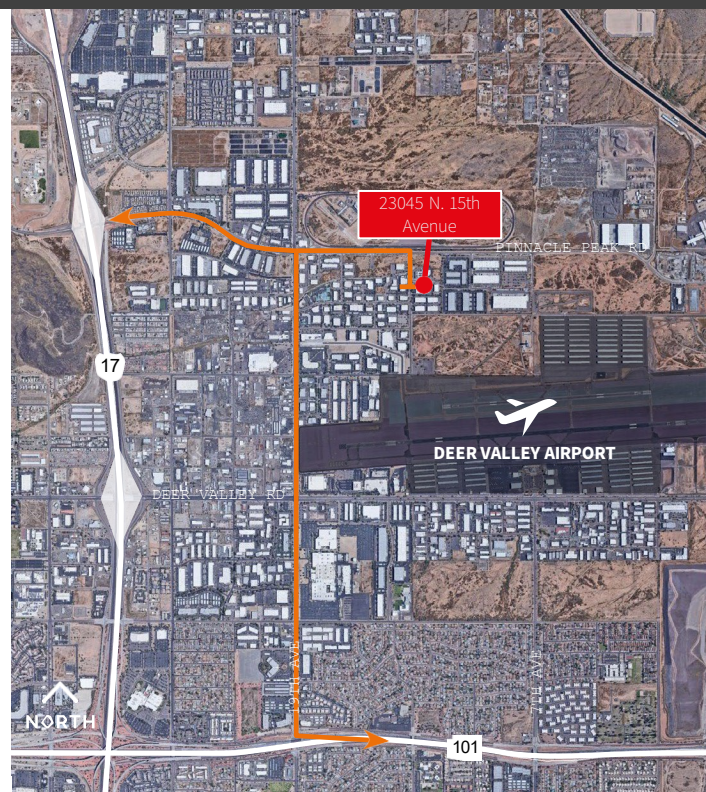

FLOOR PLAN

11,600 SF Office can be expanded or reduced to fit tenant requirements

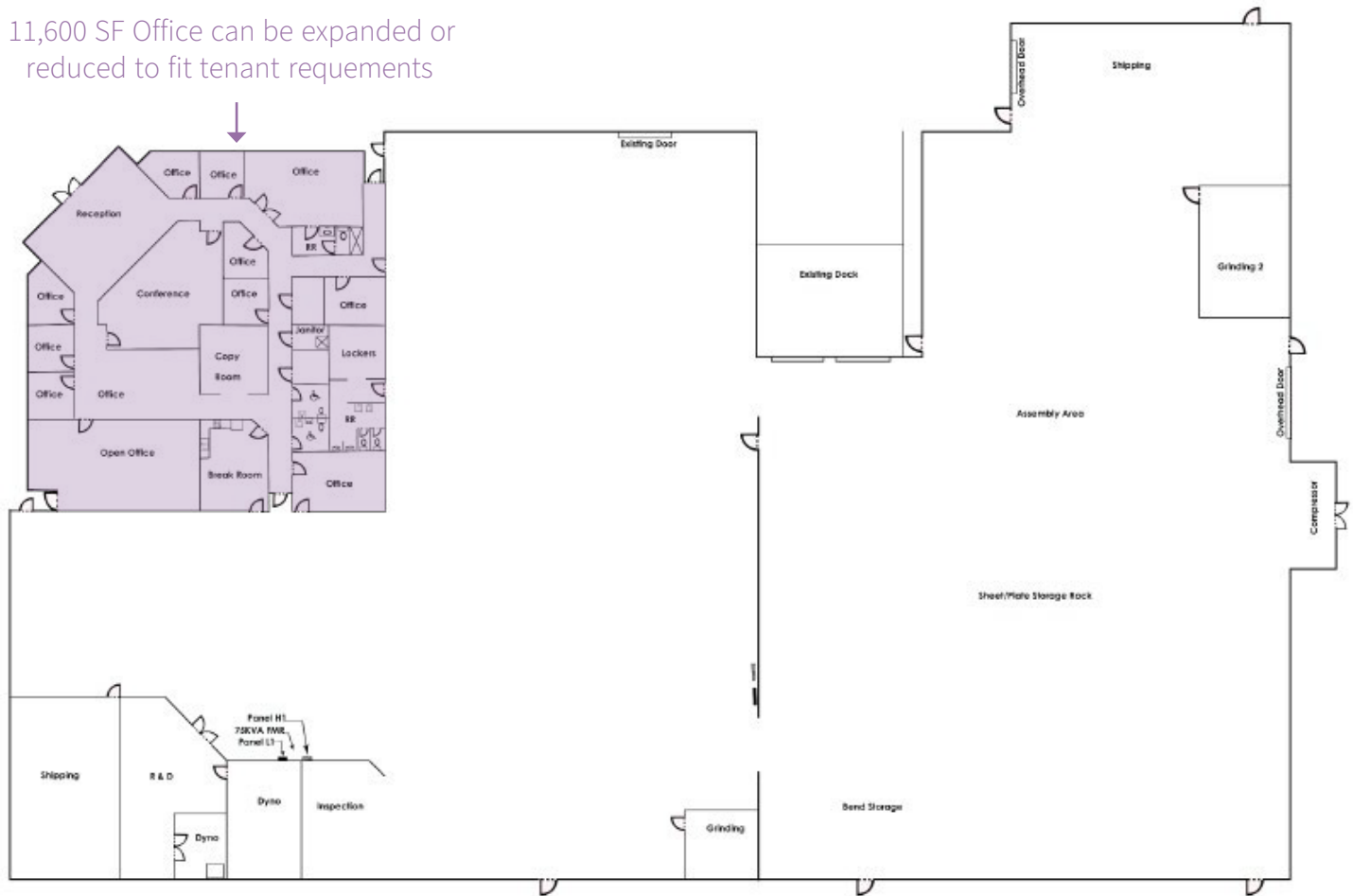

For more information:

Steve Sayre
Sr. Managing Director
602 999 7720
steve.sayre@jll.com



Although information has been obtained from sources deemed reliable, neither Owner nor JLL makes any guarantees, warranties or representations, express or implied, as to the completeness or accuracy as to the information contained herein. Any projections, opinions, assumptions or estimates used are for example only. There may be differences between projected and actual results, and those differences may be material. The Property may be withdrawn without notice. Neither Owner nor JLL accepts any liability for any loss or damage suffered by any party resulting from reliance on this information. If the recipient of this information has signed a confidentiality agreement regarding this matter, this information is subject to the terms of that agreement. ©2022 Jones Lang LaSalle IP, Inc. All rights reserved.