



2,646 SF  
Available for lease

# Creekside Court I & II

5201-5227 West 73rd St  
7320-7350 Ohms Lane  
Edina, MN 55439



## Contact

### **Connor Ott**

Vice President  
+1 612 217 6741  
connor.ott@jll.com

### **Will McArdle**

Associate  
+1 612 217 6798  
william.mcardle@jll.com



# Creekside Court I & II

5201-5227 West 73rd St | 7320-7350 Ohms Lane | Edina, MN 55439

## 2,646 SF Available

Conveniently located near I-494, I-35W, Hwy 100, Hwy 169, MSP-International Airport, and Mall of America



### Building features



14' Clear Height



82,272 Total SF



Built in 1978



Base Rent:  
Negotiable



2023 Tax & CAM:  
\$5.73 / SF



Spacious truck  
loading area

Suite 5203	
Office:	894 SF
Whse:	1,752 SF
Total:	2,646 SF

- 1 dock door
- Shared restrooms

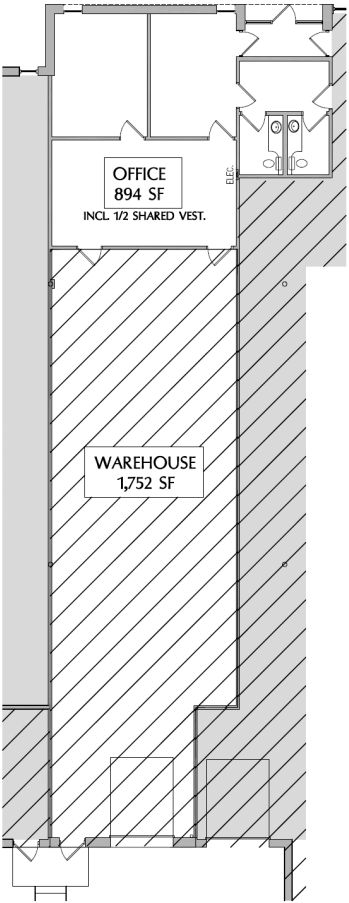



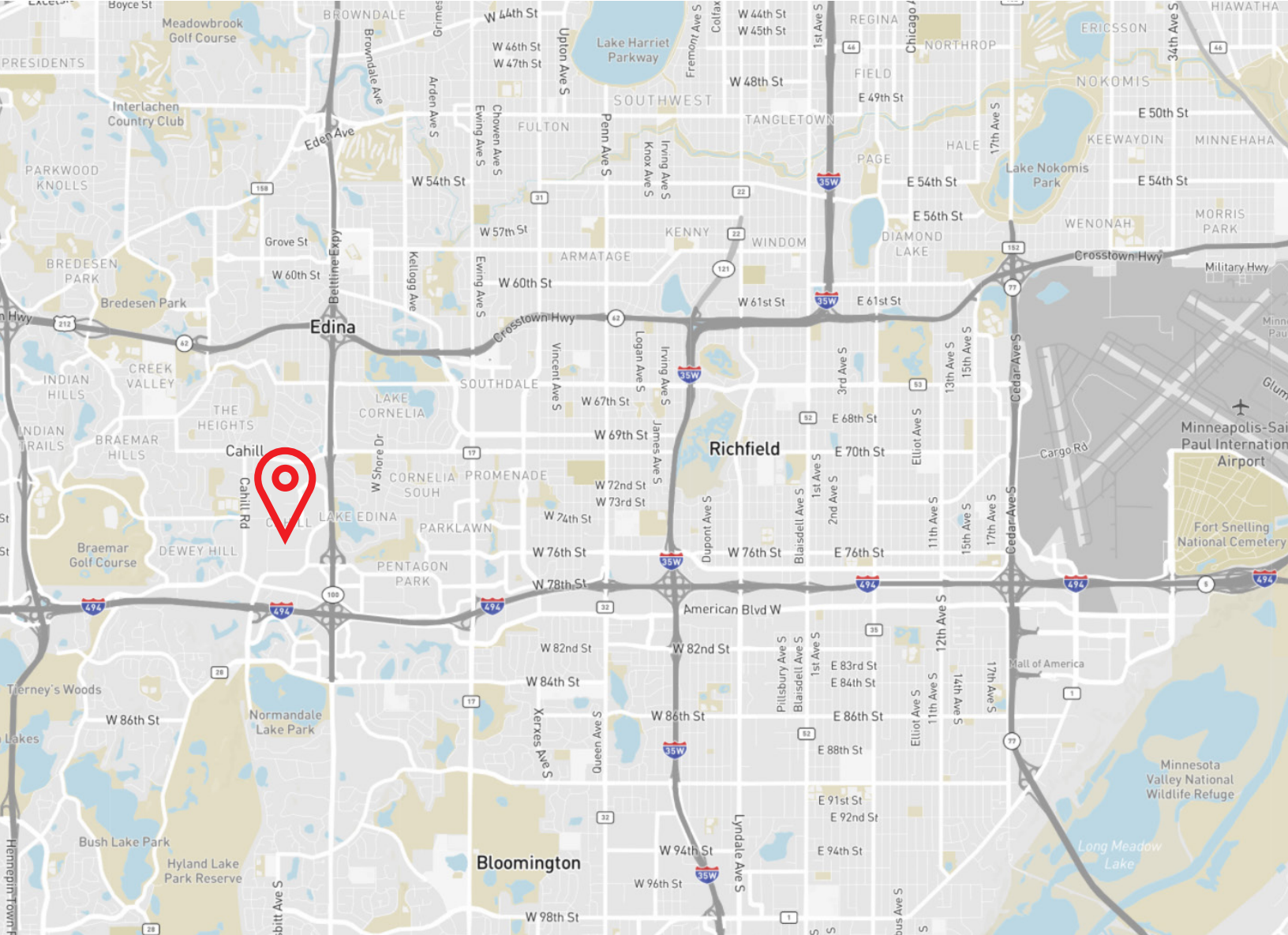

## Traffic scores

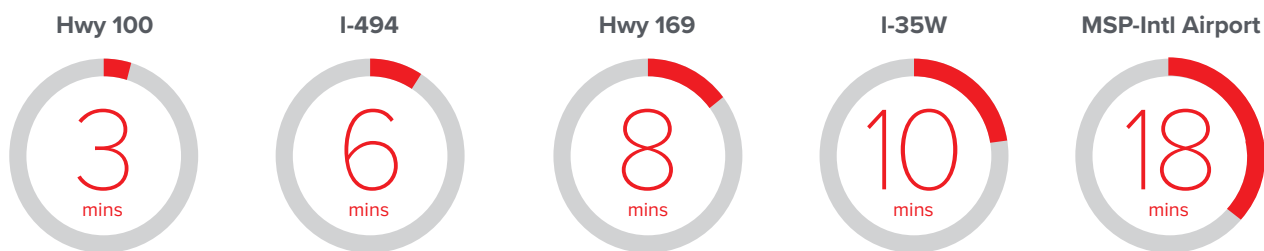

**Connor Ott**  
Vice President

+1 612 217 6741  
[connor.ott@jll.com](mailto:connor.ott@jll.com)

**Will McArdle**  
Associate

+1 612 217 6798  
[william.mcardle@jll.com](mailto:william.mcardle@jll.com)

250 Nicollet Mall  
Suite 1000  
Minneapolis, MN 55401



Although information has been obtained from sources deemed reliable, JLL does not make any guarantees, warranties or representations, express or implied, as to the completeness or accuracy as to the information contained herein. Any projections, opinions, assumptions or estimates used are for example only. There may be differences between projected and actual results, and those differences may be material. JLL does not accept any liability for any loss or damage suffered by any party resulting from reliance on this information. If the recipient of this information has signed a confidentiality agreement with JLL regarding this matter, this information is subject to the terms of that agreement. ©2020. Jones Lang LaSalle IP, Inc. All rights reserved.