



# Today's ideas. Tomorrow's standards.

3000 Pegasus Park | Dallas, TX

Jones Lang LaSalle Brokerage Inc.

**MSP** 

**J. SMALL**  
INVESTMENTS

**LH** **LYDA HILL**  
PHILANTHROPIES

 **JLL**®

# Build the brightest future imaginable

Pegasus Park is a dynamic ecosystem that encourages collaboration, problem-solving, and a healthy dose of good fun.

Located between the Design District and the Southwestern Medical District in Dallas, Texas, Pegasus Park is a 26-acre future focused campus.

The campus offers state-of-the-art facilities and amenities for the daily convergence of entrepreneurs, best of breed companies, strategic business partners, social impact organizations, and Dallas’ emerging biotech ecosystem.

## Four anchors of activity

### Commercial Tenants

Modern offices for a diverse array of tenants from entrepreneurial startups to industry leaders looking to attract and retain top talent.

### Biotech+

Nearly 40,000 SF of state-of-the-art facilities where life science and health care innovators turn their discoveries into high-performing ventures, and establishing it as the epicenter for regional life science innovation.

Pegasus Park is not just another place to work – it is the place to explore ideas that move the needle in the social sector, biotech, and business.

A place built for interaction, ingenuity, and advancement.

### Water Cooler

Up to 175,000 SF of flexible office space and community for nonprofit, philanthropic, and social impact tenants.

### Entertainment, Dining, & Services

Anchored by an on-site brewery, restaurant, and taproom, the cutting-edge facilities include a newly renovated conference center, and intentionally designed social and wellness amenities to boost work/life balance.

# Pegasus Park Site Plan

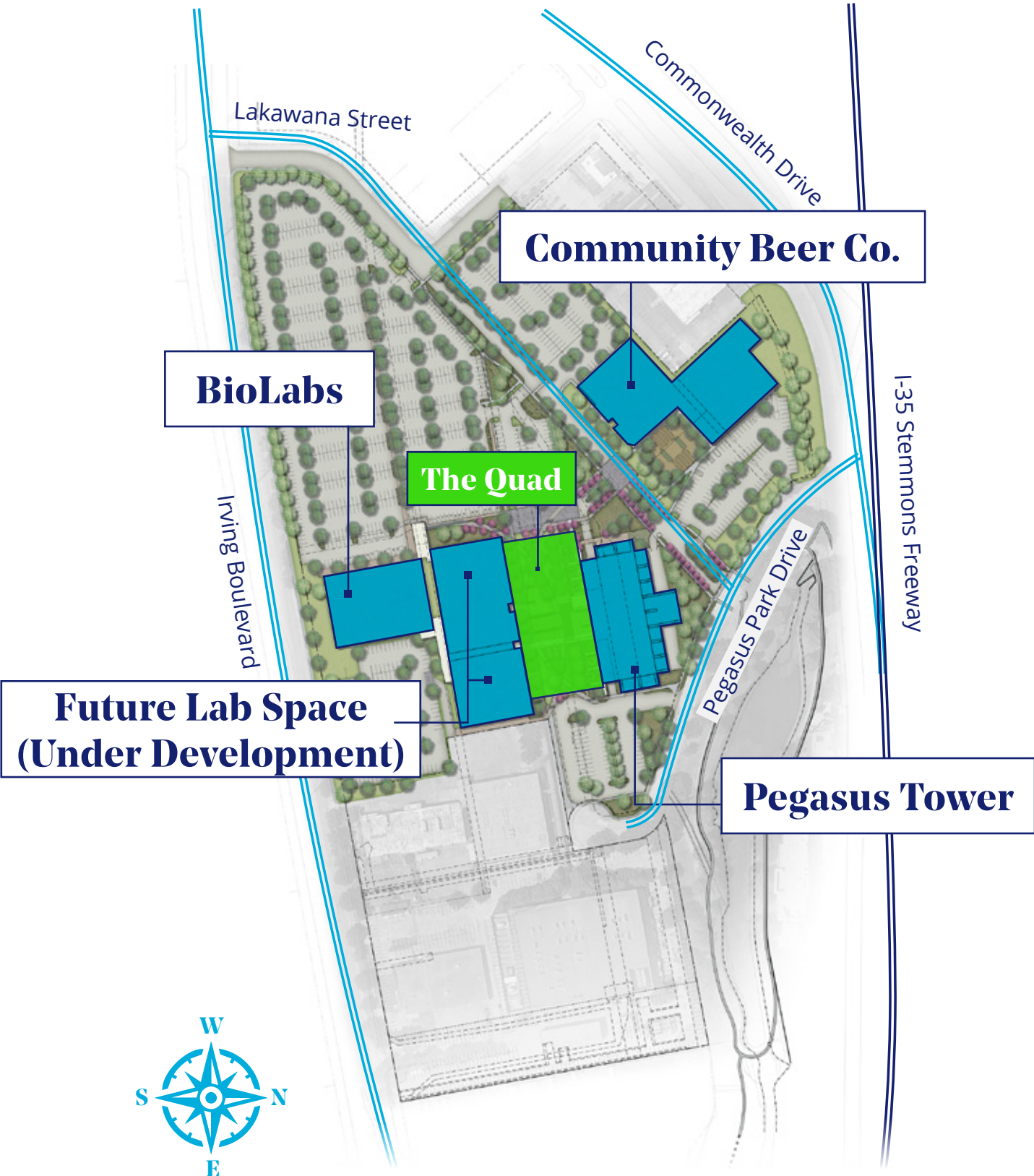



# Features & Amenities



- 16,000SF Convene conference center with room to accommodate groups up to 200.
- Outdoor patio with firepits for meeting, dining, and entertaining.
- Monthly concerts and events.
- On-campus café offering grab-and-go food and catering service.
- Indoor/ outdoor lounge serving cocktails, coffee and snacks.
- Unparalleled access to fiber optic data connectivity & free campus WiFi.
- 24/7 on-site security.
- Hidden Gym fitness center.
- On-site property management and maintenance.
- USPS mail room and overnight delivery center.
- Recycling service.



# The Lobby

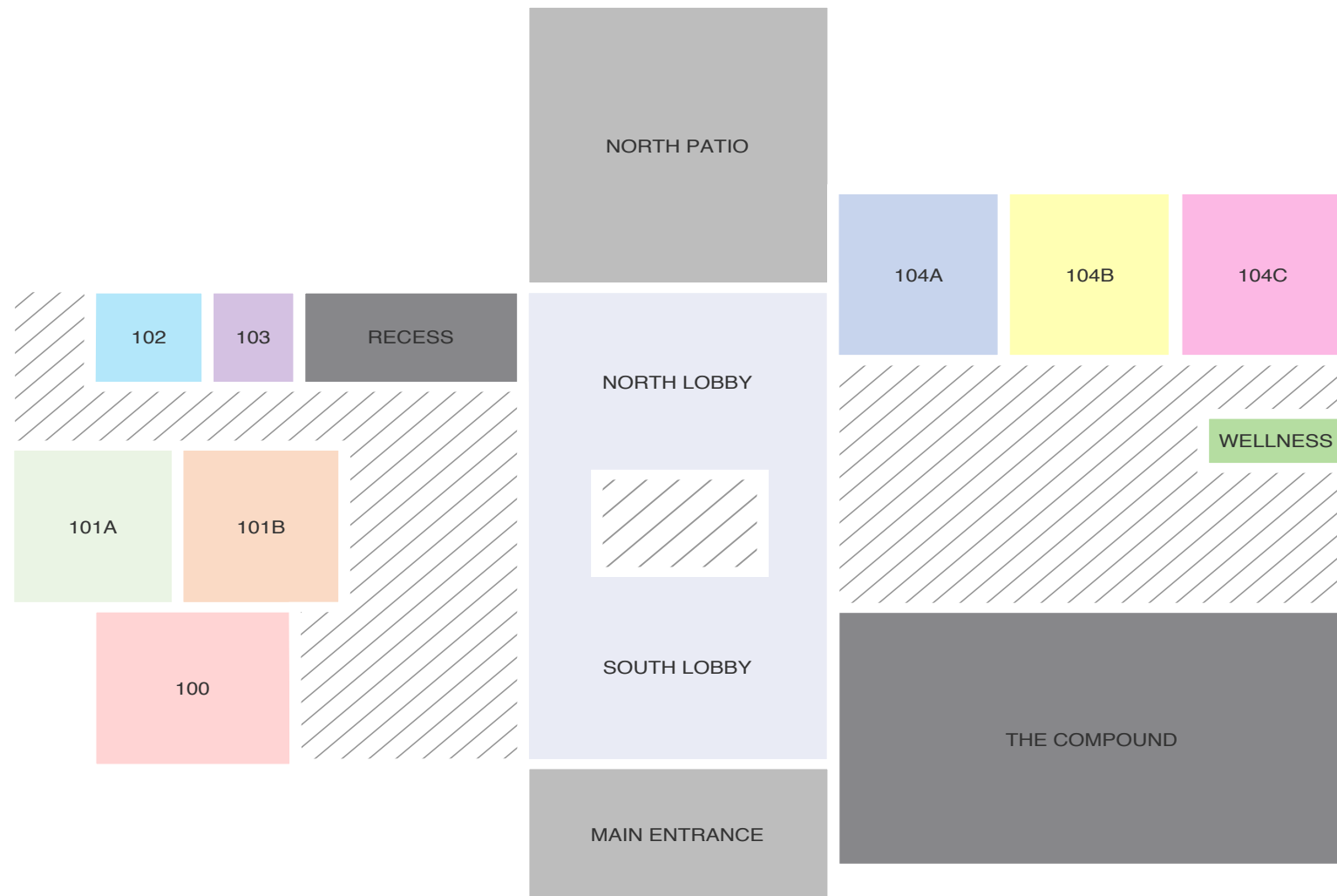



# Typical Floorplan

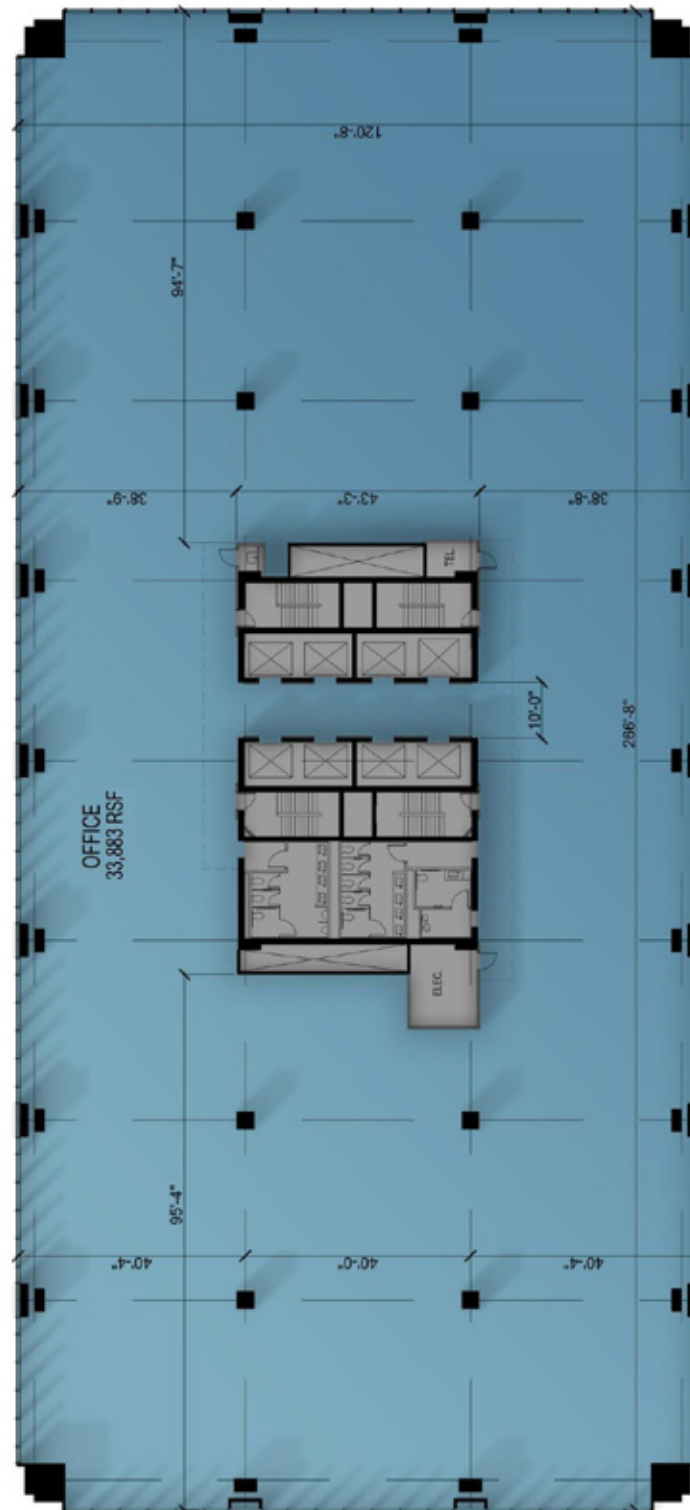

## Health & Wellness



- Adjacent to city park with walking path and pond.
- Bike & scooter storage.
- Minutes away from Trinity Strand Trail & Katy Trail.
- Near Trinity River with biking and walking paths.
- On-site state-of-the-art-fitness center with yoga classes.





## Community Beer Co.

Pegasus Park's on campus brewery, taproom, and restaurant.

## BioLabs

- New fully equipped 40,000 SF flexible life science co-working facility.
- Shared and private laboratory and office spaces for early-stage scientific ventures.
- Equipped with \$3.4M worth of a broad array of premium scientific equipment.
- Resident companies have access to campus services and amenities.
- Affiliation with LaunchBio that will support scientific entrepreneurs to start and grow successful companies at the Biotech+ Hub at Pegasus Park.

Biolabs tenants will have access to UTSW's core facilities with discounted rates, including:

- DNA Genotyping
- Electron Microscopy Core
- Flow Cytometry Core
- Human Genetics Clinical Laboratory
- Mouse Genome Engineering Core
- Next Generation Sequencing Core
- Proteomics Core
- Sanger Sequencing Core
- and many more



**Interactive Floor Plan**





# Why Dallas



01

## Sector Diversity

Dallas' innovation ecosystem expands across many industries in a variety of sectors.

02

## Dallas/Fort Worth Diverse Workforce

DFW ranks No. 1 in the country for job creation and No. 5 in most high-tech occupations added.

03

## Access to Innovative Academic Institutions

University of Texas Institutions are ranked No. 3 in the Top 100 Worldwide Universities Granted U.S. Patents for 2019.

04

## Access to Capital

As of 2019 more than \$5.5B were invested in highly valuable companies that were founded in North Texas.

05

## Solution to an Ever-Growing Problem

As innovation ecosystems become saturated in the East and West coasts, Dallas is a great hub to expand biotech development in the middle of the country.



# Dallas: By the Numbers



**#1** In total job growth.

**#2** Largest state based on population.

**#3** For number of patents received annually.

**#6** Largest tech talent pool nationally.

**#6** U.S. in highest retention rate of higher education graduates who stay and work in the region.

**#9** In world's largest economies, home to 20+ Fortune 500 companies.

## 2nd Largest

DFW International Airport, the nation's 2nd largest airport, is the hub for American Airlines as well as a cargo network that connects the region to 28 major hubs around the world; it is one of only two airports in North America to have a IATA CIEV Pharma certified cold storage logistics facility.

## Access

Access to every major city in the continental U.S. within 4 hours.

## Airline Hub

Dallas Love Field Airport is hub to Southwest Airlines, the largest domestic airline in the country.

## Affordable

No personal or corporate income tax.



# Transportation

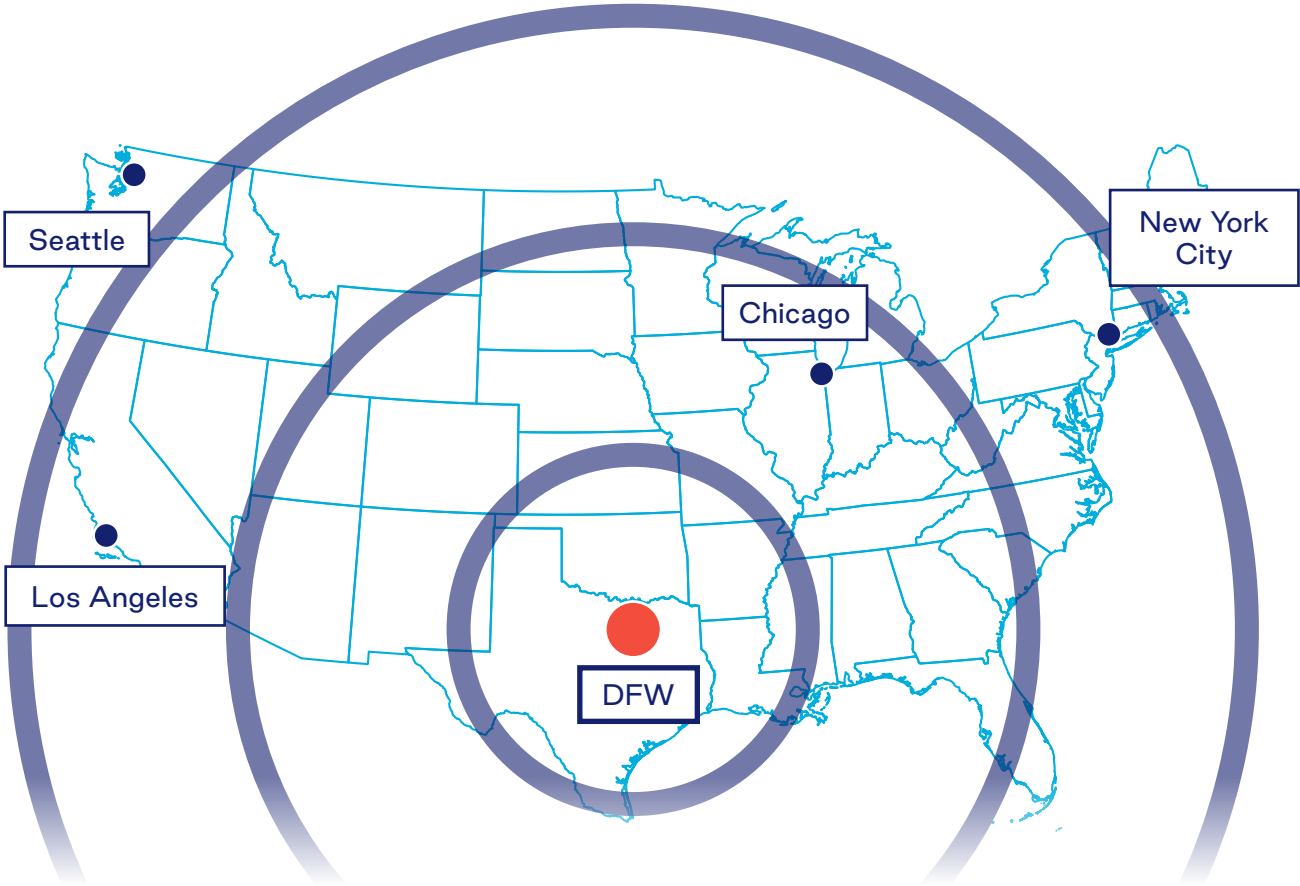

## Truck Transit Times and Population Served

Ring	Hours	Miles	Kilometers	% of US Pop. Served
1	10	600	966	16%
2	24	960	1,545	37%
3	48	1,800	2,887	93%

# Flight Time from DFW

New York, NY (NYC)	3 Hours 15 Minutes
San Diego, CA (SAN)	2 Hours 5 Minutes
Toronto, On, Canada (YTO)	2 Hour 50 Minutes
Mexico City, Mexico (MEX)	2 Hours 32 Minutes
Boston, MA (BOS)	3 Hours 50 Minutes
Seattle, Washington (SEA)	4 Hours 15 Minutes

## DFW Int'l Aiport Domestic Destinations

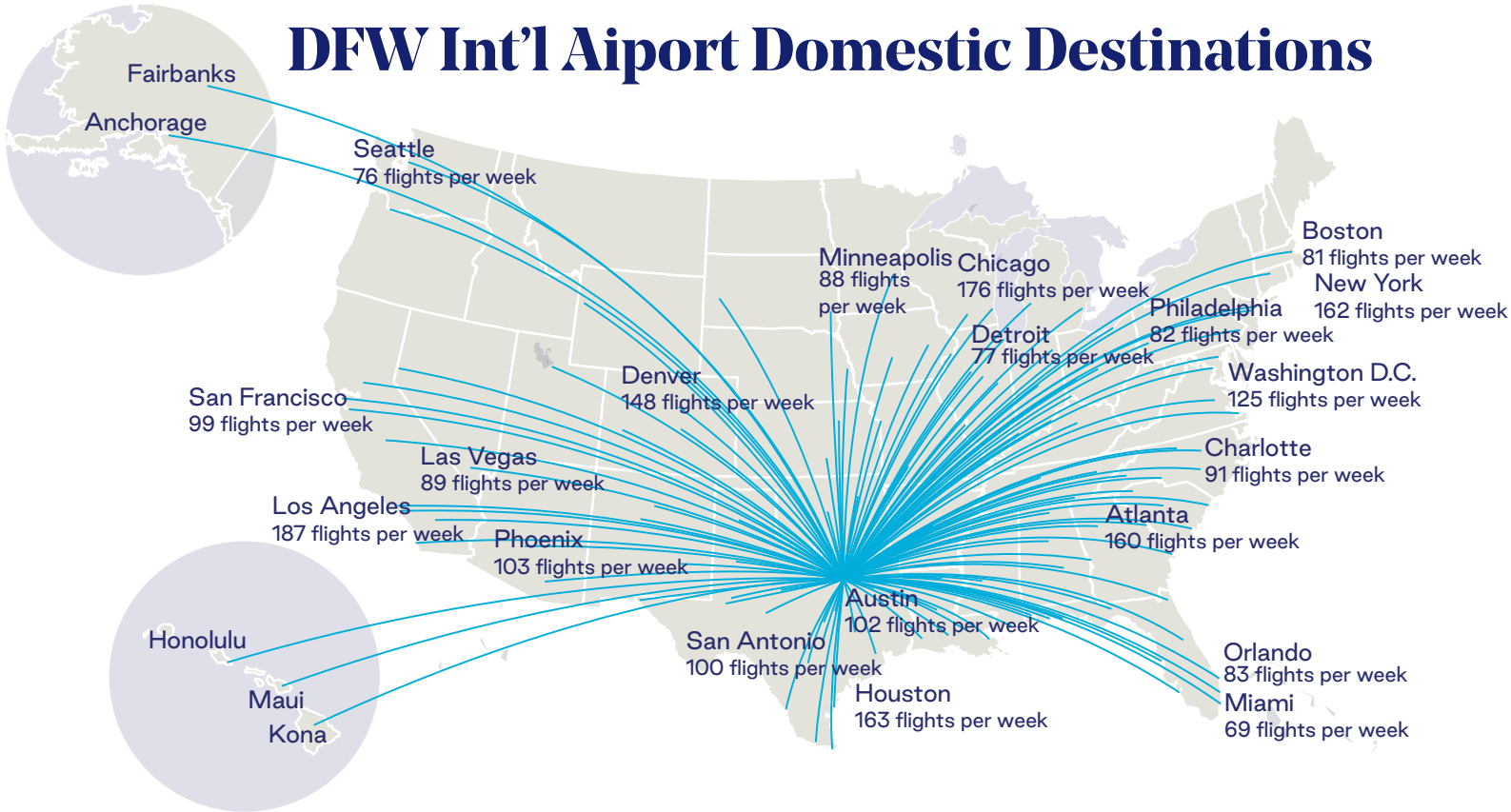

## Airports by the Numbers

### DFW Int'l Airport (2019)

Daily Passengers	205,663
Total Passengers	75,066,956
International Passengers	9,578,478
Total Cargo (Metric Tons)	984,850

### Dallas Love Field (2019)

Daily Passengers	45,973
Total Passengers	16,780,158
International Passengers	231,879
Travel time from Dallas	11 minutes



# In Good Company

DFW has a growing community of seasoned and successful biotech entrepreneurs, ventures, and leading corporations.





# Universities

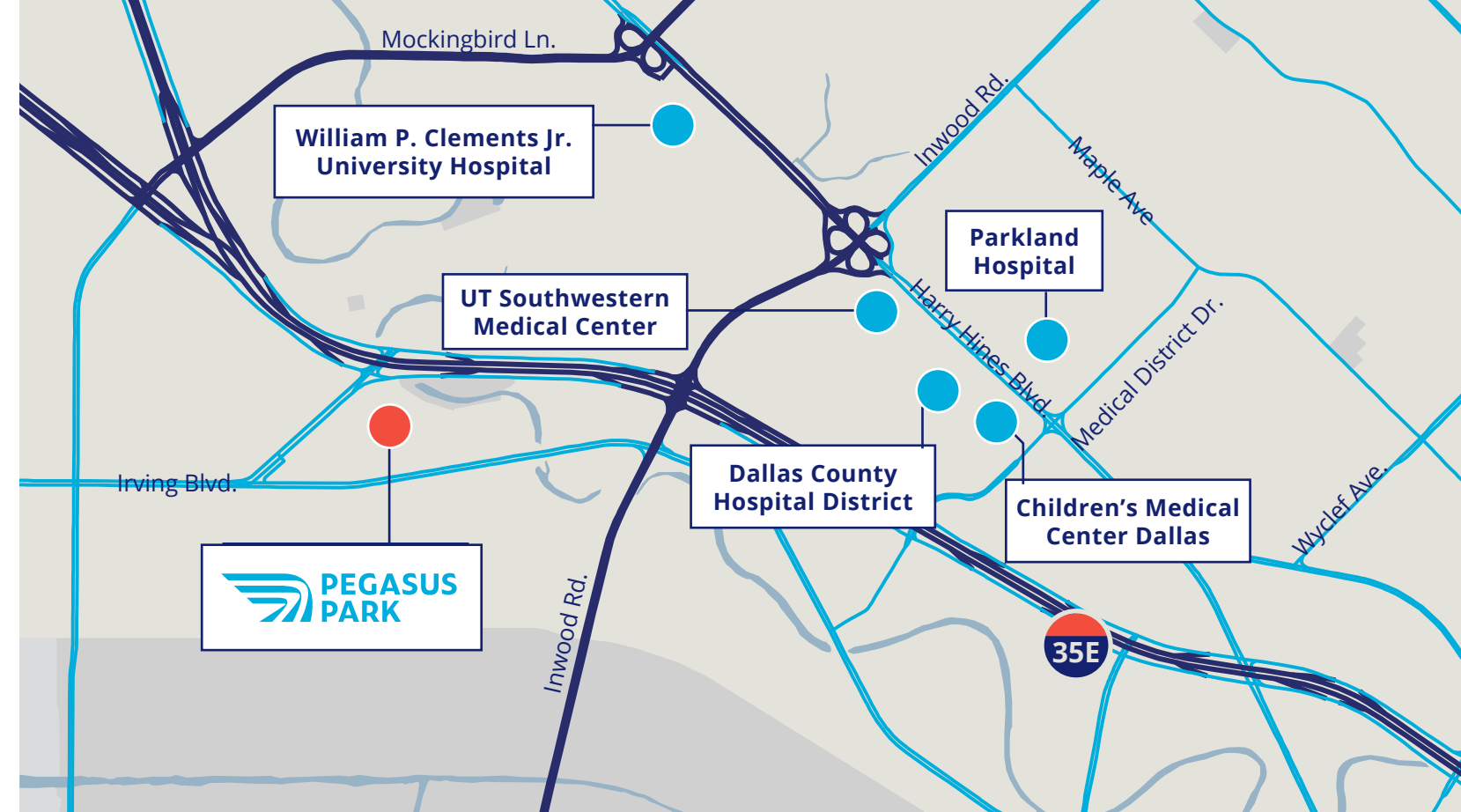

DFW has 3 Carnegie R-1 Universities.

**\$1.1 Billion**  
in Venture Capital Funding.

**\$400M**

Received by UTSW in National Institutes of Health (NIH) funding annually.



UTSW Medical Center is the only academic medical center in the world to serve as home to 6 Nobel Laureates.

**\$3.1 Billion**

In R&D expenditures across UT institutions, the highest in Texas and second highest in the nation among public higher education systems.

**\$585M**

Awarded by Cancer Prevention & Research Institute of Texas (CPRIT) to DFW since 2009.



Mary Crowley Research Center located at Medical City Dallas hospital is one of the world's largest gene therapy investigative facilities.

**76%**

Of UTD students graduate with STEM Degrees.





# Nearby Amenities

## Restaurants & Bars

- 1. Blues Burgers
- 2. Smokey Johnson's Bar-B-Que & Home Cooking
- 3. Pho Chau
- 4. Outfit Brewery
- 5. Community Beer Co.
- 6. In-N-Out Burger
- 7. Chipotle Mexican Grill
- 8. Celestial Beerworks
- 9. Cidercade Dallas
- 10. Maple & Motor
- 11. Pegasus City Brewery
- 12. Peticolas Brewing Company
- 13. Rodeo Goat
- 14. Katy Trail Ice House
- 15. Cake Bar
- 16. Beto & Son
- 17. Steam Theory Brewing Company
- 18. Manhattan Project Beer Co.
- 19. Another round
- 20. TEN Ramen
- 21. Banh Mi Station
- 22. Lone Star Donuts
- 23. PhD – Pour House Dallas
- 24. Nova
- 25. Norma's Cafe
- 26. Tiny Victories
- 27. Whitehall Exchange
- 28. Parker Barrow's Craft House & Deli
- 29. Oak Cliff Social Club
- 30. Lockhart Smokehouse BBQ
- 31. Stock & Barrel
- 32. Emporium Pies
- 33. Ten Bells Tavern
- 34. Dallas Grilled Cheese Co

- 35. Lucia
- 36. Botanist
- 37. Paradiso
- 38. Nora Restaurant and Bar

## Entertainment

- 1. Sammons Center for the Arts
- 2. The Art Park at Trinity Groves
- 3. Bowlounge
- 4. The Dallas World Aquarium
- 5. House of Blues
- 6. Dallas Museum of Art
- 7. Perot Museum of Nature and Science
- 8. Nasher Sculpture Center
- 9. Klyde Warren Park
- 10. Medieval Times Dinner & Tournament
- 11. Dallas Arts District

## Hotels

- 1. Hampton Inn & Suites Dallas Market Center
- 2. Embassy Suites by Hilton Dallas Market Center
- 3. Hilton Anatole
- 4. Hotel Aloft Dallas Love Field
- 5. Hilton Garden Inn Dallas Market Center Hotel
- 6. Renaissance Dallas Hotel
- 7. Dallas Marriott Suites Medical/ Market Center
- 8. The Guild Victory Park | Katy Trail
- 9. Courtyard by Marriott Dallas Medical Center
- 10. Tru by Hilton Dallas Downtown Market Center
- 11. Virgin Hotels Dallas

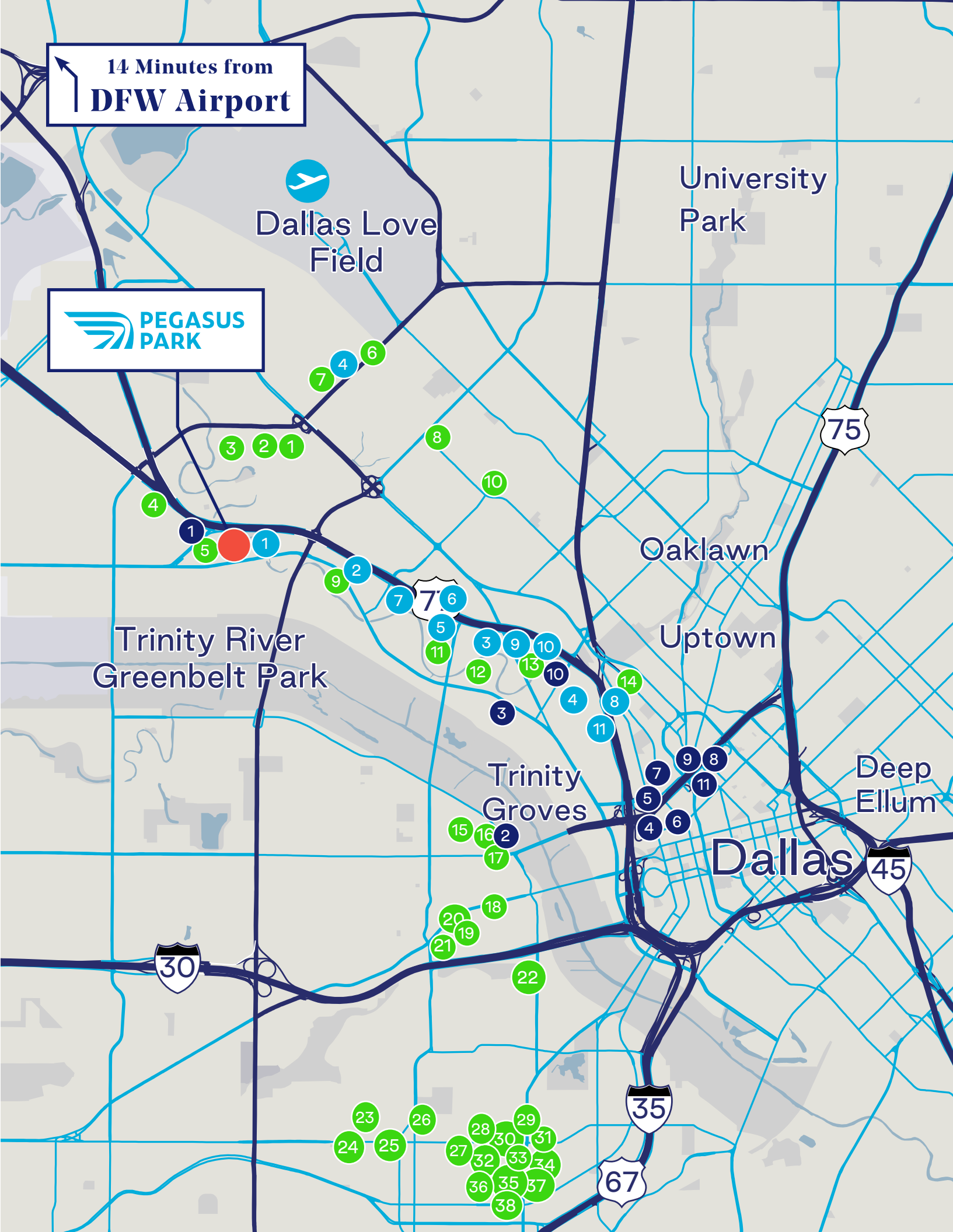





## **Dallas-Fort Worth:**

**Ethan Garner**

214.438.6515

Ethan.Garner@am.jll.com

**Megan Andrew**

214 438 1571

Megan.Andrew@am.jll.com

## **Boston:**

**Matt Daniels**

617.531.4220

Matt.Daniels@am.jll.com

**Carly Kiernan**

617.531.4142

Carly.Kiernan@am.jll.com

## **Bay Area:**

**Matt Jones**

972 209 2550

MattE.Jones@am.jll.com

**MSP** 

**J. SMALL**  
INVESTMENTS

 **LYDA HILL**  
PHILANTHROPIES

 **JLL**®

3000 Pegasus Park | Dallas, TX 75235

Although information has been obtained from sources deemed reliable, neither Owner nor JLL makes any guarantees, warranties or representations, express or implied, as to the completeness or accuracy as to the information contained herein. Any projections, opinions, assumptions or estimates used are for example only. There may be differences between projected and actual results, and those differences may be material. The Property may be withdrawn without notice. Neither Owner nor JLL accepts any liability for any loss or damage suffered by any party resulting from reliance on this information. If the recipient of this information has signed a confidentiality agreement regarding this matter, this information is subject to the terms of that agreement. ©2022 Jones Lang LaSalle IP, Inc. All rights reserved. 7.19.2022