

1000 Park Road

Chanhassen, MN

151,636 SF Sublease Opportunity



Available June 1, 2023



1000 Park Road

Chanhassen, MN

Building features

Size	151,636 SF Total
	9,642 First Floor Office
	59,538 SF First Floor Production
	61,488 SF First Floor Warehouse
	18,983 SF Second Floor Office
Land Size	14.68 Acres
Clear Height	Second Floor: 10'5"
	Production: 23' - 24'
	Warehouse: 26' - 27'
Column Spacing	45' x 50'

Loading	Nine (9) dock doors
Power	Two (2) 3000 amp service
Property Taxes (2022)	\$332,556.00
Lease Rate	Negotiable
Date Available	June 1, 2023
Lease Term through	August 31, 2027
Parking	Est. 99 stalls

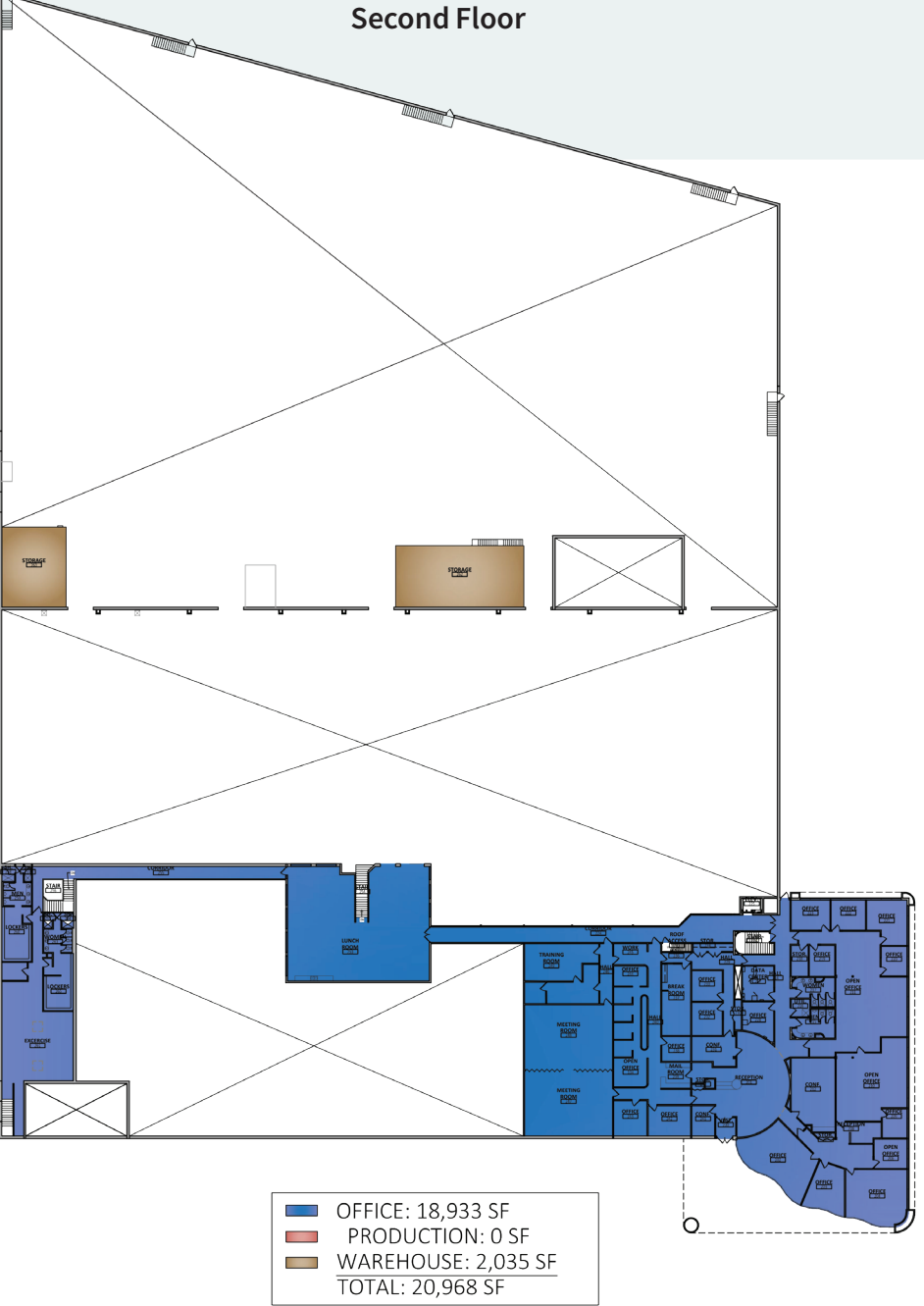
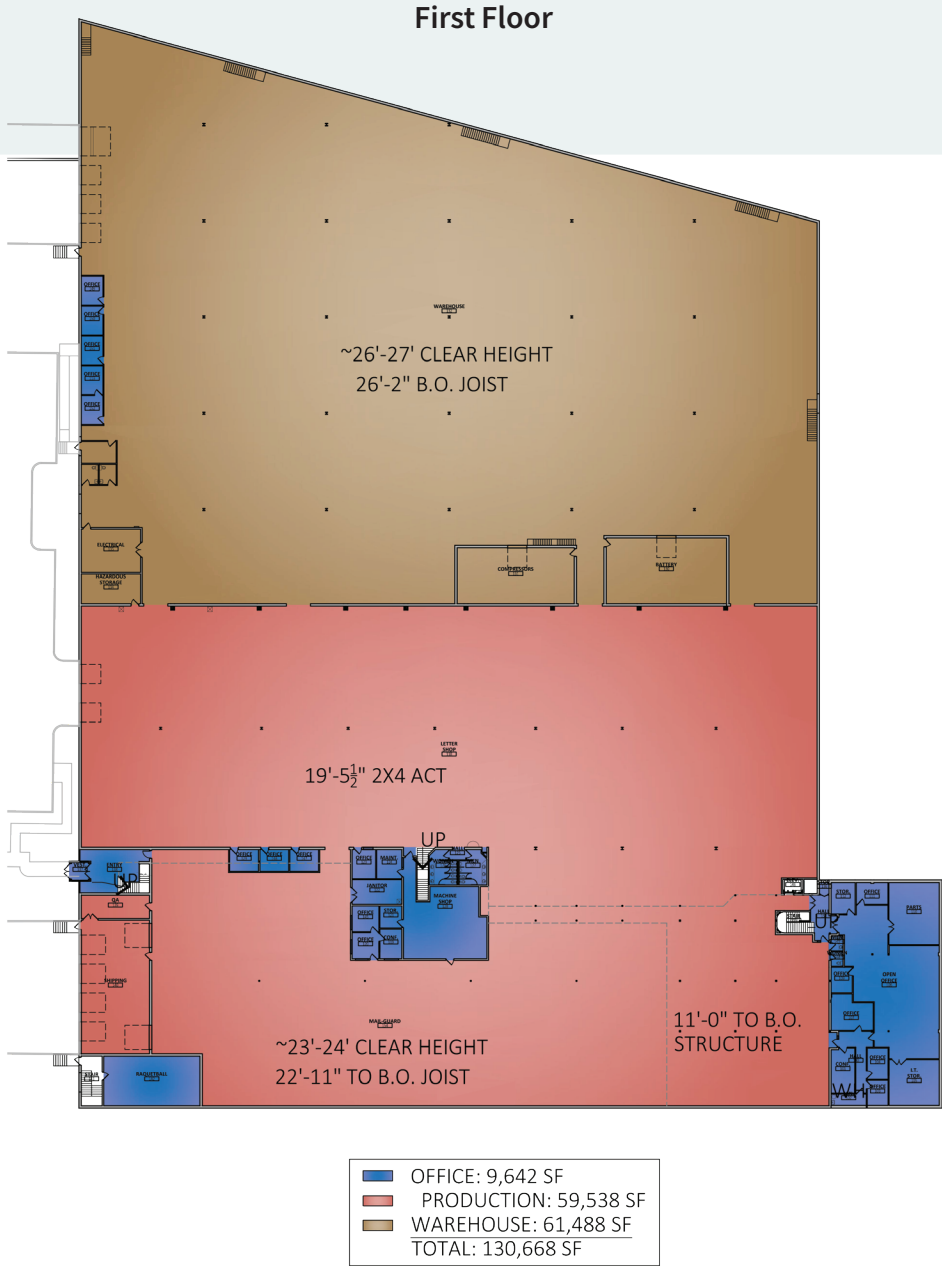

1000 Park Road

Chanhassen, MN



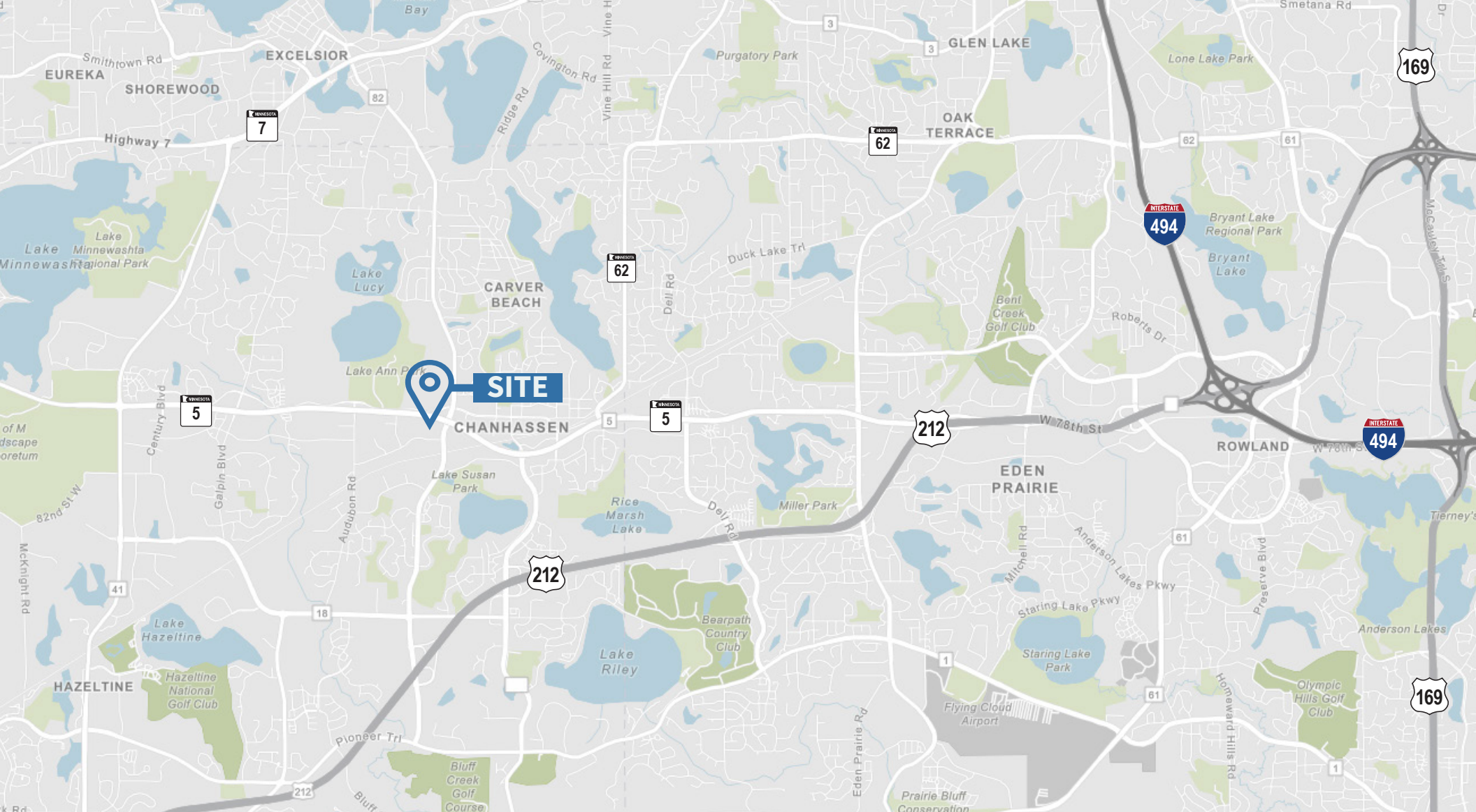

Drive Times

Hwy 212

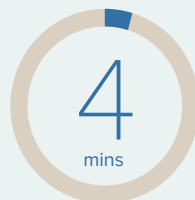

I-494

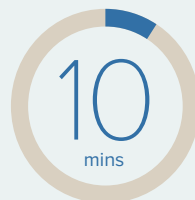

Hwy 169

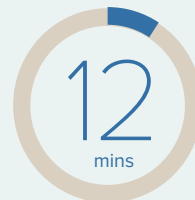

Chris Hickok, CCIM
Managing Director
612 217 5121
chris.hickok@jll.com

Dan Larew, CCIM SIOR
Executive Vice President
612 217 6726
dan.larew@jll.com

Although information has been obtained from sources deemed reliable, JLL does not make any guarantees, warranties or representations, express or implied, as to the completeness or accuracy as to the information contained herein. Any projections, opinions, assumptions or estimates used are for example only. There may be differences between projected and actual results, and those differences may be material. JLL does not accept any liability for any loss or damage suffered by any party resulting from reliance on this information. If the recipient of this information has signed a confidentiality agreement with JLL regarding this matter, this information is subject to the terms of that agreement. ©2020. Jones Lang LaSalle IP, Inc. All rights reserved.

Jones Lang LaSalle | 250 Nicollet Mall, Suite 1000 | Minneapolis, MN 55401