



# 167

**GREEN STREET**

**46,855 RSF HIGH-END SUBLEASE IN  
A COVETED FULTON MARKET ADDRESS**







# SUBLEASE HIGHLIGHTS

Located at the epicenter of Fulton Market, between Green and Halsted, 167 Green has direct access to Fulton Market's amenities, arts & culture, transportation and the Chicago Loop.

This full floor sublease offers a unique opportunity to office in the most sought after submarket in the US.



**46,855 RSF sublease**  
**4/30/34 expiration**



Floor-to-ceiling glass  
windows with  
360 degree views



Creative collaboration  
spaces throughout



Newly built,  
high-end design



Exceptional on-site  
amenities & parking  
garage



LEED Gold  
certified building



## 14TH FLOOR

46,855 RSF

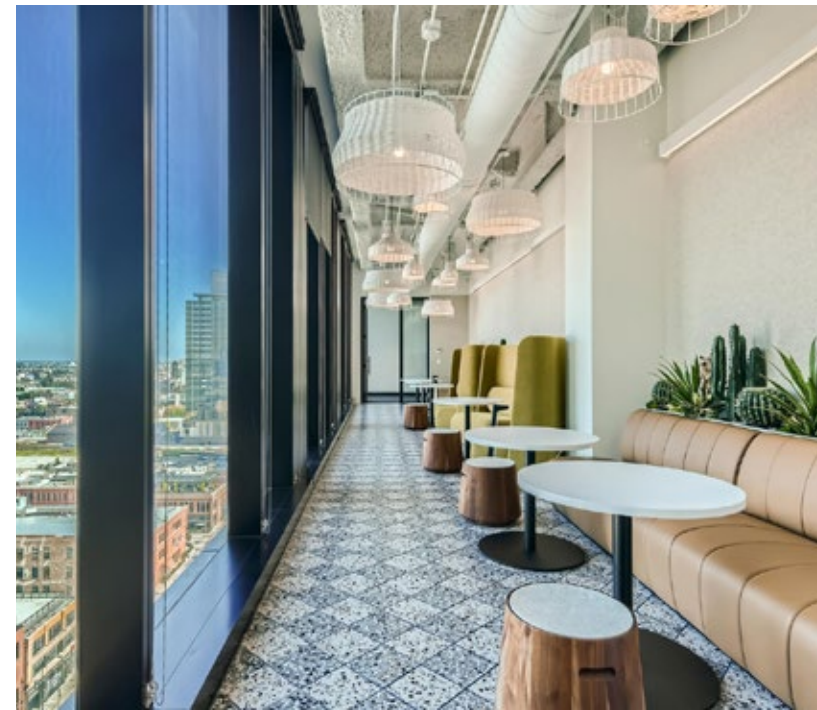
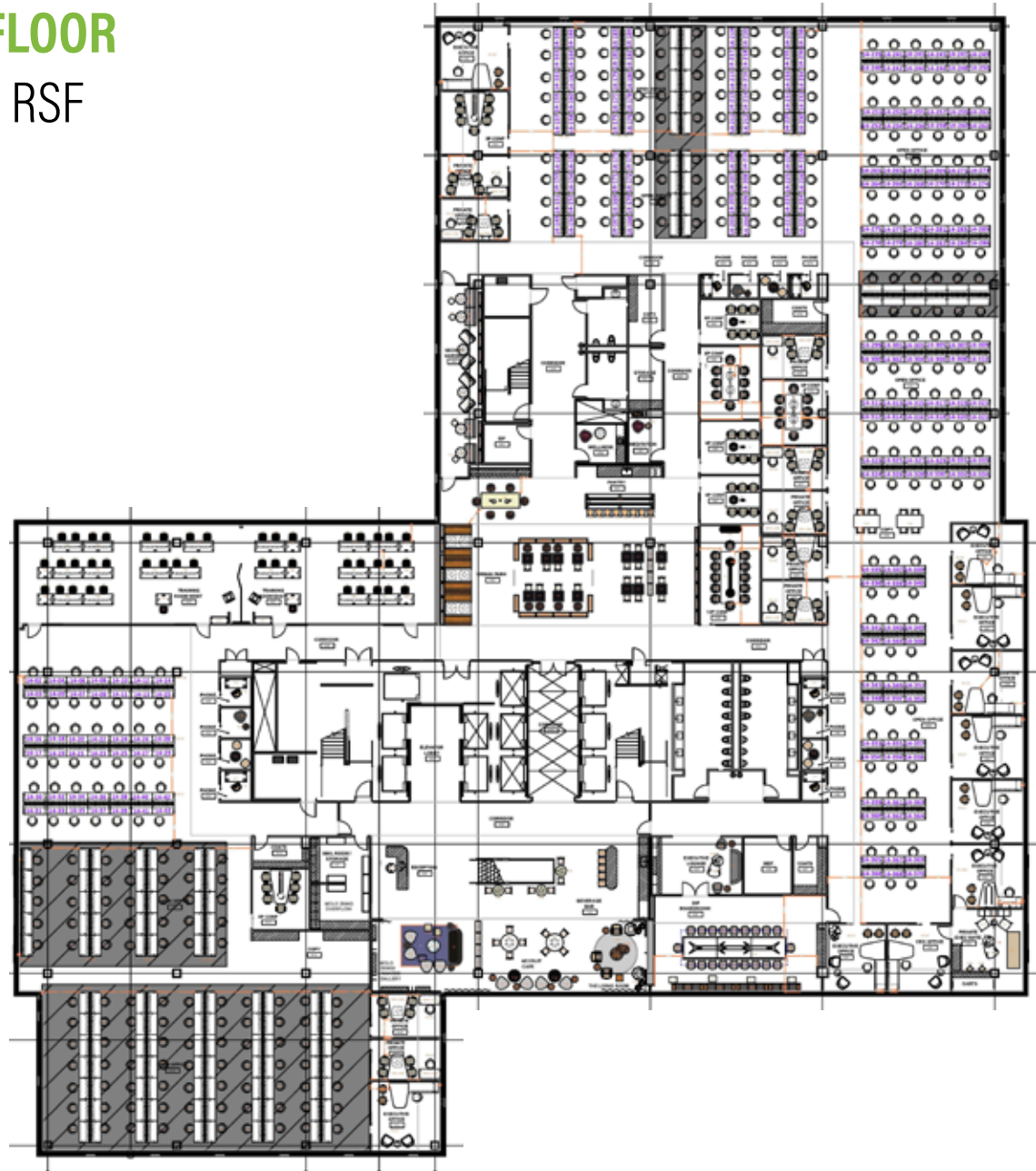

- Reception with beverage bar, living room, café area, and merchandise store area
- 9 executive offices & 1 CEO office
- Speakeasy
- 235 workstations (room to accommodate an additional 135 workstations)
- 12 phone rooms
- 9 huddle rooms
- Board room (20) with executive lounge
- 1 conference room (12)
- 4 conference rooms (8)
- 3 conference rooms (6)
- 2 training rooms with retractable wall (can seat up to 43)
- Kitchen/pantry with open seating throughout the Urban Park
- Secret garden with open seating
- 1 meditation room
- Wellness room
- 1 mail/storage room & 1 copy/print room







## ON-SITE AMENITIES

Town Hall + Professional-Sized Basketball Court

Gym + Locker Rooms

Meeting Rooms

Sitting Room + Cafe

Terrace

Ground floor retail in The Mews including Foxtrot, the Oakville and Yokocho.





# 167



**Belle Spinell**  
+1 312 245 4812  
[Isabella.Spinell@jll.com](mailto:Isabella.Spinell@jll.com)

**Kellen Monti**  
+1 312 228 2667  
[kellen.monti@jll.com](mailto:kellen.monti@jll.com)

**Matt Carolan**  
T +1 312 228 2513  
[matt.carolan@jll.com](mailto:matt.carolan@jll.com)