



# 12777

HIGH BLUFF DRIVE . DEL MAR HEIGHTS

**45,000 SF OFFICE SPACE FOR SUBLEASE**





# 12777

HIGH BLUFF DRIVE, DEL MAR HEIGHTS

Superior location in

**Del Mar Heights**

with easy access to SR-56 and I-5

Move-in ready office building

**Fully furnished with new FF&E**





Strong corporate identity & visibility along  
**High Bluff Drive**

Unparalleled access walking distance to premier  
**shopping and dining**



# 12777

HIGH BLUFF DRIVE . DEL MAR HEIGHTS

## Premier Office Space for Sublease

A 45,000 SF office building

Situated in the best location in Del Mar Heights, 12777 High Bluff Drive is offering move-in ready Class A office space. With 45,000 SF of office space available in Q4 2023, and ±140,000 SF of lab/office space available in Q1 2025 (in the adjacent 12780 building), a perfect opportunity awaits for a growing innovation company.





**±45,000**

SF building, divisible  
to 22,000 SF



Move-in ready space  
fully furnished with  
new FF&E

**4.30.2029**

Master Lease Expiration

**Q4 2023**

Available



Newly-renovated  
outdoor courtyard  
with foosball tables,  
ping pong & pool

**3.3/1,000**

RSF (135 stalls;  
surface + covered)

# 12777

HIGH BLUFF DRIVE . DEL MAR HEIGHTS

## 12777 High Bluff Drive

**Level 01**

22,207 RSF

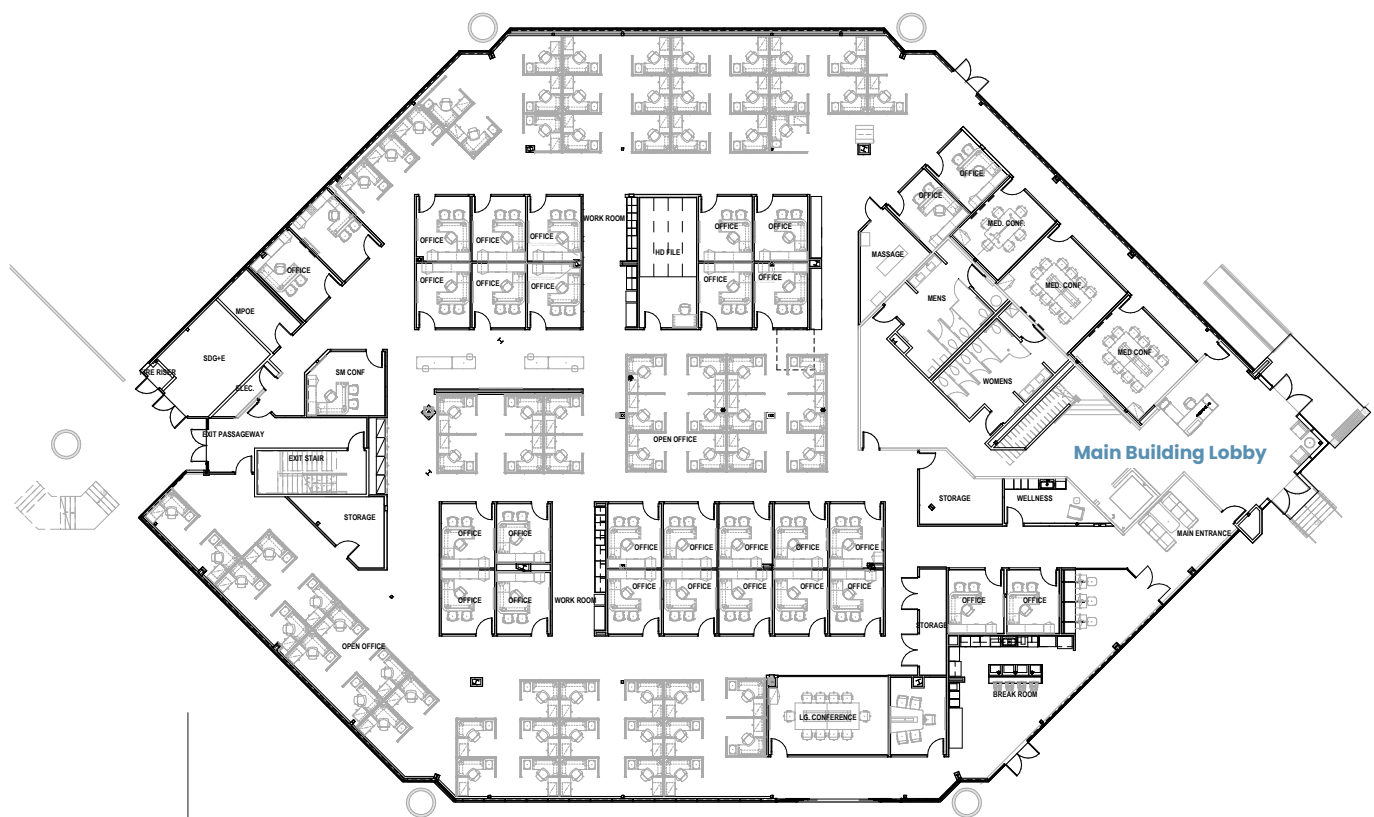

72 Workstations  
30 Private Offices  
6 Conference Rooms  
Break Room





22,511 RSF



# 12777

HIGH BLUFF DRIVE . DEL MAR HEIGHTS











# 12777

HIGH BLUFF DRIVE . DEL MAR HEIGHTS





An aerial photograph of a city intersection. A multi-lane road runs vertically through the center, intersecting with a horizontal road. To the left of the intersection is a modern building with a glass facade. To the right is a large, open green field, possibly a park or sports field, with some trees and a paved path. The background shows a dense residential area with many houses and trees. Two blue callout boxes with white text are overlaid on the image: 'ONE PASEO' on the left and 'DEL MAR HIGHLANDS' on the right.

ONE PASEO

DEL MAR HIGHLANDS





**CHAD URIE**

+1 858 410 1187

chad.urie@jll.com

RE license #01261962

**GRANT SCHONEMAN**

+1 858 410 1252

grant.schoneman@jll.com

RE license #01516695

**TAYLOR DEBERRY**

+1 858 410 6392

taylor.deberrry@jll.com

RE license #2014850

# 12777

HIGH BLUFF DRIVE . DEL MAR HEIGHTS

**45,000 SF OFFICE SPACE FOR SUBLEASE**

Although information has been obtained from sources deemed reliable, neither Owner nor JLL makes any guarantees, warranties or representations, express or implied, as to the completeness or accuracy as to the information contained herein. Any projections, opinions, assumptions or estimates used are for example only. There may be differences between projected and actual results, and those differences may be material. The Property may be withdrawn without notice. Neither Owner nor JLL accepts any liability for any loss or damage suffered by any party resulting from reliance on this information. If the recipient of this information has signed a confidentiality agreement regarding this matter, this information is subject to the terms of that agreement. ©2022. Jones Lang LaSalle IP, Inc. All rights reserved.