



FOR LEASE

5187

Ascension Way
Murray, Utah 84123

**256 – 9,422 RSF
Available**

\$16.00 PSF/ Full Service



Property **Highlights**



Immediately Available
and Move-In Condition



Great I-15 Visibility
and Exposure



Centrally Located in
the Salt Lake Valley



Prominent **Crown**
Signage Available



Abundant Parking
4.5/1000



State of the Art Mechanical
& Electrical Systems



Numerous Amenities
within Close Proximity



Walkable to Bus Stations,
High & Light Speed Rail

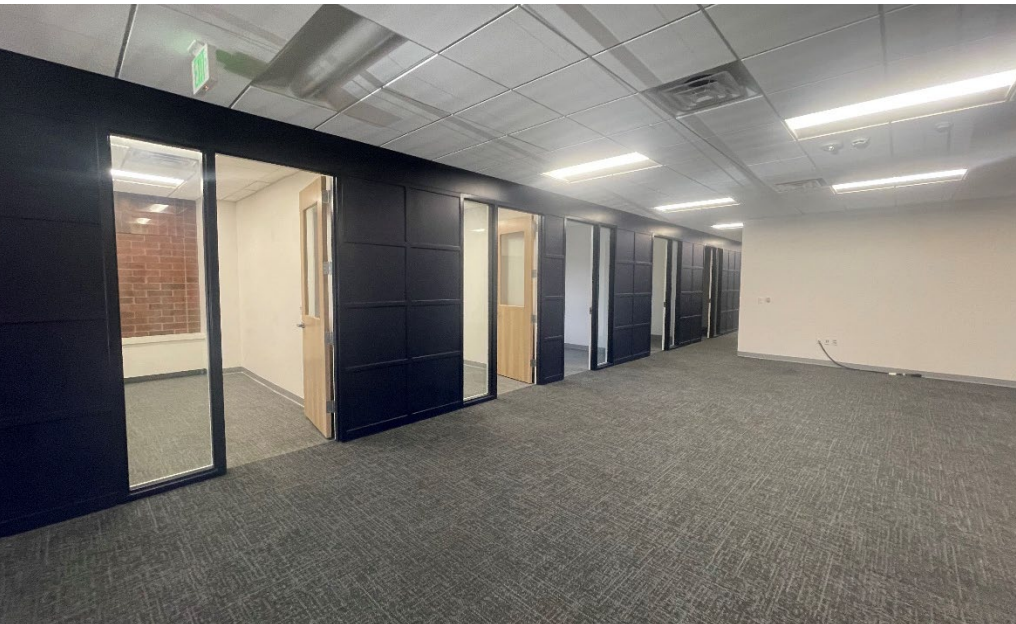

Available Space

SUITE	AREA
Suite 100	5,482 SF
Suite 125	3,527 SF
Suite 150	3,349 SF
Suite 160	5,106 SF
Suite 175	1,733 SF
Suite 200	9,422 SF
Suite 225	2,485 SF
Suite 250	5,971 SF
Suite 260	1,469 SF
Suite 270	256 SF

FLOOR ONE

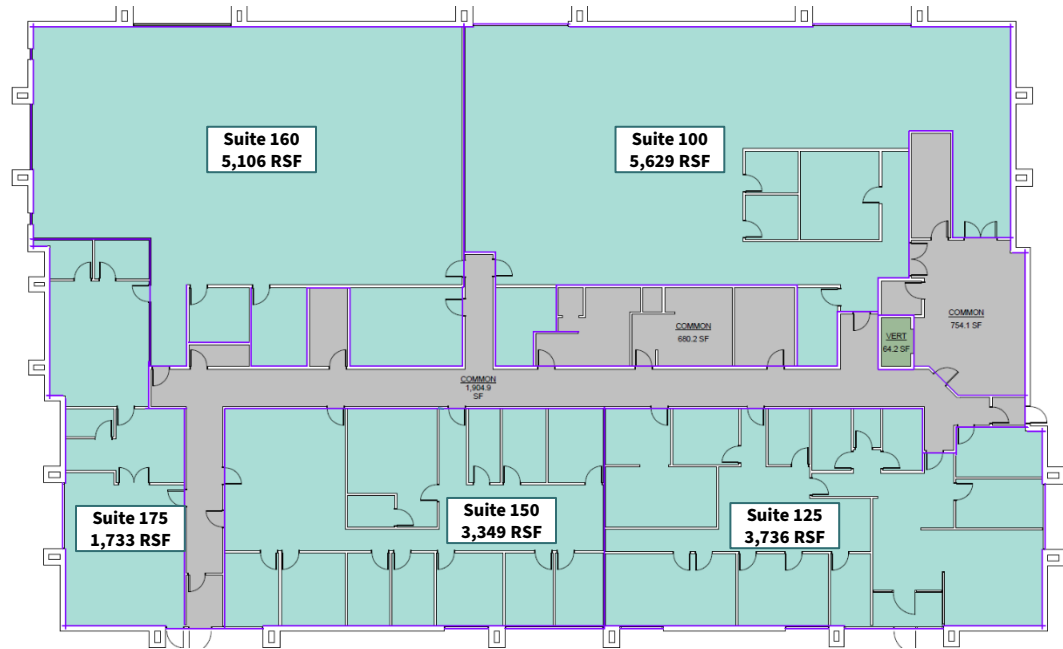

FLOOR TWO

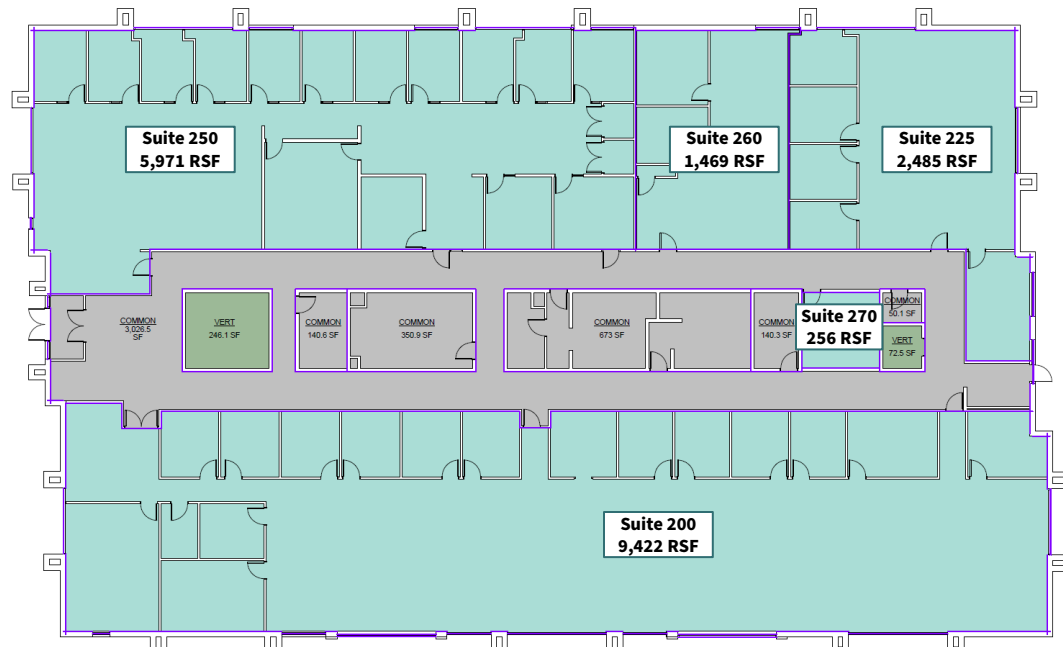



Contact Information

David Nixon

+1 (801) 456 9518

david.nixon@jll.com

Jillian Johnson

+1 (801) 456 9517

jillian.johnson@jll.com

Jones Lang LaSalle Brokerage, Inc.
©2023 Jones Lang LaSalle LP, Inc. All rights reserved.
All information contained herein is from sources deemed reliable; however, no representation or warranty is made to the accuracy thereof.