

*Excellent location.
Exceptional value.*

ONE NORTHBROOK PLACE

5 REVERE DRIVE, NORTHBROOK



BUILDING FEATURES

- Recently renovated lobby, corridors, and restrooms
- Modernized Michael's on Main deli, serving breakfast and lunch
- Expansive window lines and large floorplates
- Underground and reserved parking
- Proximity to an array of restaurants, hotels and retail amenities
- Monument signage available

Suite 355: 5,562 RSF ● Suite 400: 13,854 RSF ● Suite 404: 4,093 RSF ● Suite 540: 10,536 RSF

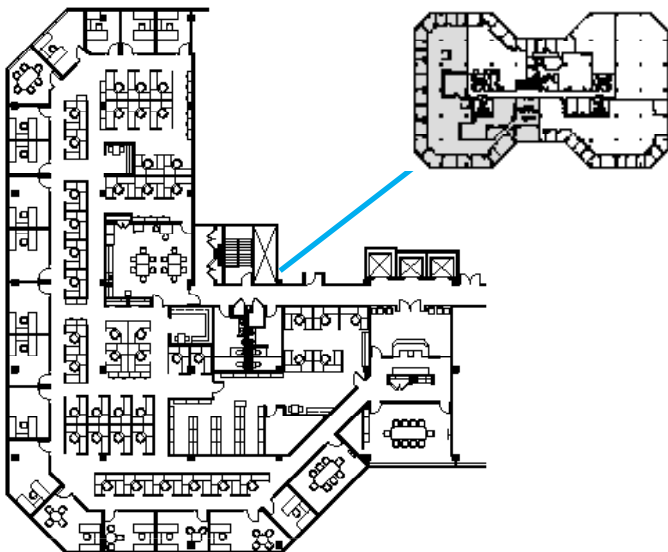



- Convenient to public transportation
- Quick access to Skokie Highway / Edens Expressway via four-way interchange at Lake Cook Road

