



FOR LEASE
COUNTY LINE
LOGISTICS CENTER

Plant City, Florida

nuveen
REAL ESTATE



Jones Lang LaSalle Brokerage Inc., a licensed real estate broker

PROPERTY HIGHLIGHTS

- First-generation Class A warehouse space
- 1.1M+ SF. overall building project
- Corporate park setting
- On-site trailer storage
- Tilt-wall construction
- Rear-load and cross-dock configurations available
- Dock-high and grade-level loading
- Conveniently located on County Line Road, just south of I-4

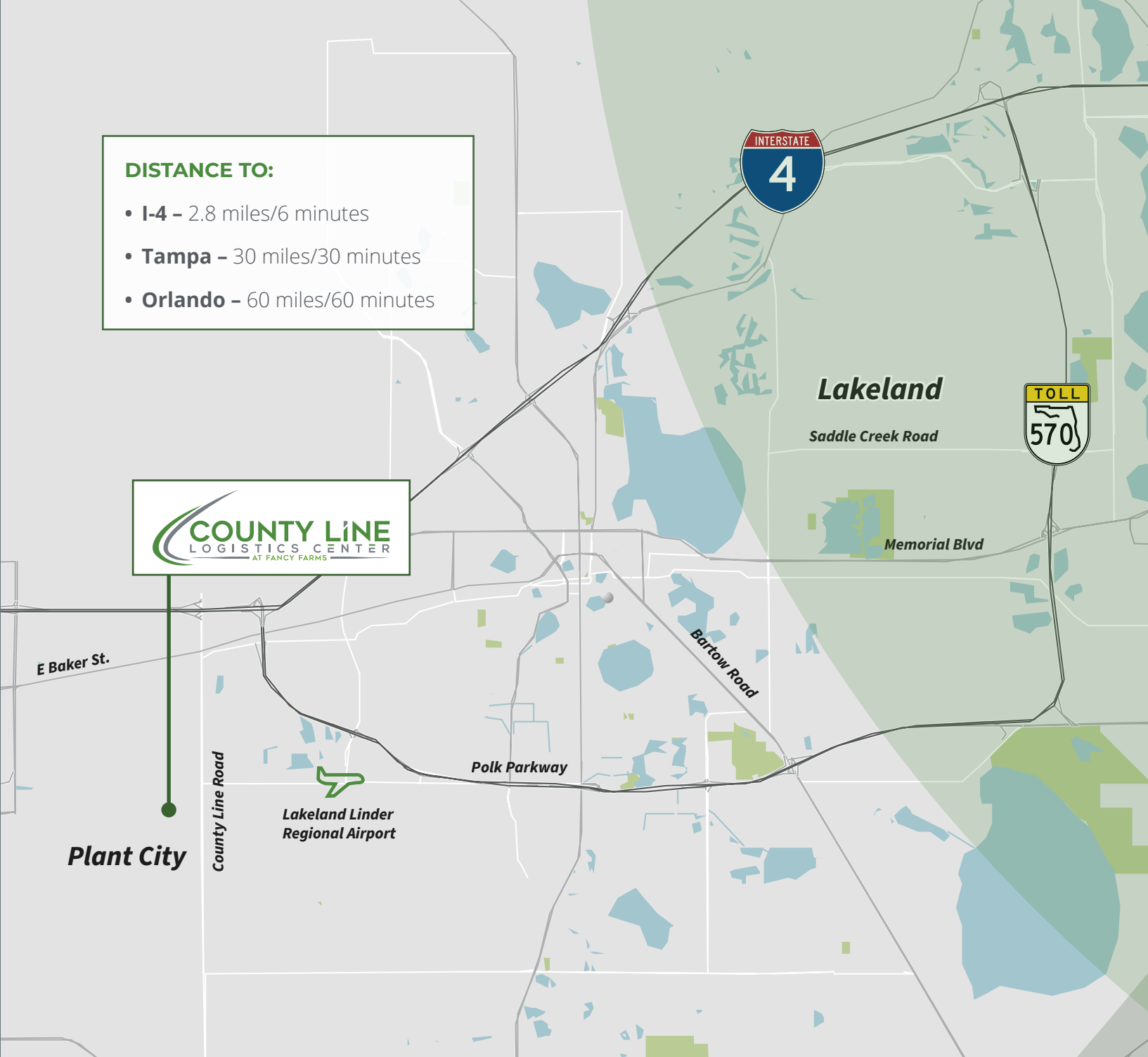
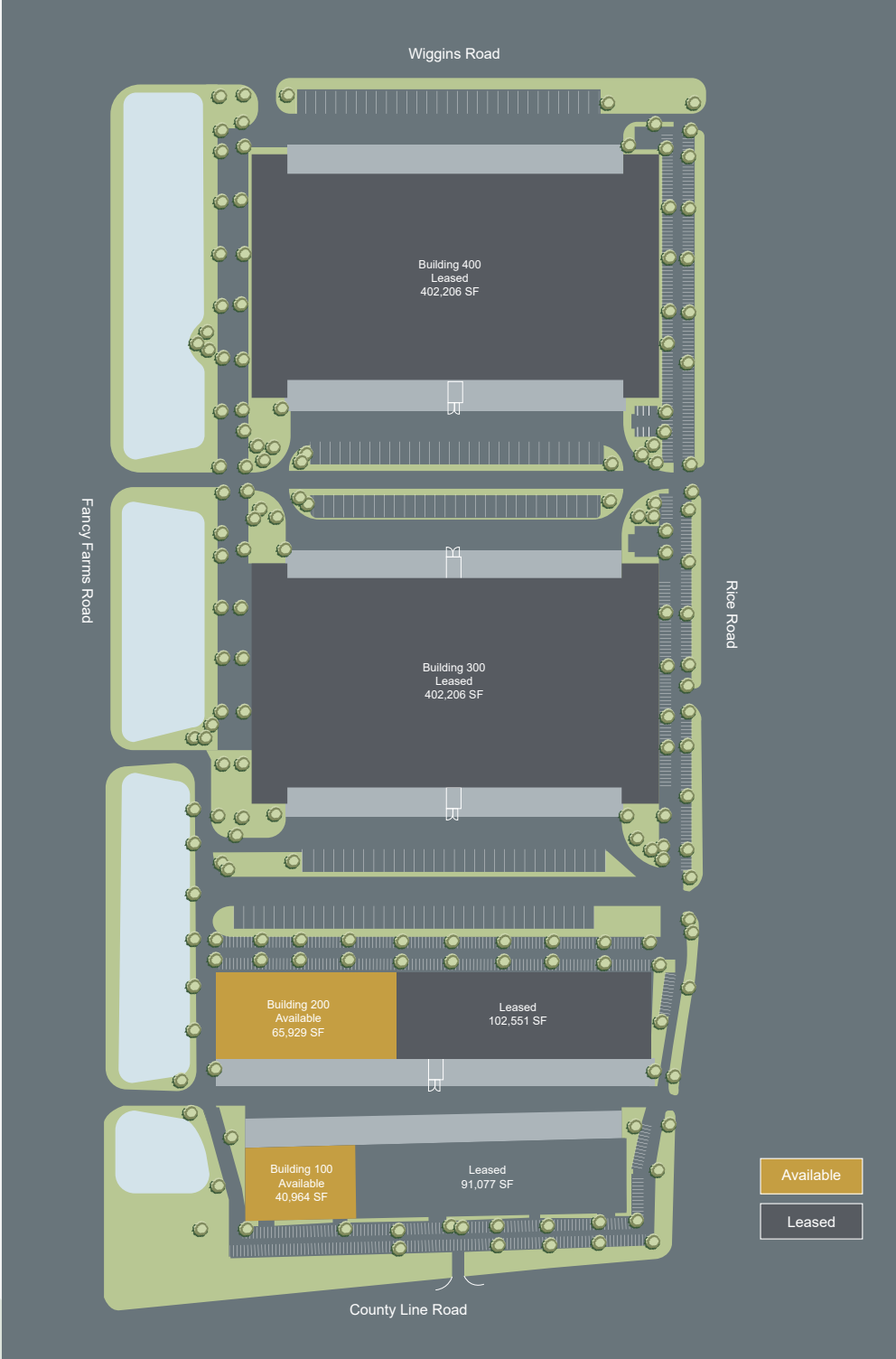

DEMOGRAPHICS

	1 hr	2 hr	4hr
Total Population	3,190,858	6,258,311	9,691,647
Total Households	1,285,371	2,582,093	3,853,727
Median Household Income	\$66,029	\$64,125	\$65,306
Businesses	119,661	257,275	480,868
Employees	1,262,626	2,403,751	4,161,050

BUILDING 100 INFORMATION:

Space Available:	40,964 SF
Office Space:	1,797 SF
Total Building Size:	132,041 SF
Building Dimensions:	160' × 820'
Clear Height:	28'
Truck Court:	±170' (shared)
Car Parking:	168 spaces
Column Spacing:	52'w × 54'd with 60' staging bay
Loading:	Sixteen (16) - 9' × 10' dock-high doors One (1) - 12' × 14' grade-level door
Electric:	3-phase
Sprinkler System:	ESFR sprinkler system
Available:	February 2024

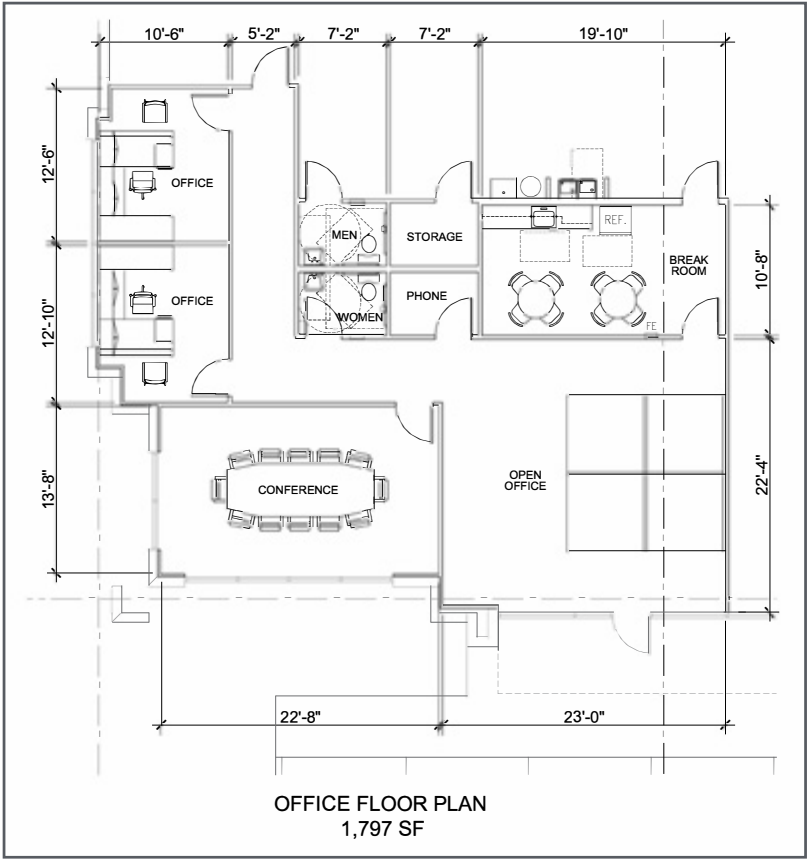

Building 100
2101 County Line Road, Plant City, FL

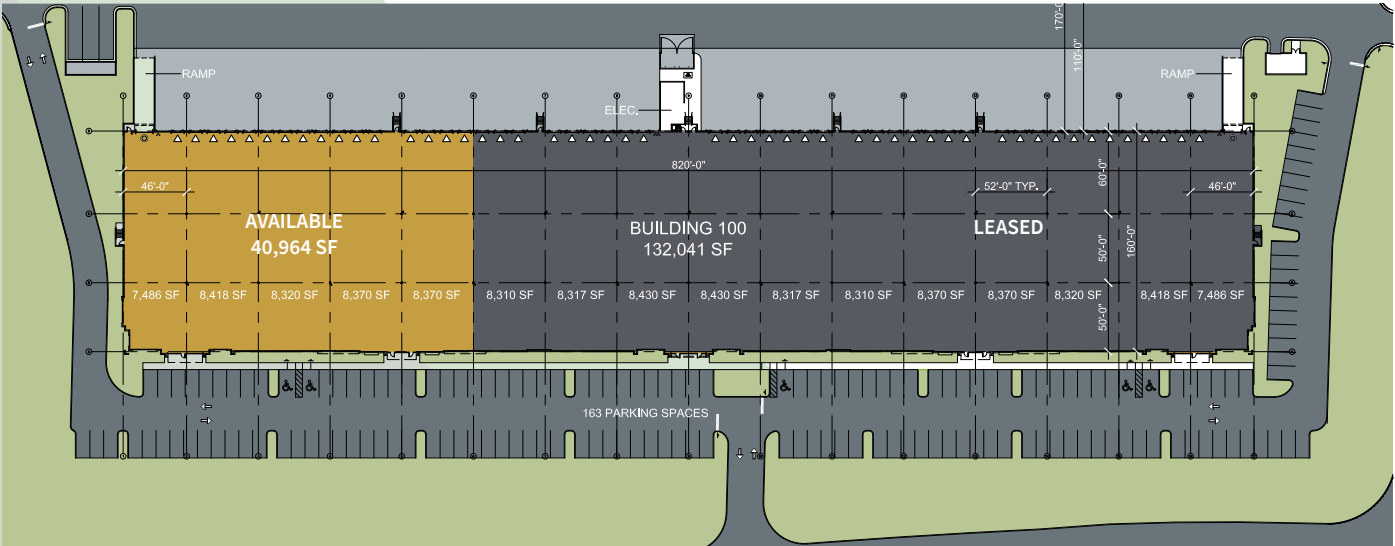

BUILDING 200 INFORMATION:

Space Available:	65,929 SF
Office Space:	3,097 SF
Total Building Size:	168,480 SF
Building Dimensions:	180' × 936'
Clear Height:	30'
Truck Court:	±170' (shared)
Car Parking:	179
Column Spacing:	52'w × 40'd with 60' staging bay
Loading:	Twenty-three (23) - 9' × 10' dock-high doors One (1) - 12'w × 14'h grade-level door
Electric:	3-phase
Sprinkler System:	ESFR sprinkler system
Available:	Now

Building 200
2041 S. County Line Road-, Plant City, FL

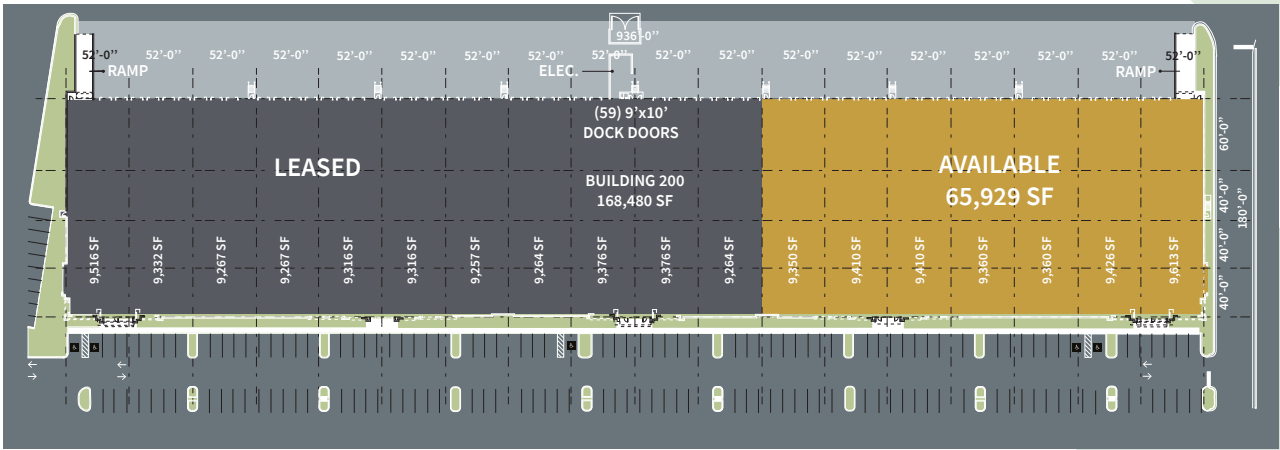



nuveen

REAL ESTATE

For more information, please contact:

John Dunphy, SIOR, CCIM

Executive Managing Director
johnc.dunphy@jll.com
+1 813 387 1312

Matt Sullivan, SIOR, CCIM

Executive Managing Director
matt.sullivan@jll.com
+1 407 930 1802

Wilson McDowell, SIOR, CCIM

Executive Managing Director
wilson.mcdowell@jll.com
+1 407 930 1801

Olivia Brock

Associate
olivia.brock@jll.com
+1 813 387 1320

Although information has been obtained from sources deemed reliable, neither Owner nor JLL makes any guarantees, warranties or representations, express or implied, as to the completeness or accuracy as to the information contained herein. Any projections, opinions, assumptions or estimates used are for example only. There may be differences between projected and actual results, and those differences may be material. The Property may be withdrawn without notice. Neither Owner nor JLL accepts any liability for any loss or damage suffered by any party resulting from reliance on this information. If the recipient of this information has signed a confidentiality agreement regarding this matter, this information is subject to the terms of that agreement. ©2023. Jones Lang LaSalle IP, Inc. All rights reserved.

