



OFFICES AT
StonePoint

A Workplace that Inspires Well-being



Jones Lang LaSalle Brokerage, Inc.
Real Estate License #: 01856260

One Adventist Health Way, Roseville

14,880 – 123,102 RSF Available

Class A Plug-and-Play Office For Lease





WELL Platinum
Certification



LEED
Certification



Find Space for Everything



Plug-N-Play
Office Space



1-Mile Outdoor
Walking Path



Extensive On-Site
Security Systems



Grab n Go Café



Fully Furnished with
High-End Furniture
and Tech



Easy Access to I-80
and Highway-65



Outdoor Patio Seating



Energy-Efficient Power
and HVAC Systems



Showers and Lockers



Parking Ratio 4.0/1,000 SF



EV Charging Stations



High Tech Conference
Facilities for 6-200 People



BUILDING AMENITIES

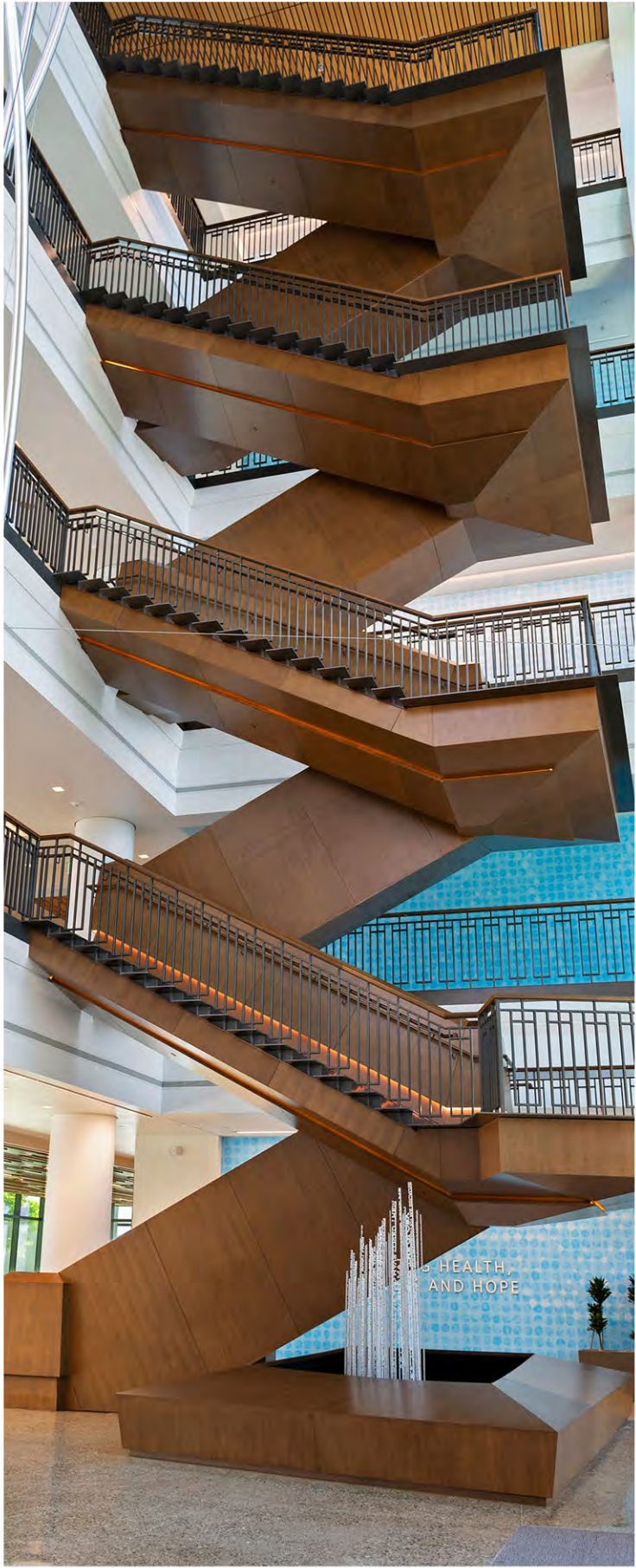



High Quality Suites Available

AVAILABILITIES



Suite 300

Suite 200

Suite 350

Suite 200

Suite 150

A private suite,
a full floor,
or multiple floors,
The Offices at
Stone Point has
the space for you

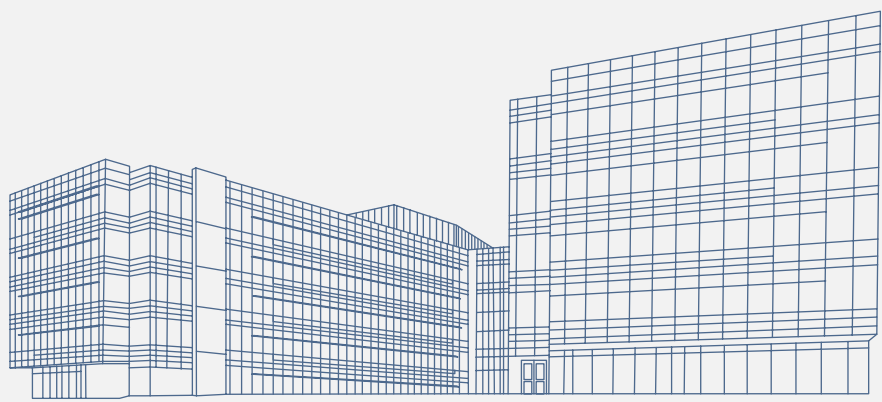

Suite 150	±14,880 RSF	Suite 300	±30,426 RSF
Suite 200	±58,747 RSF	Suite 350	±19,049 RSF
		Total SF Available	
		±123,102 RSF	

Suite 150

±14,880 RSF

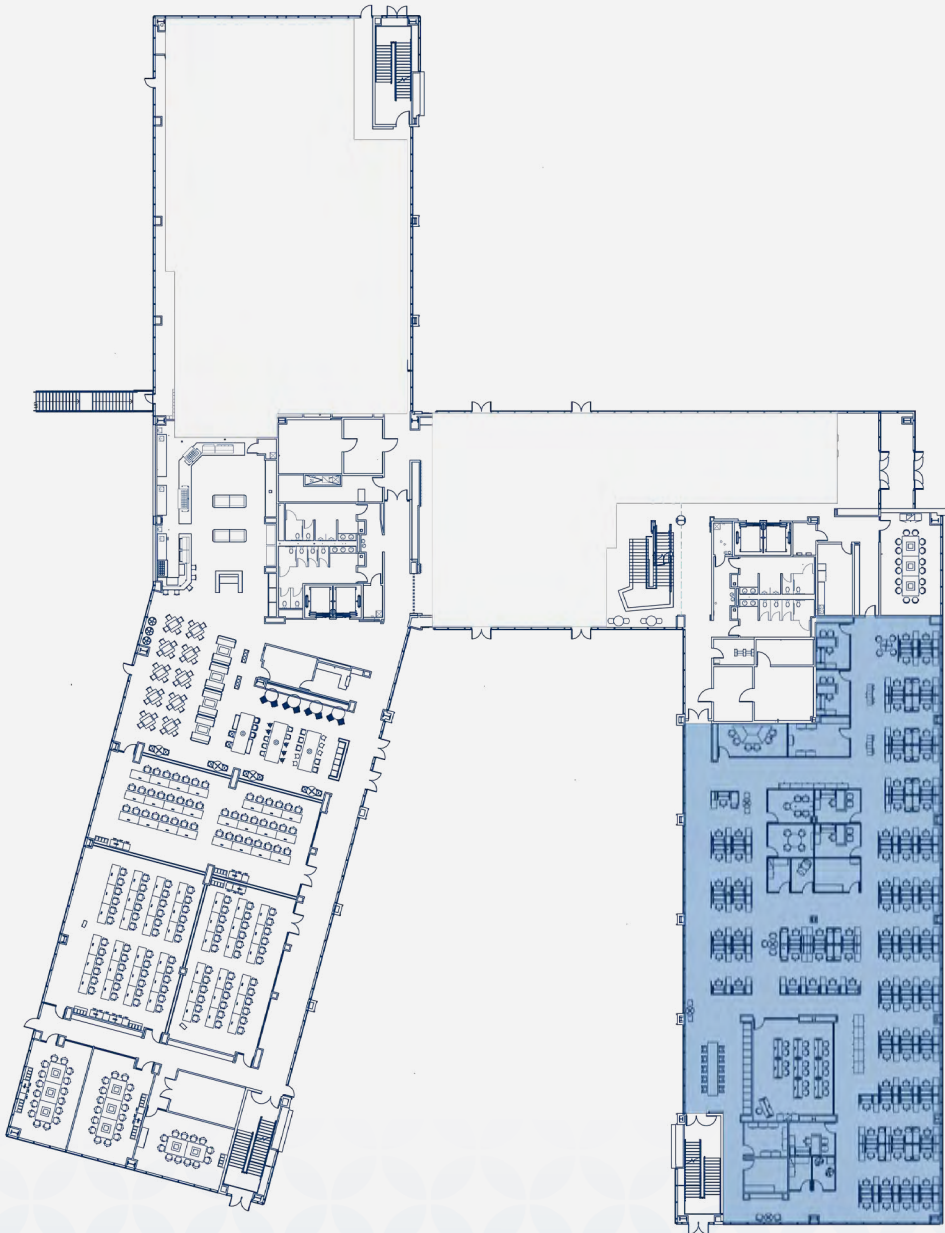

Suite 200

±58,747 RSF

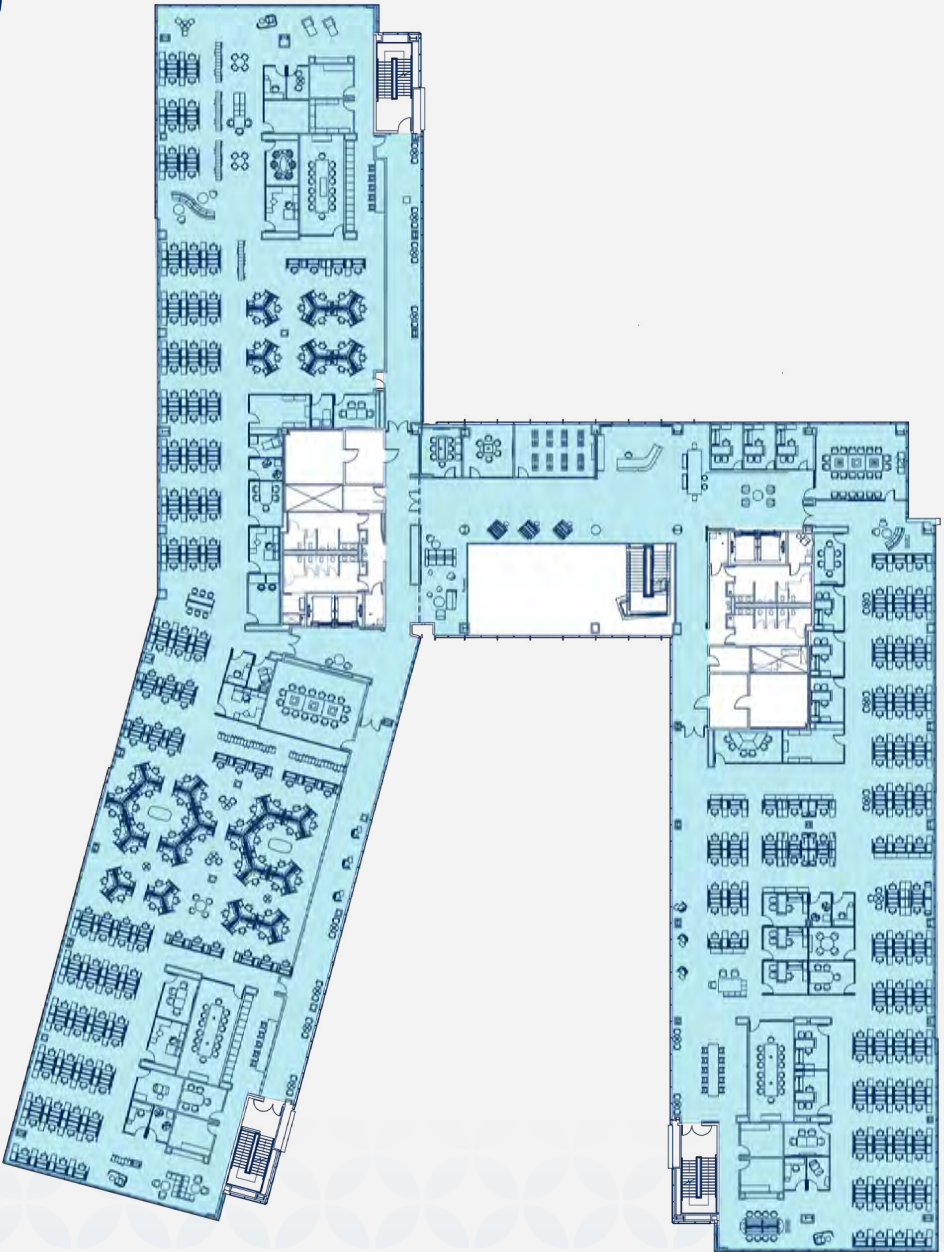

92

Desks



5

Private
Offices



5

Meeting
Rooms



1

All Hands/
Training
Room

Furniture and desk counts are approximate.



304

Desks



20

Private
Offices



20

Meeting
Rooms



5

Conference/
Training
Room

Furniture and desk counts are approximate.

Suite 300

±30,426 RSF

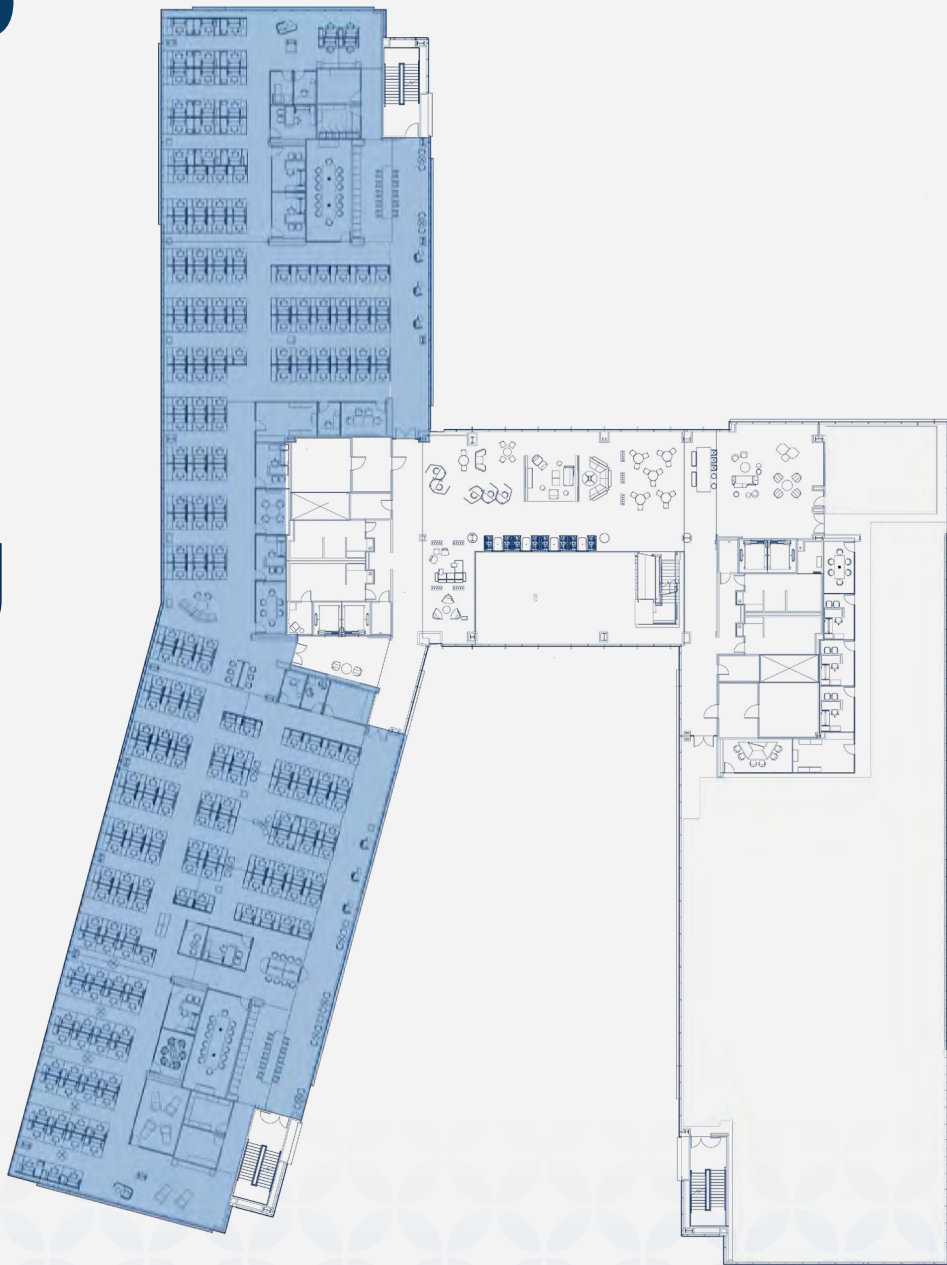

Suite 350

±19,049 RSF

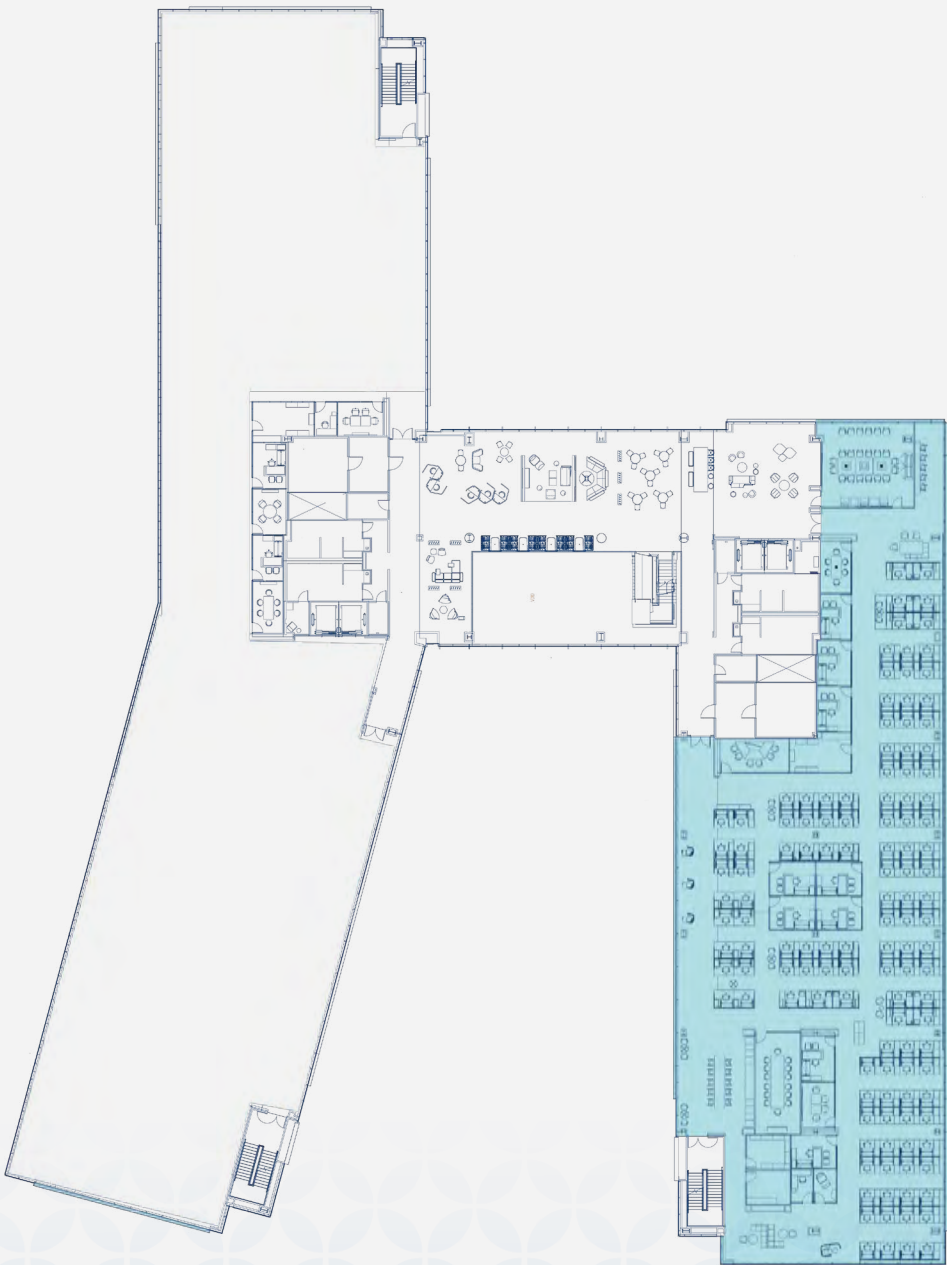

225

Desks



9

Private
Offices



9

Meeting
Rooms



4

Conference
Rooms

Furniture and desk counts are approximate.



124

Desks



9

Private
Offices



5

Meeting
Rooms



2

Conference
Rooms

Furniture and desk counts are approximate.



Love where you work

Roseville is packed with amenities.
Whether it's a breakfast meeting offsite, a Birthday lunch, a company happy hour, dinner with a client, last minute shopping, or a fun team bonding activity, you can find what you're looking for in the neighborhood.

Shopping

- 1 The Home Depot
- 2 Walmart Supercenter
- 3 Target
- 4 Raley's
- 5 Office Depot
- 6 Trader Joe's
- 7 Rite Aid Pharmacy
- 8 Whole Foods Market
- 9 Best Buy
- 10 Costco Wholesale
- 11 REI
- 12 Nordstrom Rack
- 13 Westfield Galleria

Entertainment

- 1 Regal UA Olympus Pointe
- 2 Sky Zone Trampoline Park
- 3 iFLY Indoor Skydiving
- 4 Roseville Golfand Sunsplash
- 5 Cinemark Roseville Galleria Mall and XD

Restaurants

- 1 In-N-Out Burger
- 2 Chicago Fire
- 3 Galpão Gaucho Brazilian Steakhouse
- 4 Mikuni | Roseville
- 5 The Original Mels Diner
- 6 Thai Basil Restaurant
- 7 Squeeze Burger
- 8 Brickyard Kitchen & Bar
- 9 Panera Bread
- 10 University of Beer - Roseville
- 11 Raising Cane's Chicken Fingers
- 12 BJ's Restaurant & Brewhouse
- 13 Dave & Buster's Roseville
- 14 Yard House
- 15 Pressed
- 16 Nick The Greek

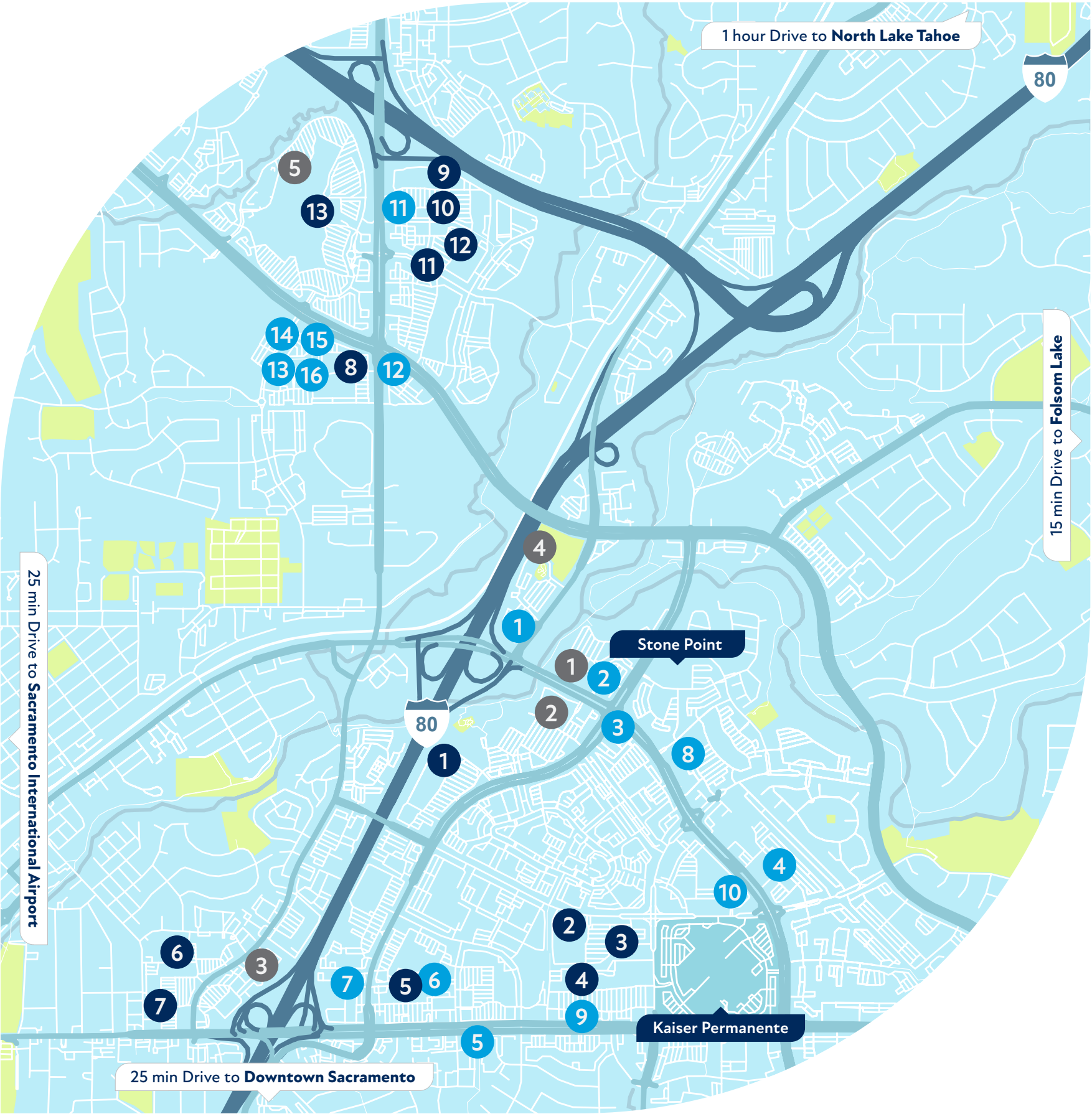

WHY ROSEVILLE?



154,635
Population



37.8
Median Age Range



45%
Bachelor's/Graduate/
Professional Degree



74.4%
White Collar Work Force



\$109,018
Median Household Income



23%
Population Growth since 2010



21%
Housing Growth since 2010

ROSEVILLE

SACRAMENTO
DOWNTOWN



25 MIN DRIVE

20 MIN AMTRAK

25 MIN DRIVE





OFFICES AT
StonePoint



Bernardo Hubbard
bernardo.hubbard@jll.com
+1 916 491 4322
Lisc # 02140127

Howard Hughes
howard.hughes@jll.com
+1 916 491 4335
Lisc # 01026782



Although information has been obtained from sources deemed reliable, neither Owner nor JLL makes any guarantees, warranties or representations, express or implied, as to the completeness or accuracy as to the information contained herein. Any projections, opinions, assumptions or estimates used are for example only. There may be differences between projected and actual results, and those differences may be material. The Property may be withdrawn without notice. Neither Owner nor JLL accepts any liability for any loss or damage suffered by any party resulting from reliance on this information. If the recipient of this information has signed a confidentiality agreement regarding this matter, this information is subject to the terms of that agreement. ©2023. Jones Lang LaSalle IP, Inc. All rights reserved. **The outbreak of the COVID-19 virus (novel coronavirus) since the end of January 2020 has resulted in market uncertainty and volatility. While the economic impact of a contagion disease generally arises from the uncertainty and loss of consumer confidence, its impact on real estate values is unknown at this stage.