

1388 Kifer Rd

Sunnyvale, CA 94086

±88,924 SF

Divisible by Floor



SUBLEASE





Property Highlights

- Available Now
- Fully Plug N Play
- LED: April 30, 2027
- Market Ready Improvements Complete
- ±88,924 SF Class A Office / R&D 3-Story Building
- Credit Sublessor
- Direct Deal with Landlord Available
- Monument & Building Signage
- 11' Drop Ceiling with 16' Clear Height on the Ground Floor
- Large Cafe & Outdoor Collaboration Area
- Showers
- 2 Elevators (1 with Freight Capacity)
- Shipping / Receiving with Roll-Up Door
- Back-Up Generator: - 300kW WQ w/ 417 HP Motor, 550 Gallon Tank, 600 Amp Transfer Switch
- ±3.62/1,000 Parking
- 2,000 Amps @ 277/480 Volts
- Multiple Fiber Providers - On-Site Century
- Link Colocation Center
- Across the Street from Bay Club Santa Clara
- Caltrain Shuttle Across the Street

FIRST FLOOR

±29,321 SF

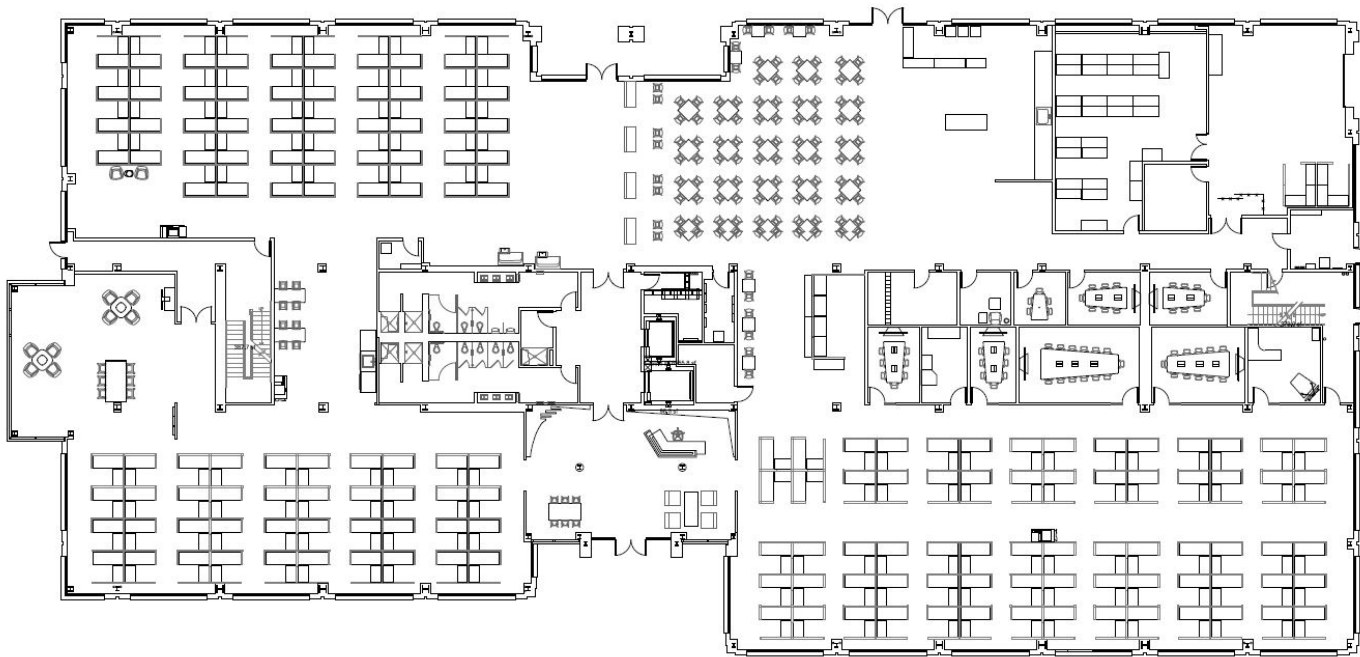

Contact

Conor Flannery

Executive Managing Director

T: 650 480 2207

M: 650 400 6021

Conor.Flannery@jll.com

RE Lic # 01434412

Soroush Aboutalebi

Associate

T: 650 480 2163

M: 925 212 5620

Soroush.Aboutalebi@jll.com

RE Lic # 02180627

1388 KIFER RD

Sunnyvale, CA 94086

SECOND FLOOR

±29,695 SF

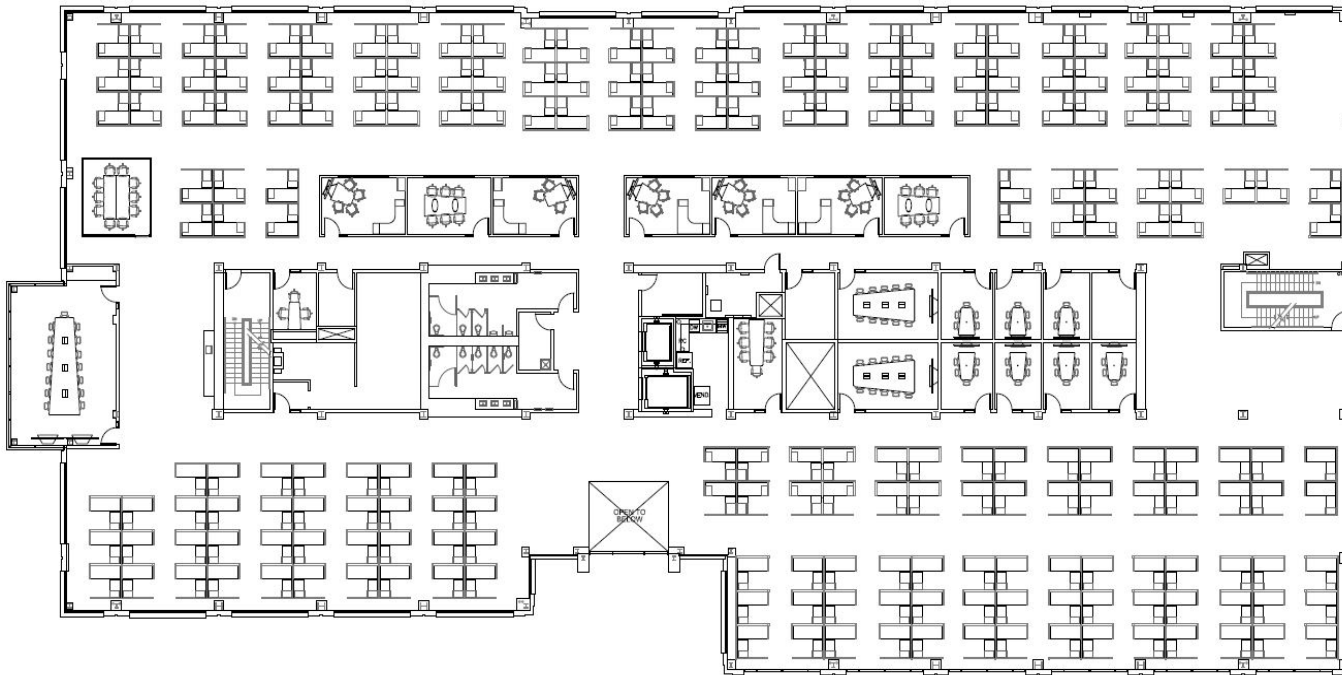

Contact

Conor Flannery

Executive Managing Director

T: 650 480 2207

M: 650 400 6021

Conor.Flannery@jll.com

RE Lic # 01434412

Soroush Aboutalebi

Associate

T: 650 480 2163

M: 925 212 5620

Soroush.Aboutalebi@jll.com

RE Lic # 02180627

1388 KIFER RD

Sunnyvale, CA 94086

THIRD FLOOR

±29,904 SF

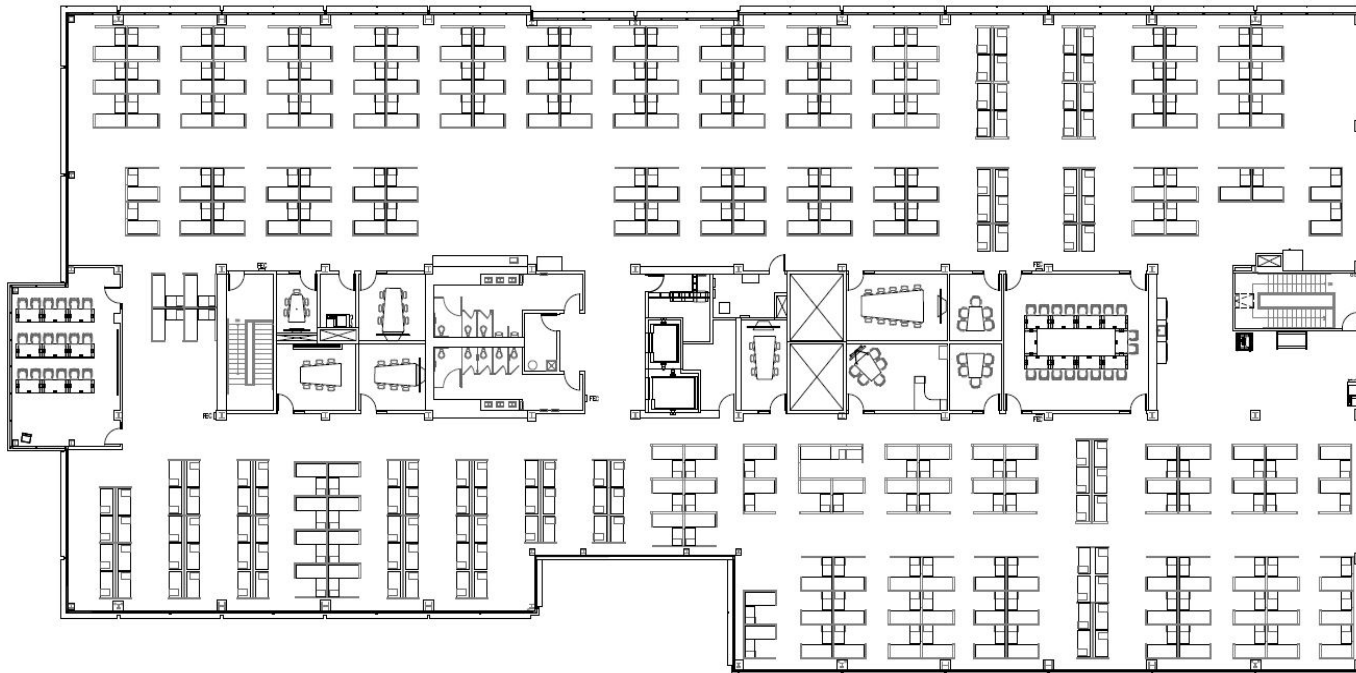

Contact

Conor Flannery

Executive Managing Director

T: 650 480 2207

M: 650 400 6021

Conor.Flannery@jll.com

RE Lic # 01434412

Soroush Aboutalebi

Associate

T: 650 480 2163

M: 925 212 5620

Soroush.Aboutalebi@jll.com

RE Lic # 02180627

1388 KIFER RD

Sunnyvale, CA 94086

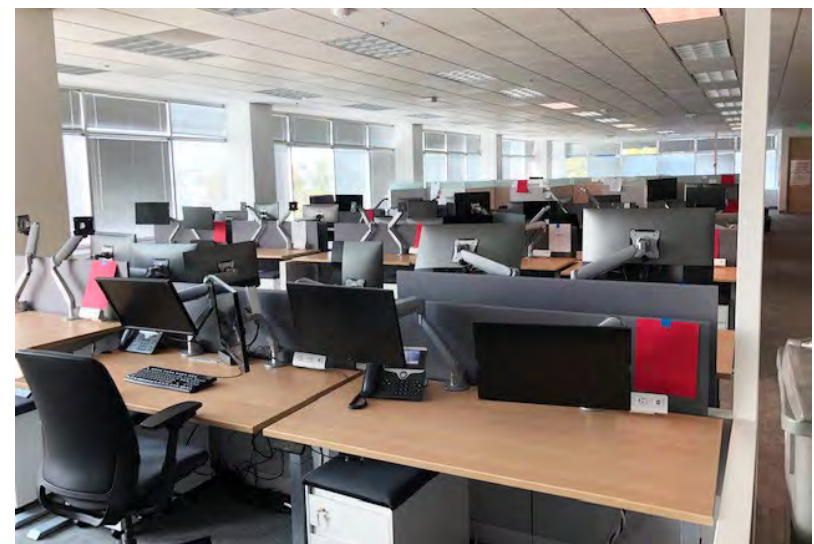
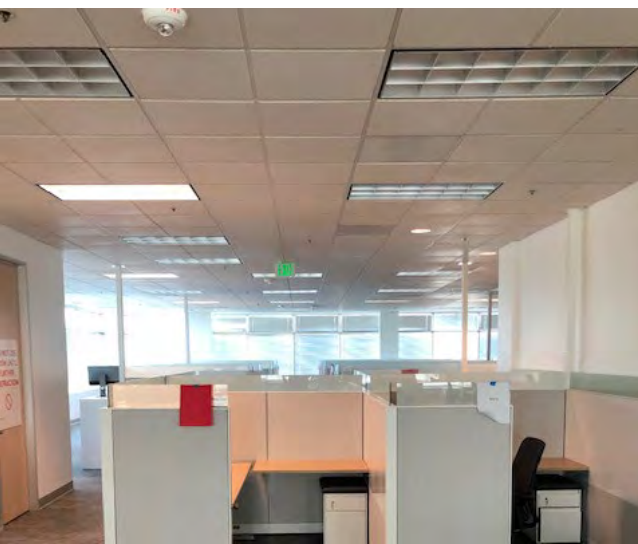

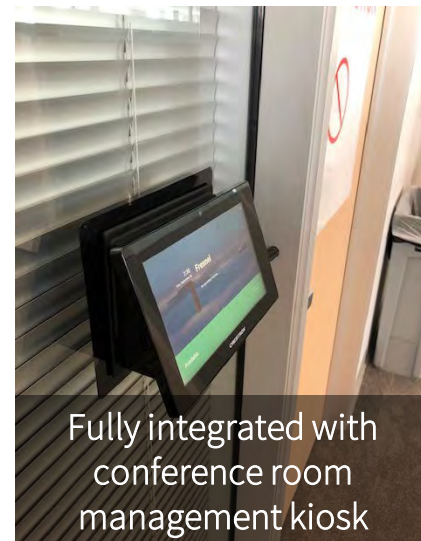

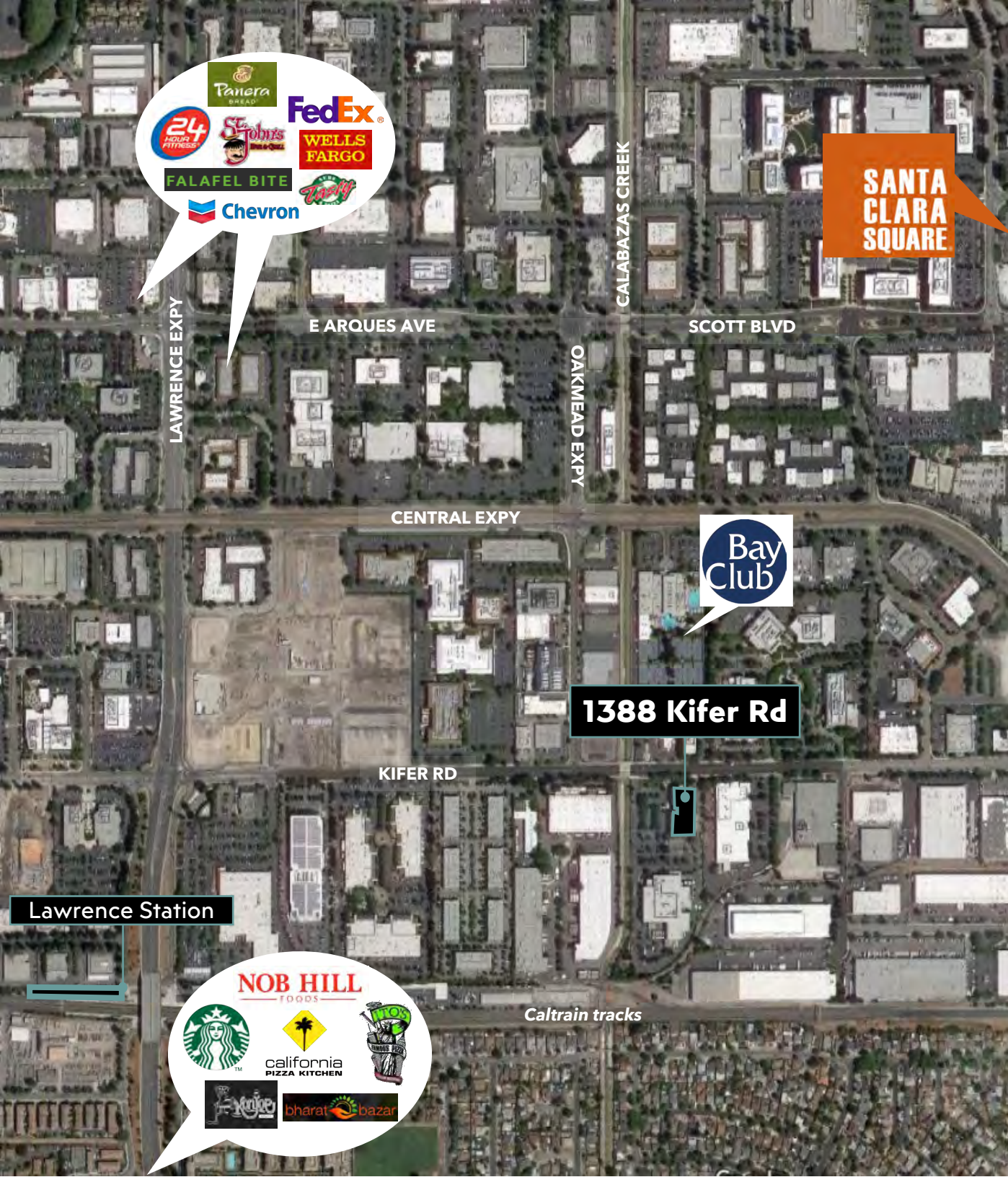

Contact

Conor Flannery

Executive Managing Director

T: 650 480 2207

M: 650 400 6021

Conor.Flannery@jll.com

RE Lic # 01434412

Soroush Aboutalebi

Associate

T: 650 480 2163

M: 925 212 5620

Soroush.Aboutalebi@jll.com

RE Lic # 02180627



Jones Lang LaSalle Brokerage Inc.

RE Lic # 01856260

Although information has been obtained from sources deemed reliable, neither Owner nor JLL makes any guarantees, warranties or representations, express or implied, as to the completeness or accuracy as to the information contained herein. Any projections, opinions, assumptions or estimates used are for example only. There may be differences between projected and actual results, and those differences may be material. The Property may be withdrawn without notice. Neither Owner nor JLL accepts any liability for any loss or damage suffered by any party resulting from reliance on this information. If the recipient of this information has signed a confidentiality agreement regarding this matter, this information is subject to the terms of that agreement. ©2022 Jones Lang LaSalle IP, Inc. All rights reserved.