

PLUG & PLAY SUBLEASE

4035

S. RIVERPOINT PARKWAY | PHOENIX



CLASS A BUILDING

Immediately Available for Sublease



Jones Lang LaSalle Brokerage, Inc. RE lic. #CO508577000



±88,869 SF
for sublease

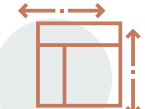

±165,851 SF
building



FLOORS 3, 4 & 5 AVAILABLE
floor sizes from ±29,602 - 29,662 SF



MARCH 31, 2031
Lease expiration

PROJECT HIGHLIGHTS



±570
Cubicles



ACCESS
via full diamond -
32nd St. & I-10



7/1,000
PARKING RATIO
In adjacent surface lot and
parking structure



3.1M PEOPLE
within a 30 minute drive time



CLASS A CAMPUS
with maintained
lush landscape



FLOOR THREE

±29,662 SF | ±191 CUBICLES

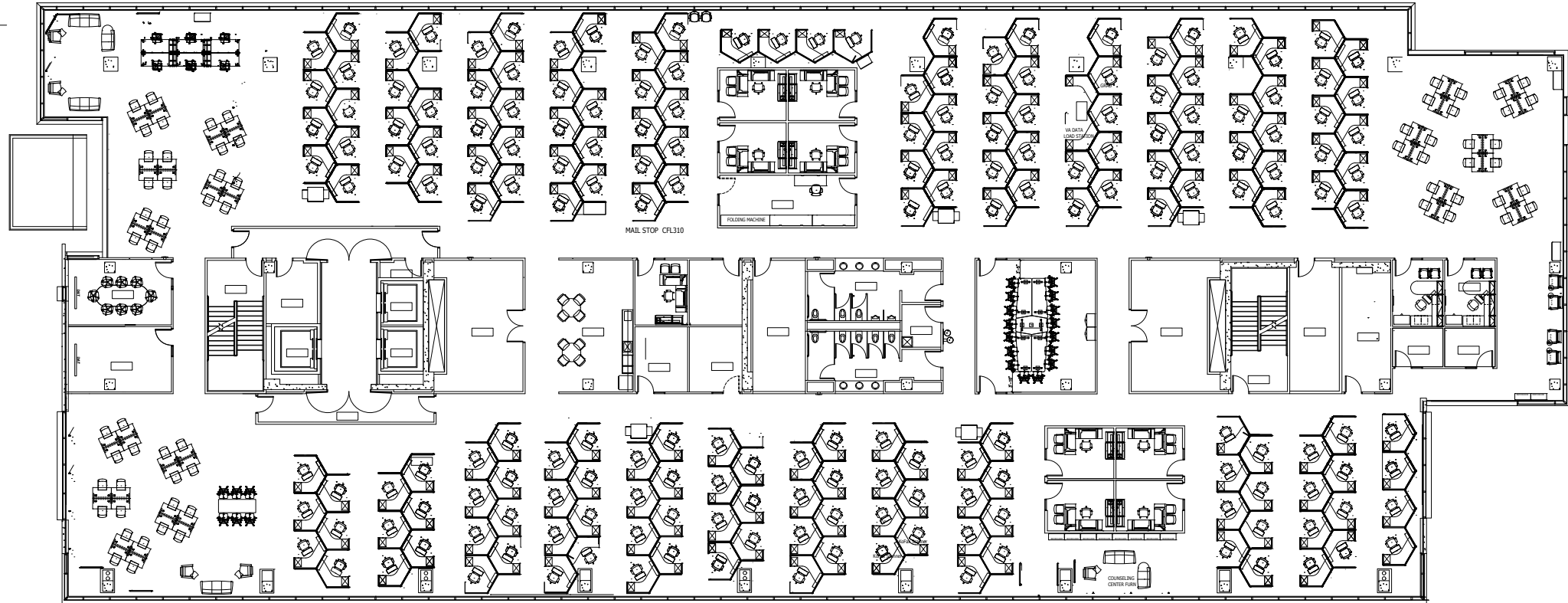

PLUG & PLAY /
±191 CUBES



INTERIOR
OFFICES



RESTROOM CORE
& BREAKROOM

FLOOR FOUR

±29,605 SF | ±149 CUBICLES

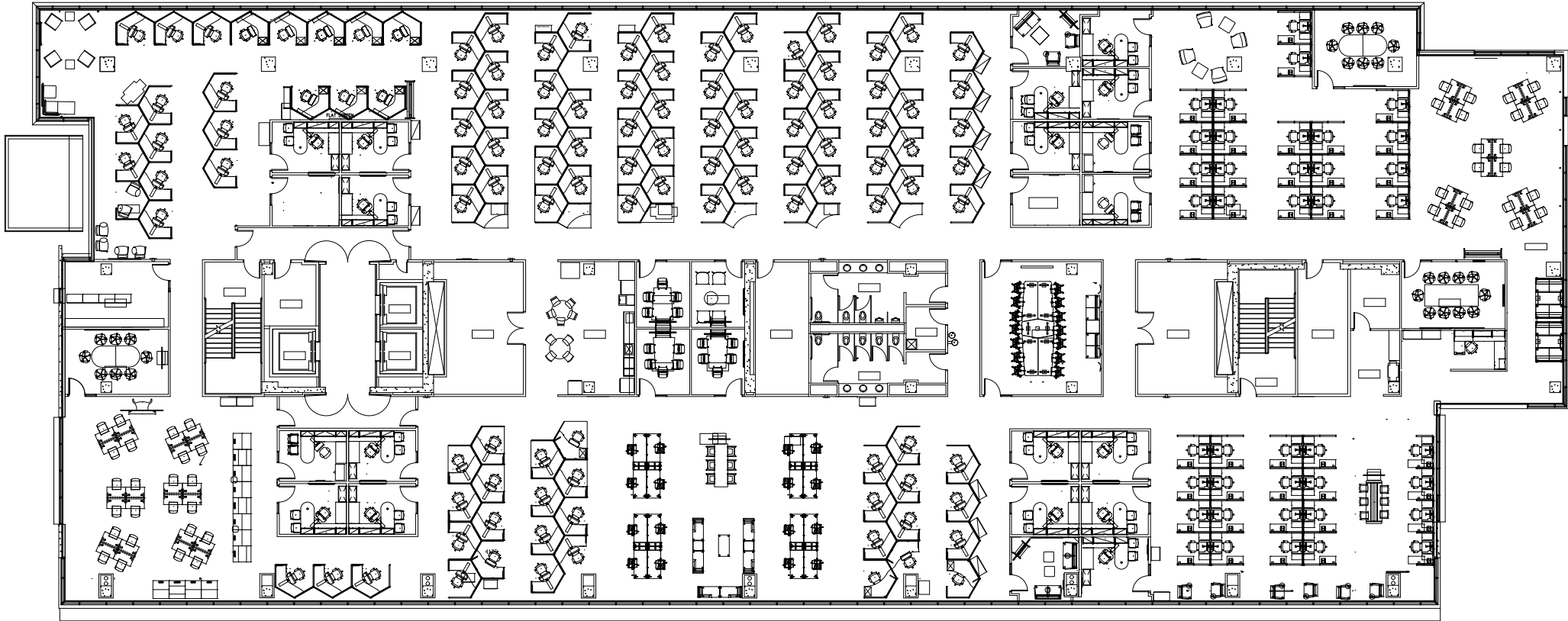

PLUG & PLAY /
±149 CUBES



INTERIOR
OFFICES



RESTROOM CORE
& BREAKROOM

FLOOR FIVE

±29,602 SF | ±230 CUBICLES

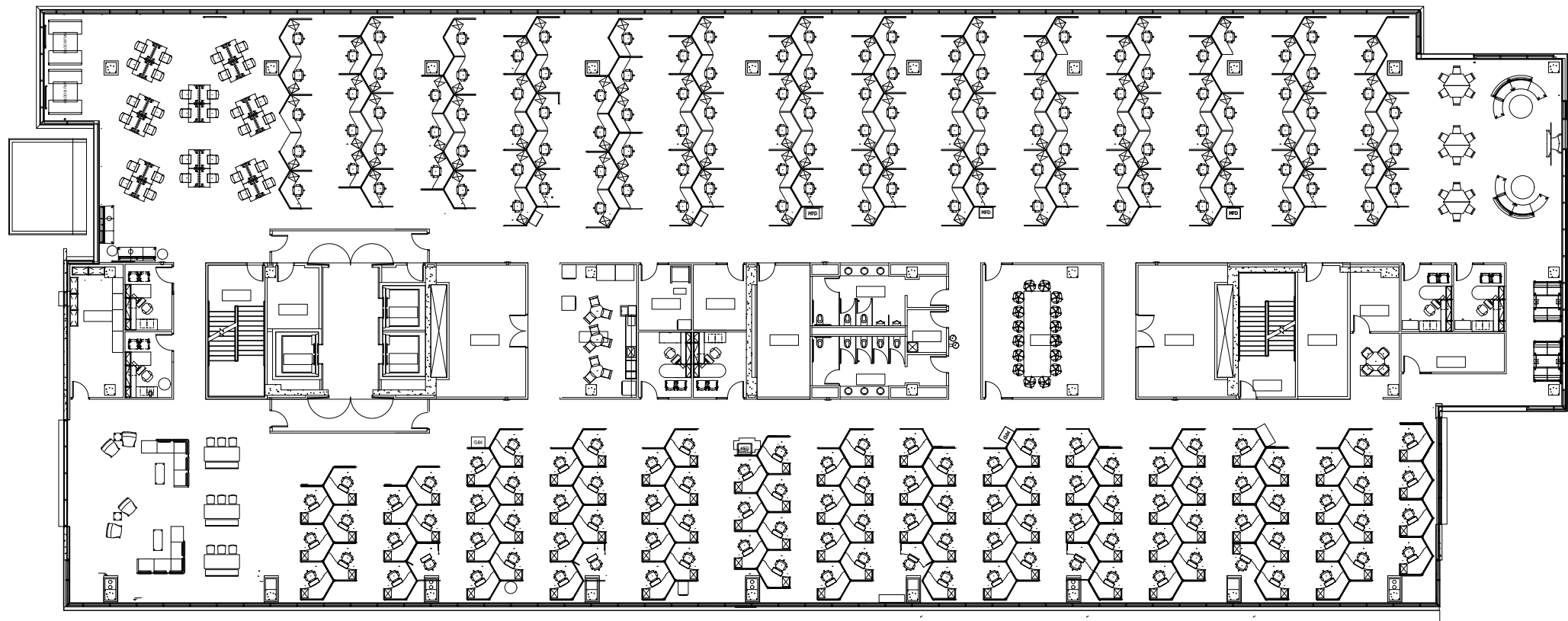

PLUG & PLAY /
±230 CUBES



INTERIOR
OFFICES



RESTROOM CORE
& BREAKROOM



Existing Cubicles in Place



Break Room



Shared Lobby



Shared Amenity Space



4035

S. RIVERPOINT PARKWAY | PHOENIX

Although information has been obtained from sources deemed reliable, neither Owner nor JLL makes any guarantees, warranties or representations, express or implied, as to the completeness or accuracy as to the information contained herein. Any projections, opinions, assumptions or estimates used are for example only. There may be differences between projected and actual results, and those differences may be material. The Property may be withdrawn without notice. Neither Owner nor JLL accepts any liability for any loss or damage suffered by any party resulting from reliance on this information. If the recipient of this information has signed a confidentiality agreement regarding this matter, this information is subject to the terms of that agreement. ©2023. Jones Lang LaSalle IP, Inc. All rights reserved.

Mark Gustin, SIOR, CCIM

+1 602 282 6316

mark.gustin@jll.com

Jimmy Cornish

+1 602 282 6363

jimmy.cornish@jll.com



Jones Lang LaSalle Brokerage, Inc. RE lic. #01856260