



4501 N Sheridan
Uptown, Chicago, IL

Up to 3,976 SF Available



4501 N Sheridan offers ground floor retail opportunities with dedicated parking at the base of a 59-unit residential development in Chicago’s rapidly transitioning Uptown neighborhood.



3,976 SF
Space Available

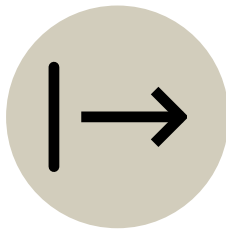

89’ 3”
Frontage on
Sunnyside Ave

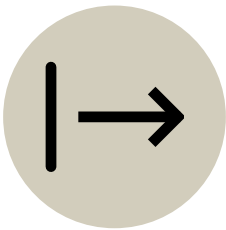

85’
Frontage on
Sheridan Road

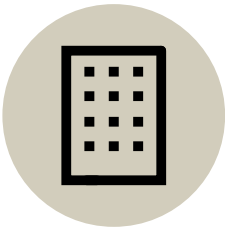

59
Residential Units



36
Surface Parking Spaces



Now Available
New Construction

Demographics

	0.5 miles	1 miles	1.5 mile
Total Population	29,006	76,839	143,339
Daytime Population	22,339	51,460	99,205
Avg Household Income	\$89,080	\$107,929	\$123,015
Households	15,718	43,893	80,181

Site Plan

Can combine for 2,976 SF

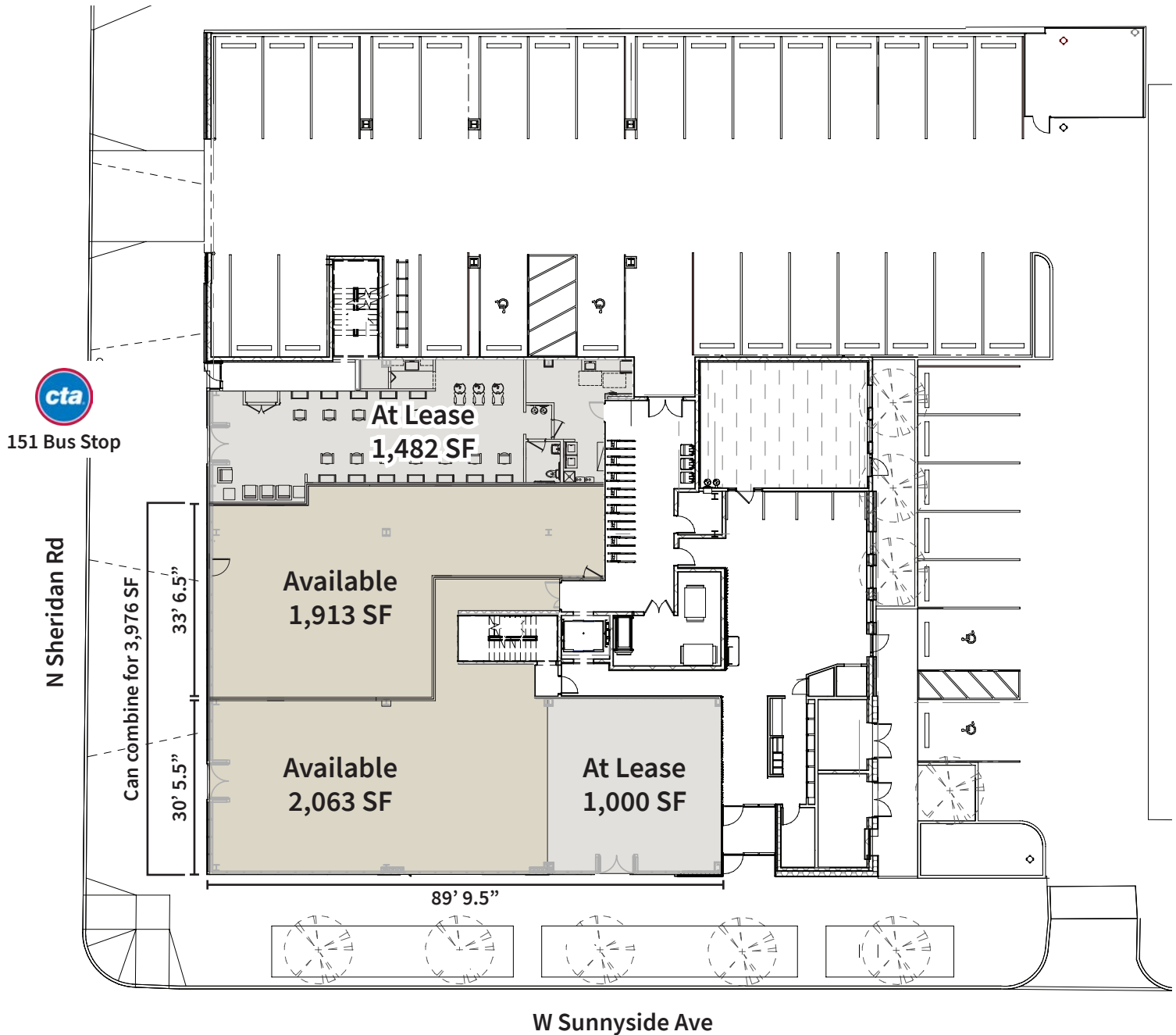

Steve Schwartz
Senior Vice President
+1 312 228 2157
Steve.Schwartz@jll.com

Jose Gonzalez
Executive Vice President
+1 312 228 2155
Jose.O.Gonzalez@jll.com



Although information has been obtained from sources deemed reliable, JLL does not make any guarantees, warranties or representations, express or implied, as to the completeness or accuracy as to the information contained herein. Any projections, opinions, assumptions or estimates used are for example only. There may be differences between projected and actual results, and those differences may be material. JLL does not accept any liability for any loss or damage suffered by any party resulting from reliance on this information. If the recipient of this information has signed a confidentiality agreement with JLL regarding this matter, this information is subject to the terms of that agreement. ©2023. Jones Lang LaSalle IP, Inc. All rights reserved.