

# 18 55

DORNOCH COURT

20k - 25k SF  
Sublease

2-3 Year  
Lease Term!

## ± 20,000 to 25,000 SF For Sublease Functional Warehouse / Distribution Space



Jones Lang LaSalle Brokerage, Inc.  
RE lic. #01856260

Joe Anderson  
Managing Director  
858.410.6360  
joe.anderson@jll.com  
RE Lic. #01509782

Joe Bernstein  
Managing Director  
858.410.1225  
joe.bernstein@jll.com  
RE Lic. #01304775

Hunter Ancich  
Associate  
562.201.4929  
hunter.ancich@jll.com  
RE Lic. #02145207

[Click Here For  
Video Tour](#)

# 18 55

DORNOCH COURT







# 18 55

DORNOCH COURT

## Building Features

± 20,000 - 25,000 SF For Sublease | Available Now



26' - 28' Clear Height



Major Project & Space  
Renovations in 2021



Additional Trailer Parking



87,460 SF



Access to 2-3 loading doors,  
subject to mutually agreed  
plan



60' x 40'  
Column Spacing



Heavy Power - 2,000 Amps  
277 / 480v, expandable to  
7,775 Amps (to be verified)



Easy Access To  
SR-905 / I-5 / I-805 / SR-11



ESFR Sprinklers



Location In The Foreign  
Trade Zone



2.0 / 1,000 SF Parking Ratio



Fenced Yard, Secure  
Truck Court



Below-Market Asking Rate:  
\$1.15/SF NNN



Lease Expiration Date:  
10/31/2029



Potential For  
C-T PAT Certification



Labor potentially available  
at additional cost



# 1855

DORNOCH COURT

## Site Plan

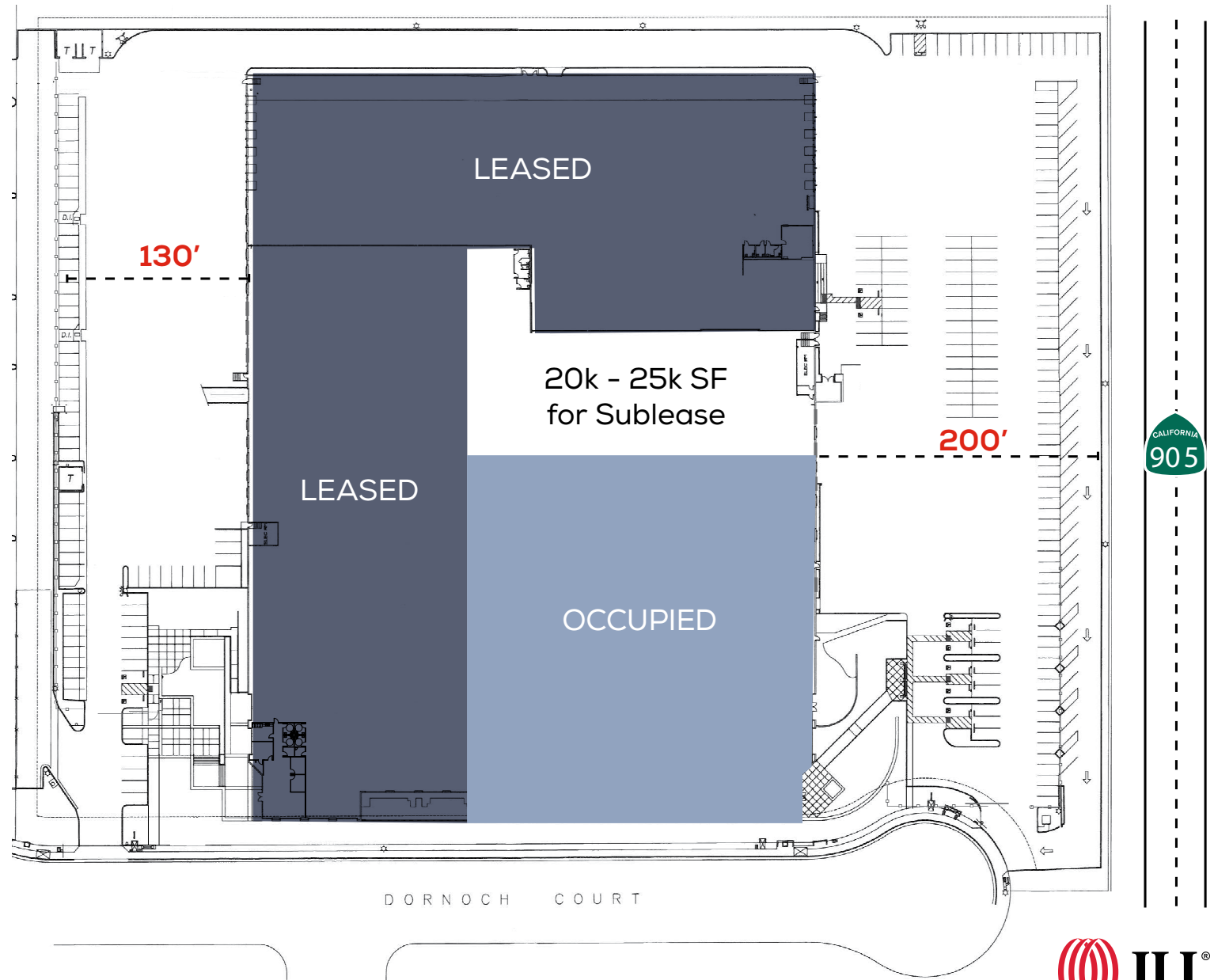

# 18 55

DORNOCH COURT

## Location Features

- Direct freeway access from 3 off-ramps (SR 905 @ La Media, SR905 @ Siempre Viva Road, and SR 11 @ Enrico Fermi)
- Freeway frontage
- Located in the Foreign Trade Zone (FTZ)
- Improved Infrastructure with SR-905, SR-125, and SR-11
- South San Diego County abundant labor supply

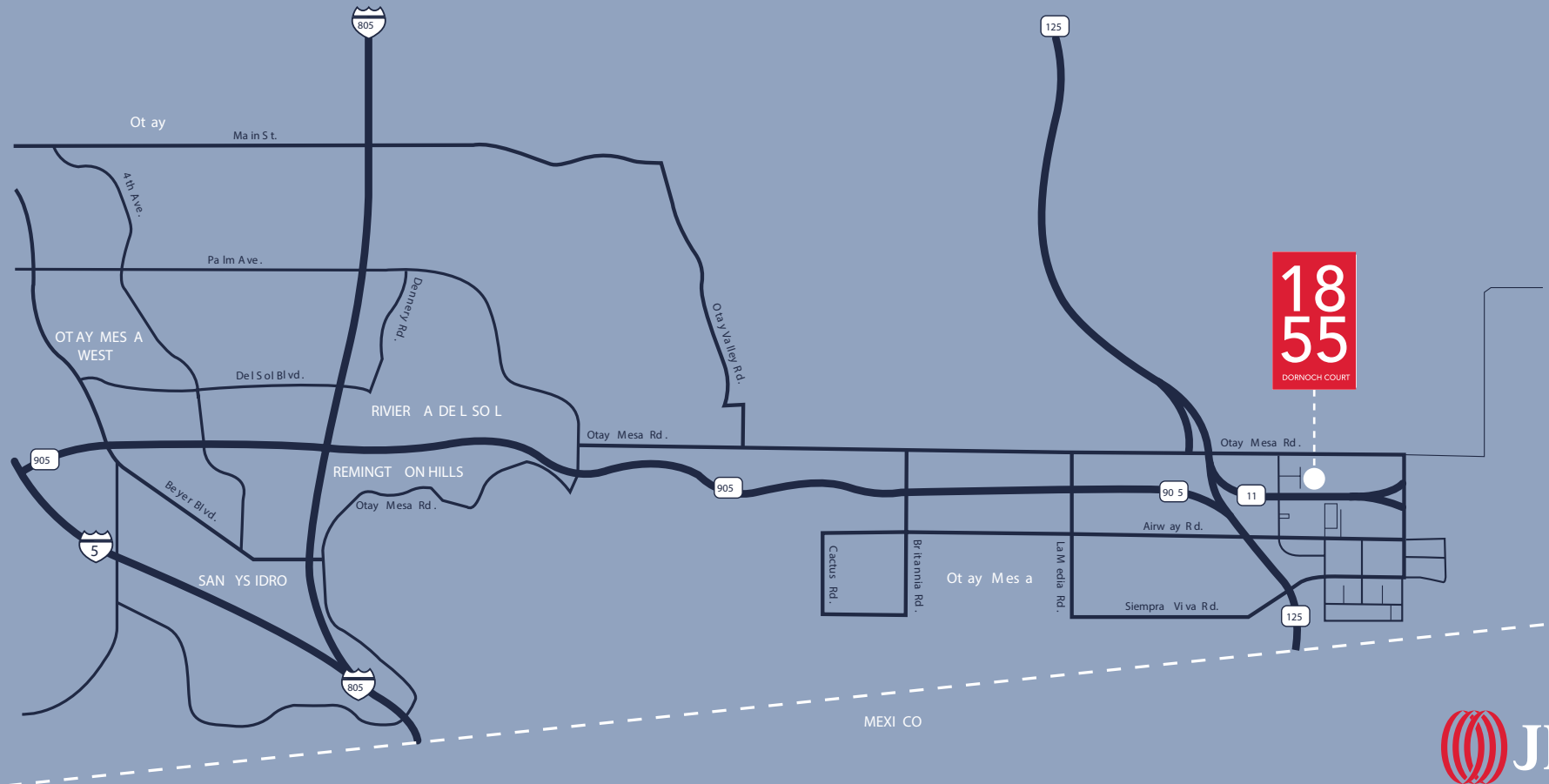



18  
55  
DORNOCH COURT

Pacific Ocean

Coronado

San Diego Intl Airport  
Downtown San Diego

BAE SYSTEMS

UTC Aerospace Systems

INTERSTATE  
5

GENERAL DYNAMICS

Solar Turbines  
A Caterpillar Company

BAE SYSTEMS

SPAWAR

INTERSTATE  
805

plantronics

OM  
Owens  
Illinois

GENERAL DYNAMICS

Brown Field  
Airport

Honeywell

Johnson & Johnson

Cross Border  
Terminal

MAD  
ENGINE

Airway Rd

BD

BOSE

ups

WHALEN

CALIFORNIA  
125

CALIFORNIA  
905

METTLER TOLEDO  
BALBOA  
Water Group

Otay Mesa Rd

CALIFORNIA  
905

Panasonic

CALIFORNIA  
11

18  
55  
DORNOCH COURT

JLL®

Future  
Amazon

FedEx

SHARP

FedEx

MAD  
ENGINE

IRON MOUNTAIN

GENERAL DYNAMICS

TJ Intl  
Airport

Otay Mesa  
Port of Entry

International Border

International Border

# 18 55

DORNOCH COURT

|              |                |
|--------------|----------------|
| Total size   | ± 20k - 25k SF |
| Dock doors   | 2-3            |
| Clear Height | 26' - 28'      |
| Sprinklers   | ESFR           |

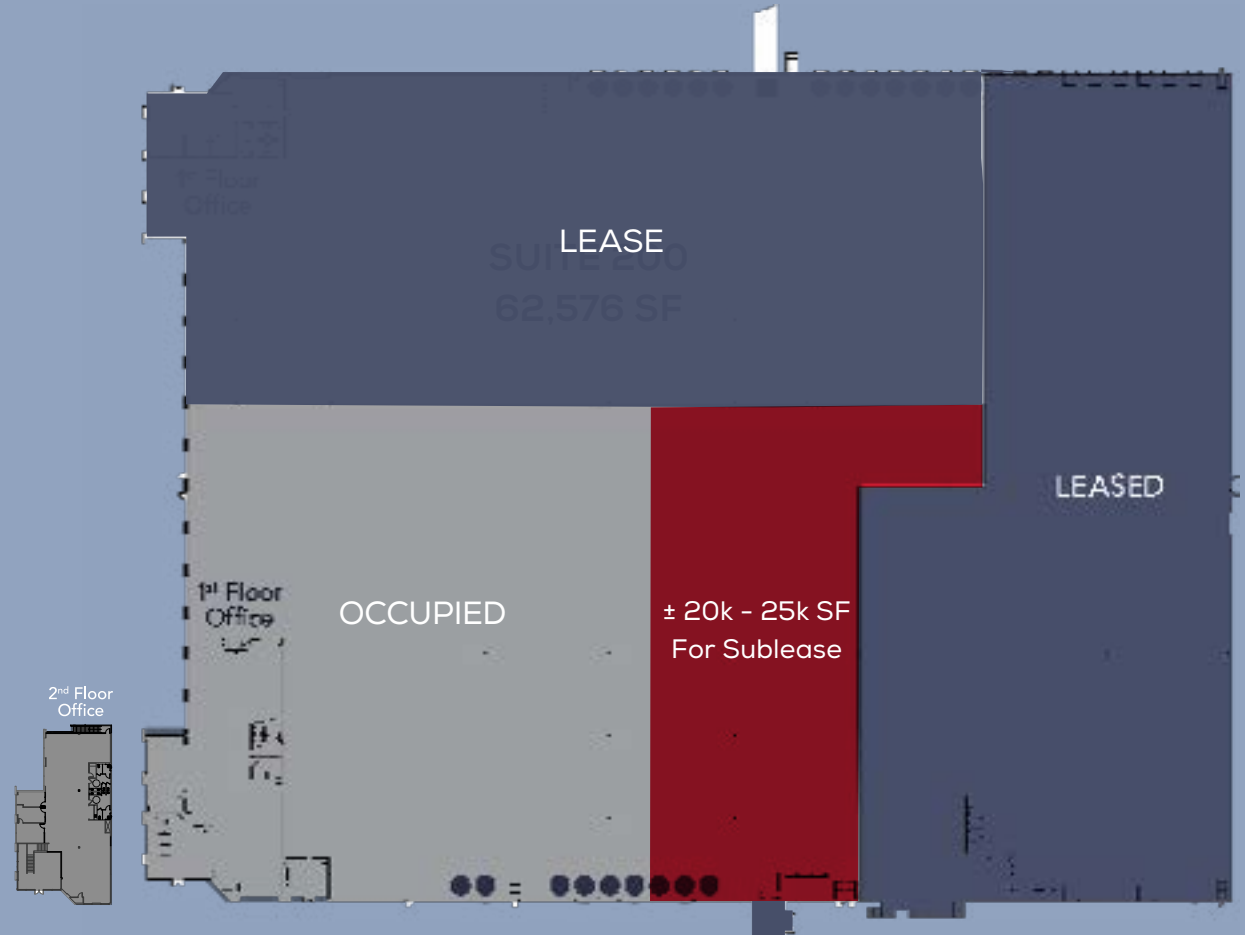

Dock high doors





18  
55

DORNOCH COURT



26' - 28' Clear Height



# 18 55

DORNOCH COURT



# 18 55

DORNOCH COURT



Newly Renovated Office





# 18 55

DORNOCH COURT



Joe Anderson  
Managing Director  
858.410.6360  
joe.anderson@jll.com  
RE Lic. #01509782

Joe Bernstein  
Managing Director  
858.410.1225  
joe.bernstein@jll.com  
RE Lic. #01304775

Hunter Ancich  
Associate  
562.201.4929  
hunter.ancich@jll.com  
RE Lic. #02145207

Although information has been obtained from sources deemed reliable, neither Owner nor JLL makes any guarantees, warranties or representations, express or implied, as to the completeness or accuracy as to the information contained herein. Any projections, opinions, assumptions or estimates used are for example only. There may be differences between projected and actual results, and those differences may be material. The Property may be withdrawn without notice. Neither Owner nor JLL accepts any liability for any loss or damage suffered by any party resulting from reliance on this information. If the recipient of this information has signed a confidentiality agreement regarding this matter, this information is subject to the terms of that agreement. ©2023 Jones Lang LaSalle IP, Inc. All rights reserved.