

[333]  
ROUTE 46  
MOUNTAIN LAKES

MEDICAL  
SUITES  
AVAILABLE  
FOR  
LEASE

Join

AdvancED  
Urgent Care



at this  
prime location!



All tenants receive prominent  
signage along Route 46



## Building Highlights

- One of the only medical and office buildings located in Mountain Lakes
- Join Atlantic Health System's AdvancED Urgent Care, Oncology & Hematology Specialists of Morris County, Princeton Radiology and Medical Park Imaging
- Recently renovated new grand entrance with grand center staircase
- Exterior building façade improvements completed
- Abundant parking
- Existing generators with excess capacity
- Common covered tailboard loading docks



## Available Space

Floor	RSF	Availability	Rent
1	5,111 RSF	4/1/2023 or sooner	\$22.75 + Utilities
2	1,348 RSF	Immediate	\$22.75 + Utilities
2	1,994 RSF	Immediate	\$22.75 + Utilities
2	3,241 RSF	Immediate	\$22.75 + Utilities
2	13,704 RSF	Immediate	\$22.75 + Utilities





## Location

- Conveniently located on Route 46 West bound
- Easy access to Interstate 80, the Garden State Parkway, Interstates 280, 287, Route 2 and 23
- Only 1 mile to downtown Denville – restaurants and shopping
- Less than 2 miles from Saint Clare's Hospital

## First Floor Plan

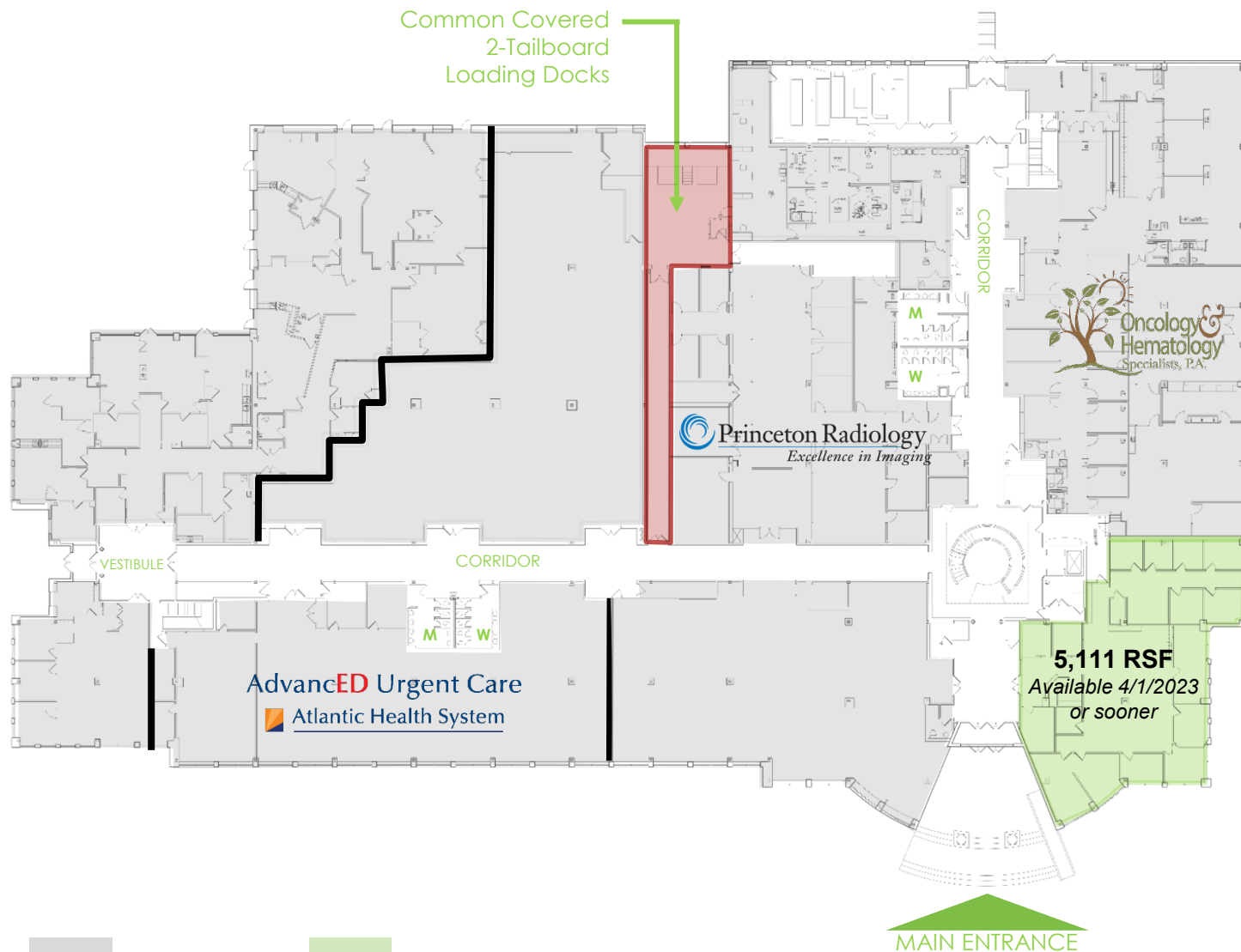

## Second Floor Plan

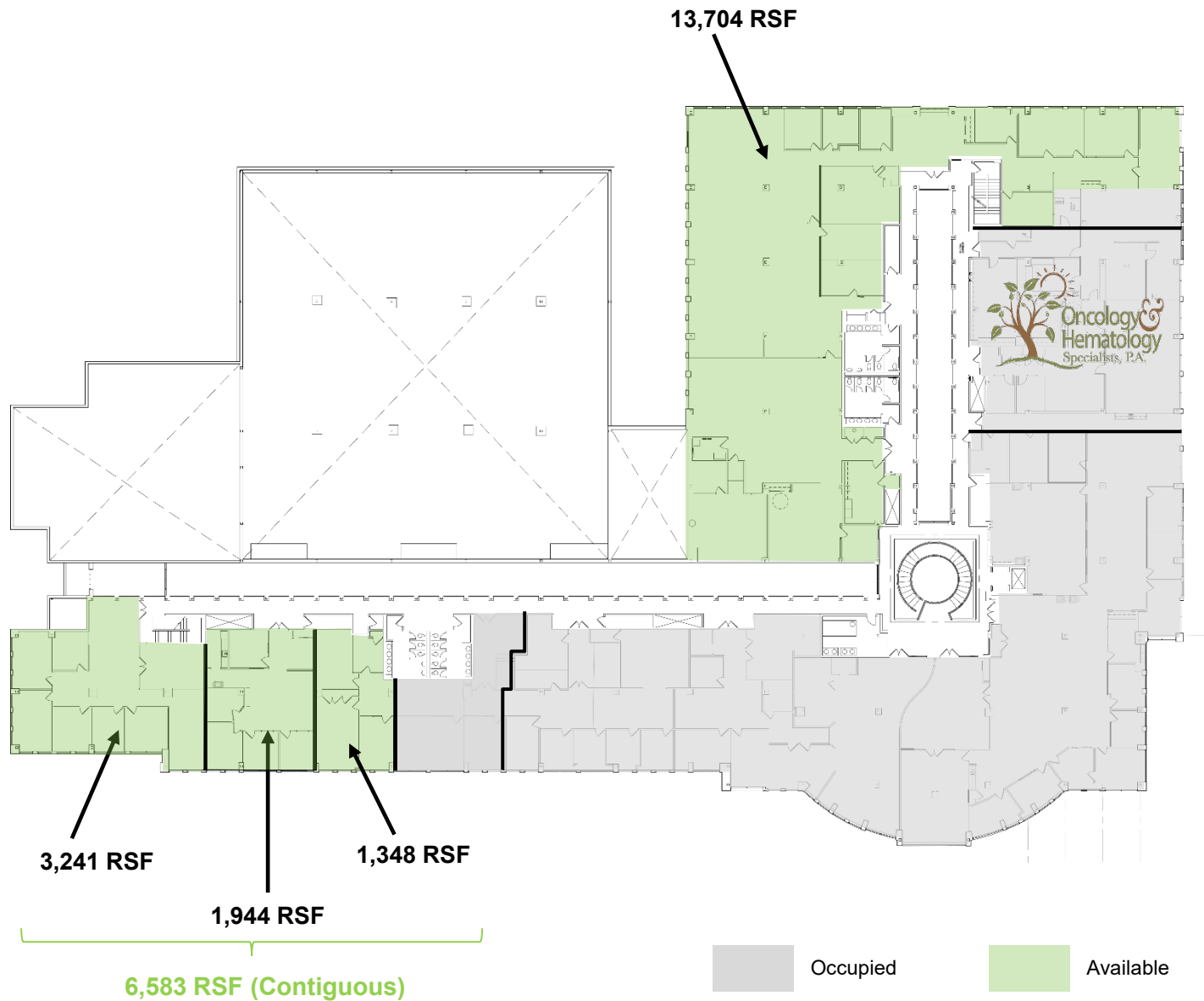



## Downtown Denville Amenities Map



# [333]

## ROUTE 46

MOUNTAIN LAKES

Conveniently located on Route 46 West bound

Easy access to Interstate 80, the Garden State Parkway, Interstates 280, 287, Route 2 and 23

1 mile to downtown Denville

28 miles to Newark Liberty International Airport

30 miles to Manhattan

## Local and Regional Map

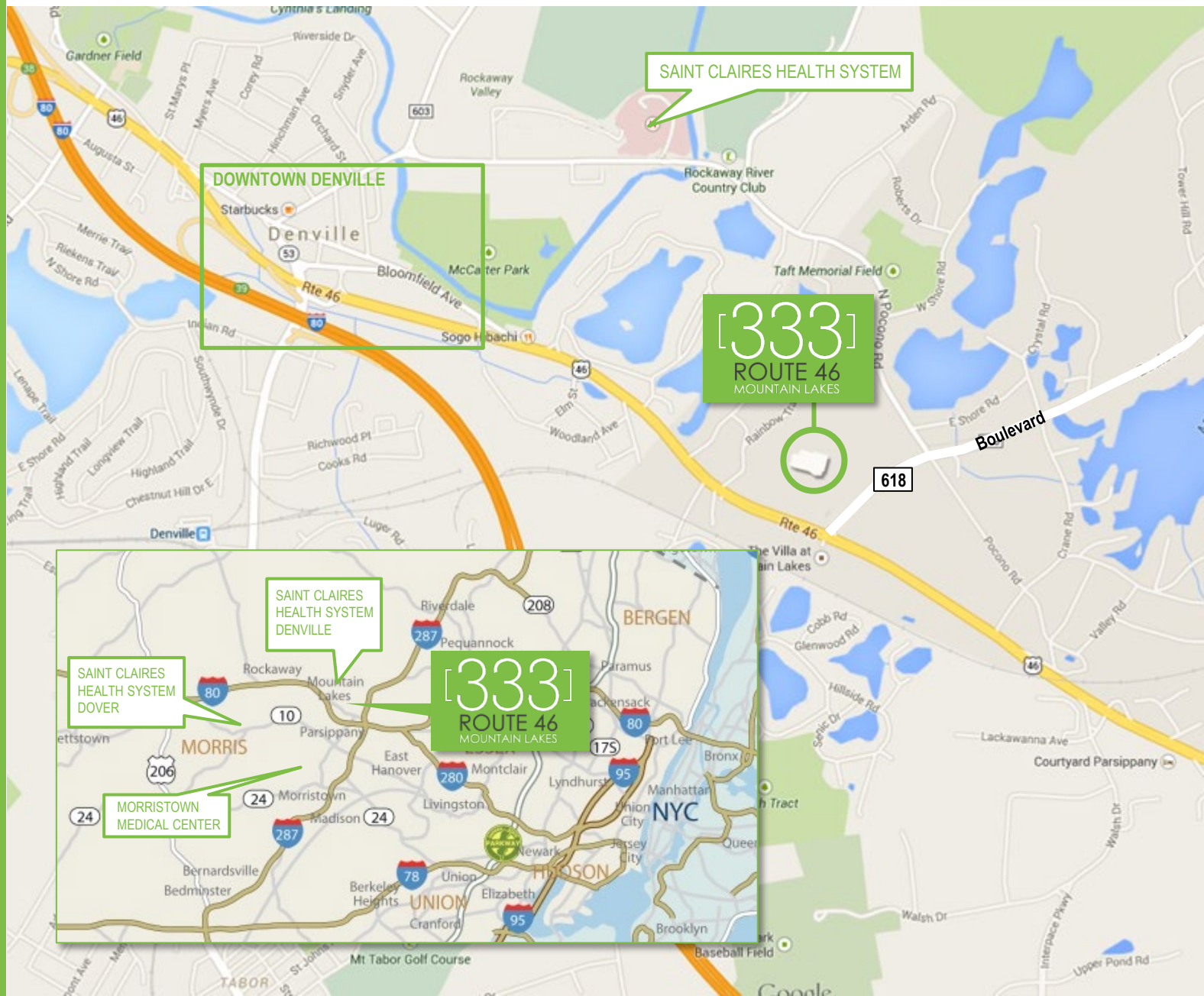

# [333]

ROUTE 46  
MOUNTAIN LAKES

---

## CONTACT

---

For more information about available space

Fred Hyatt

+1 973 829 4688 | [fred.hyatt@jll.com](mailto:fred.hyatt@jll.com)



Jones Lang LaSalle Brokerage, Inc.  
a licensed real estate broker

[jll.com/new-jersey](http://jll.com/new-jersey)

+1 973 829 4800

Although information has been obtained from sources deemed reliable, neither Owner nor JLL makes any guarantees, warranties or representations, express or implied, as to the completeness or accuracy as to the information contained herein. Any projections, opinions, assumptions or estimates used are for example only. There may be differences between projected and actual results, and those differences may be material.

The Property may be withdrawn without notice. Neither Owner nor JLL accepts any liability for any loss or damage suffered by any party resulting from reliance on this information. If the recipient of this information has signed a confidentiality agreement regarding this matter, this information is subject to the terms of that agreement. ©2022 Jones Lang LaSalle IP, Inc. All rights reserved.