

RDI

669 RIVER DRIVE
ELMWOOD PARK, NJ

Owned & managed by:



Accordia
REALTY VENTURES

11,538 RSF
AVAILABLE
FOR LEASE



River Drive Center II is located in the River Drive Office campus, which includes two other buildings and contains a total of nearly 300,000 s.f. of Class "A" space. The quality and atmosphere of the 669 River Drive are defined by its dramatic 4-story atrium and unmistakable exterior fountain and pool, which were both redesigned in 2017.



This 84,069 SF, 4-story building situated on 5.12 acres is owned and managed by Accordia Realty Ventures, a local entrepreneurial real estate firm dedicated to providing superior management services to its tenants.

Originally constructed in 1984, the building recently went through several upgrades which include a new high efficiency HVAC system, as well as common area and bathroom upgrades. The property is surrounded by abundant area amenities including a café in the adjacent building.



- Easy access to I-80 via Exit 61 and the Garden State Parkway, Exit 157, via Route 46.
- Excellent accessibility to Routes 3, 4, 17, 21 and the NJ Turnpike/I-95.

AVAILABLE SPACE

\$25.00 Gross Plus Tenant Electric

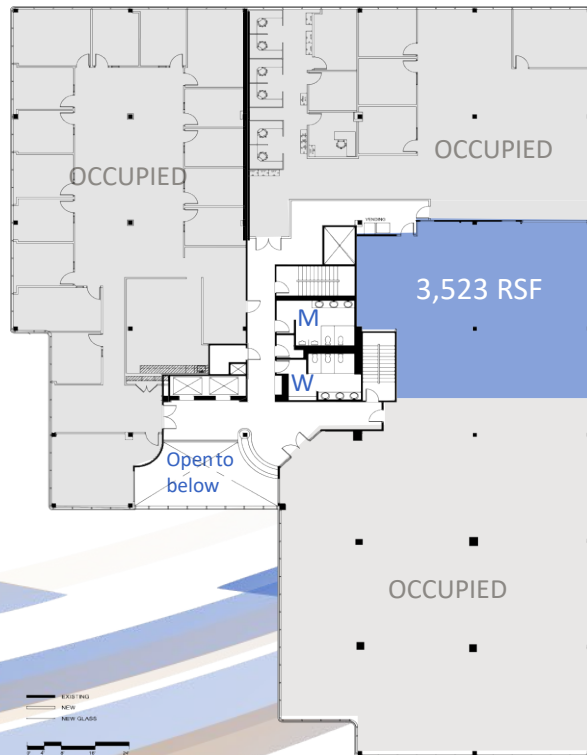

SECOND FLOOR

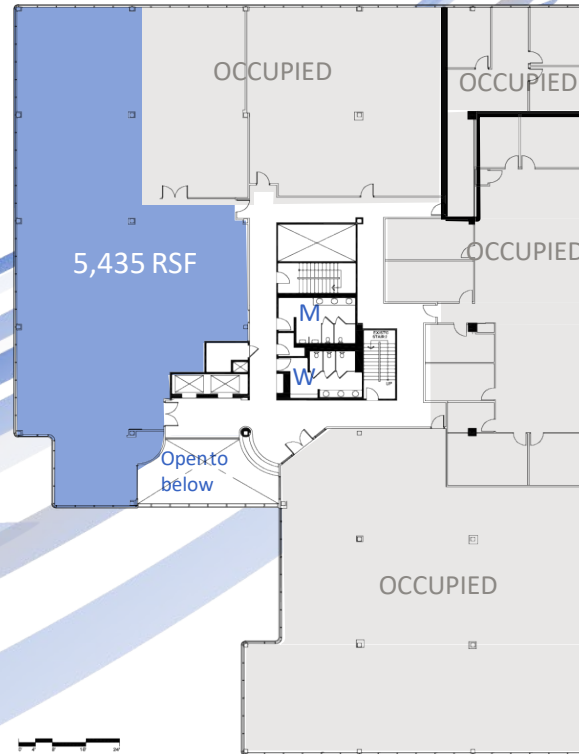

THIRD FLOOR

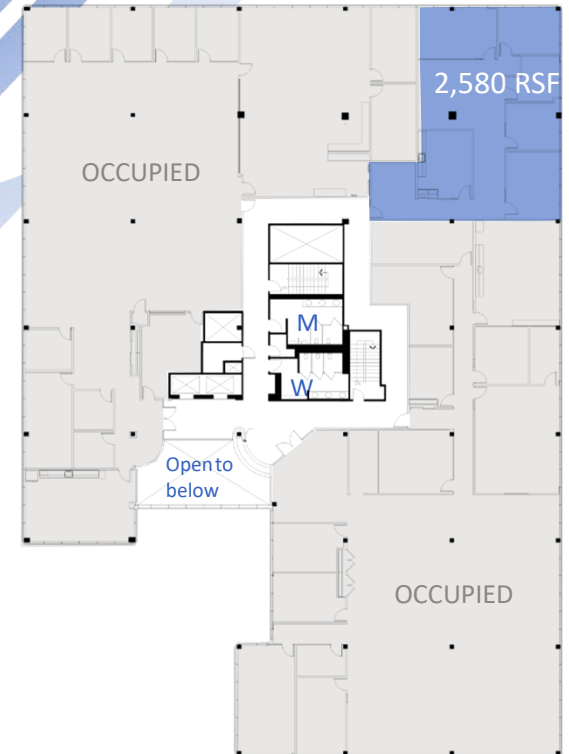

FOURTH FLOOR

NOT SHOWN:
FIRST FLOOR – FULLY OCCUPIED

ACCESS & AMENITIES

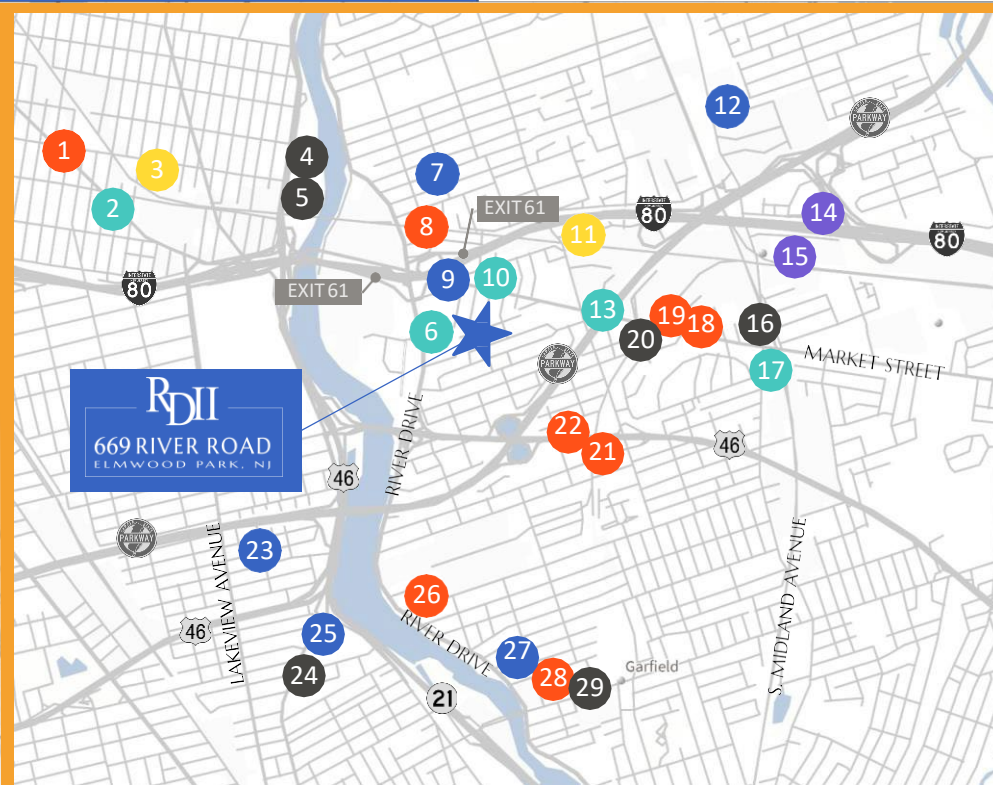
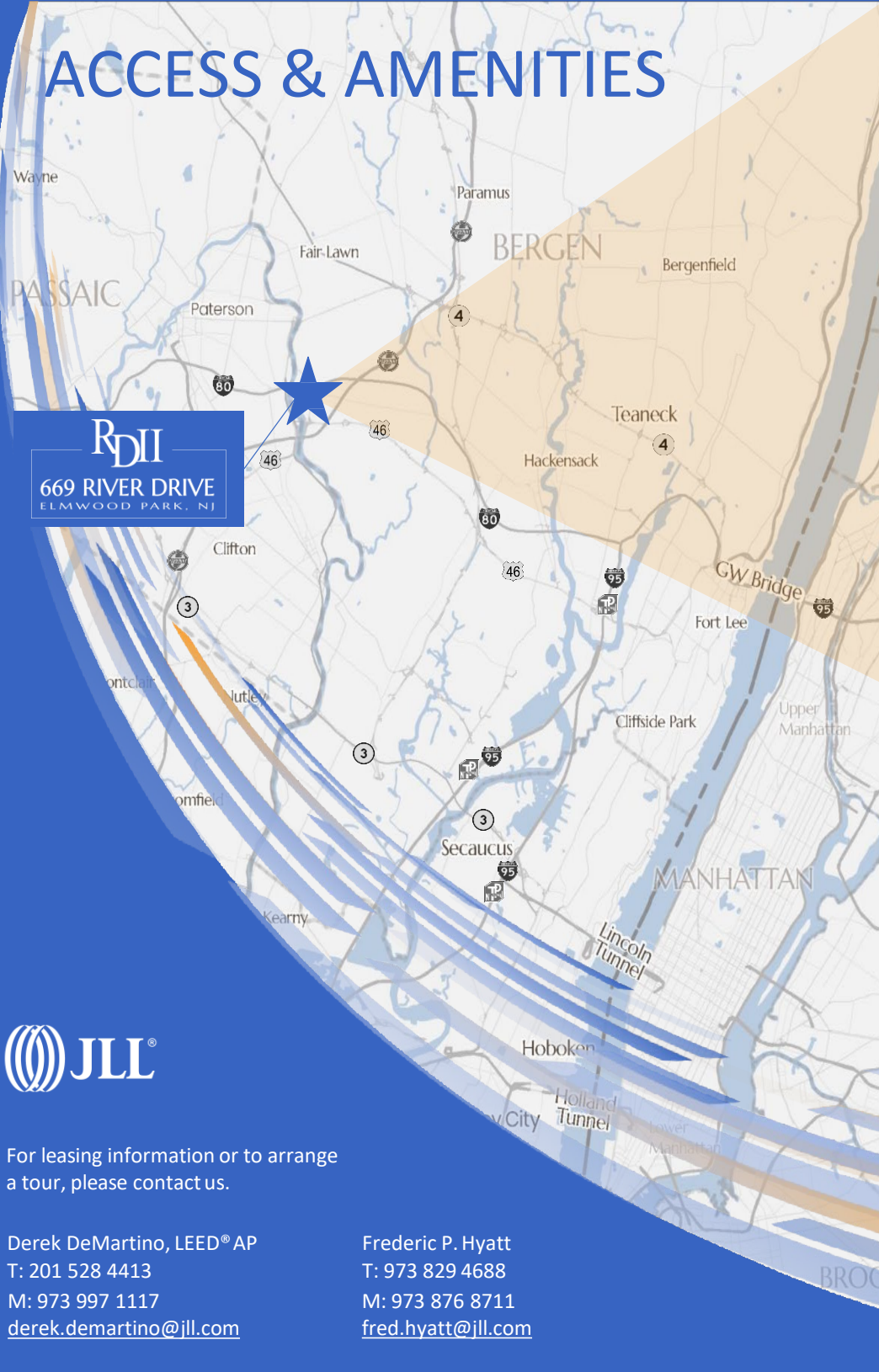

Area Amenities

Banking

- 2. PNC Bank
- 6. Spencer Savings Bank
- 10. Chase Bank
- 13. Bank of America
- 17. TD Bank

Hotels

- 14. Marriott Saddle Brook
- 15. Crowne Plaza Saddle Brook

Childcare

- 3. Riteway Child Care Center
- 11. Kinder Castle Child Care

Restaurants

- 7. Taste of Italia
- 9. Blue42 Restaurant & Bar
- 12. Midland Brew House
- 23. The Harp N' Bard
- 25. The Hot Grill
- 27. DP's Pub & Seafood Grill

Coffee

- 1. Dunkin'
- 8. Dunkin'
- 18. Dunkin'
- 19. Manhattan Bagel
- 21. Dunkin'
- 22. 7-Eleven
- 26. Dunkin'
- 28. Wawa

Retail / Fitness

- 4. Micro Center
- 5. Lowes
- 16. Walgreens
- 20. AnytimeFitness
- 24. CVS
- 29. Walgreens



For leasing information or to arrange a tour, please contact us.

Derek DeMartino, LEED® AP
T: 201 528 4413
M: 973 997 1117
derek.demartino@jll.com

Frederic P. Hyatt
T: 973 829 4688
M: 973 876 8711
fred.hyatt@jll.com