

# 1750H STREET



For more information,  
please contact:

**Andy Corno**

Executive Vice President  
+1 202 719 6137  
[andy.corno@jll.com](mailto:andy.corno@jll.com)

**Thomas Jackman**

Executive Vice President  
+1 202 719 5624  
[thomas.jackman@jll.com](mailto:thomas.jackman@jll.com)





# RETAIL SPACE FOR LEASE

- ◇ 1,644 SF second-gen café space with potential for outdoor seating. 12' - 10" slab to slab.
- ◇ Located adjacent to the White House
- ◇ Within 1 block of Farragut West and McPherson Square metro stations and two blocks from Farragut North metro
- ◇ Transit score of 98 and Walk score of 97
- ◇ Minutes away from 1-66, Whitehurst Freeway and Rock Creek Parkway
- ◇ 15,050,572 SF of office space within 3 blocks

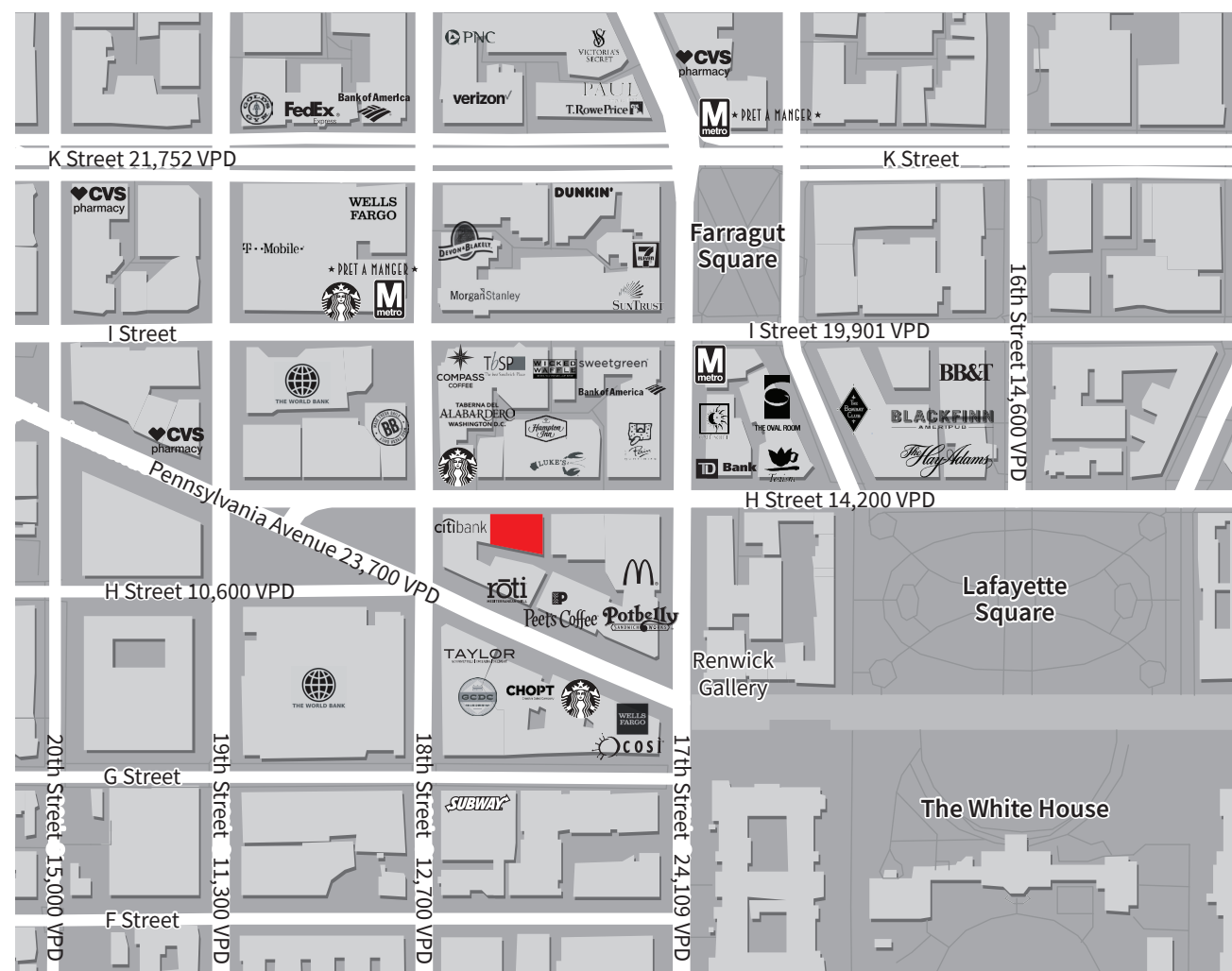

**DAYTIME  
POPULATION**  
\_\_\_\_\_ .5 mi

**90,270**

**AVERAGE HH  
INCOME**  
\_\_\_\_\_ .5 mi

**\$68,585**

**OFFICE SPACE**  
\_\_\_\_\_ 3 blocks

**5.3M SF**

**EMPLOYEES**  
\_\_\_\_\_ .5 mi

**145,668**

# THE OPPORTUNITY

H Street NW 14,200 VPD

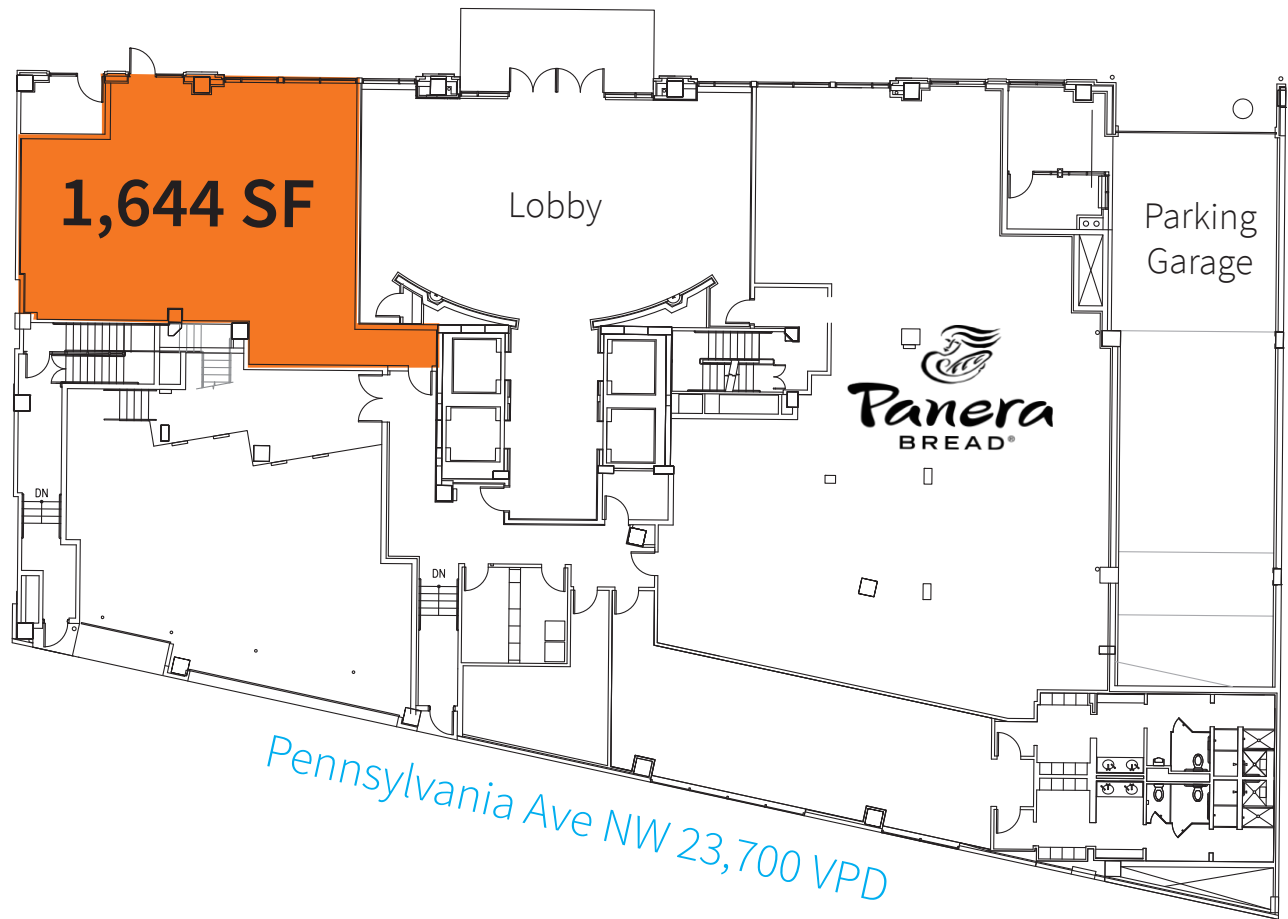

For more  
information,  
please contact:

Andy Corno  
+1 202 719 6137  
[andy.corno@jll.com](mailto:andy.corno@jll.com)

Thomas Jackman  
+1 202 719 5624  
[thomas.jackman@jll.com](mailto:thomas.jackman@jll.com)

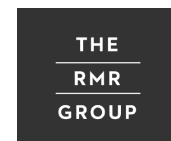



# 1750H STREET



For more information,  
please contact:

**Andy Corno**

Executive Vice President  
+1 202 719 6137  
[andy.corno@jll.com](mailto:andy.corno@jll.com)

**Thomas Jackman**

Executive Vice President  
+1 202 719 5624  
[thomas.jackman@jll.com](mailto:thomas.jackman@jll.com)

THE  
RMR  
GROUP

