



Office Space for Lease

- Office availabilities ranging from 1,193 – 3,824 SF
- Strong, well-capitalized ownership
- On-site property management
- Abundant parking
- Newly renovated common areas
- Easy access to all major highways, I-287, Exit 10-NJ Turnpike, Garden State Parkway, and Routes 1, 9 and 27

**145 Talmadge Rd
Edison, NJ 08817**

Jon Compitello
+1 732 590 4164
jon.compitello@am.jll.com

Alex Crane
+1 732 590 4187
alex.crane@am.jll.com

Although information has been obtained from sources deemed reliable, neither Owner nor JLL makes any guarantees, warranties or representations, express or implied, as to the completeness or accuracy as to the information contained herein. Any projections, opinions, assumptions or estimates used are for example only. There may be differences between projected and actual results, and those differences may be material. The Property may be withdrawn without notice. Neither Owner nor JLL accepts any liability for any loss or damage suffered by any party resulting from reliance on this information. If the recipient of this information has signed a confidentiality agreement regarding this matter, this information is subject to the terms of that agreement. ©2019 Jones Lang LaSalle IP, Inc. All rights reserved.



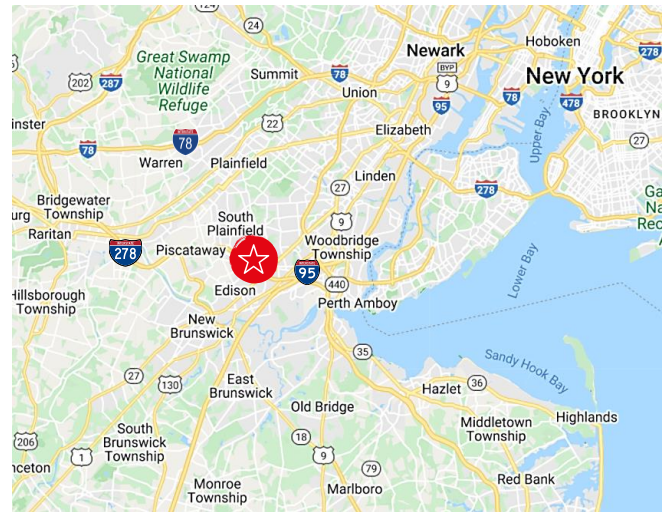
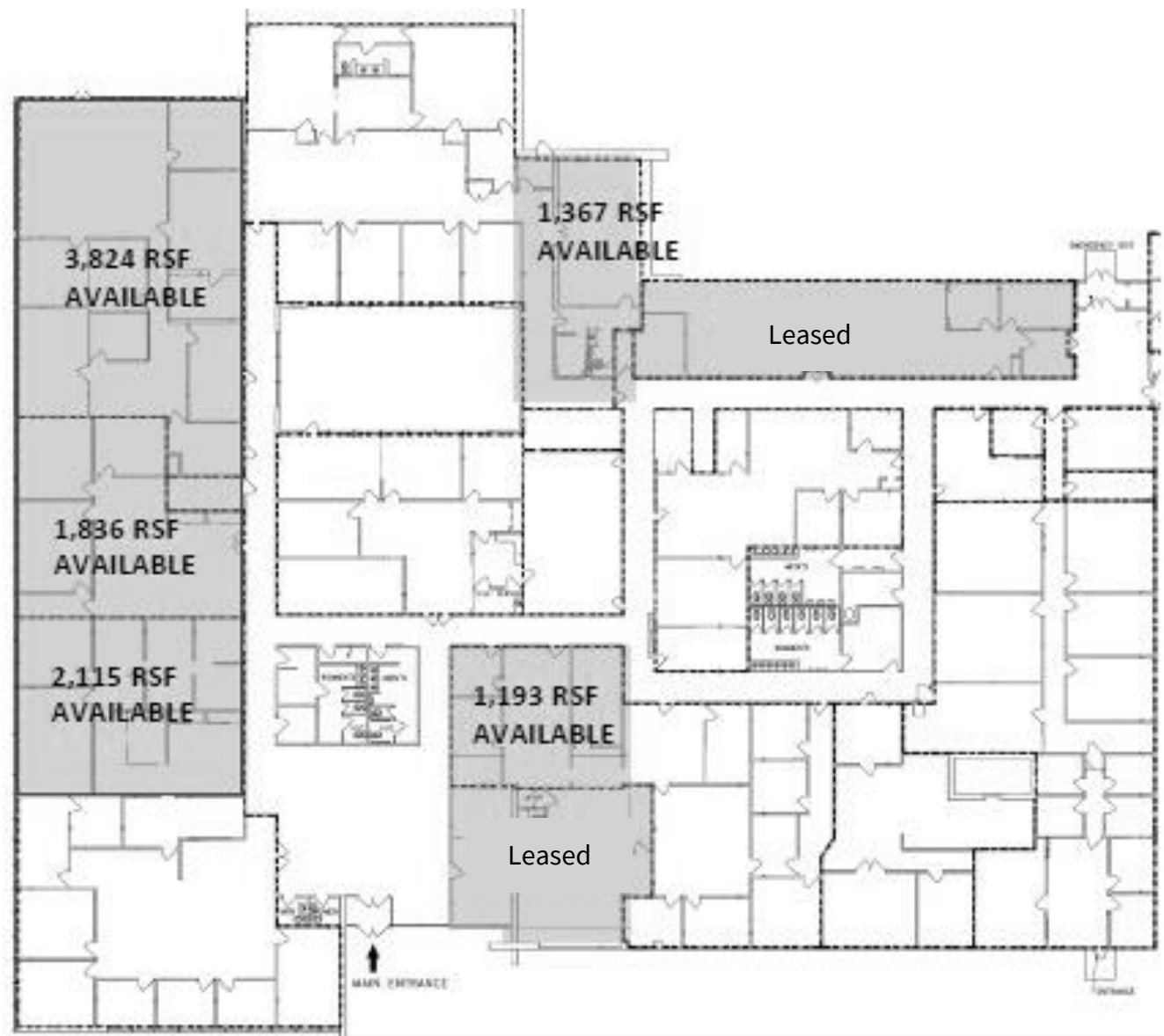

Although information has been obtained from sources deemed reliable, neither Owner nor JLL makes any guarantees, warranties or representations, express or implied, as to the completeness or accuracy as to the information contained herein. Any projections, opinions, assumptions or estimates used are for example only. There may be differences between projected and actual results, and those differences may be material. The Property may be withdrawn without notice. Neither Owner nor JLL accepts any liability for any loss or damage suffered by any party resulting from reliance on this information. If the recipient of this information has signed a confidentiality agreement regarding this matter, this information is subject to the terms of that agreement. ©2019 Jones Lang LaSalle IP, Inc. All rights reserved.

