

**100% COMMISSION PAID
WITHIN 48 HOURS OF
LEASE SIGNING**



1200 Atwater Drive

Malvern, PA 19355

MAGUIRE
HAYDEN
REAL ESTATE COMPANY

For Lease
3,992 – 29,138 SF



Availabilities

- 1st floor – 3,992 SF
- 1st floor – 5,168 SF
- 2nd floor – Up to 29,138 SF



Highlights

- 10' finished ceiling height throughout
- 4.50/1,000 SF parking ratio
- Floor to ceiling glass
- On-site café & beautiful outdoor patio with brand new furniture
- Car charging station for electric vehicles
- Showers in West lobby bathrooms for use after exercising on the fitness trail in the Park
- Adjacent to full service hotel with conference facilities and restaurant, fitness center and extensive jogging trails
- Direct PA Turnpike EZ-Pass Interchange at Route 29 places Atwater at the convergence of the regions most important arteries (I-76, Rt. 29, Rt. 30, Rt. 202)
- A short drive to hotels, shopping and restaurants along Route 29
- Waterfront location overlooking Echo Lake

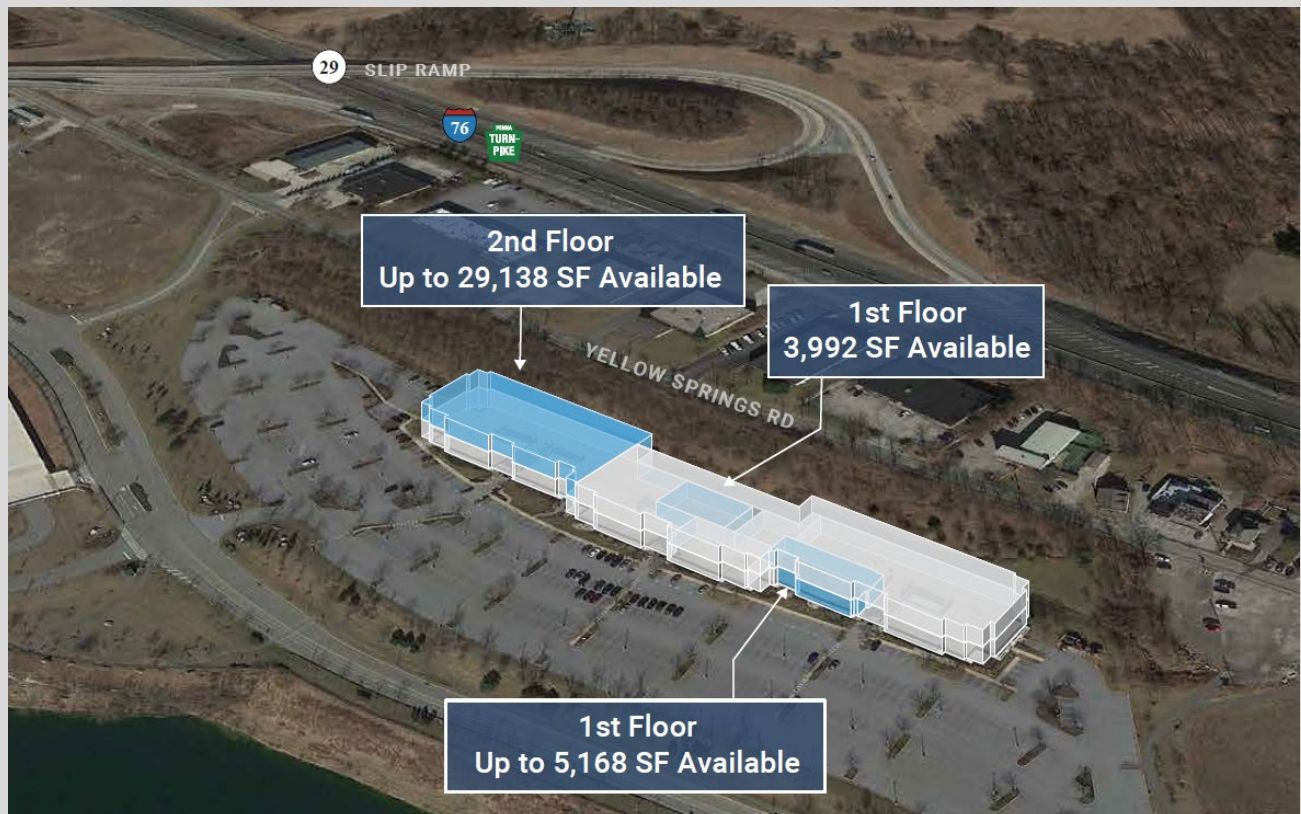

1200 Atwater Drive sits along an 80-acre spring-fed lake and has access to several walking/running paths, making it ideal for companies wishing to provide an outstanding and comfortable environment for their employees and visitors.



Nearby Amenities

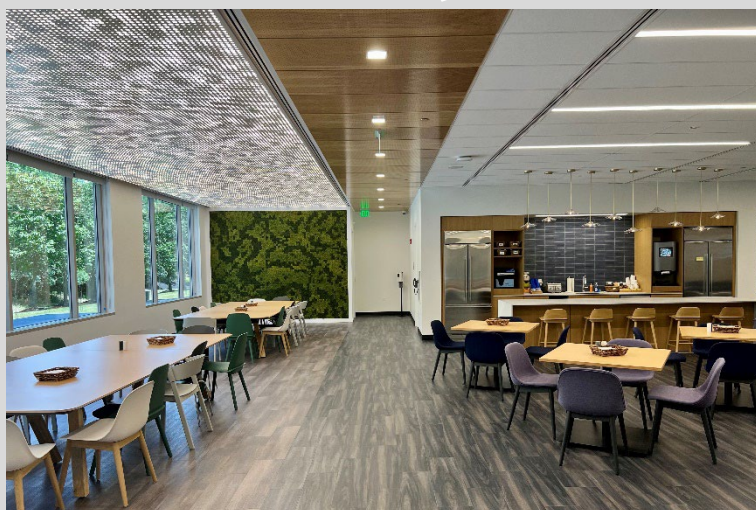

Mike MacCrory
+1 610 389 2767
mike.maccrory@jll.com

Doug Newbert
+1 267 980 6484
doug.newbert@jll.com

Jones Lang LaSalle Brokerage, Inc.
550 E. Swedesford Road, Suite 260
Wayne, PA 19087
+1 610 249 2255



Although information has been obtained from sources deemed reliable, neither Owner nor JLL makes any guarantees, warranties or representations, express or implied, as to the completeness or accuracy as to the information contained herein. Any projections, opinions, assumptions or estimates used are for example only. There may be differences between projected and actual results, and those differences may be material. The Property may be withdrawn without notice. Neither Owner nor JLL accepts any liability for any loss or damage suffered by any party resulting from reliance on this information. If the recipient of this information has signed a confidentiality agreement regarding this matter, this information is subject to the terms of that agreement. ©2023. Jones Lang LaSalle IP, Inc. All rights reserved.