



For Sublease

**Sublease through
November 30, 2027**

12623 Cisneros Lane
Santa Fe Springs, CA 90670

- 64,799 SF available
- 17,607 SF office space
- 30' clear height
- 10 dock high loading positions
- ESFR Sprinklers
- 125' Concrete truck court
- Existing racking can be made available
- Excellent access to I-5 & 605 Freeways

Jon Reno, SIOR, CCIM

Managing Director
CA DRE #01277642
+1 213 271 1508
jon.reno@jll.com

Mark Vanis

Managing Director
CA DRE #01305617
+213 239 5908
mark.vanis@jll.com

Trevor Gale, SIOR

Managing Director
CA DRE #01452957
+1 213 239 6256
trevor.gale@jll.com

Sage Segal

Senior Associate
CA DRE #02099925
+1 213 239 6078
sage.segal@jll.com

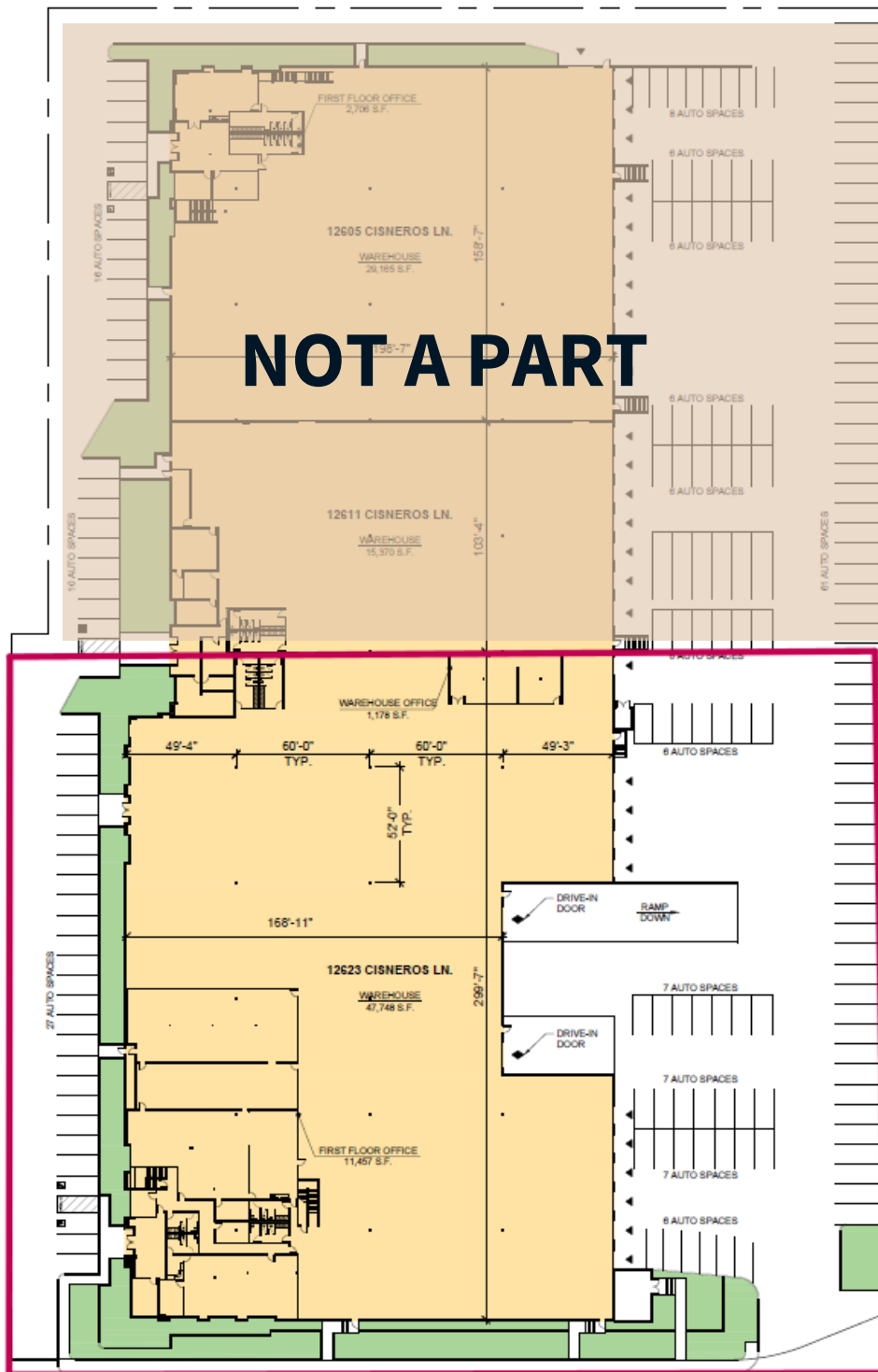

CISNEROS LN.

Jon Reno, SIOR, CCIM
Managing Director
CA DRE #01277642
+1 213 271 1508
jon.reno@jll.com

Mark Vanis
Managing Director
CA DRE #01305617
+213 239 5908
mark.vanis@jll.com

Trevor Gale, SIOR
Managing Director
CA DRE #01452957
+1 213 239 6256
trevor.gale@jll.com

Sage Segal
Senior Associate
CA DRE #02099925
+1 213 239 6078
sage.segal@jll.com

Although information has been obtained from sources deemed reliable, neither Owner nor JLL makes any guarantees, warranties or representations, express or implied, as to the completeness or accuracy as to the information contained herein. Any projections, opinions, assumptions or estimates used are for example only. There may be differences between projected and actual results, and those differences may be material. The Property may be withdrawn without notice. Neither Owner nor JLL accepts any liability for any loss or damage suffered by any party resulting from reliance on this information. If the recipient of this information has signed a confidentiality agreement regarding this matter, this information is subject to the terms of that agreement. © 2024 Jones Lang LaSalle IP, Inc. All rights reserved. Jones Lang LaSalle Brokerage, Inc. CA License #01856260 515 S. Flower Street, Suite 1300, Los Angeles, CA 90071