

FOR SUBLEASE

LED: 10/31/25



The Atrium @ Lakeside

 **JLL** SEE A BRIGHTER WAY

2880 Lakeside Drive
Santa Clara, CA
± 8,779 SF

- Available 4/1/24
- 2nd Floor S:250 & 253
- LED: 10/31/25 - Credit sublessor
- Gym, lockers, and showers on the second floor
- Abundant surface parking
- EV Charging Stations On-Site
- Plug-and-play delivery - high end workstations

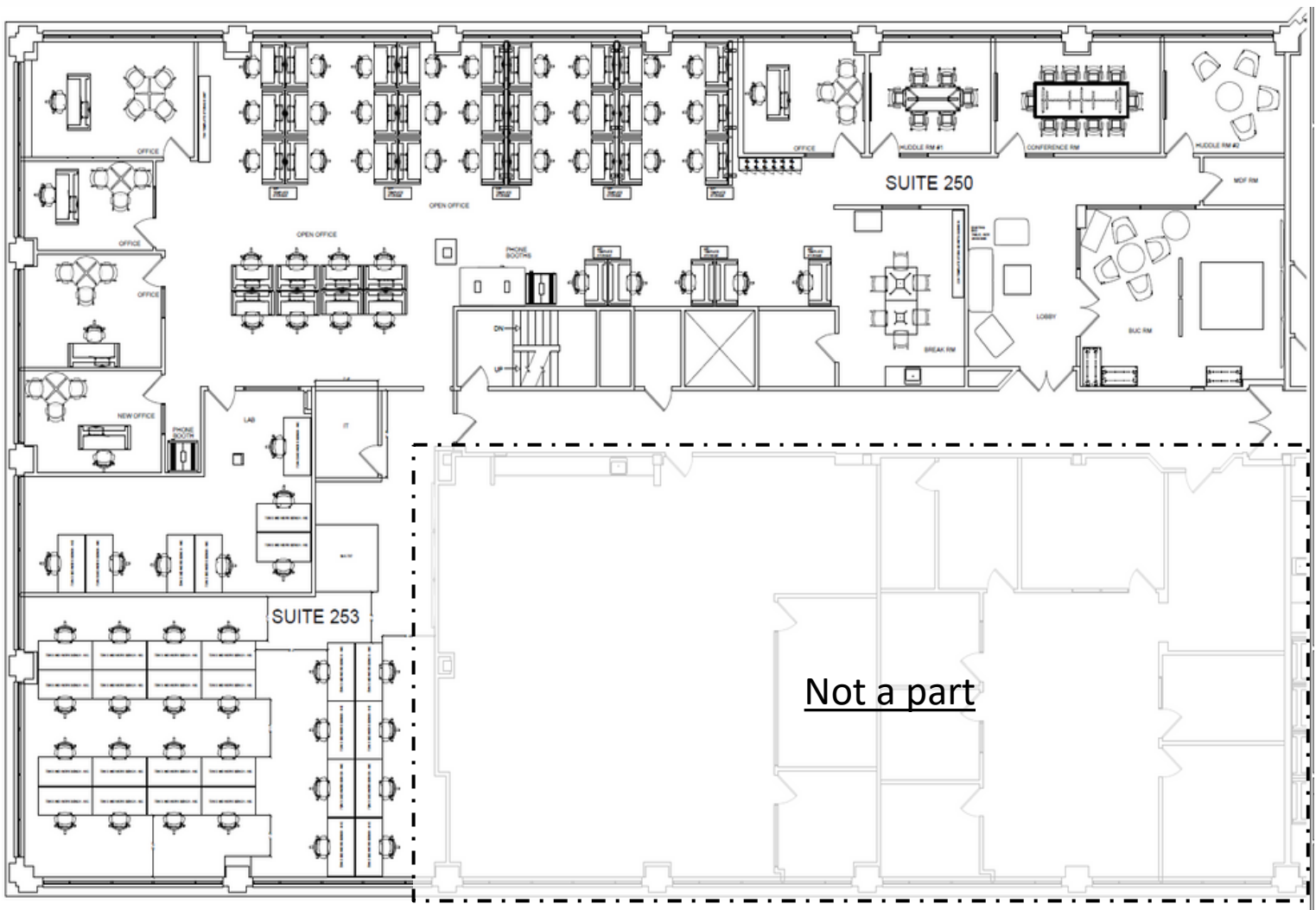

CONOR FLANNERY

RE License #01856260

O +1 650 480 2207

M +1 650 400 6021

conor.flannery@jll.com

NICK CARROLL

RE License #02196860

O +1 650 480 2207

M +1 408 325 3276

nick.carroll@jll.com

2880 Lakeside Drive

S:250/253 ±8,779 SF



CONOR FLANNERY
RE License #01856260
O +1 650 480 2207
M +1 650 400 6021
conor.flannery@jll.com

NICK CARROLL
RE License #02196860
O +1 650 480 2207
M +1 408 325 3276
nick.carroll@jll.com

 **JLL** SEE A BRIGHTER WAY

AMENITIES & TRANSPORTATION MAP

- Located in the Heart of Silicon Valley off Highway 101 at the Great America Pkwy
- Conveniently located 1.5 miles north of San Jose International Airport
- Within walking distance of hotels, restaurants, and retail services

- ■ ■ ■ ■ **CalTrain**
- ■ ■ ■ ■ **Mission College Shuttle**
- ■ ■ ■ ■ **VTA Bus Line**



CONOR FLANNERY
 RE License #01856260
 O +1 650 480 2207
 M +1 650 400 6021
conor.flannery@jll.com
jll.com

NICK CARROLL
 RE License #02196860
 O +1 650 480 2207
 M +1 408 325 3276
nick.carroll@jll.com

JLL SEE A BRIGHTER WAY